



# Hardwire Kit

## UTS6, UTS6H, UTS6BI & UTS10BI

### CAUTION

The UTS6/6H/6BI will support a generator up to 30 A, 7.2 kW with a UTS Hardwire Kit (UTSHW). The UTS10BI will support a generator up to 50 A, 10-12 kW with a UTSHW. **DO NOT** connect the generator power cable to the generator until the UTSHW installation is complete. Ensure there is **NO POWER** connected to the UTS panel from any source during UTSHW installation.

A qualified electrician must install the transfer switch according to the transfer switch manufacturer instructions, and the connection must comply with all applicable laws and the local electric code.

UTS Hard Wiring Kit Parts List		
Qty	Description	Image
1	TERMINAL BLOCK ASSEMBLY	
2	NUT 6-32 SLOTTED	
1	TERMINAL BLOCK INSULATOR	
1	RING LUG #8 AWG 10-12	
1	RING LUG #8 AWG 14-16	
3	SCREW 6-32X3/8 FLAT HEAD	
1	LOCKNUT 3/4 STEEL	
1	STRAIN RELIEF 3/4 CABLE CLAMP	
1	L14 CLOSE OFF PLATE	

1. Review the *UTS Hardwiring Kit Parts List*, and ensure all parts are included.

**NOTE: A Type UF 2 or 3-wire power cable must be purchased by the user.**

2. Remove the *square drive screws* securing the UTS cover. Remove the cover, and retain the screws.

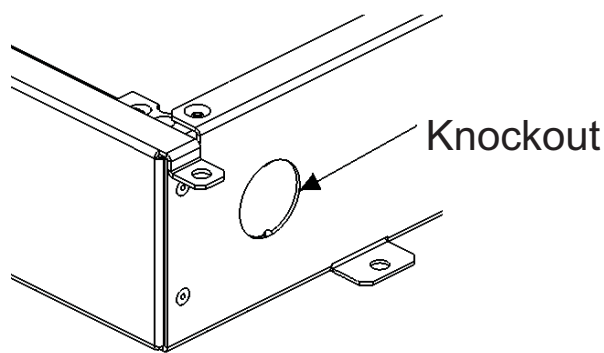

3. Remove the knockout from the right side of the UTS.

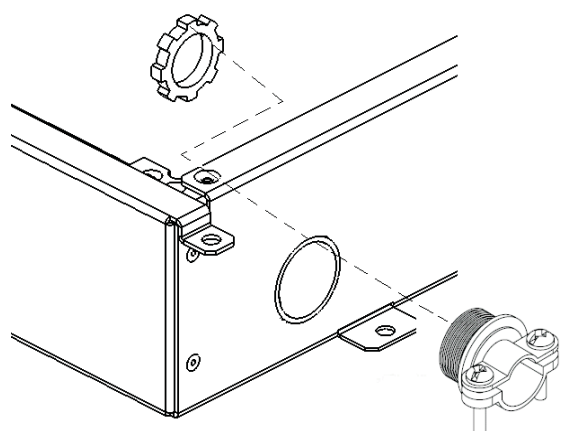

4. Install the  $\frac{3}{4}$ -inch strain relief cable clamp, and fasten it into place using the locknut provided.

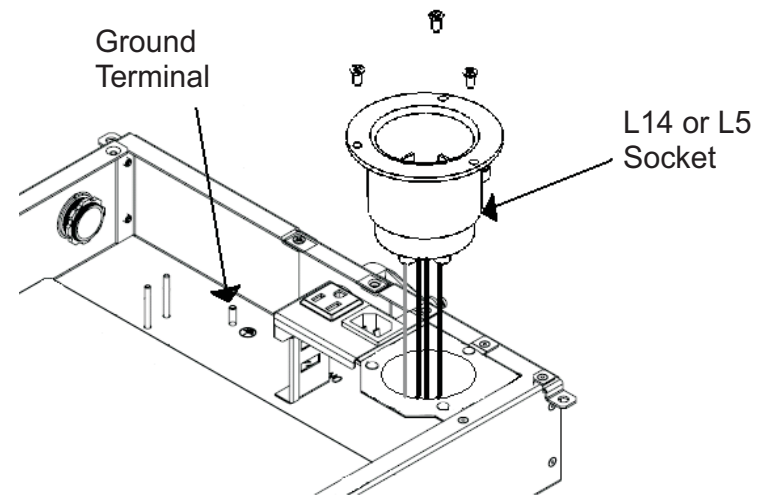

5. Remove the *flat head screws* securing the L14 or L5 Socket to the mounting bracket.

6. On the PC board (PCB), disconnect the black, brown, and white wires running from the L14 or L5 socket.

7. Remove the *Ground Terminal Nut* securing the green ground wire originating from the L14 or L5 socket, and remove the ground wire. Loosely thread the nut back on to the Ground Terminal.

8. Remove the *L14 or L5 Socket* with all wires still attached.

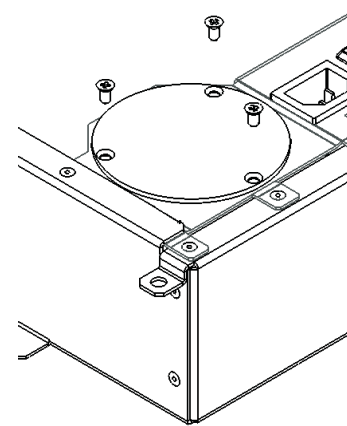

9. Install the *L14 Close-off Plate*, and secure it in place using the flat head screws provided.

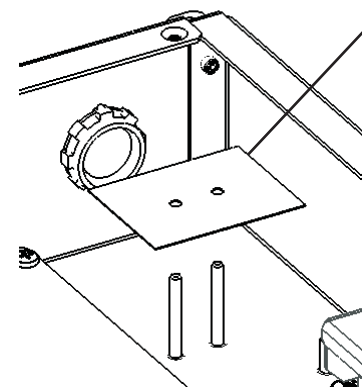

10. Slide the *Terminal Block Insulator* down over the two threaded studs.

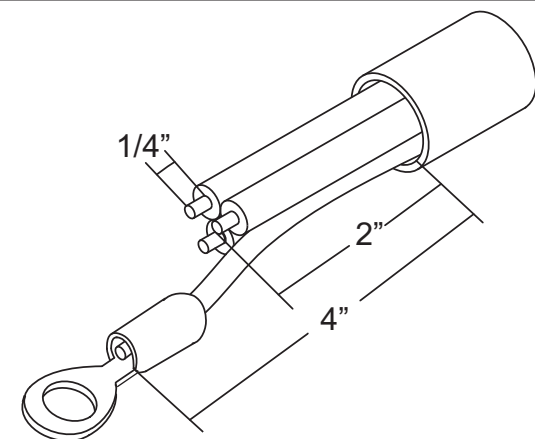

11. Prepare the *Type UF Power Cable* as follows:

- Remove approximately 4" of the *outer jacket*.
- Cut the three jacketed *conductors* back approximately 2", and strip off 1/4" of insulation from each.
- Select the appropriate size *ring lug* provided (10awg-12awg or 14awg-16awg) and crimp it to the uninsulated ground wire using a crimping tool specified and approved for application of closed barrel ring terminals.

**UTS6/UTS6BI Only**

**UTS6H Only**

12. Terminal block assembly (TBA), preparation.  
For installation with a UTS10BI model, go to step 13.

- a. Loosen the screws securing the wires to be removed from the TBA. Refer to the diagrams below.
- b. UTS6/UTS6BI: Remove the long black and brown wires leaving the short brown and black wires in place.  
UTS6H: Remove both the short and long brown wires.
- c. UTS6/UTS6BI: Tighten the screws securing the short black and brown wires. Torque to 10-16 in lbs.

16. Attach the wires from the *TBA* to the *PCB Reference Points*, listed in Table 1. These points differ slightly for each model, as shown in the table.

**Table 1. Reference Points**

PCB Reference Points					
Color	Length	UTS10BI	UTS6BI	UTS6	UTS6H
BRN	5.5 in	BU1-Y1 (J40)	BU1-Y2 (J42)	BU1-Y1 (J40)	N/A
BRN	11.5 in	BU1-Y3 (J41)	N/A	N/A	N/A
BLK	12.5 in	BU1-X1 (J4)	BU1-X3 (J5)	BU1-Y1 (J4)	BU1-X1 (J4)
BLK	15 in	BU1-X3 (J5)	N/A	N/A	BU1-Y1 (J40)
WHT	7 in	Neutral (J19)	Neutral (J33)	Neutral (J33)	Neutral (J33)
WHT	7 in	Neutral (J17)	N/A	N/A	N/A

**UTS6/UTS6H**

**UTS6BI**

**UTS10BI**

**For All Units**

Terminal Block Wires	Type UF Power Cable Wires
White	White
Brown	Red
Black	Black

13. Thread the *Type UF Power Cable* through the *Strain Relief Cable Clamp* (shown in step 4), and insert the white, red and black wires into the *TBA* shown above. Tighten the screws to secure the wires in place, torque setting 10 in lbs ~ 16 in lbs.

14. Slide the *TBA* down over the two (2) threaded studs, shown in Step 10, and install the two (2) *slotted nuts*, as shown above.

15. Remove the nut loosed in step 7 from the ground terminal on the chassis, slide the *ground wire ring lug* over the ground terminal, and secure it in place with the nut, torque setting 11 in lbs ~ 13 in lbs.

17. Install the *UTS cover*, and fasten it in place with the square drive screws removed in step 2.

18. Connect the far end of the *Type UF Power Cable*. For example, it might connect to a fixed generator, or to a remote L14 or L5 connector that is used for a portable generator.

19. Once the generator end of the *Type UF Power Cable* is wired and tested, start the generator and verify that the source LED is on, and the loads are powered.

**APC by SCHNEIDER ELECTRIC IT CUSTOMER SUPPORT WORLDWIDE**

For country specific customer support, go to the APC by Schneider Electric Web site, [www.apc.com](http://www.apc.com).

© 2014 APC by Schneider Electric. APC, and the APC logo are owned by Schneider Electric Industries S.A.S or their affiliated companies. All other trademarks are property of their respective owners.