

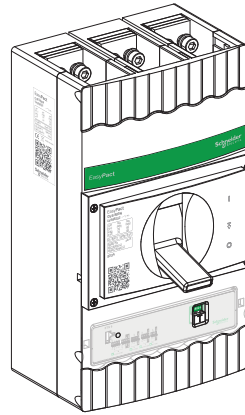

## 3P/4P Circuit Breakers and Accessories

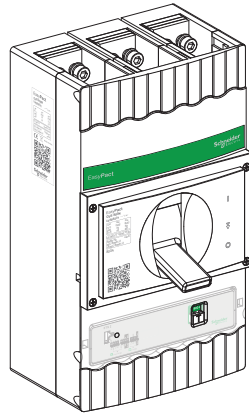
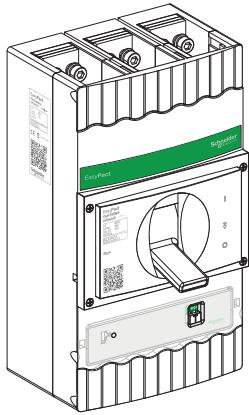

LV5082•0  
LV5102•0  
LV5122•0

LV5082•1  
LV5102•1  
LV5122•1

LV5082•2  
LV5102•2  
LV5122•2

? → [www.se.com/support](http://www.se.com/support)

Retain instruction sheet for future use.  
Visit our website at [www.se.com](http://www.se.com) to download other documents.

### PLEASE NOTE

- Electrical equipment should be installed, operated, serviced, and maintained only by qualified personnel.
- No responsibility is assumed by Schneider Electric for any consequences arising out of the use of this material.
- All pertinent state, regional, and local safety regulations must be observed when installing and using this product.

## ⚠ ⚠ DANGER

### HAZARD OF ELECTRIC SHOCK, EXPLOSION OR ARC FLASH

- Apply appropriate personal protective equipment (PPE) and follow safe electrical work practices. See NFPA 70E, CSA Z462, NOM-029-STPS or local equivalent.
- This equipment must only be installed and serviced by qualified electrical personnel.
- Turn off all power supplying this equipment before working on or inside equipment.
- Always use a properly rated voltage sensing device to confirm power is off.
- Re-place all devices, doors, and covers before turning on power to this equipment.
- Beware of potential hazards, and carefully inspect the work area for tools and objects that may have been left inside the equipment.

**Failure to follow these instructions will result in death or serious injury.**

## Table of contents

<b>1</b>	<b>Required for Installation</b>	<b>3</b>
<b>2</b>	<b>Operation of Circuit Breaker</b>	<b>5</b>
<b>3</b>	<b>Operation of Extended rotary handle</b>	<b>6</b>
<b>4</b>	<b>Before Working on Equipment</b>	<b>7</b>
<b>5</b>	<b>Clearance Distances</b>	<b>7</b>
<b>6</b>	<b>Installation</b>	<b>8</b>
<b>7</b>	<b>Wiring</b>	<b>9</b>
<b>8</b>	<b>Connection Accessories</b>	<b>10</b>
<b>9</b>	<b>Insulation Accessories</b>	<b>21</b>
<b>10</b>	<b>Trip Unit Adjustment</b>	<b>22</b>
<b>11</b>	<b>Handling</b>	<b>24</b>

# 1 Required for Installation

## 1.1 Circuit Breaker

LV5082●●  
LV5102●●  
LV5122●●

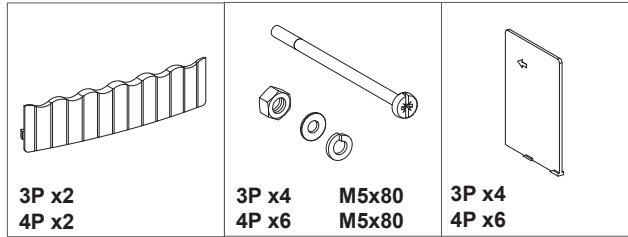
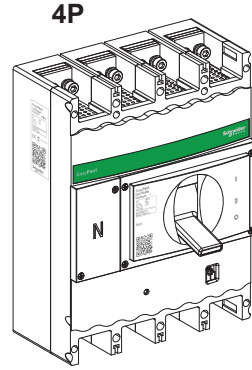
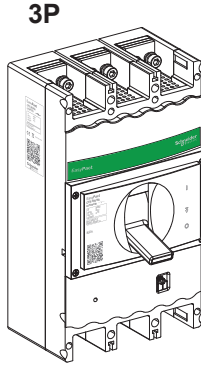

Note: Always use specified tools for assembly and maintenance.

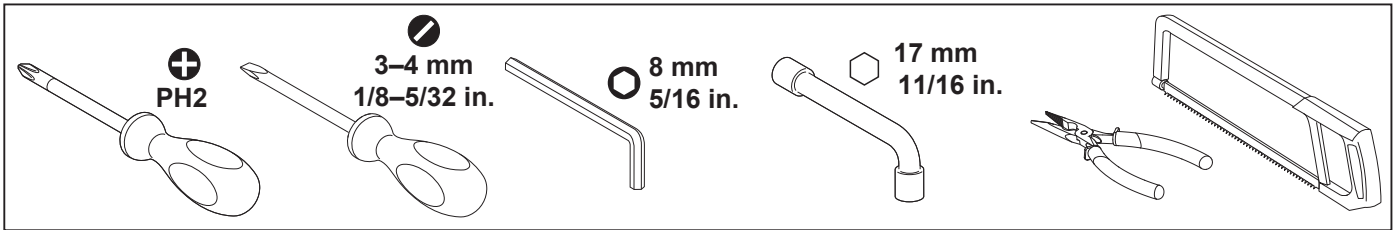

## 1.2 Accessories



Note: Accessories are bought separately as per the requirement.

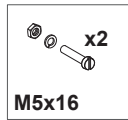
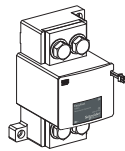
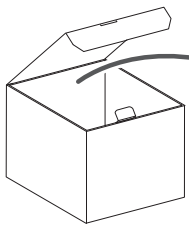

LV508560  
LV510560  
LV512560

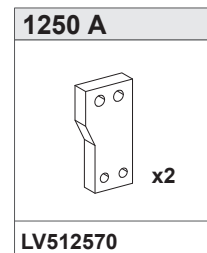
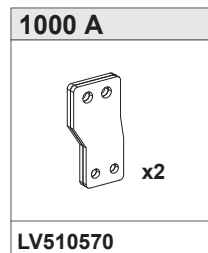
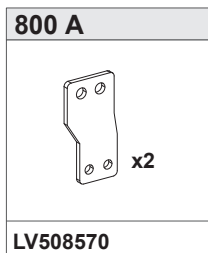
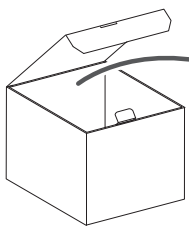

# 1 Required for Installation

## 1.2 Accessories

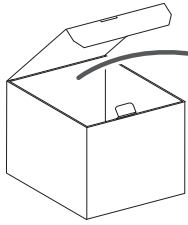

800 A			
			x2
LV508530	3P		x2
		LV508540	4P

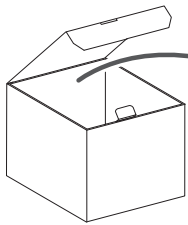

1000 A			
			x2
LV510530	3P		x2
		LV510540	4P

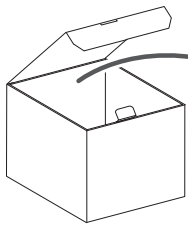

1250 A			
			x2
LV512530	3P		x2
		LV512540	4P

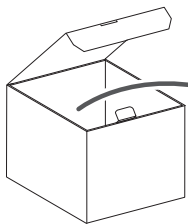

			x4	x2
LV500500	M5x90	M4x15		
				3P/4P

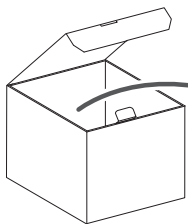

LV500606	LV500605	LV500603	LV500601 LV500602	LV500604



# 2 Operation of Circuit Breaker

## 2.1 Device Status

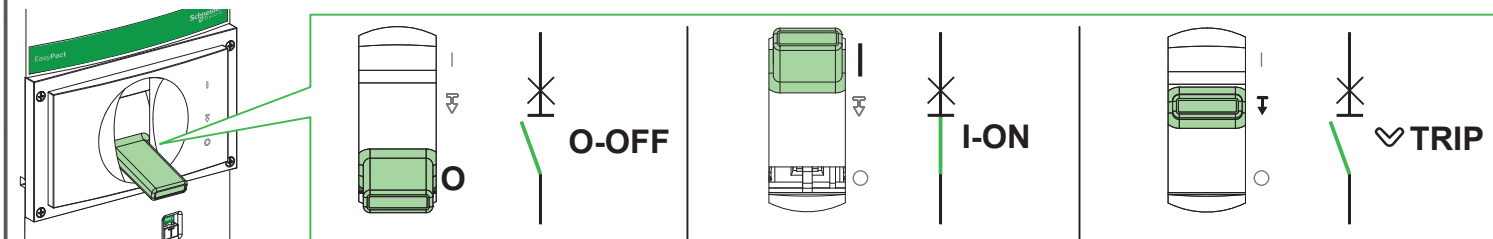

## 2.2 Device Operation

### 2.2.1 Close Device

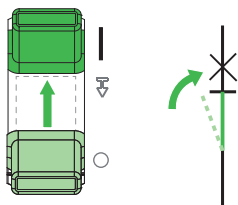

### 2.2.2 Open Device

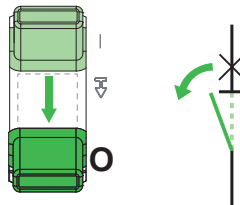

### 2.2.3 Reset After a Trip

#### ⚠️ ⚠️ DANGER

#### HAZARD OF ELECTRIC SHOCK, EXPLOSION OR ARC FLASH

Do not close the device without first inspecting and, if necessary, repairing the downstream electrical equipment.  
Failure to follow these instructions will result in death or serious injury.

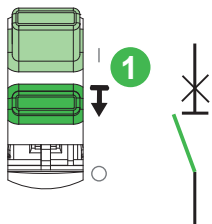

Device has tripped.  
Inspect the device.

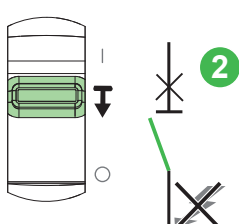

Inspect and repair downstream equipment,  
using proper safety precautions.

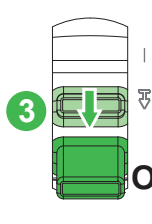

Reset the device.

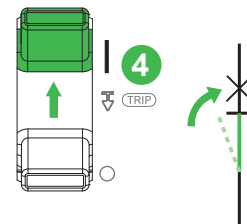

Close the device.

# 3 Operation of Extended rotary handle

## 3.1 Circuit Breaker Status

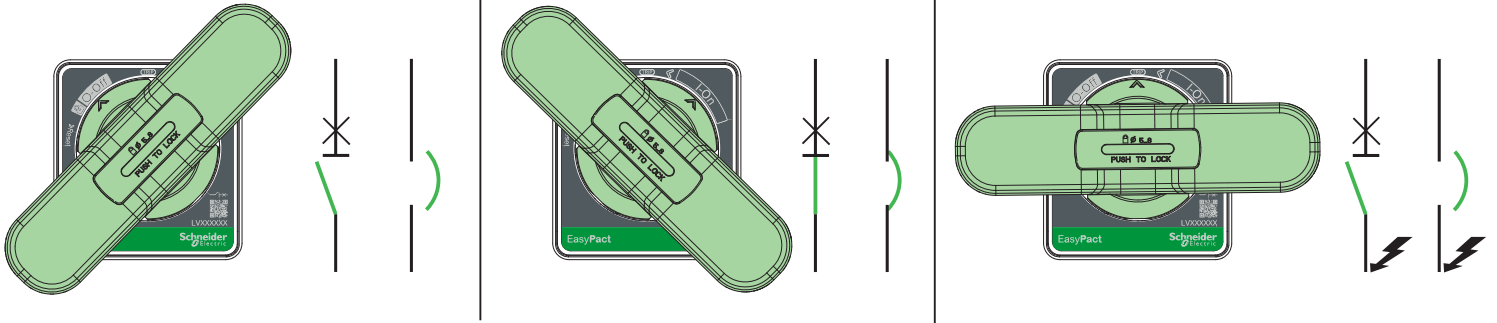

## 3.2 Circuit Breaker Operation

### 3.2.1 Close Circuit Breaker

### 3.2.2 Open Circuit Breaker

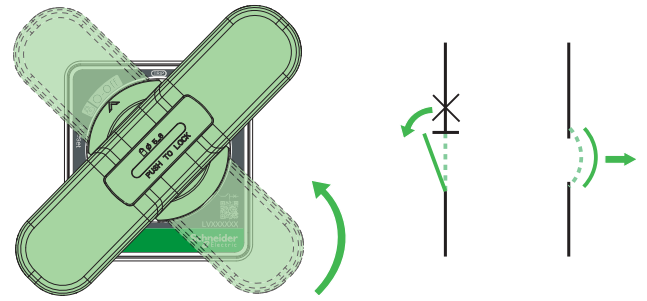
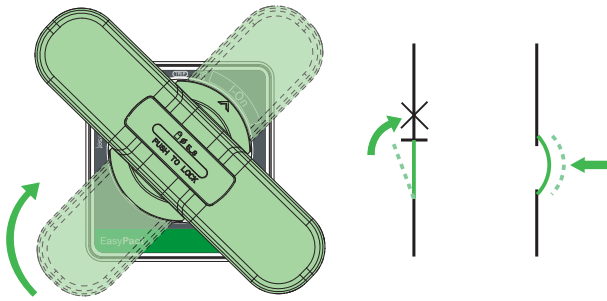

### 3.2.3 Reset After a Trip

## ⚠ ⚠ DANGER

### HAZARD OF ELECTRIC SHOCK, EXPLOSION OR ARC FLASH

Do not close the circuit breaker without first inspecting and, if necessary, repairing the downstream electrical equipment. Failure to follow these instructions will result in death or serious injury.

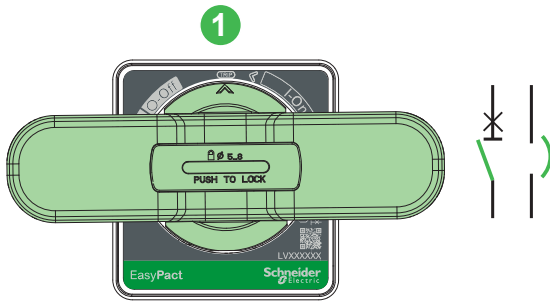

1  
Circuit breaker has tripped. Inspect the device.

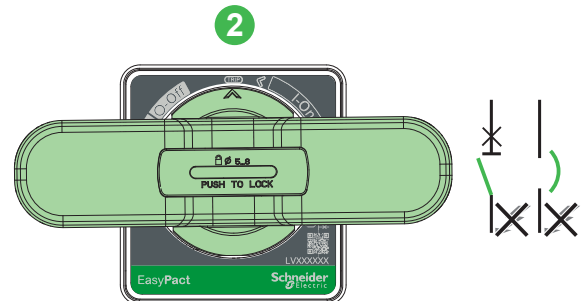

2  
Inspect and repair downstream equipment, using proper safety precautions.

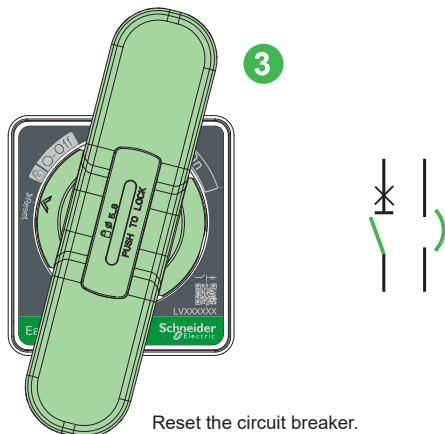

3  
Reset the circuit breaker.

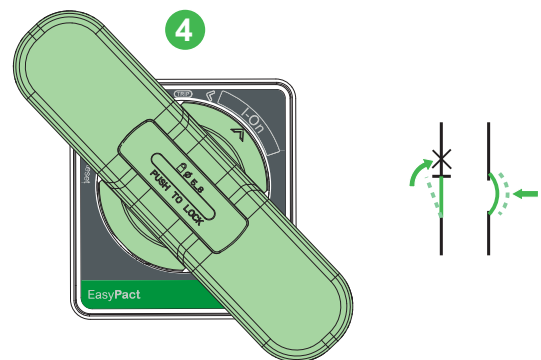

4  
Close the circuit breaker.

# 4 Before Working on Equipment

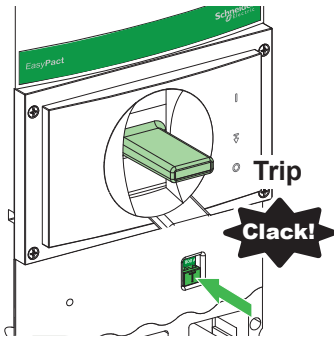

1. Turn off all power supplying this equipment before working on or inside equipment.
2. Use push-to-test button to trip the device.
3. Use a properly rated voltage sensing device to confirm power is off.

# 5 Clearance Distances

**⚠️ ⚠️ DANGER**

**HAZARD OF ELECTRIC SHOCK, EXPLOSION OR ARC FLASH**  
 Install the device so minimum clearance distance to grounded metal is maintained.  
 Failure to follow these instructions will result in death or serious injury.

## 5.1 Live Part Minimum Clearance Distances Required

3P/4P

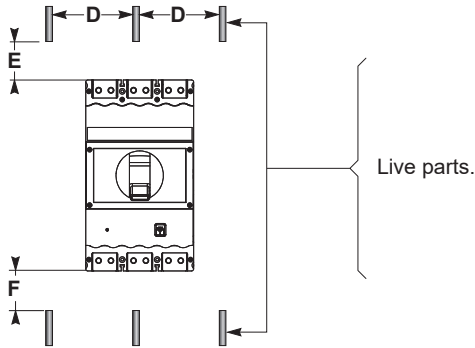

D ≤ 60 mm (2.36 in.)		D > 60 mm (2.36 in.)	
E	F	E	F
135 mm 5.31 in.	135 mm 5.31 in.	135 mm 5.31 in.	135 mm 5.31 in.

Insulating screen required between device and busbars.

## 5.2 Compression Busbar Clearance Distances

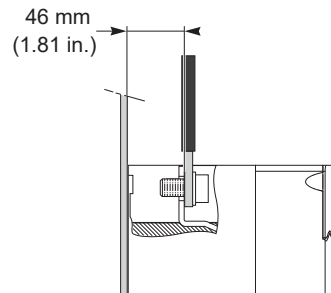

## 5.3 Minimum Clearance Distances Required

3P/4P

mm  
in.

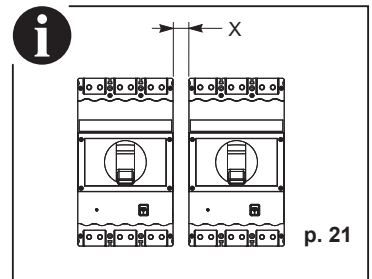
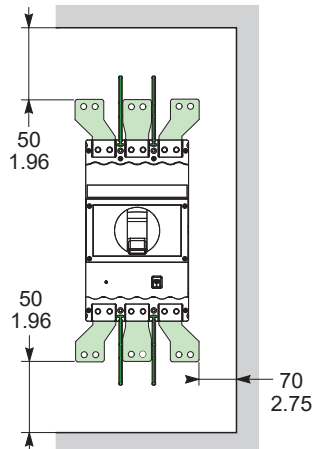
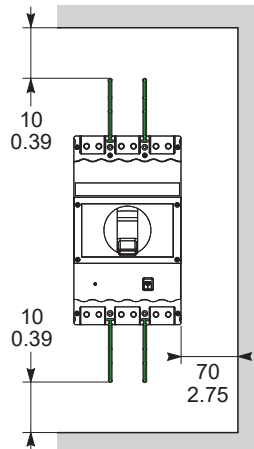
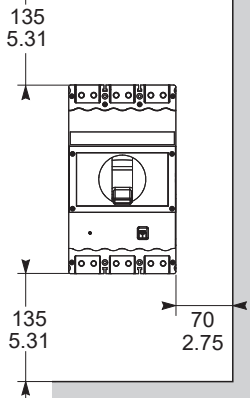

# 6 Installation

## 6.1 Mounting on Plate

**⚡ ⚠ DANGER**

**HAZARD OF ELECTRIC SHOCK, EXPLOSION OR ARC FLASH**

Install the MCCB using 4 mounting screws for 3P and 6 mounting screws for 4P to fix it firmly on the mounting plate.  
**Failure to follow these instructions will result in death or serious injury.**

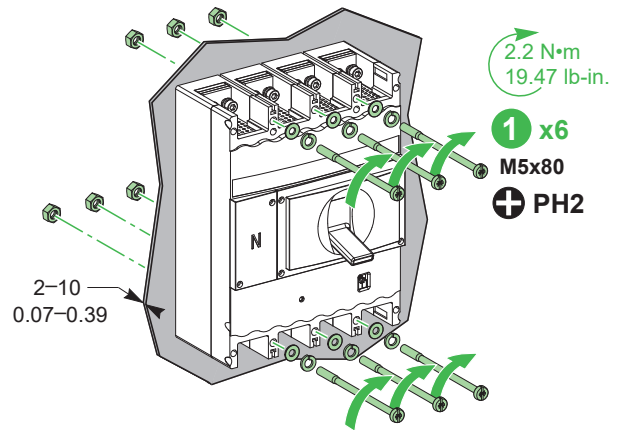
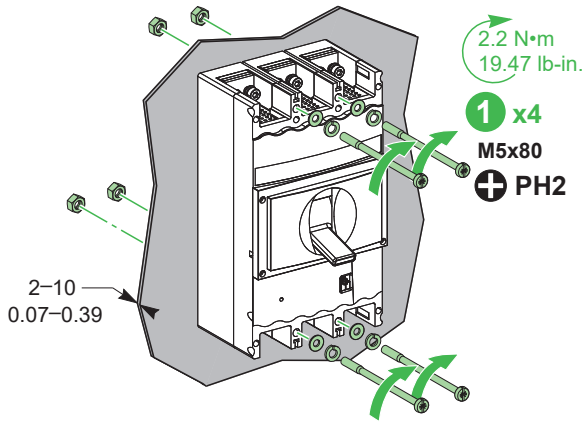
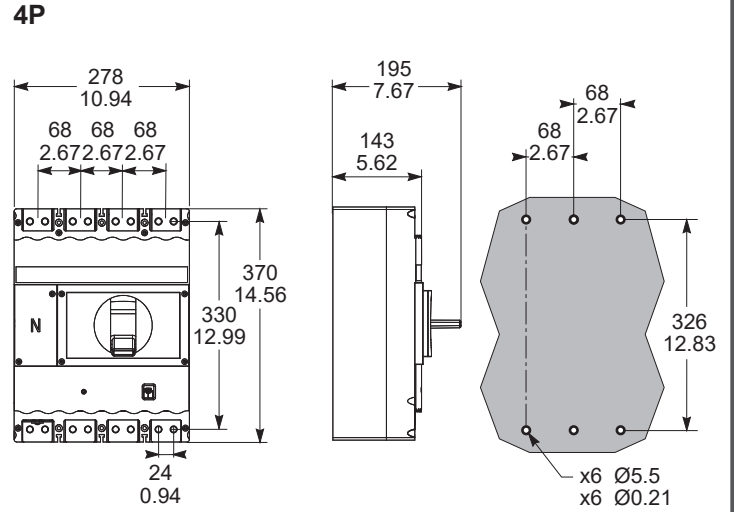
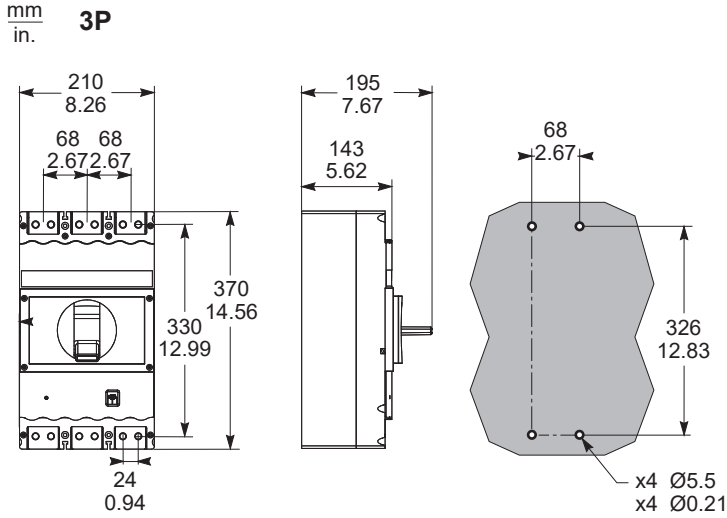

**i** 3P/4P

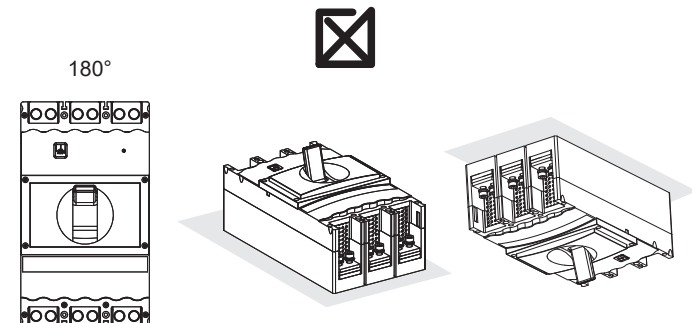
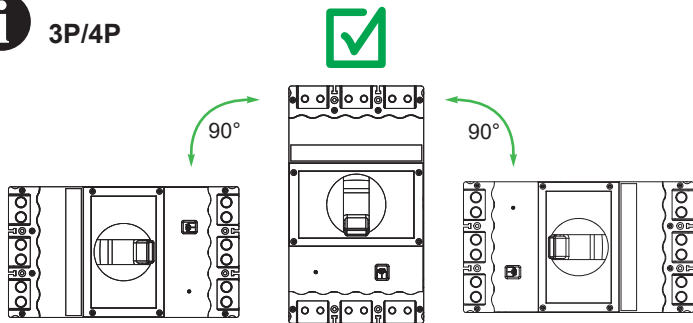

# 6 Installation

## 6.2 Door Cut-out

mm  
in.

3P

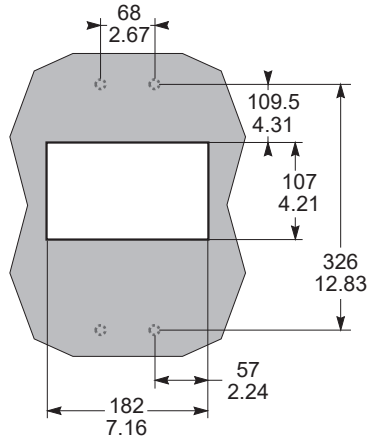
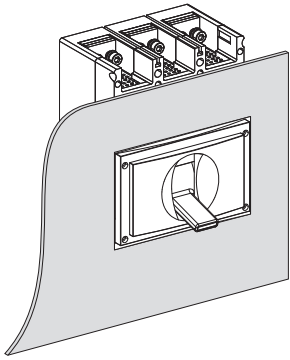

4P

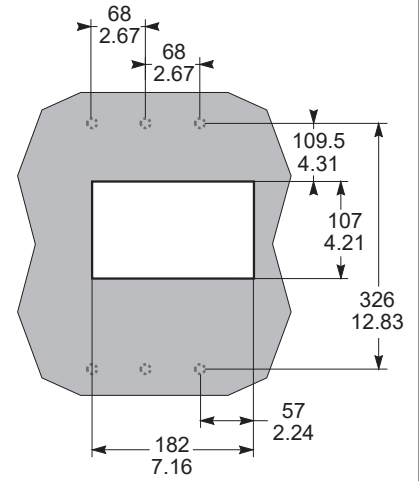
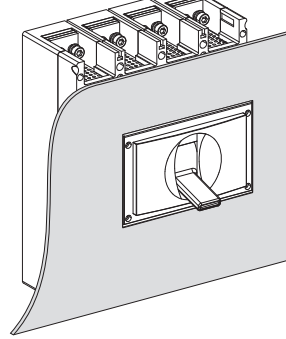

# 7 Wiring

### DANGER

#### HAZARD OF ELECTRIC SHOCK, EXPLOSION OR ARC FLASH

Install the insulation accessories like phase barriers and terminal shields to provide proper protection. These are provided in the packaging box.

**Failure to follow these instructions will result in death or serious injury.**

### WARNING

#### HAZARD OF FIRE

- Use only specified wiring cross-section with the equipment and comply with the specified wiring requirements.
- Tighten the connections to the specified torque values.

**Failure to follow these instructions can result in death, serious injury, or equipment damage.**

## 7.1 Compression Busbar

LV5082●●  
LV5102●●  
LV5122●●

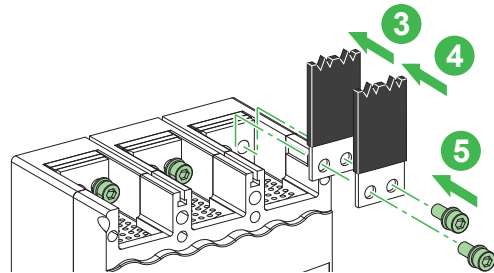
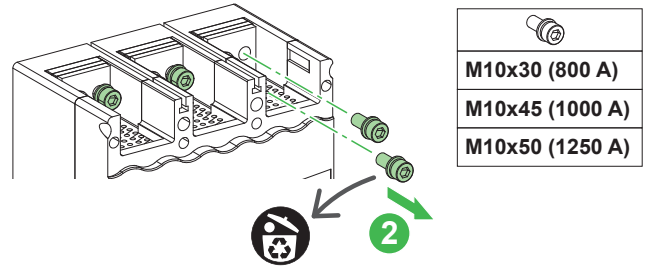
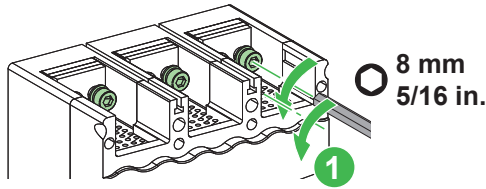
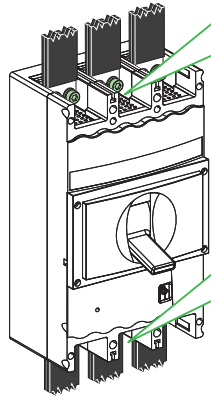

M10x50 (800 A)
M10x50 (1000 A)
M10x60 (1250 A)

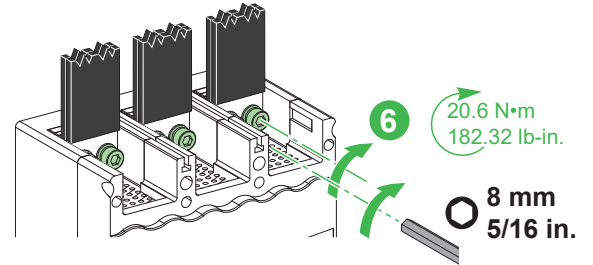

**i** mm  
in.

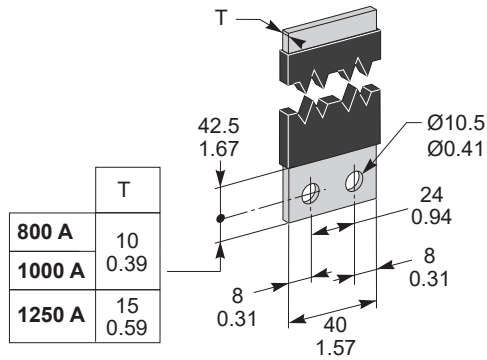

**i** 3P/4P

p. 21

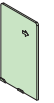

## 8 Connection Accessories

### ⚠ WARNING

#### HAZARD OF FIRE

- Use only specified wiring cross-section with the equipment and comply with the specified wiring requirements.
- Tighten the connections to the specified torque values.

Failure to follow these instructions can result in death, serious injury, or equipment damage.

## 8.1 Spreader link

**⚠ ⚠ DANGER**

**HAZARD OF ELECTRIC SHOCK, EXPLOSION OR ARC FLASH**

Install an insulation accessory to provide proper protection.

Failure to follow these instructions will result in death or serious injury.

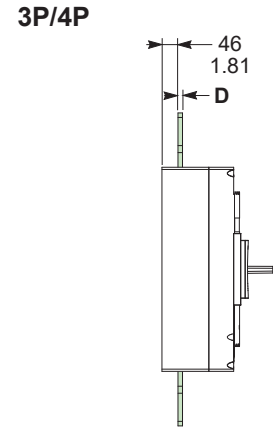
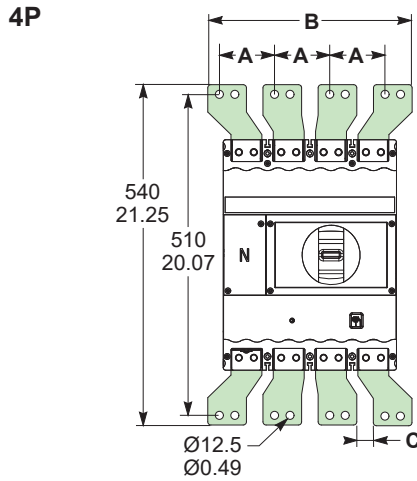
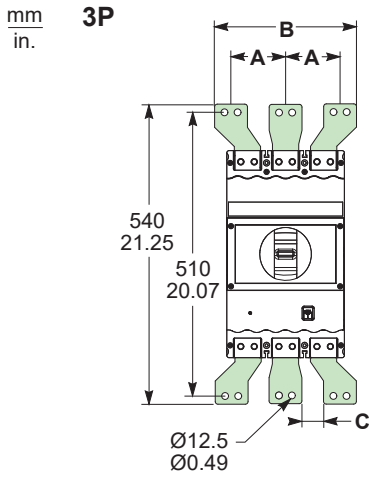

Type	A		B		C		D
	3P	4P	3P	4P	3P	4P	3P/4P
<b>800 A</b>	98 3.85	88 3.46	256 10.07	324 12.75	38 1.49	28 1.49	6 0.23
<b>1000 A</b>	98 3.85	88 3.46	256 10.07	324 12.75	38 1.49	28 1.49	12 0.47
<b>1250 A</b>	86 3.38	80 3.14	232 9.13	300 11.81	26 1.02	20 1.02	20 0.78

LV5082●●  
LV5102●●  
LV5122●●

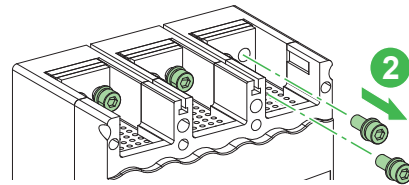
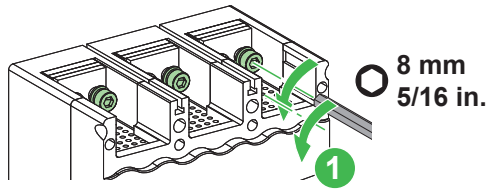
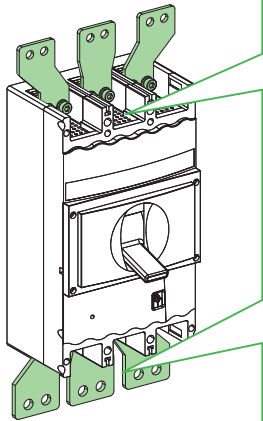

M10x30 (800 A)
M10x45 (1000 A)
M10x50 (1250 A)

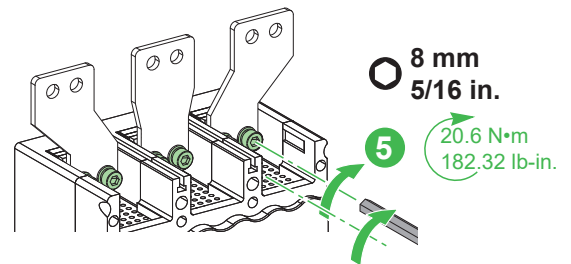
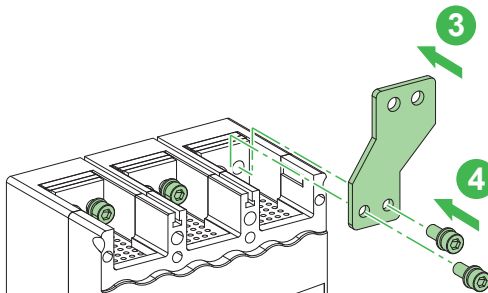

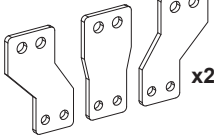
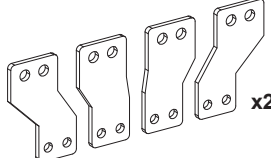
	x2		x2	
<b>800 A</b>	LV508530	<b>3P</b>	LV508540	<b>4P</b>
<b>1000 A</b>	LV510530	<b>3P</b>	LV510540	<b>4P</b>
<b>1250 A</b>	LV512530	<b>3P</b>	LV512540	<b>4P</b>

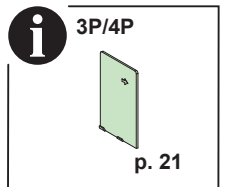

## 8.1 Spreader link



mm  
in.

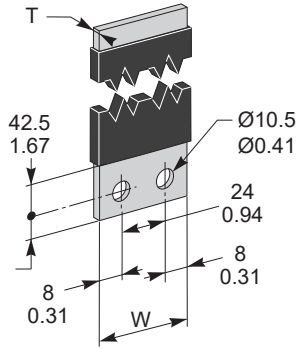
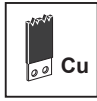

	T	W
800 A	5	50
	0.19	1.97
1000 A		60
		2.36
1250 A	10	40
	0.39	1.57

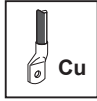
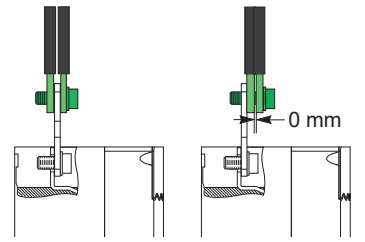
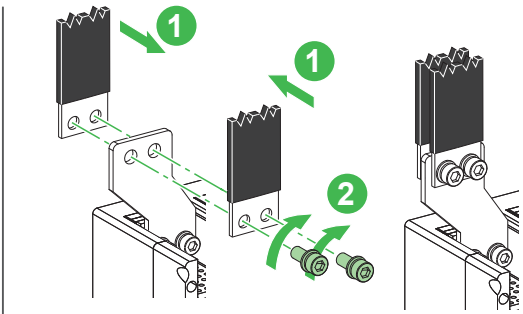

mm  
in.

800 A

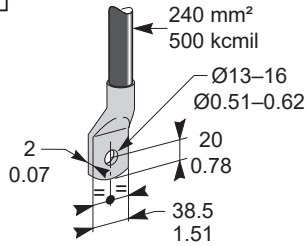

800 A	
1000 A	
1250 A	

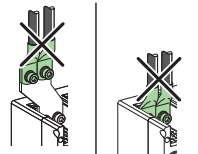
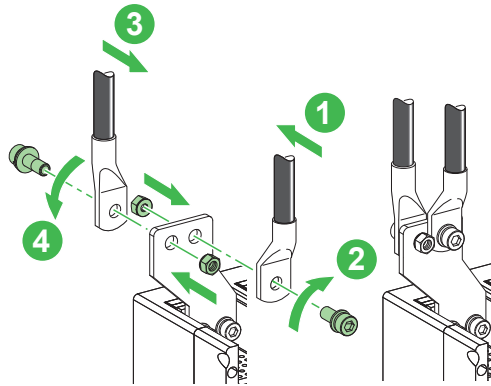

## 8.2 Extended Rotary handle

mm  
in.

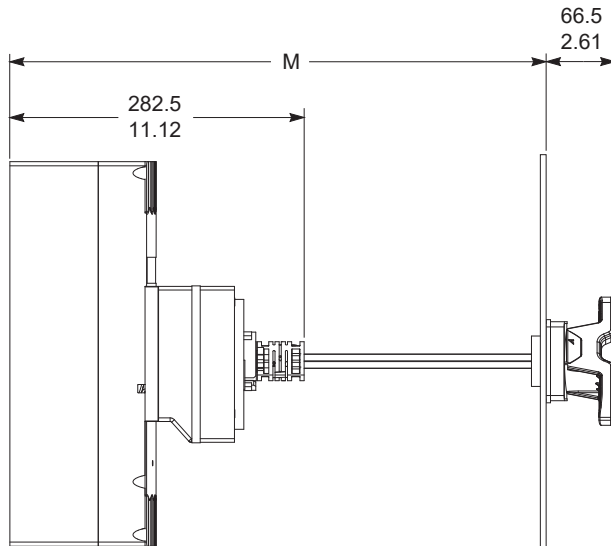
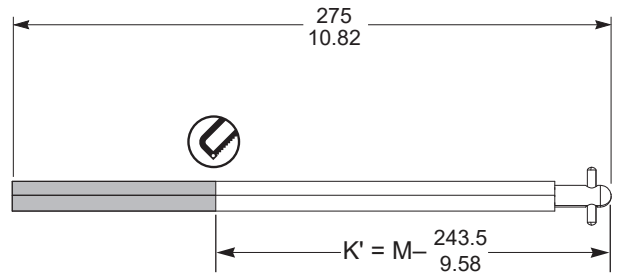
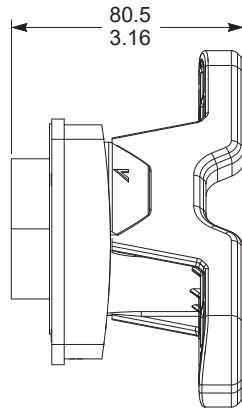
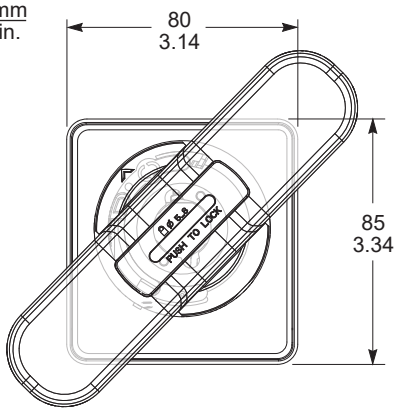

M (Minimum)	306.5 12.06
M (Maximum)	518.5 20.41

## 8.2 Extended Rotary handle

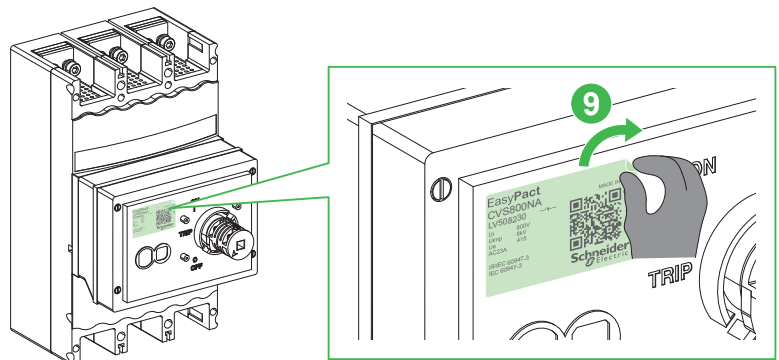
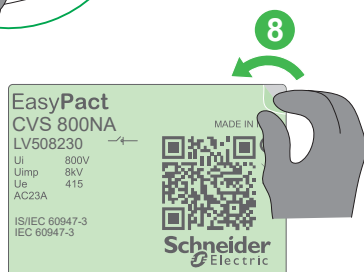
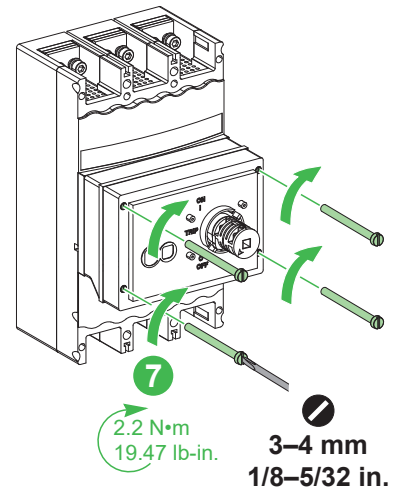
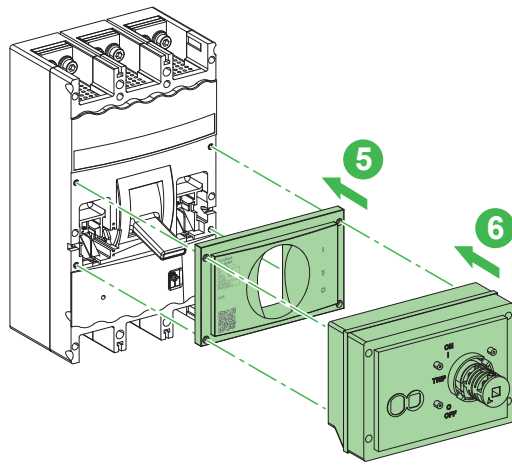
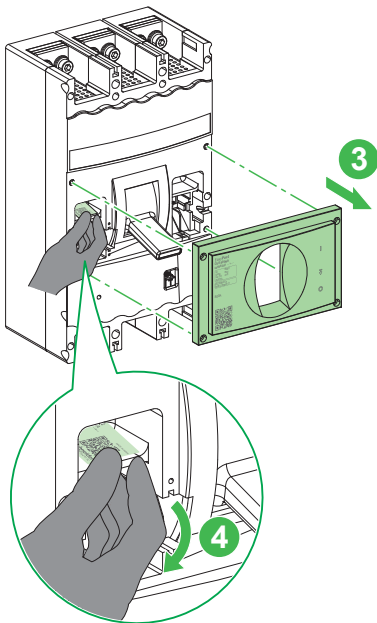
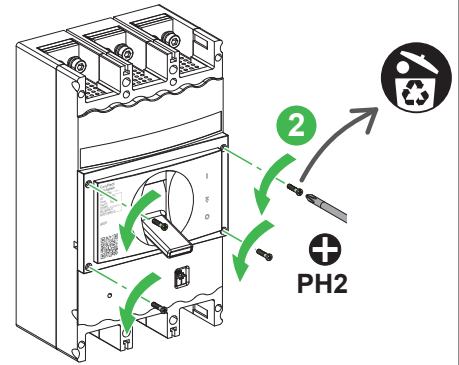
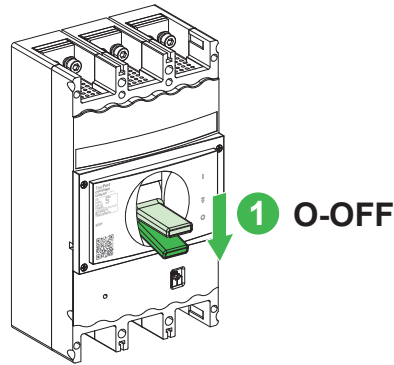
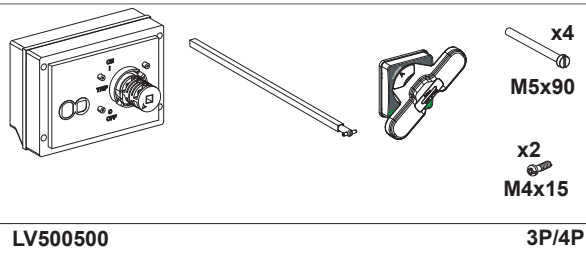
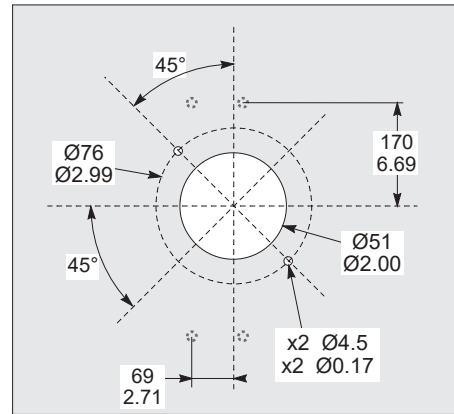
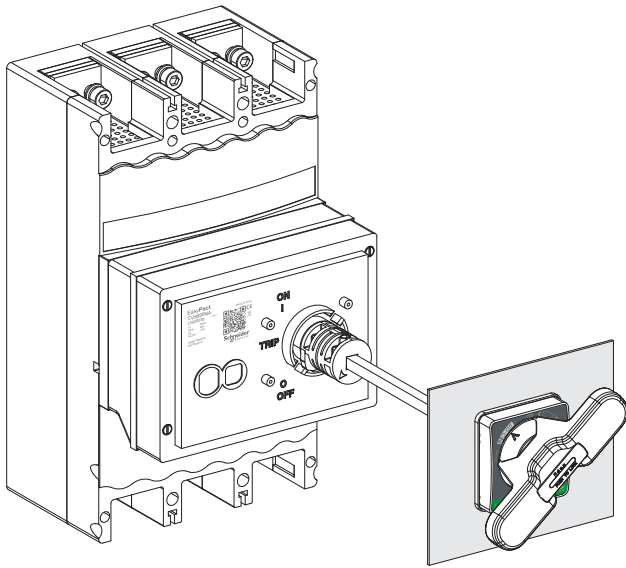

## 8.2 Extended Rotary handle

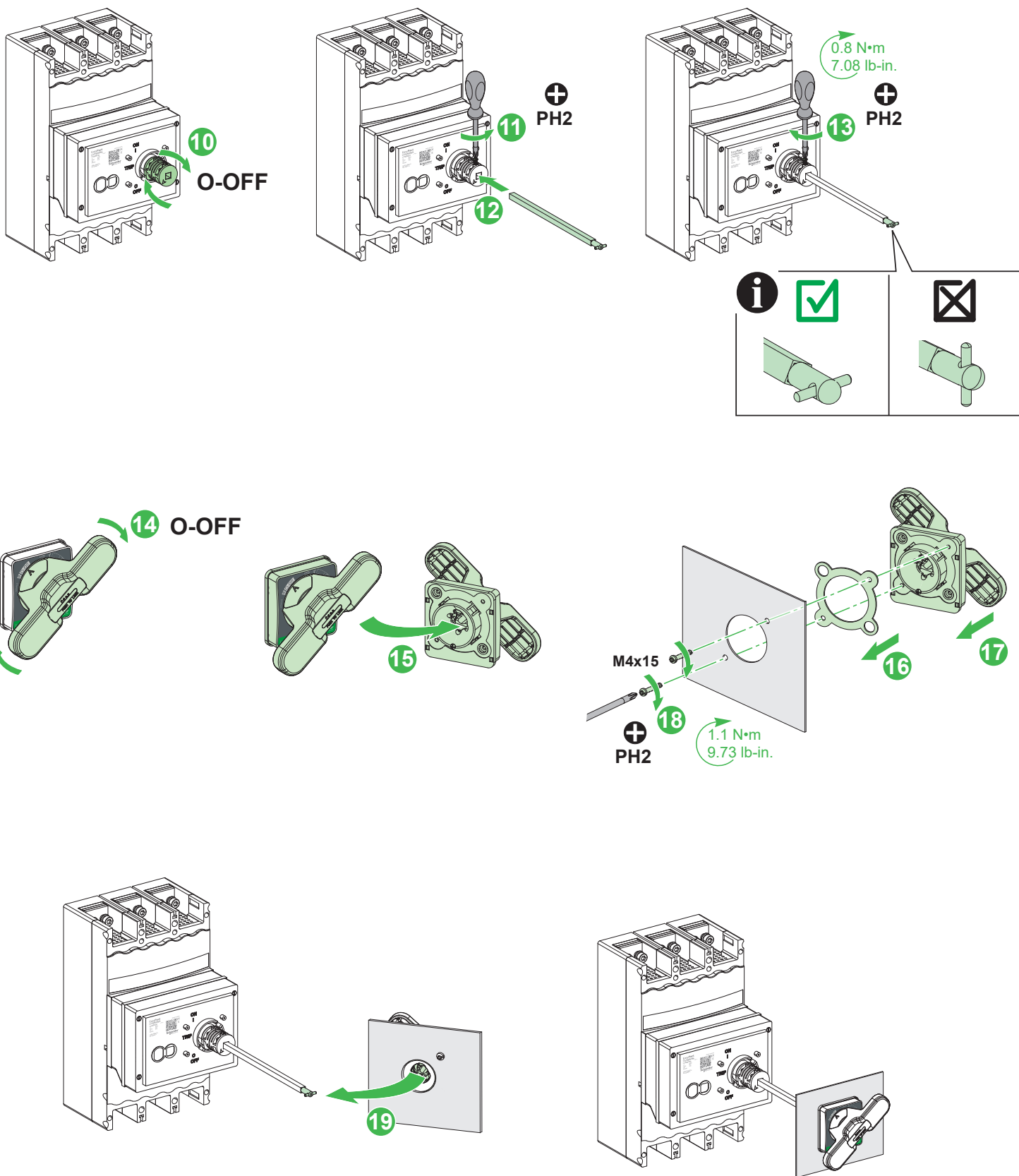

## 8.2 Extended Rotary handle

### 8.2.1 Door Defeat features

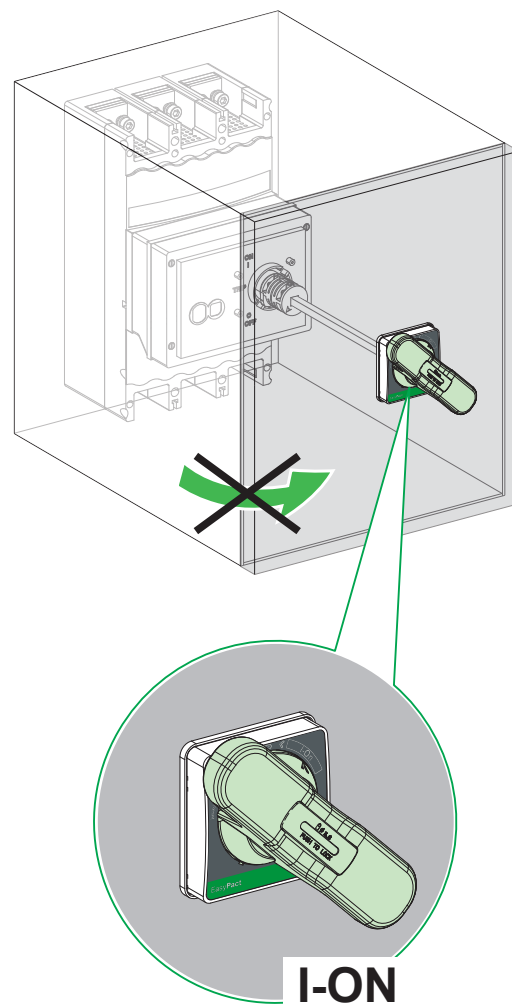
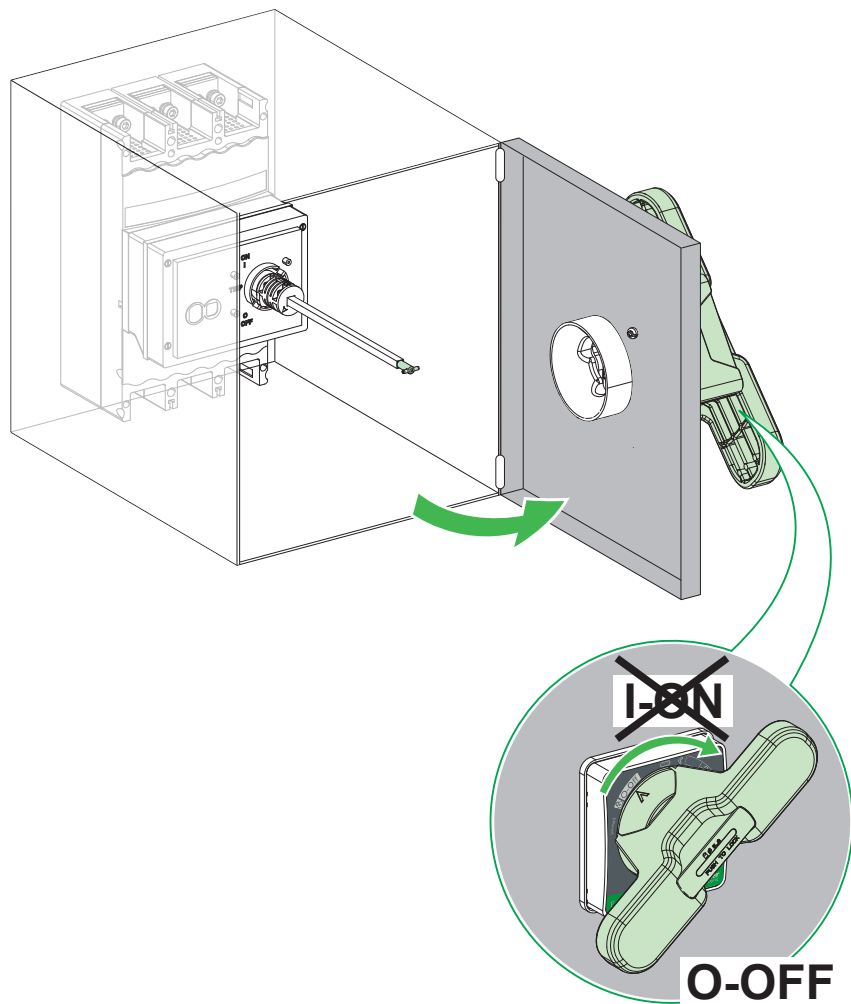

#### Tool Defeat

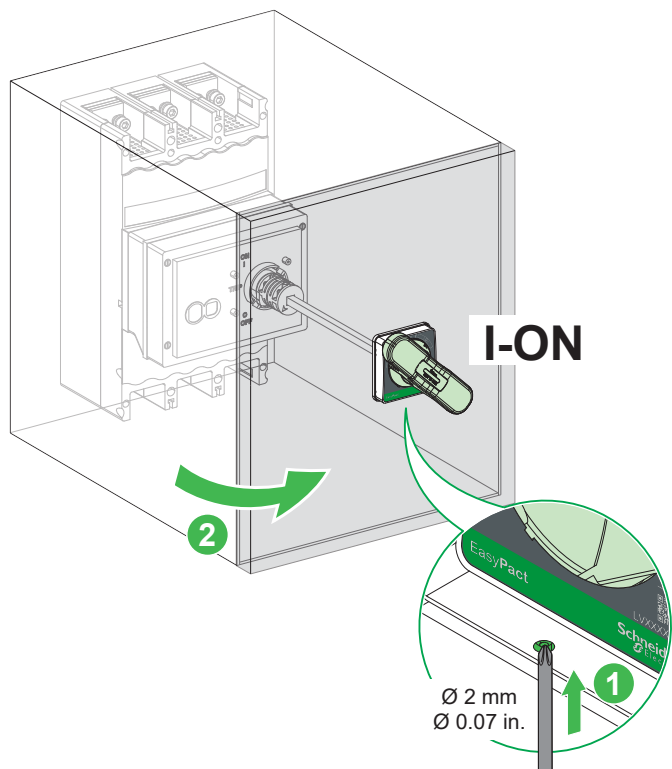

#### Auto Restoration

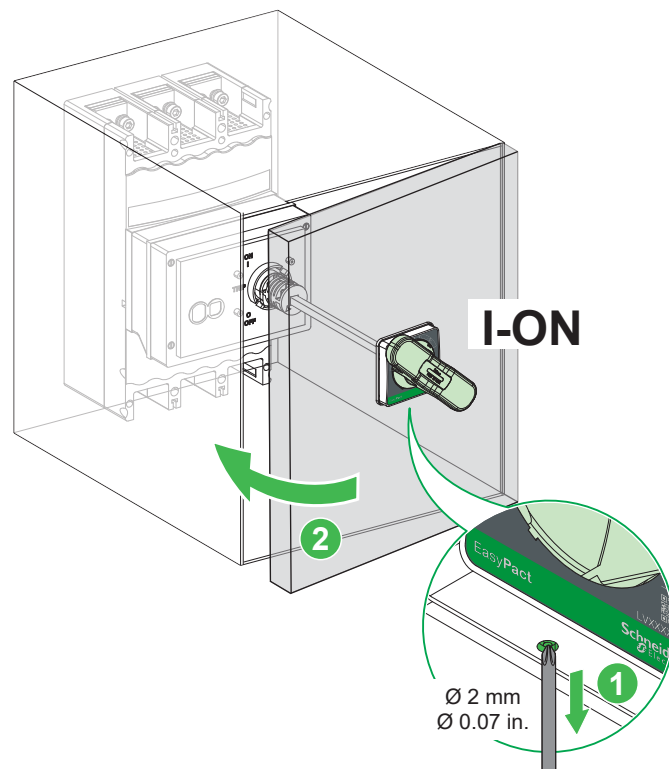

**⚠ CAUTION**

**HAZARD OF EQUIPMENT DAMAGE**

Do not pull the lead-wires while handling or removal.

Failure to follow these instructions can result in injury or equipment damage.

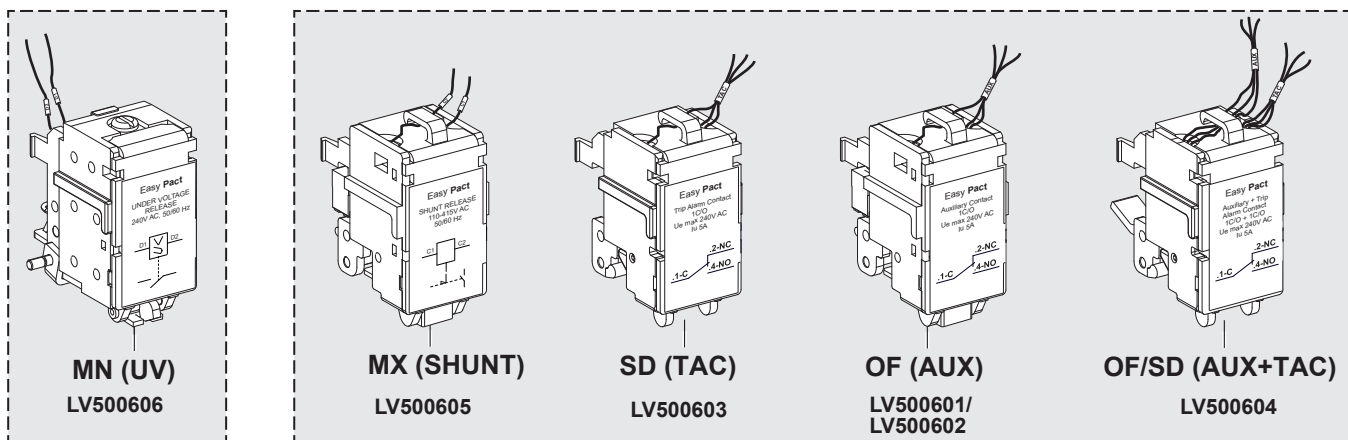

3P / 4P

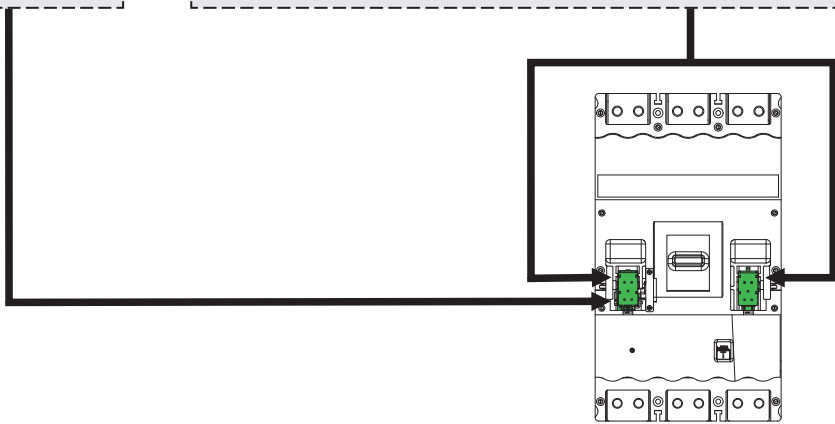

3P/4P

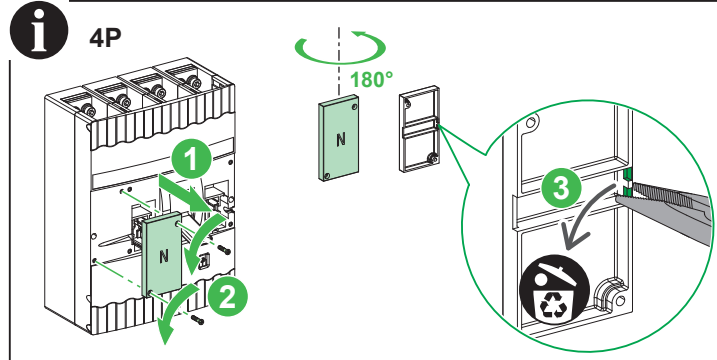
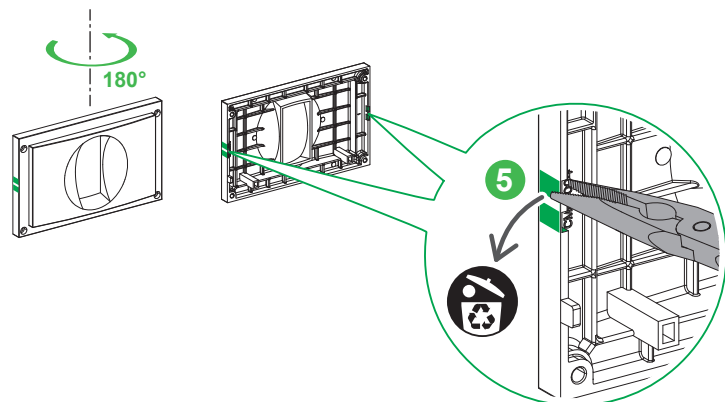
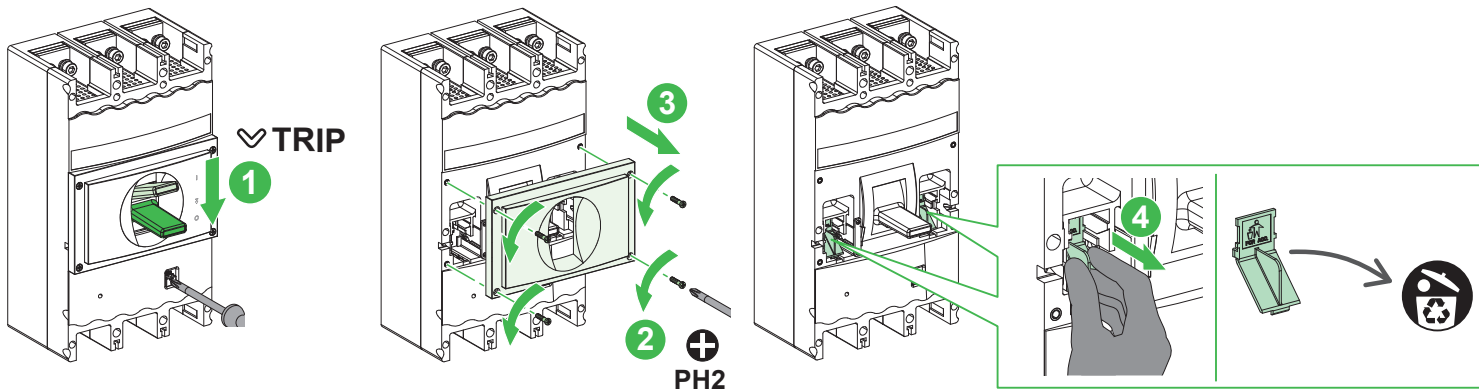

8.3 Electrical auxiliary contact (OF/SD) and Voltage release (MN) or Shunt trip (MX) with pre-wired termination

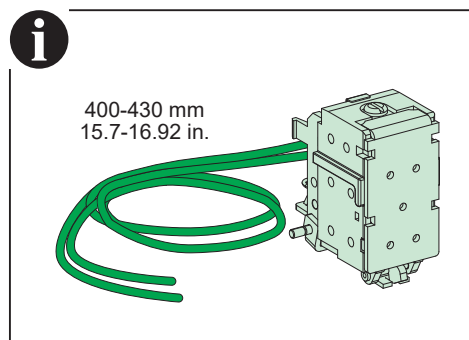
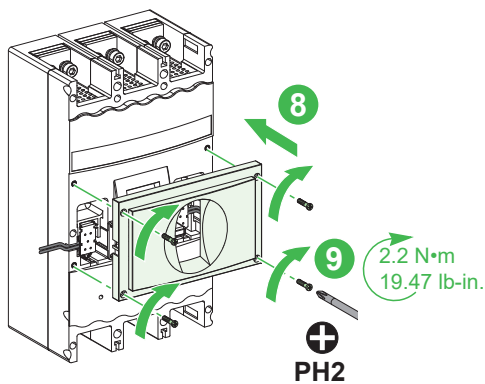
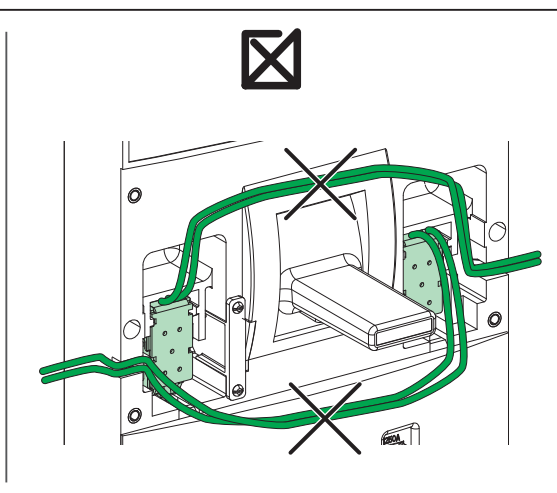
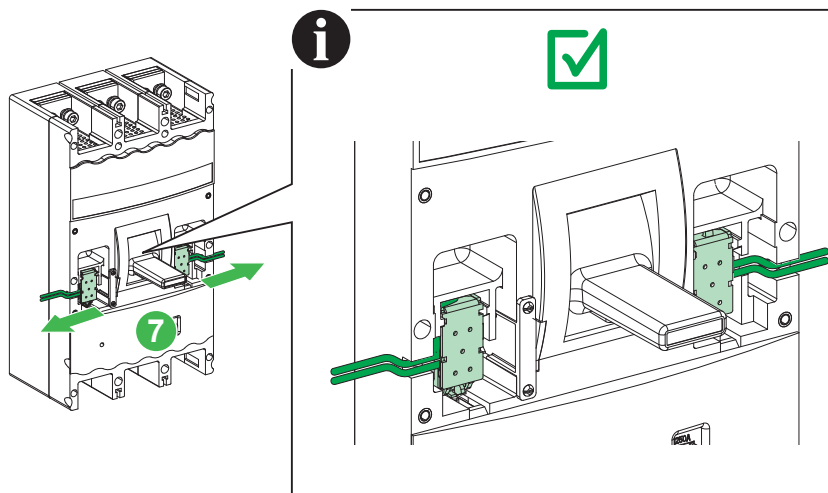
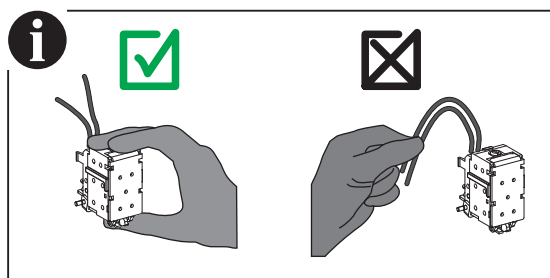
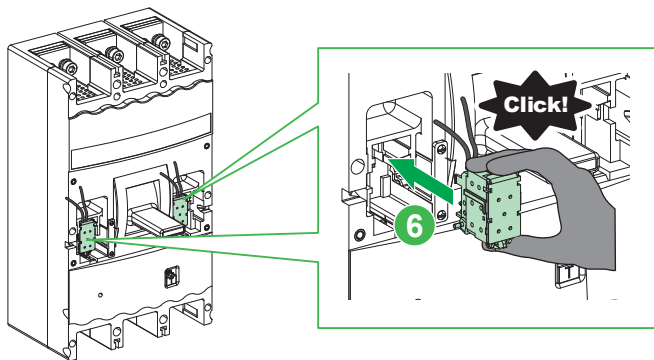

**i** 4P

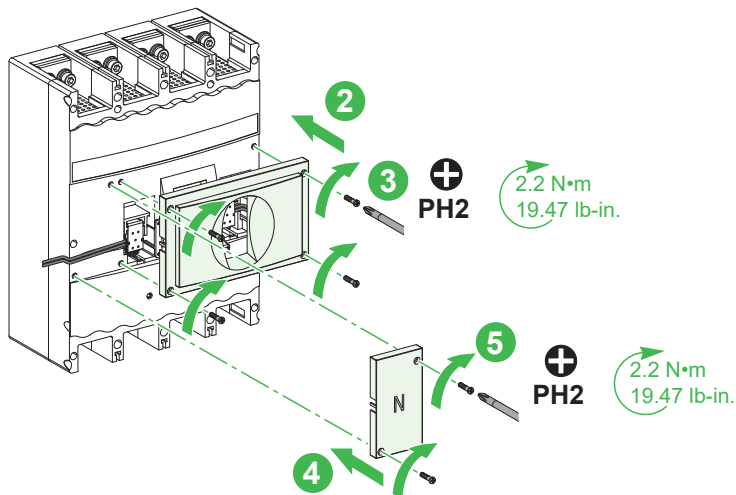
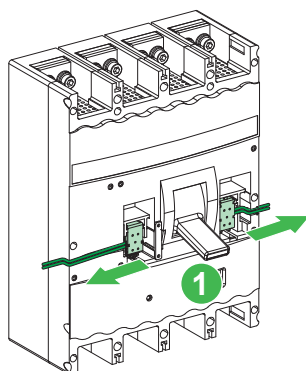

### 8.3 Electrical auxiliary contact (OF/SD) and Voltage release (MN) or Shunt trip (MX) with pre-wired termination

#### 8.3.1 Removal

3P/4P

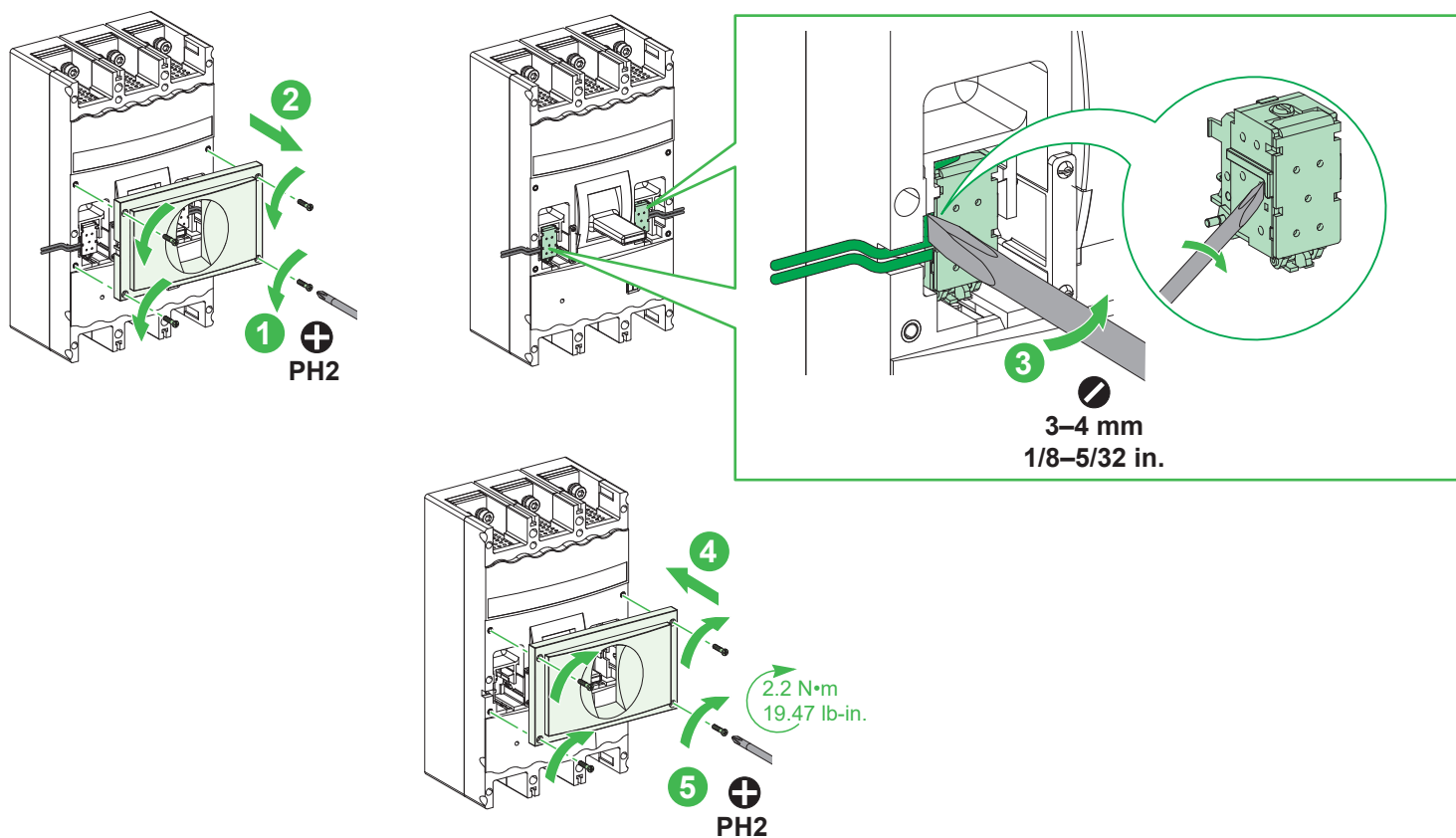

### 8.4 External Neutral CT with Adaptor kit

mm  
in.

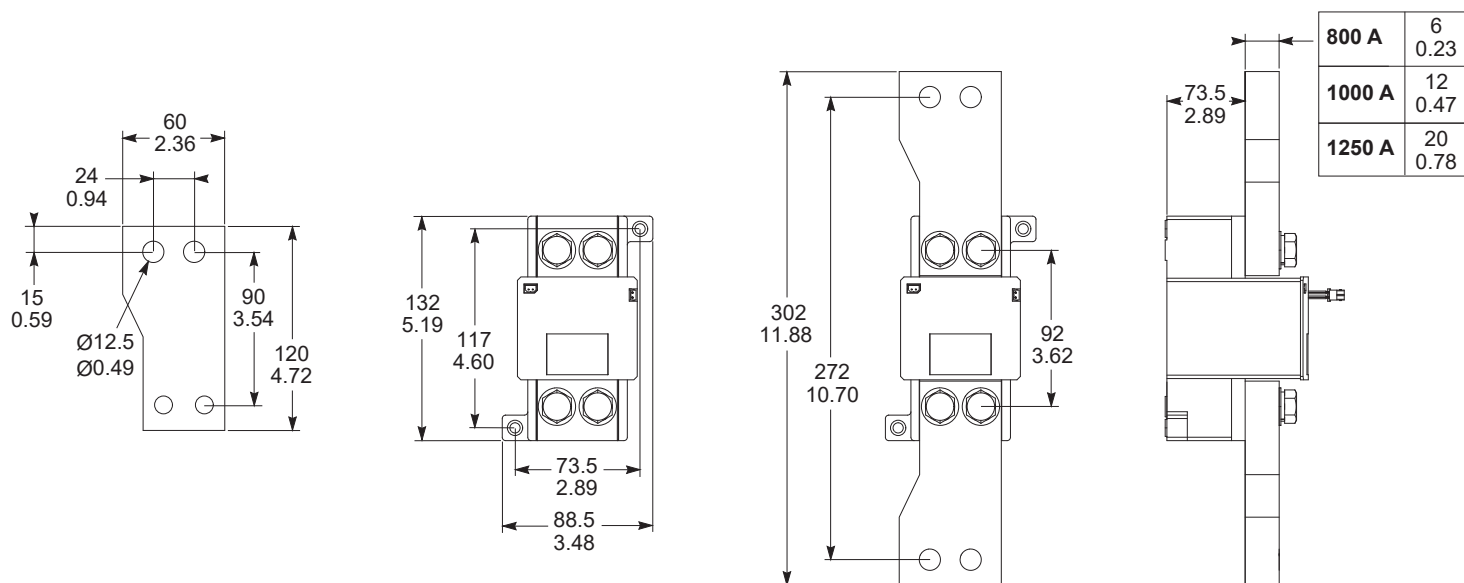

## 8.4 External Neutral CT with Adaptor kit

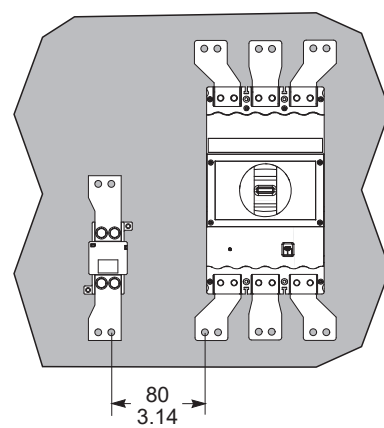
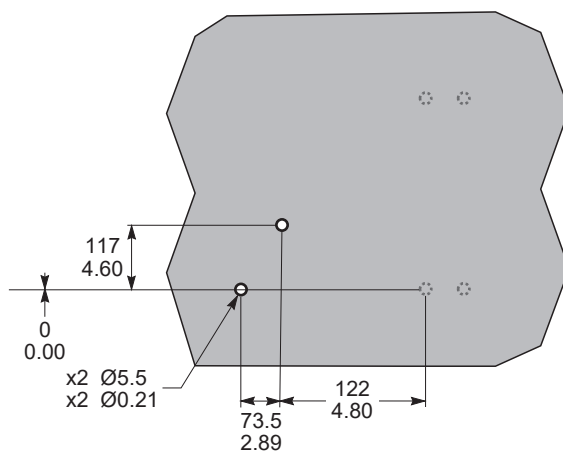
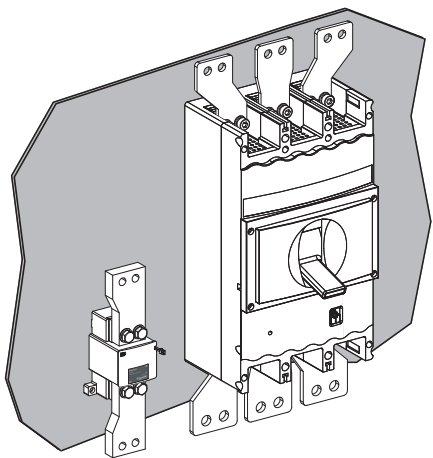

### ⚠ CAUTION

#### HAZARD OF EQUIPMENT DAMAGE

Do not pull the lead-wires while handling or removal.

Failure to follow these instructions can result in injury or equipment damage.

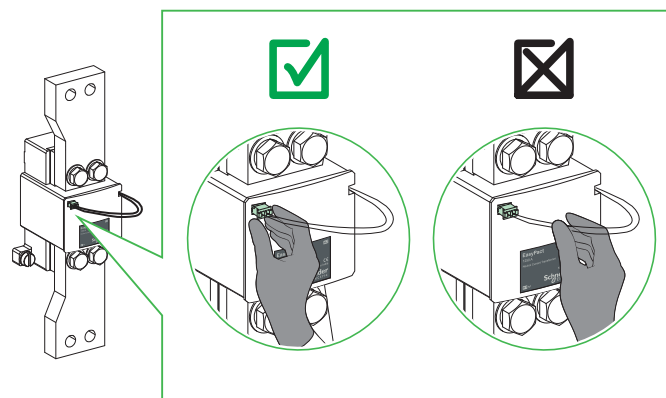
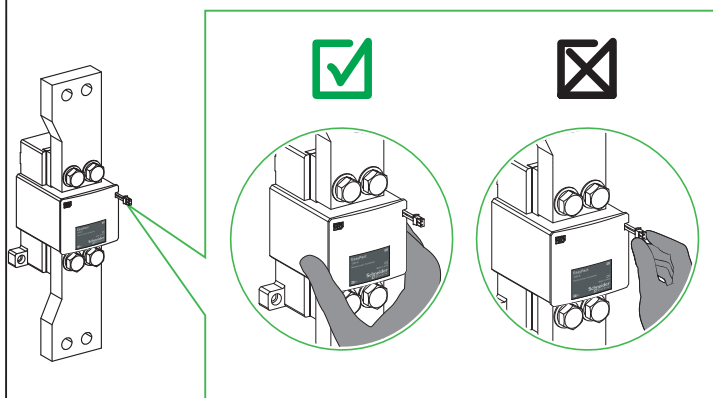

LV508560  
LV510560  
LV512560

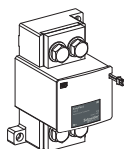

x2  
M5x16

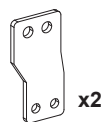

x2  
LV508570

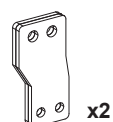

x2  
LV510570

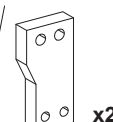

x2  
LV512570

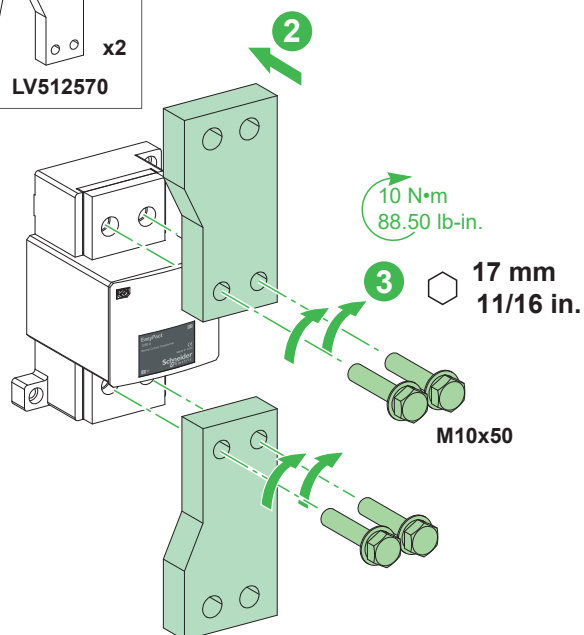
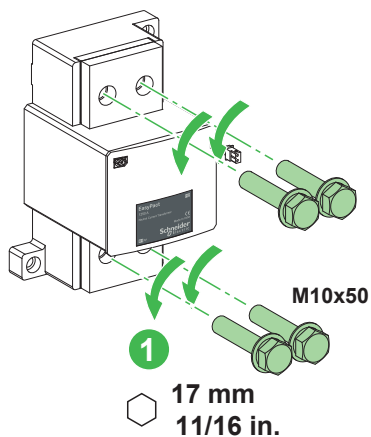

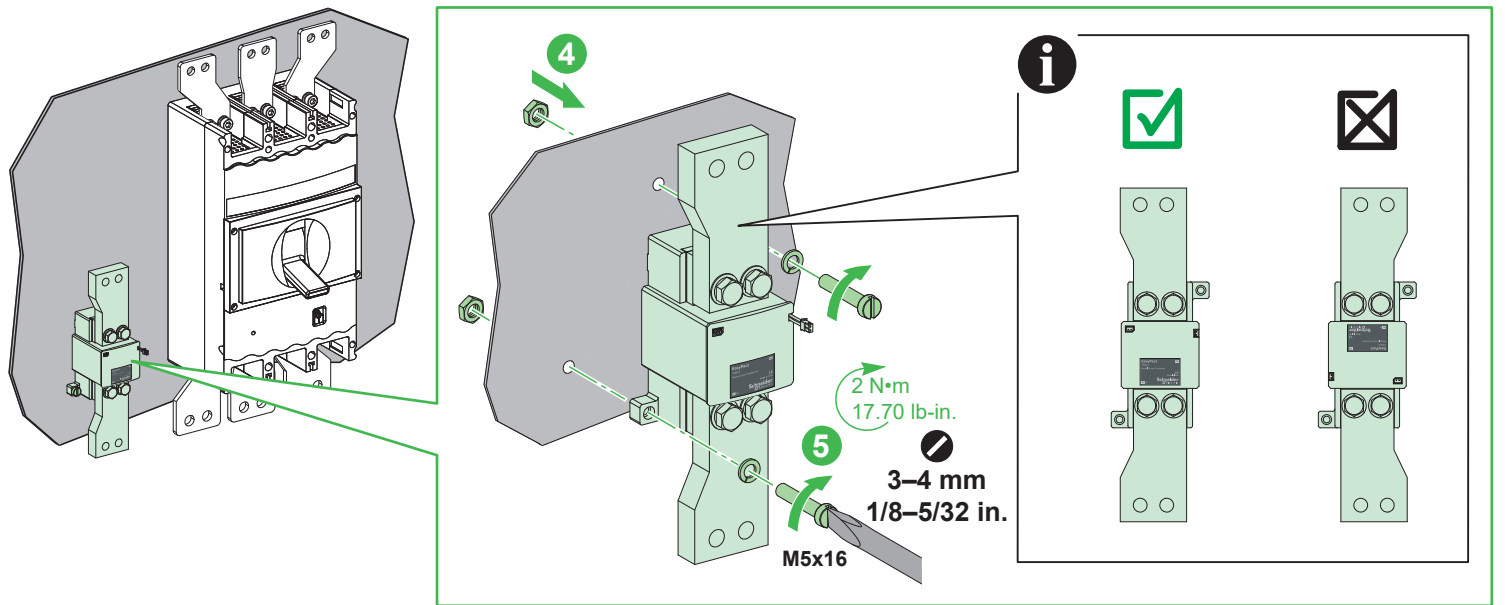

#### 8.4 External Neutral CT with Adaptor kit

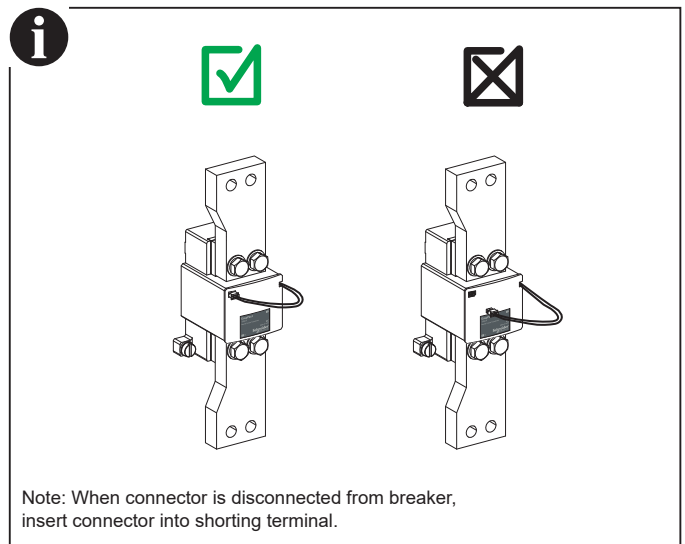
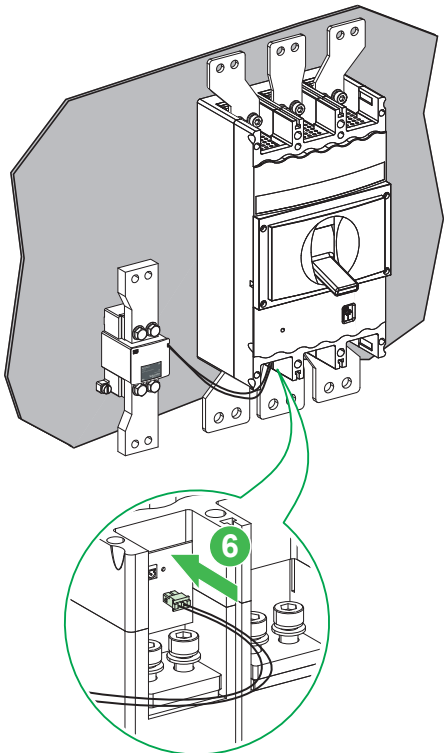
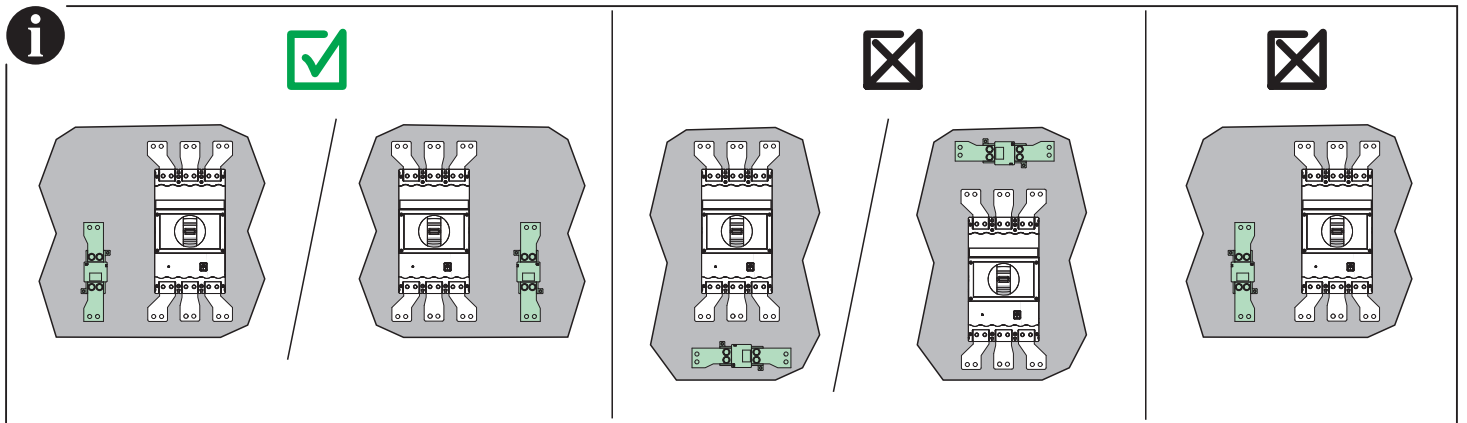

# 9 Insulation Accessories

**⚠ ⚠ DANGER**

**HAZARD OF ELECTRIC SHOCK, EXPLOSION OR ARC FLASH**

Install the insulation accessories like phase barriers and terminal shields to provide proper protection. These are provided in the packaging box.  
**Failure to follow these instructions will result in death or serious injury.**

## 9.1 Interphase Barriers

**⚠ WARNING**

**HAZARD OF FLASHOVER BETWEEN PHASES**

Install the mandatory Interphase barrier to provide the insulation between the phases.  
**Failure to follow these instructions can result in death, serious injury, or equipment damage.**

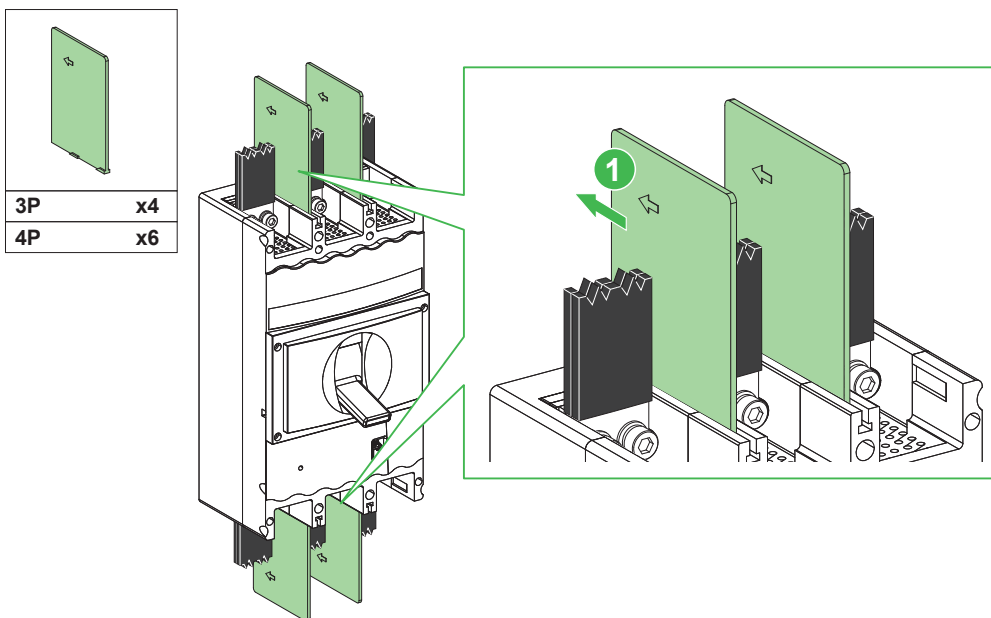

3P	x4
4P	x6

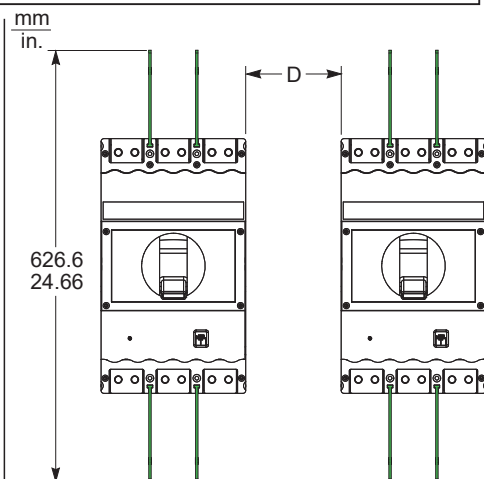

MCCBs	D
4P – 4P	≥61 ≥2.40
3P – 3P	≥47 ≥1.85
3P – 4P	≥54 ≥2.12

## 9.2 Terminal Shields

**⚠ ⚠ DANGER**

**HAZARD OF ELECTRIC SHOCK, EXPLOSION OR ARC FLASH**

Terminal shields are mandatory for IP40 operation when it is open door.  
**Failure to follow these instructions will result in death or serious injury.**

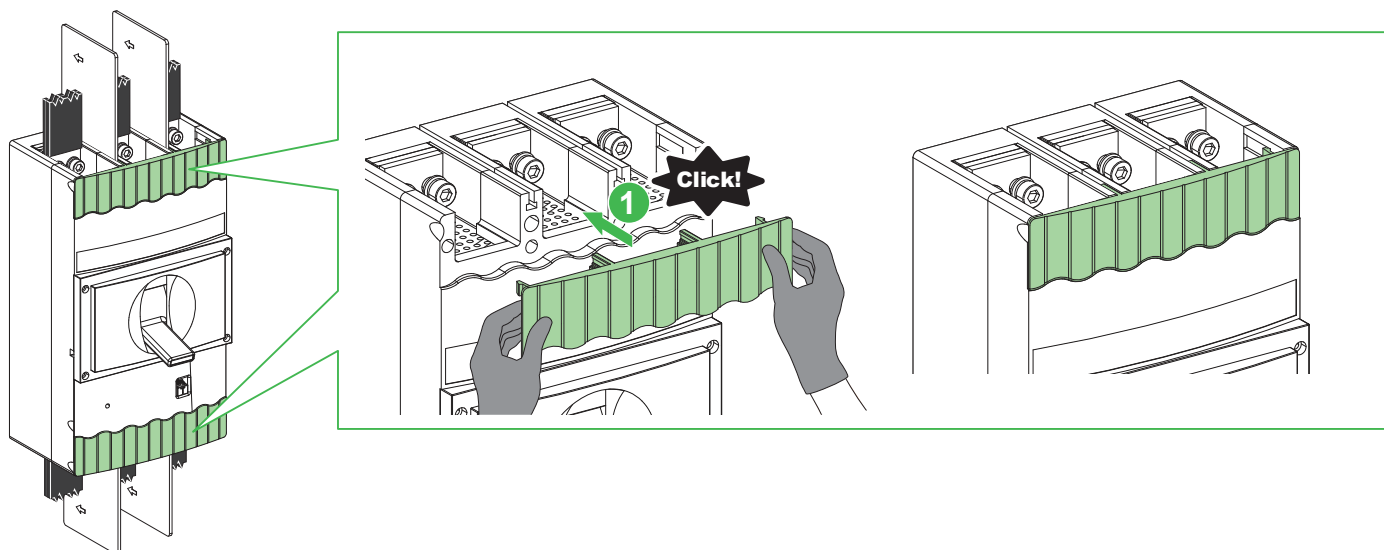

# 10 Trip Unit Adjustment

## Switch Disconnector (SD)

LV5082●●

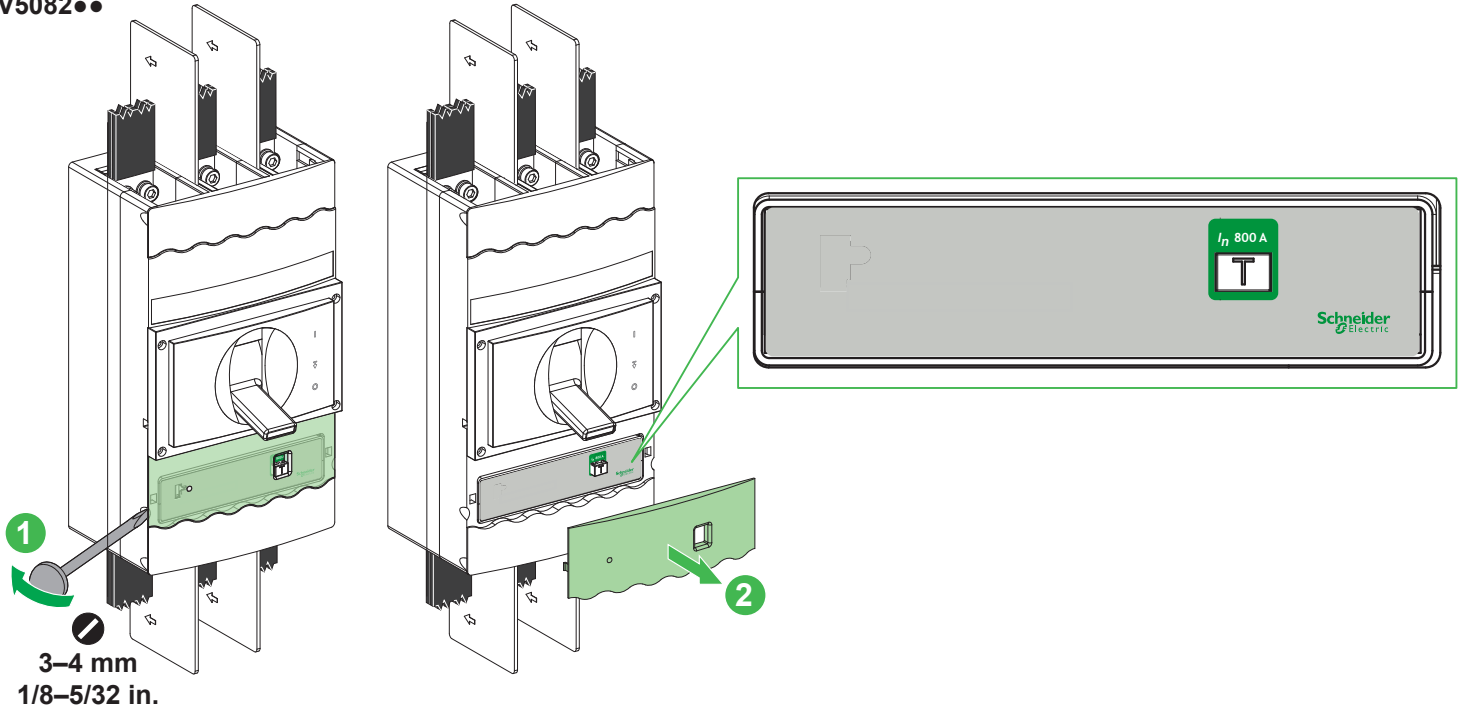

Note: For Switch Disconnector no adjustment of release settings is required.

### ⚠ WARNING

#### HAZARD OF NUISANCE TRIPPING OR FAILURE TO TRIP

- EasyPact MCCBs are provided with maximum trip unit settings from the factory. The trip unit settings should be modified according to the electrical installation characteristics and local safety rules and regulations.
  - Protection setting adjustments must be done by qualified electrical personnel.
- Failure to follow these instructions can result in death, serious injury, or equipment damage.

## Electronic Trip Unit (ETS 2)

LV5102●●

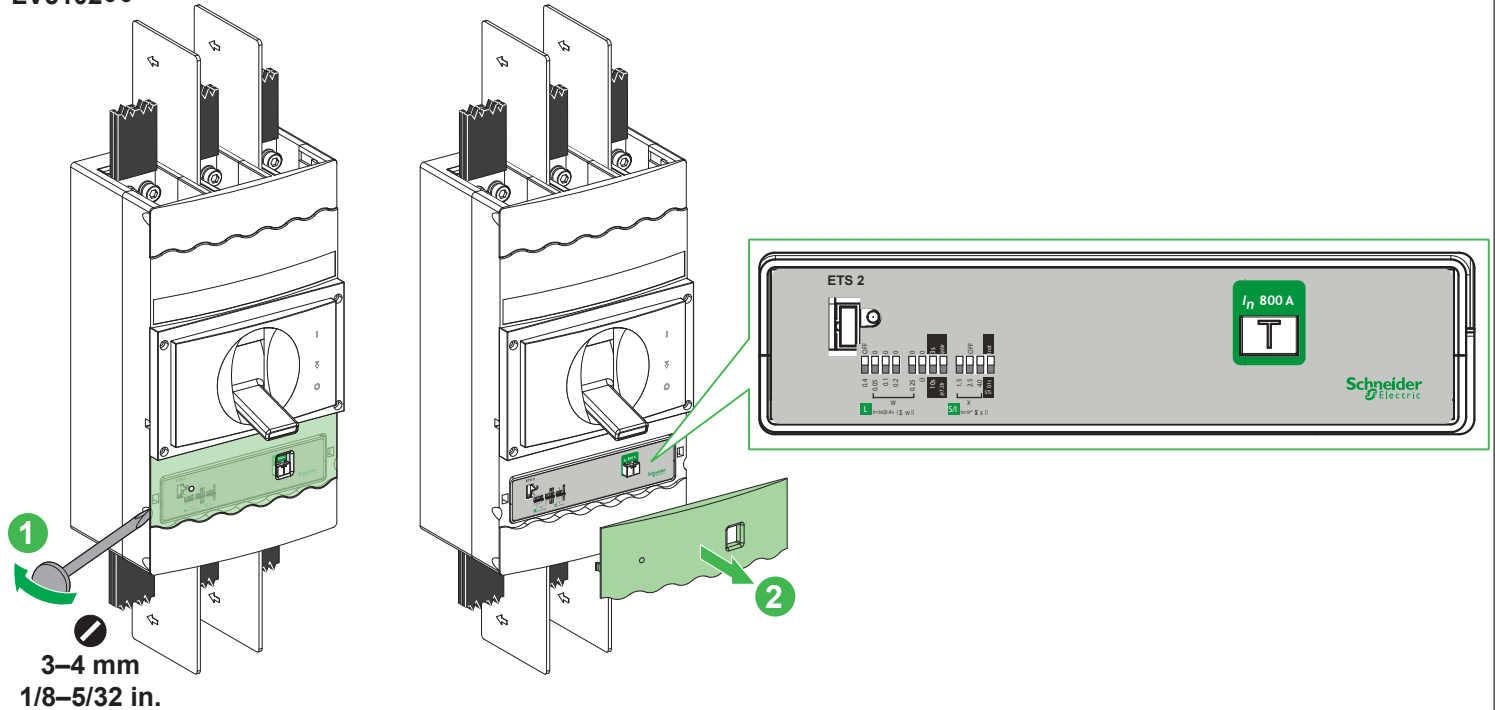

# Electronic Trip Unit (ETS 6)

LV5122●●

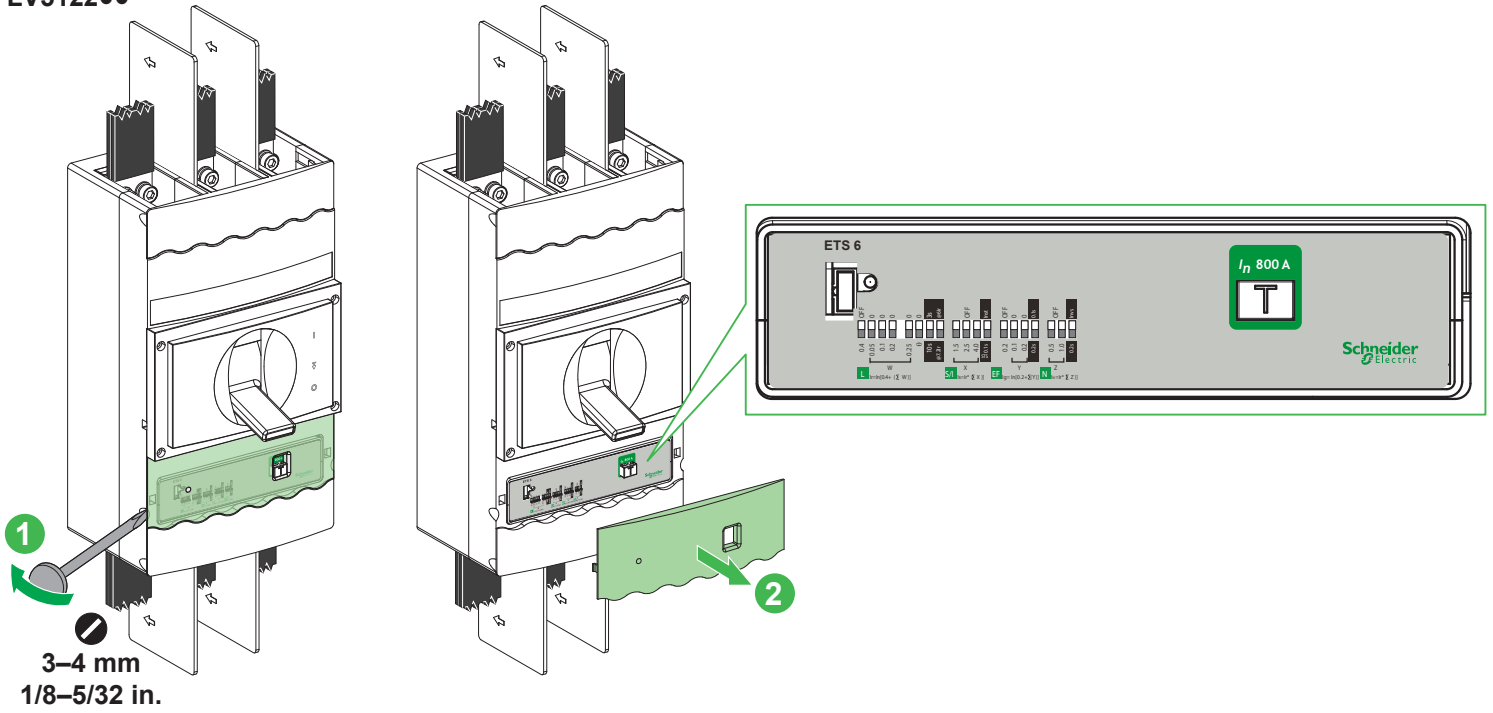

3-4 mm  
1/8-5/32 in.

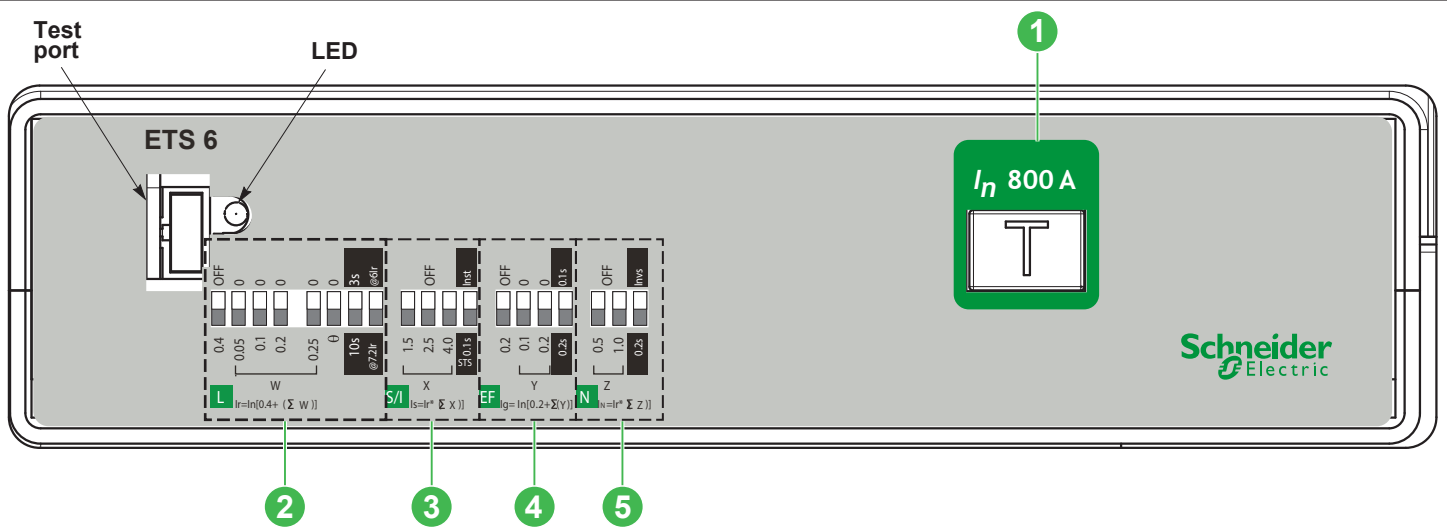

When either LTS (Ir) setting or Earth Fault (I<sub>g</sub>) setting are set to OFF the respective protection is defeated.

**LED** indication:  
Power up : 0.3 I<sub>n</sub>  
Alarm : 0.85 I<sub>r</sub>  
Pick up : 1.15 I<sub>r</sub>

**I<sub>n</sub>** : Normal Current  
**I<sub>r</sub>** : Overload Current  
**I<sub>s</sub>** : Short circuit Current  
**I<sub>g</sub>** : Earth fault Current  
**I<sub>N</sub>** : Neutral Current

## LTS Setting

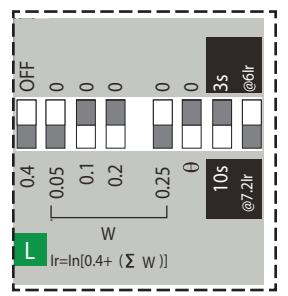
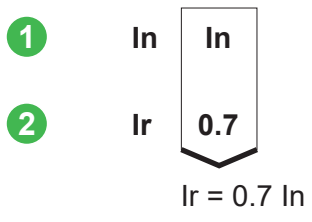

θ denotes Thermal Memory.

## Earth fault setting

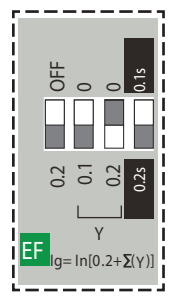
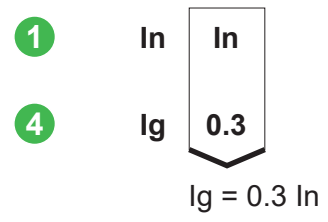

I<sub>g</sub> (xI<sub>n</sub>): 0.20 to 0.5 I<sub>n</sub>  
Delay: 0.1s & 0.2s

Note: Earth fault setting not applicable to Electronic Trip Unit (ETS 2).

## STS Setting

3

Is

4.0

$$I_s = 0.7 I_n \times 4 = 2.8 I_n$$

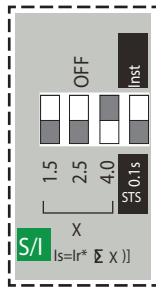

I<sub>r</sub> (%I<sub>n</sub>): 0.4 to 1 I<sub>n</sub> in steps of 5%

4 user selectable curves:

6I<sub>r</sub> @10s, 6I<sub>r</sub> @3s,

7.2I<sub>r</sub> @10s, 7.2I<sub>r</sub> @3s

I<sub>s</sub> (xI<sub>r</sub>): 1.5, 2.5, 4, 5.5, 6.5, 8 I<sub>r</sub>

Delay: 0.1s

Inst: Instantaneous Setting

## Neutral setting

1

In

In

2

I<sub>r</sub>

0.7

$$I_r = 0.7 I_n$$

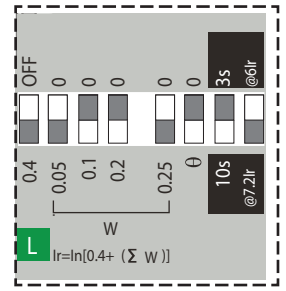

θ denotes Thermal Memory.

5

IN

1.5

$$I_N = 0.7 I_n \times 1.5 = 1.05 I_n$$

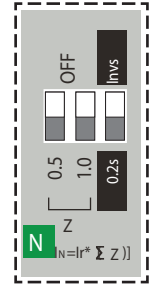

I<sub>N</sub> (x I<sub>r</sub>): 0.5, 1.0, 1.5 I<sub>r</sub>  
when Invs ON follows LTS curves  
Delay: 0.2s

$I_r \leq 0.7 I_n$  for 1.5 Neutral setting  
with Invs enabled

Note: Neutral setting not applicable to Electronic Trip Unit (ETS 2).

# 11

## Handling

**⚠️ DANGER**

### HAZARD OF DEVICE FALLING

- Be sure lifting equipment has lifting capacity for the device being lifted.
- Wear hard hat, safety shoes and heavy gloves.

Failure to follow these instructions will result in death or serious injury.

3P

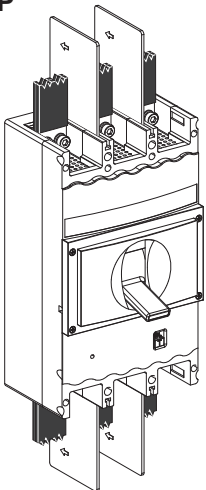

18.9 kg  
41.66 lbs

4P

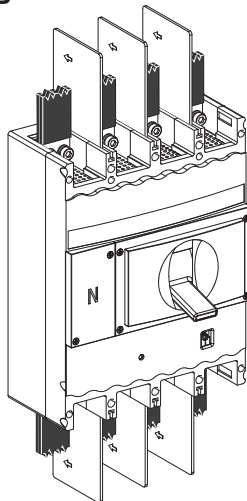

22.3 kg  
49.16 lbs

