

Connecting Schneider Charge to your monitoring APP

The Schneider Charge is more than an EV charger

for single family homes it is a complete solution with remote monitoring and an anti-tripping module for load balancing: fast installation, robust and embedded connectivity all backed by Schneider Electric's product design and after sales service.

Reduce your costs and provide benefits to:



The Homeowner:

- Robust and aesthetic design
- Extensive range of products



The Installer:

- Installed in 5 min
- 3 wiring entries (back, top, bottom)
- Intuitive commissioning thanks to eSetup App

End-to-end solution



+ Open to other applications ...



Charging station

Schneider Charge

- T2S socket up to 22kW, combined 1P/3P
- Attached cable up to 11 kW 3 P
- IP55 and IK10
- Bottom, top, or rear entry wiring
- Colored LED for status indication



Load balancing

Schneider Charge anti-tripping module

- Auto-regulates the energy consumption of the charging station to avoid exceeding the available power either from the grid or from self generated sources like PV, wind or energy storage:
- 1-phase or 3-phase devices
 - Simple power setting and charging station pairing
 - Power Line Communication



Monitoring and control at your fingertips

Core EV charging features

- Automatic start
- Recurring scheduling
- Charging session monitoring
- Charging history

Additional features depending on the APP:

- cost optimization
- billing
- remote control
- load shedding, and much more...



A solution compliant to standards

- OCPP 1.6J protocol enables to integrate third party applications that pass Schneider Electric test for validation
- Data privacy (GDPR) and cybersecurity recommendations



Schneider Electric support

- Advice on the solution from your local Schneider Electric contact
- Local and global after-sales services



eSetup

- Commissioning APP for installers

se.com

Life Is On

Schneider
Electric

How to onboard a new APP?

Charge Point Operators, Car OEMs or Energy Retailers can provide their own monitoring APP as a free or charged service to their customers. Schneider Electric supports such use-cases:

Investigation by Schneider Electric

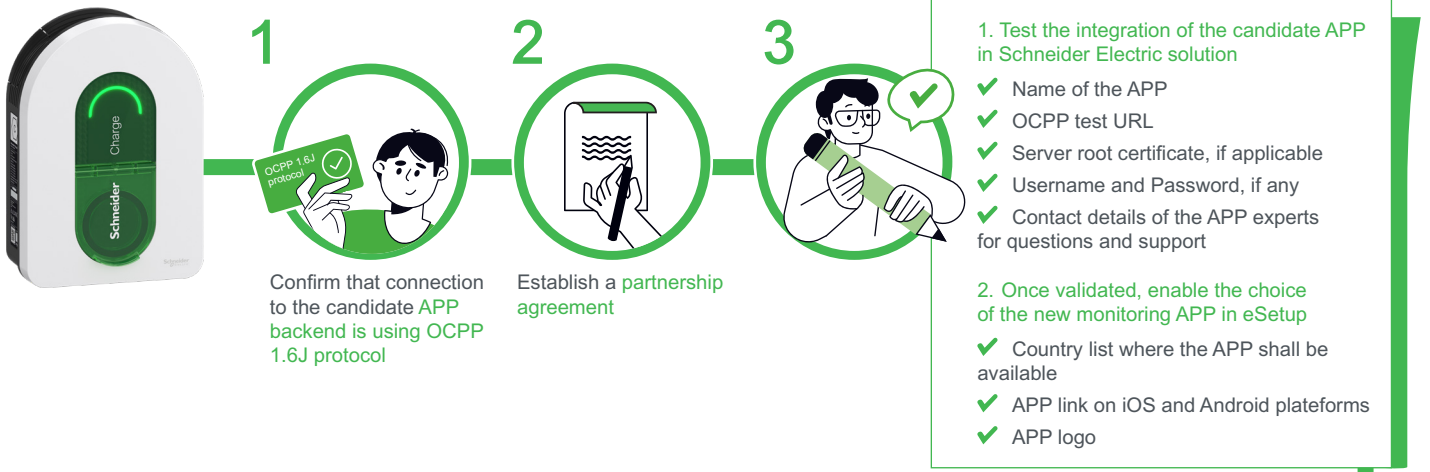

Test and validation by Schneider Electric and software APP experts

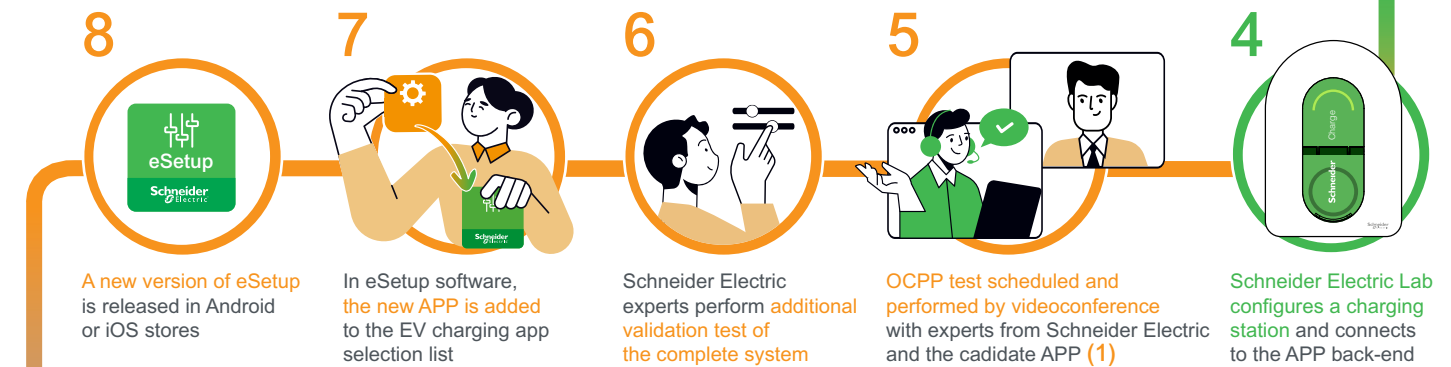

On-site commissioning by the installer

EV/Homeowner account

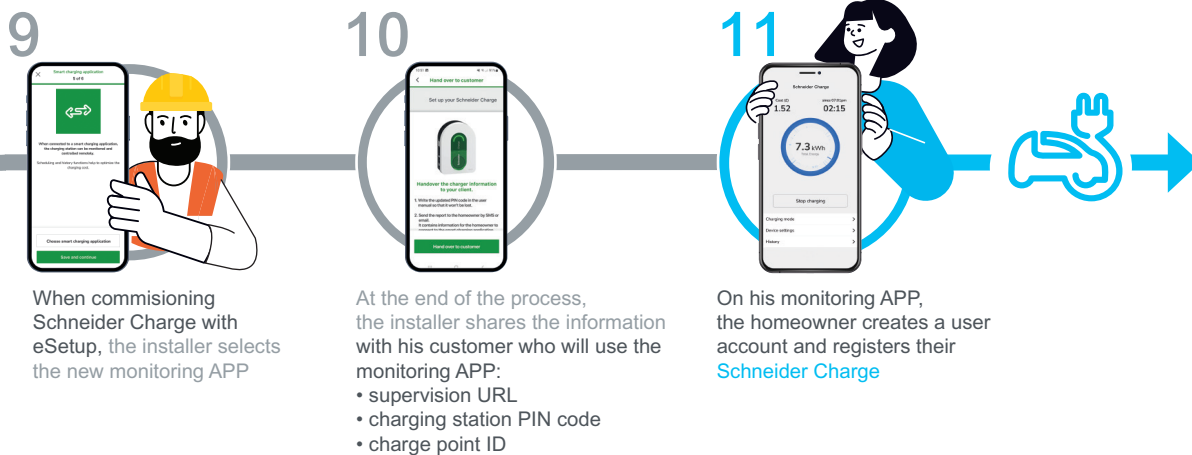

1. To test locally the charging station and propose a new monitoring APP, contact your local sales representative.

se.com

Life Is On

Schneider
Electric