

Odace - Connected Relay Switch 10 A

Device user guide

Information about features and functionality of the device.

04/2024



Legal Information

The information provided in this document contains general descriptions, technical characteristics and/or recommendations related to products/solutions.

This document is not intended as a substitute for a detailed study or operational and site-specific development or schematic plan. It is not to be used for determining suitability or reliability of the products/solutions for specific user applications. It is the duty of any such user to perform or have any professional expert of its choice (integrator, specifier or the like) perform the appropriate and comprehensive risk analysis, evaluation and testing of the products/solutions with respect to the relevant specific application or use thereof.

The Schneider Electric brand and any trademarks of Schneider Electric SE and its subsidiaries referred to in this document are the property of Schneider Electric SE or its subsidiaries. All other brands may be trademarks of their respective owner.

This document and its content are protected under applicable copyright laws and provided for informative use only. No part of this document may be reproduced or transmitted in any form or by any means (electronic, mechanical, photocopying, recording, or otherwise), for any purpose, without the prior written permission of Schneider Electric.

Schneider Electric does not grant any right or license for commercial use of the document or its content, except for a non-exclusive and personal license to consult it on an "as is" basis.

Schneider Electric reserves the right to make changes or updates with respect to or in the content of this document or the format thereof, at any time without notice.

To the extent permitted by applicable law, no responsibility or liability is assumed by Schneider Electric and its subsidiaries for any errors or omissions in the informational content of this document, as well as any non-intended use or misuse of the content thereof.

Table of Contents

Safety Information.....	5
Odace - Connected Relay Switch 10 A	6
For your safety	6
About the device.....	6
Installing the device	6
Pairing the device	7
Configuring the device	8
Setting the device location	9
Setting up the LED Indicator Behaviour	10
Using the device	11
Switching on/off the device manually	11
Turning On/Off device using app	12
Setting up a schedule.....	12
Moments.....	14
Automation.....	17
Resetting the device	23
LED Indication.....	23
Technical Data	25

Safety Information

Important Information

Read these instructions carefully and look at the equipment to become familiar with the device before trying to install, operate, service, or maintain it. The following special messages may appear throughout this manual or on the equipment to warn of potential hazards or to call attention to information that clarifies or simplifies a procedure.



The addition of either symbol to a “Danger” or “Warning” safety label indicates that an electrical hazard exists which will result in personal injury if the instructions are not followed.



This is the safety alert symbol. It is used to alert you to potential personal injury hazards. Obey all safety messages that accompany this symbol to avoid possible injury or death.

DANGER

DANGER indicates a hazardous situation which, if not avoided, **will result in** death or serious injury.

Failure to follow these instructions will result in death or serious injury.

WARNING

WARNING indicates a hazardous situation which, if not avoided, **could result in** death or serious injury.

CAUTION

CAUTION indicates a hazardous situation which, if not avoided, **could result in** minor or moderate injury.

NOTICE

NOTICE is used to address practices not related to physical injury.

Odace - Connected Relay Switch 10 A

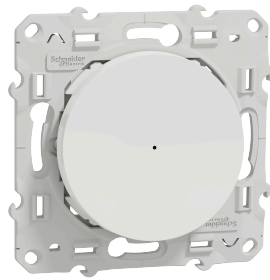

S5X0530W

For your safety

⚡⚠ DANGER

HAZARD OF ELECTRIC SHOCK, EXPLOSION, OR ARC FLASH

Safe electrical installation must be carried out only by qualified electrical personnel. Qualified electrical personnel must prove profound knowledge in the following areas:

- Connecting to installation networks
- Connecting several electrical devices
- Laying electrical cables
- Safety standards, local wiring rules, and regulations

Failure to follow these instructions will result in death or serious injury.

About the device

The Connected Relay Switch 10 A (hereinafter referred to as **relay switch**) is a push button device that can be used to switch LED, ohmic, inductive or capacitive loads manually or remotely.

Control options

Home control: To control the relay switch through the Wiser app you will need the **Wiser Hub**.



Direct operation: The relay switch can always be controlled directly on-site. You can also connect any number of mechanical push-buttons.

Installing the device

Refer to the Installation instruction supplied with this product.

Pairing the device

Using the Wiser Home app, pair your relay switch with the **Wiser Hub** to access and control the relay switch.

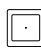
1. On the Home page, tap .
2. Tap **Devices** >  icon and **Lights** >  **1-gang** > **Next**.

NOTE: The next screen shows the joining process of relay switch.

3. Short press the push button 3 times and make sure that the LED blinks amber.

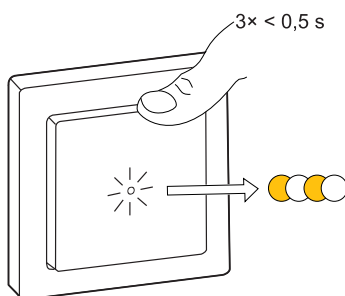

4. Wait for a few seconds until the LED turns green. You can also see in the app that the device is joined.

NOTE: If the LED is blinking green and red, see the instructions by tapping the link **LED blinking green and red?**.

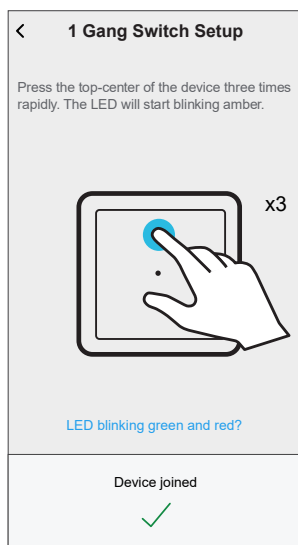

5. Tap **Next** to enter the name of the device and assign the device to a new room or an existing room.





The relay switch is now listed under **All** devices.

Configuring the device

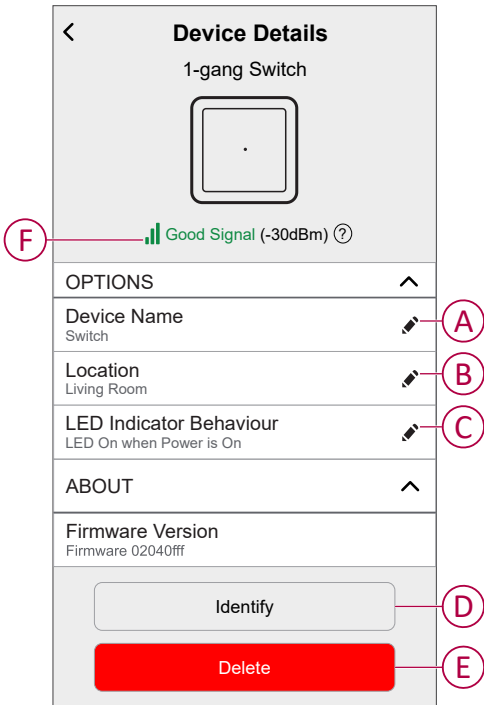
Using the Wiser home app, you can configure the device according to your preferences.



- 1. On the Home page, tap .
- 2. Tap **Devices > Lights > Relay switch** to locate to the **Device Details** screen.



A	Device Name: Tap to change the name of the device.
B	Location: Tap to assign the Device to any room (such as living room, bedroom, kitchen etc). Refer to Setting the device location , page 9 for more details on how to set the location.
C	LED Indicator Behaviour: Tap to set the LED indicator behaviour of the device as per your preference. Refer to Setting up the LED Indicator Behaviour , page 10 for detailed information on each option.
D	Identify: Tap to identify the device. The status LED blinks red and connected lighting devices blinks On/Off, upon successful identification of the switch. Tap OK when you finish identifying the device.
E	Delete: Tap to remove the device from the system. NOTE: <ul style="list-style-type: none">• Removing the device will also reset the switch. After reset, the LED turns amber indicating that the switch is ready for pairing.• If there is a problem while pairing or resetting the switch, refer to Resetting the device, page 23
F	Zigbee Signal Strength Indicator: Zigbee Signal Strength indicator which displays the current signal strength of the device. <ul style="list-style-type: none">•  Good Signal (between 0 & -54dBm)•  Normal Signal (between -54 & -79dBm)•  Poor Signal (<-79dBm)•  No Signal (device is offline)

Setting the device location

You can change the device location using Wiser Home app (such as bedroom, living room, dining room etc.).

1. On the Home page, tap .
2. Tap **Devices**, select the device from the list for which you wish to change the location.
3. Tap **Location**  to open setup page.
4. On setup page, you can enter **New room name** (A) or select an existing room from the list (B).

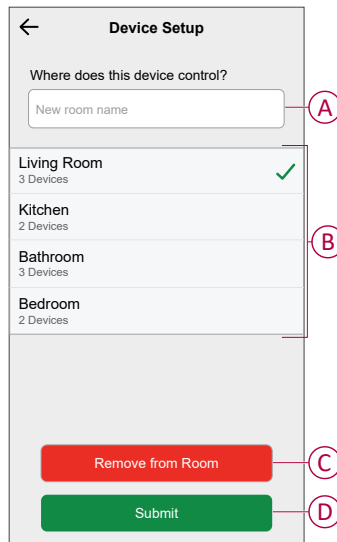

TIP: If the device is already assigned, you can remove it from the existing room. Tap **Remove from Room** (C).

5. Once changes are done, tap **Submit** (D).

Setting up the LED Indicator Behaviour

Using the Wiser Home app, you can set the behaviour of the LED indicator on your device to identify the device status.

- 1. On the Home page, tap .
- 2. Tap **Devices > Lights**.
- 3. Select the device you want to update and tap **LED Indicator Behaviour**.

NOTE: If you are unable to find the option in your app, reset the device to factory default and perform the pairing process.

- 4. Select one of the following options as per your preference.

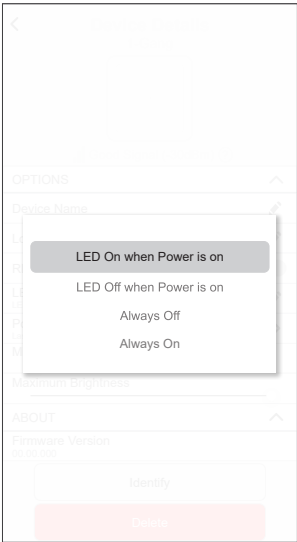

LED On when Power is on	The LED turns On when the device is On.
LED Off when Power is on	The LED turns Off when the device is On.
Always Off	The LED stays Off all the time.
Always On	The LED stays On all the time.

Using the device

Switching on/off the device manually

You can turn on/off the device manually. The device powers the electrical appliances connected to it.
Short press the push button once to turn on/off the relay switch.

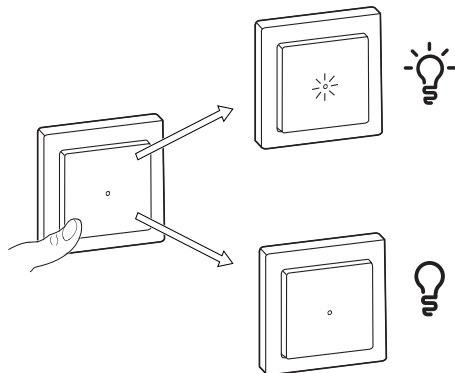

Turning On/Off device using app

Using the Wiser Home app, you can turn On/Off the relay switch remotely.

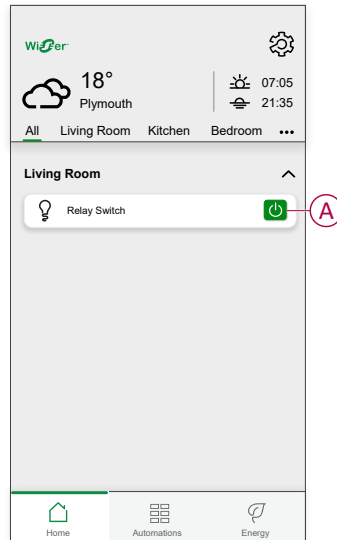

Follow the steps to turn On/Off the relay switch using the app:

1. Go to the Home page, tap **All** and find the device.
2. Tap  (A) to turn On/Off relay switch.



Setting up a schedule

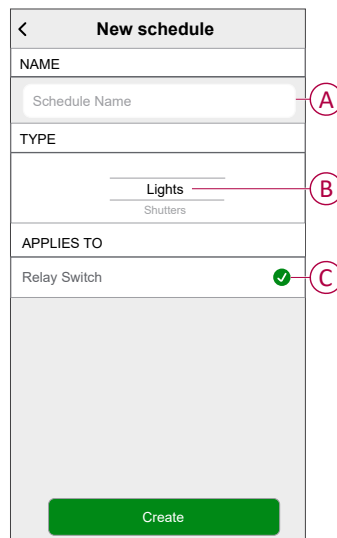

The relay switch can be fully controlled by a schedule. Once the schedule is set, the relay switch operates at a given time.

1. On the **Home** page, tap .
2. Go to **Schedules** and tap  to create a schedule.
3. Enter the name of the schedule (A).
4. In the **TYPE** menu, select **Lights** (B).
5. In the **APPLIES TO** menu, select **Relay Switch** (C) from the listed devices.
6. Tap **Create** to setup events.



7. Under **EVENTS** menu, select a day and then Tap  to add an event such as **STATE** (lights On/Off) and **WHEN** (sunrise/sunset or specific time range).
8. Tap **Set** to save the schedule.



TIP:

- You can add multiple schedules based on your requirement. Select days, tap , set on/off state and time.
- You can copy the existing schedule to another schedule or to the days of your choice. Tap  .
 - Tap **Schedule** and select an existing schedule and tap **Copy**.
 - Tap **Day** and select the days you want to assign and tap **Copy**.

Moments

Moment allows you to group multiple actions that are usually performed together. By using the Wiser Home app, you can create moments based on your needs.

Creating a moment

1. On the **Home** page, tap .
2. Go to **Moments** and tap  to create a moment.
3. Enter the name of the moment (A).
TIP: You can choose the cover image that represents your moment by tapping .
4. Tap **Add actions** (B) to select the list of devices.

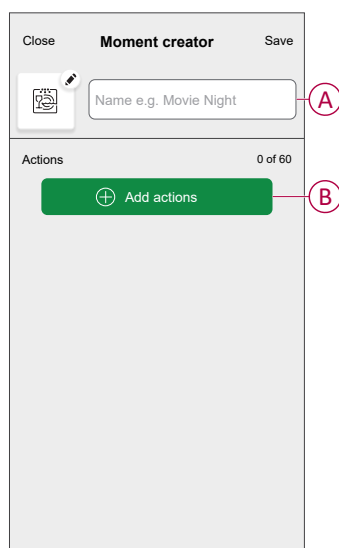

5. In the **Add actions** menu, you can select the devices (C).

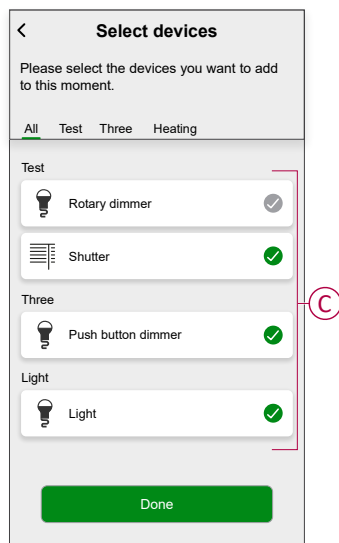



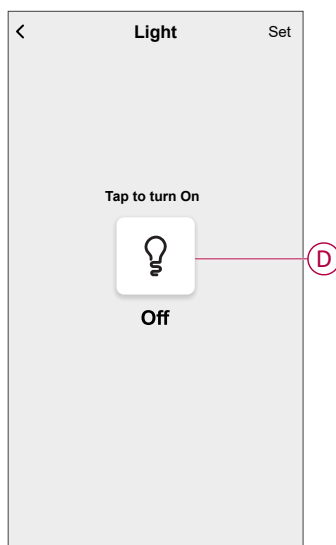

6. Once the device are selected, tap **Done**.

7. On the **Moment creator** page, tap the device to set the condition. For example, it is a relay switch:
 - Tap to turn on (D) and tap **Set** on the upper right corner.



8. After setting all conditions, tap **Save**.
Once the moment is saved, it will appear on the **Moments** tab. Tap on the moment to enable it.

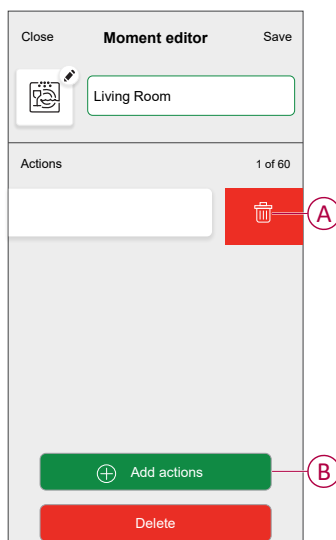

Editing a moment

1. On the **Home** page, tap .
2. Go to **Moments**, locate the moment you want to edit and tap .
3. On the **Moment editor** page, you can perform following changes:
 - Change the icon .
 - Rename the moment.
 - Tap each action to change the settings.
 - To remove an action, slide the action to the left and then tap  (A) to delete it.
 - Tap  **Add actions** (B) to add new action.



4. Tap **Save**, to save the changes.

Deleting a moment

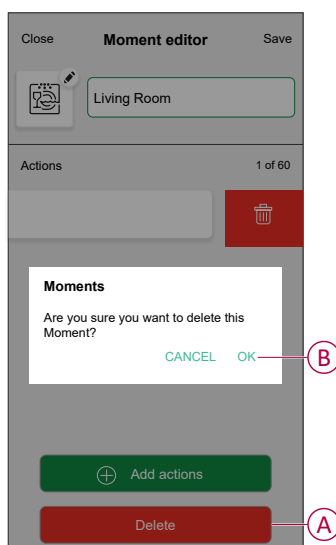

1. On the **Home** page, tap .
2. Go to **Moments**, locate the moment you want to delete and tap .
3. On the Moment editor page, tap **Delete** (A) and then tap **Ok** (B).



Automation

An automation allows you to trigger an action automatically or at scheduled times. By using the Wiser Home app, you can create automations based on your needs. This example demonstrates how a device works when the condition is met.

Creating an automation

1. On the **Home** page, tap .
2. Go to **Automation** and then tap  to create an automation.

3. Enter a name of the automation (A) and select any of the following conditions to trigger an automation.

- **All conditions:** All conditions must be met to trigger an automation
- **Any condition:** Any one of the condition must be met to trigger an automation.

TIP: You can choose the cover image that represents your automation by tapping 

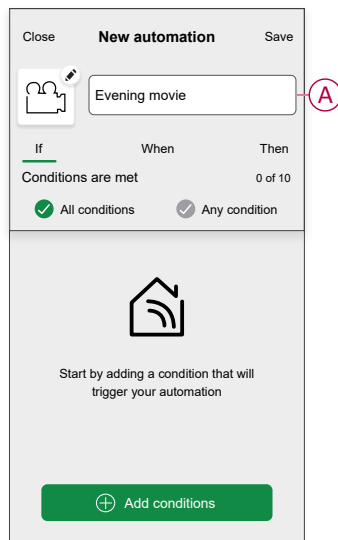

4. Tap **Add conditions** (B) and select any of the following (C):

- **Device status change** (Select the device): An automation will be triggered based on a device status, such as the opening of a shutter or the detection of movement by a motion sensor.
- **Away Mode** (Enable or Disable): The Away Mode is intended to set your Home to a practical state for longer absences, such as leaving for the weekend.

NOTE: Maximum 10 conditions can be added.

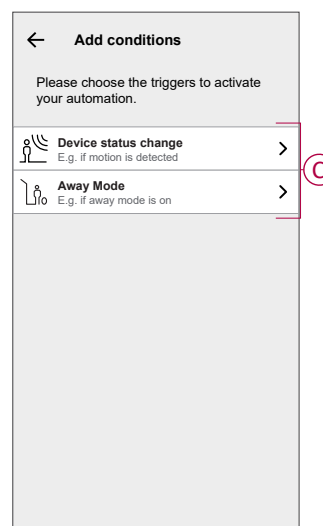
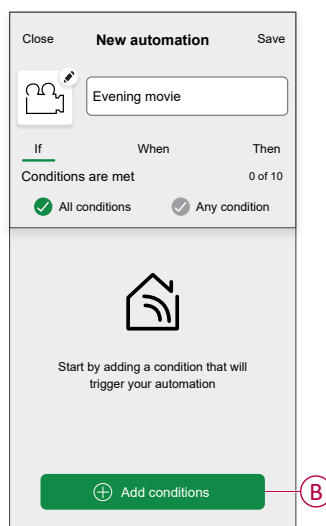

5. Select a device to set the condition. Then, choose the state of the device that will trigger the automation, such as the On/Off state or Brightness level of a dimmer.

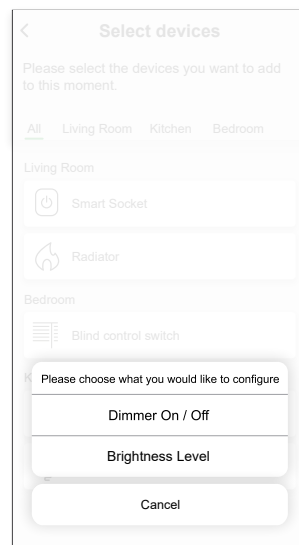
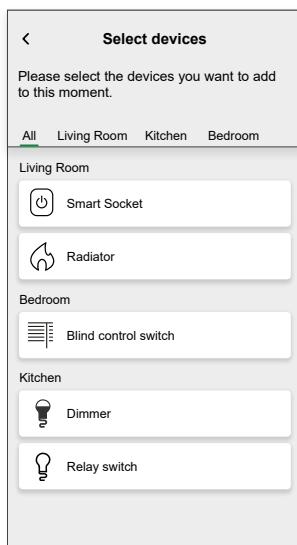

6. Tap **Set** on the upper right corner.

TIP: If you want to change the condition, swipe it to the left and tap the bin icon. Then add a new condition with the required parameters.

7. To start your automation at a particular time, tap **When > Add time** and select any of the following (D):

NOTE: Maximum 10 time entries can be added.

- **Specific time of day** - The automation will trigger at a specific time of the day, such as at sunrise, sunset, or at 8:00 AM.
- **Period of time** - The automation will be trigger during time periods such as from sunrise to sunset, from sunset to sunrise, or from 8:00 AM to 5:00 PM.

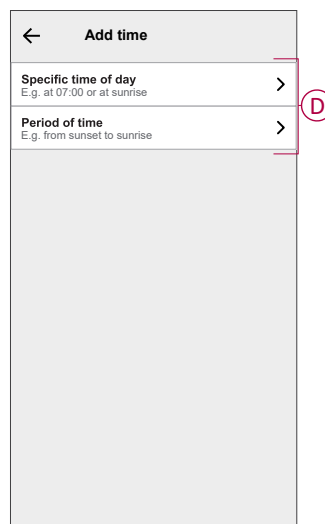
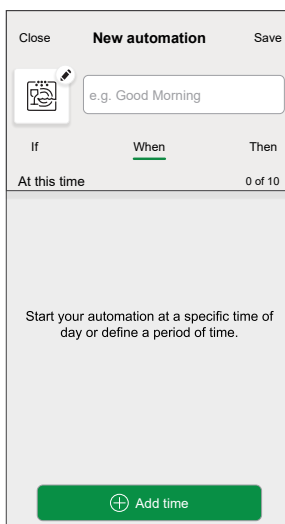

8. To add an action, tap **Then > Add an action** and select any of the following (E):

NOTE: Maximum 10 actions can be added.

- **Control a device** - Select the device and set the desired state of the device.
- **Send notification** - You will be notified if the condition is met.
- **Activate a moment** - Select a Moment.

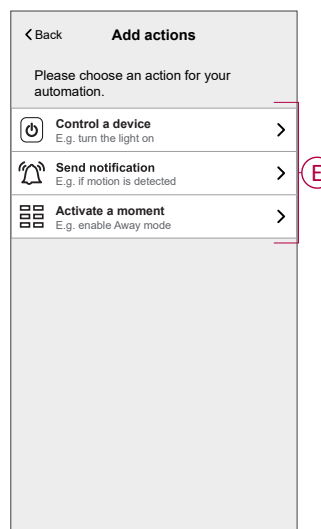
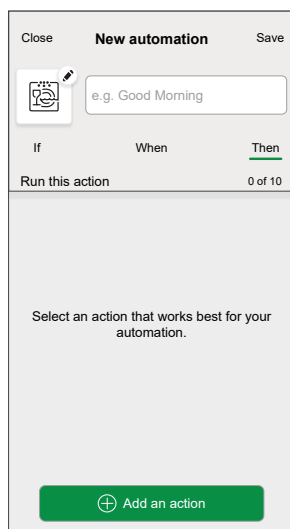

- a. In this example, we will select for **Control a device** and choose **Relay switch** (F) as the device to trigger an action.

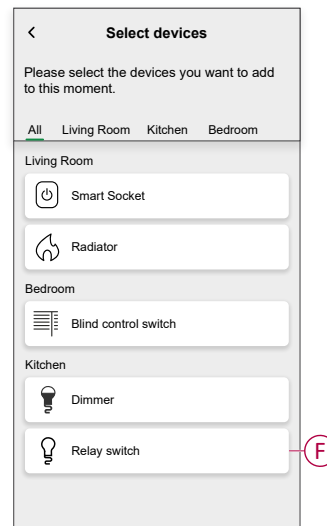
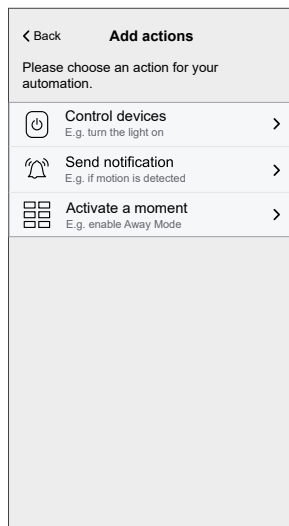

- b. Set the state, such as turning the relay switch On/Off. Then, tap **Set** located on the upper right corner

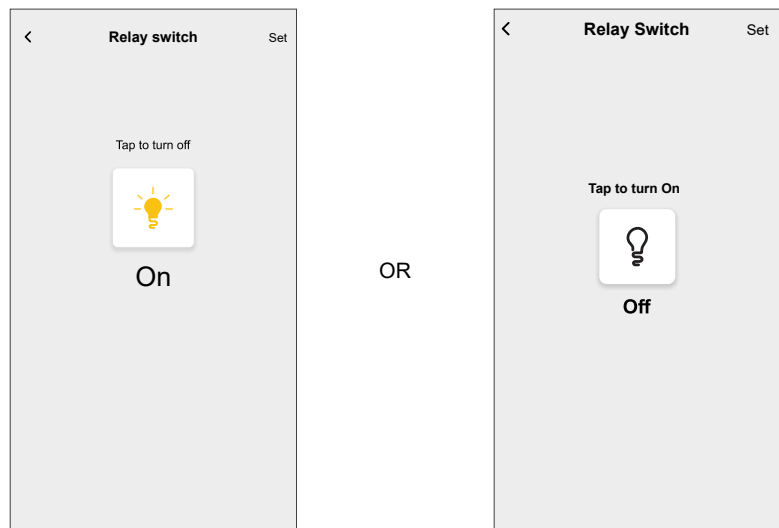

9. Tap **Save**.

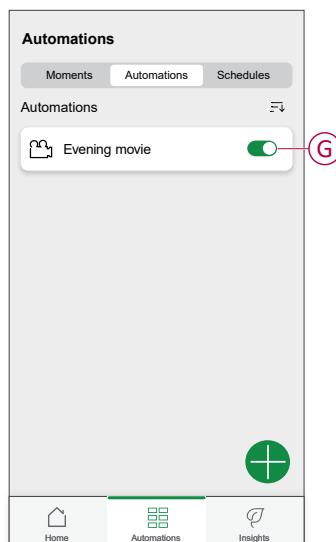

The saved automation is displayed on the **Automation** page. Tap the toggle switch (G) on the Automation page to enable/disable the automation.



Editing an automation

1. On the **Home** page, tap .
2. Go to **Automation**, tap the automation you want to edit.

3. On the **Edit automation** page, you can perform following changes:

- Change the icon .
- Rename the automation.
- Tap each condition to change the settings.
 - To remove a condition, slide the condition towards left and then tap  (A) to delete it.
 - Tap  **Add conditions** (B) to add new condition.

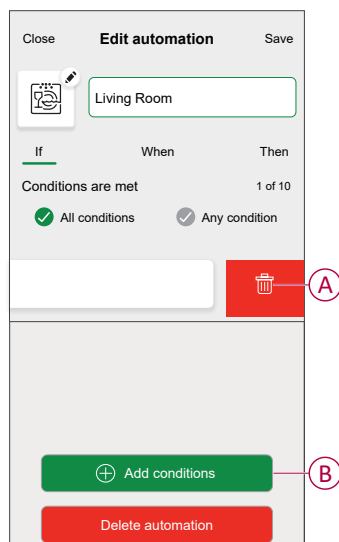

4. Tap **Save** , to save the changes.

Deleting an automation

1. On the **Home** page, tap .
2. Go to **Automation**, tap the automation you want to delete.
3. On the **Edit automation** page, tap **Delete automation** (A) and read the confirmation message and then tap **OK** (B).

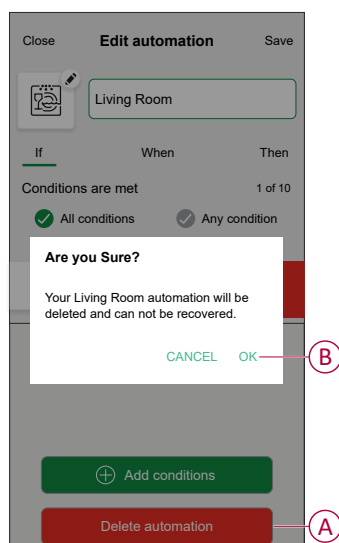

Resetting the device

You can reset the device to factory default manually.

Short-press the push button 3 times (<0.5 s) and then long-press the push button once (>10 s).

The LED blinks red after 10 s, and then release the push button.

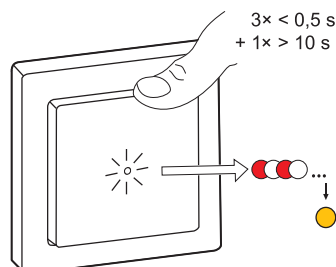

Upon successful reset, the LED stops blinking. Then, the device restarts and blinks green for a few seconds.

NOTE: After reset, the LED turns amber indicating that it is ready for pairing.





LED Indication

Pairing

User Action	LED Indication	Status
Press the push-button 3 times	LED blinks amber per second. 	Pairing mode is active for 30 seconds. When pairing is completed, LED glows green for some time before turning Off. 

Resetting

User Action	LED Indication	Status
Press the push-button 3 times and hold it down once for > 10 s.	After 10 s, the LED blinks red. 	The relay switch is in reset mode. It is reset to the factory settings after 10 seconds. The relay switch then restarts and the LED blinks green for a few seconds and then stays amber. 







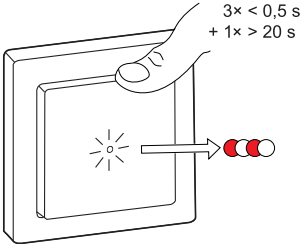

Identifying the device

LED Indication	Status
The LED blinks red. 	The connected devices blinks On/Off, upon successful identification of the relay switch.

Different connectivity mode

LED Indication	Status
<p>The LED blinks green and red while paring.</p> 	<p>The device is trying to connect to other connectivity mode. Short press the push button 3 times and then hold for 20 seconds. When the LED blinks red rapidly, release the push button.</p> 

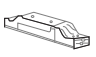
Technical Data

Nominal voltage	AC 230 V, 50 Hz		
Nominal power	Load type	Load name	Load value
	 LED	LED	200 W
	 M	Motor	1000 VA
		Iron core transformer	500 VA
		Incandescent lamp	2200 W
		Halogen lamp	2000 W
		Fluorescent lamp	200 W
		Electronic step-down converter	1050 VA
	 C	Capacitive load	10 A, 140µF
Standby	Maximum 0.4 W		
Connecting Terminals	Screw terminals for max. 2 x 2.5 mm ² , 0.5 Nm		
Extension unit	Single Push-button, unlimited number, max. 50 m		
Fuse protection	16 A circuit breaker		
Nominal current	10 A, cosφ = 0.6		
Operating frequency	2405 - 2480 MHz		
Max. radio-frequency power transmitted	< 10 mW		
Communication protocol	Zigbee 3.0 certified		

Compliance

Compliance information for Green Premium products

Find and download comprehensive information about Green Premium products, including RoHS compliance and REACH declarations as well as Product Environmental Profile (PEP) and End-of-Life instructions (EOLI).

<https://checkaproduct.se.com/>



General information about Green Premium products

Click the link below to read about Schneider Electric's Green Premium product strategy.

<https://www.schneider-electric.com/en/work/support/green-premium/>



EU Declaration of Conformity

Hereby, Schneider Electric Industries, declares that this product is in compliance with the essential requirements and other relevant provisions of RADIO DIRECTIVE 2014/53/EU. Declaration of conformity can be downloaded on se.com/docs.

Trademarks

This guide makes reference to system and brand names that are trademarks of their relevant owners.

- Zigbee® is a registered trademark of the Connectivity Standards Alliance.
- Apple® and App Store® are brand names or registered trademarks of Apple Inc.
- Google Play™ Store and Android™ are brand names or registered trademarks of Google Inc.
- Wi-Fi® is a registered trademark of Wi-Fi Alliance®.
- Wiser™ is a trademark and the property of Schneider Electric, its subsidiaries and affiliated companies.
- Amazon Alexa™ is a trademark of AMAZON TECHNOLOGIES, INC.

- Google Home™ is a trademark of Google INC.

Other brands and registered trademarks are the property of their respective owners.

Schneider Electric
35 rue Joseph Monier
92500 Rueil Malmaison
France

+ 33 (0) 1 41 29 70 00

www.se.com

As standards, specifications, and design change from time to time,
please ask for confirmation of the information given in this publication.

© 2022 – 2024 Schneider Electric. All rights reserved.

DUG_Odace Relay Switch_WH-02