

# 3818 kW, Tier III, NAM, Chilled Water, Liquid-Cooled & Air-Cooled AI Clusters

## Design Overview

### Data Center IT Capacity

3818 kW

Adaptable from 1864 kW to 3818 kW

### Target Availability

Tier III

### Annualized PUE at 100% Load

San Francisco, CA: 1.16 – 1.18

Dallas, TX: 1.21 – 1.23

(Scenario dependent)

### Racks and Density

Total Racks: 128 / 144 (Scenario dependent)

Rack Density:

Max air-cooled: 40 kW

Max liquid-cooled: 73 kW

### Data Center Overall Space

32,920 ft<sup>2</sup>

### Regional Voltage and Frequency

480V, 60Hz

## About this Design

- IT space and power distribution designed to accommodate AI clusters with density up to 73 kW per rack
- Various options to support liquid-cooled racks, including liquid-to-air coolant distribution units (CDUs) and liquid-to-liquid CDUs
- Chilled water systems optimized for high water temperatures using *Uniflair FWCV* fan walls and *Uniflair XRAF HT* air-cooled packaged chillers
- Redundant design for increased availability and concurrent maintainability

## Introduction

High-density AI clusters and liquid cooling bring new challenges to data center design. Schneider Electric's data center reference designs help shorten the planning process by providing validated, proven, and documented data center physical infrastructure designs to address such challenges. This design focuses on the deployment of high-density AI clusters with two IT rooms. IT room 1 depicts three retrofit scenarios, where a new, high-density AI cluster is installed alongside existing traditional IT.

- Scenario 1A shows a high-density air-cooled AI cluster.
- Scenario 1B shows a high-density liquid-cooled AI cluster which uses liquid-to-air coolant distribution units (CDUs) for heat rejection. This is ideal for scenarios where facility water systems are unavailable.
- Scenario 1C shows a high-density liquid-cooled AI cluster which uses liquid-to-liquid CDUs. This is ideal for scenarios where facility water systems are available.

IT room 2 is purpose-built and optimized for a liquid-cooled AI cluster which uses liquid-to-liquid CDUs.

Reference Design 100 includes information for four technical areas: facility power, facility cooling, IT space and lifecycle software. They represent the integrated systems required to meet the design's specifications in this overview document.

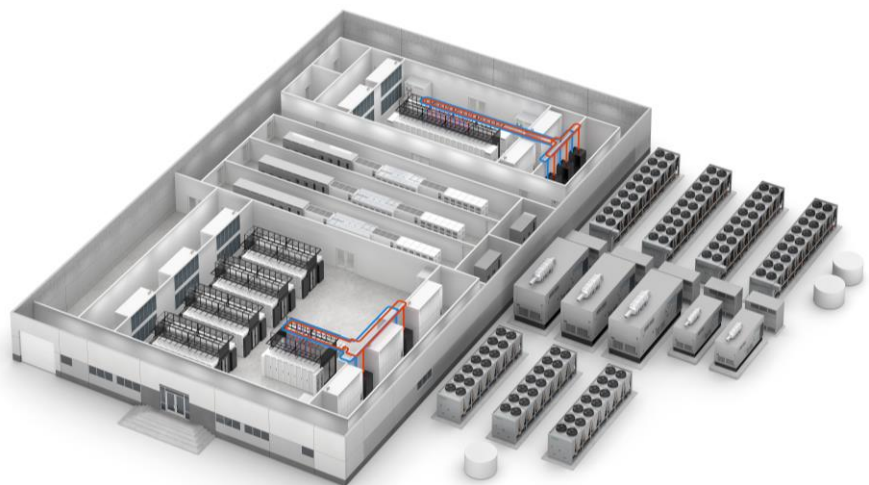

# Facility Power

Facility Power Block Diagram

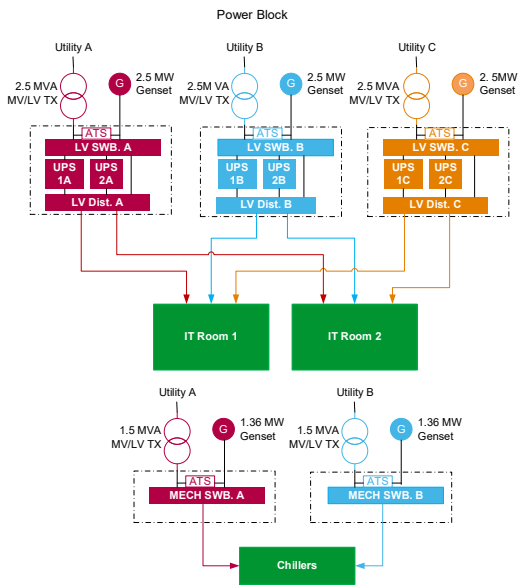

The facility power system supplies power to all components within the data center. In this concurrently maintainable electrical design, power to the IT rooms is supplied through three 2.5 MW powertrains. The three powertrains provide 2+1 distributed redundant UPS power to the IT space, backed up by diesel generators. Each powertrain consists of a 3000-amp QED-2 main switchboard feeding two 1250 kW Galaxy VX UPS with 5 minutes of runtime in parallel and a 3000-amp QED-2 distribution section. The main switchboards also feed the Uniflair FWCV fan walls in the two IT rooms. Downstream, these powertrains feed power distribution units (PDUs), either APC Modular PDUs or Galaxy PDU, that power the IT racks with 2N redundancy. The UPSs also feed the CDUs and chilled water pumps. Separately, two 1.5 MW powertrains feed the chillers with 2N redundant power.

The facility power system is designed to support integrated peripheral devices like fire panels, access control systems, and environmental monitoring and control devices. Power meters in the electrical path monitor power quality and allow for predictive maintenance & diagnostics of the system. These meters also integrate with EcoStruxure Power Monitoring Expert.

Every component in this design is built and tested to the applicable IEEE or UL standards.

Further design details, such as dimensions, schematics, and equipment lists are available in the engineering package.

## Design Options

This reference design can be modified as follows without a significant effect on the design’s performance attributes:

- Add EcoStruxure Power Monitoring Expert
- Provision for load bank
- Change UPS battery type & runtime
- Add facility cooling UPS
- Add/remove/change standby generators:
  - Location & tank size

## Facility Power Attributes

Name	Value	Unit
Total facility peak power (IT and cooling)	6250	kW
Total amps (IT main bus, each)	3000	A
Input voltage (IT main bus)	480	V
Switchboard kAIC (IT main bus)	65	kA
Generator redundancy (IT main bus)	Distributed redundant	
IT power path	Dual	
IT space UPS capacity, per powertrain	2500	kW
IT space UPS redundancy	Distributed redundant	
IT space UPS runtime @ rated load	5	minutes
IT space UPS output voltage	480	V
Total amps (Facility cooling bus, each)	1600	A
Input voltage (Facility cooling bus)	480	V
Switchboard kAIC (Facility cooling bus)	35	kA
Generator redundancy (Facility cooling bus)	2N	
Facility cooling UPS capacity	N/A	kW
Facility cooling UPS redundancy	N/A	
Facility cooling UPS runtime @ rated load	N/A	minutes

# Facility Cooling

## Facility Cooling Block Diagrams

Retrofit Scenario System Flow

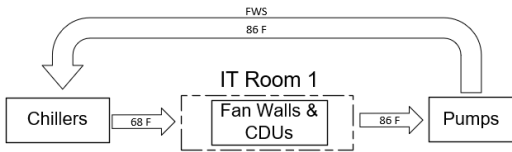

New Build Scenario System Flow

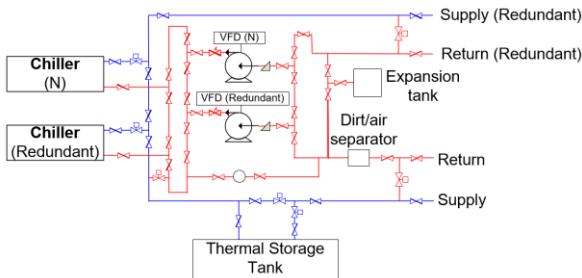
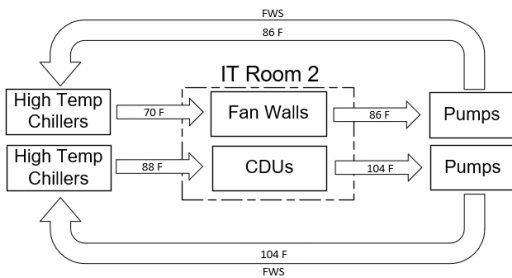

### Design Options

This reference design can be modified as follows without a significant effect on the design's performance attributes:

- Add *EcoStruxure IT Expert*
- Change storage tank size
- Use standard temperature chillers, like *Uniflair XRAF* or *Uniflair BCEF*, chillers for loop with fan walls in IT Room 2

The facility cooling design is based on the specified AI deployment scenarios. For IT Room 1 (retrofit IT room scenario), a chilled water system with dual path piping is implemented. Three *Uniflair BCEF* chillers with free cooling capabilities deliver 68°F chilled water in an N+1 configuration.

The facility cooling design for IT Room 2 (new IT room scenario) is comprised of two separate chilled water loops. A high temperature water loop, with two *Uniflair XRAF* extra high temperature chillers with screw compressors and free cooling capabilities, provides 88°F water to the IT room to cool the IT equipment. A separate chilled water loop, with two *Uniflair XRAF* extra high temperature chillers, provides 70°F water for the air handling units of the IT room. Using *Uniflair XRAF* extra high temperature chillers for the chilled water loop enables future-readiness for water temperature increase. *Uniflair BCEF* chillers and standard *Uniflair XRAF* chillers are also good options at this specified chilled water temperature.

A thermal storage system provides 5 minutes of continuous cooling after a power outage or chiller restart. The *Uniflair BCEF* and *Uniflair XRAF* chillers can fully restart within 3 minutes.

More information on fan wall and CDU cooling architecture is provided in the IT room section of this document.

This design is instrumented to work with *EcoStruxure IT Expert* and *AVEVA Unified Operations Center*.

Further design details such as dimensions, schematics, and equipment lists are available in the engineering package.

### Facility Cooling Attributes

Name	Value	Unit
Total max cooling capacity (chillers)	4976 (Dallas) 5450 (San Francisco)	kW
Input voltage	480	V
Heat rejection medium	Chilled water	
Chiller redundancy	N+1	
Outdoor heat exchange	Packaged chiller with free cooling	
CW supply temperature	68 – 70	°F
CW return temperature	86	°F
CW supply temp (Room 2, to CDUs)	88	°F
CW return temp (Room 2, from CDUs)	104	°F
Combined* storage tank size	989	ft <sup>3</sup>
Ride-through time	5	minutes
Outdoor ambient temperature range	11.1 to 110.5	°F
Economizer type	Water-side	

\*Summation of all three chilled water loops



# Retrofit IT Room: Scenario 1B

## IT Room 1B Diagrams

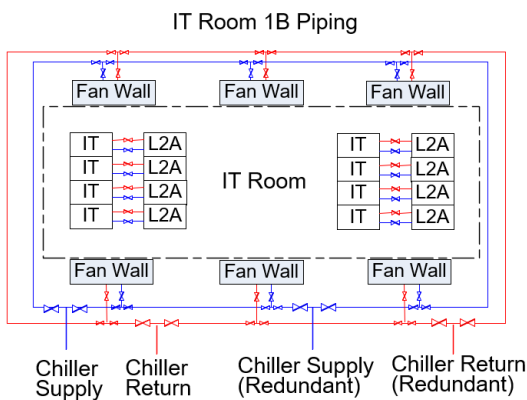
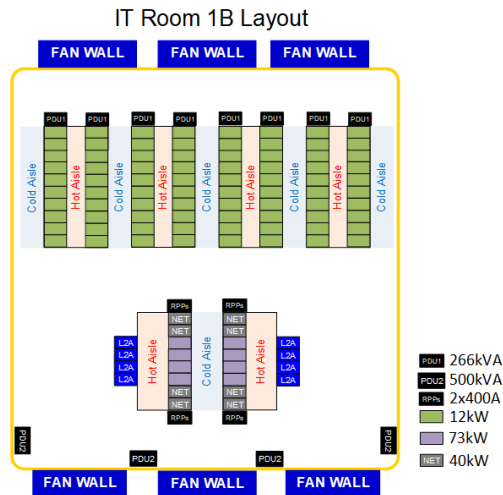

### Design Options

This reference design can be modified as follows without a significant effect on the design's performance attributes:

- Use *Uniflair FXCV* fan walls
- CRAHs can be selected instead of fan walls
- Variations in AI cluster configuration

The second retrofit IT room scenario features eighty 12 kW air-cooled IT racks. The load has been expanded with an AI cluster consisting of eight 73 kW liquid-cooled AI racks and eight 40 kW air-cooled networking racks (modeled after Nvidia's *DGX SuperPOD*). The AI cluster is configured with four liquid cooled racks together and two networking racks on each end of the row. For the liquid-cooled racks, *Uniflair ACSX* liquid-to-air (L2A) coolant distribution units (CDUs) are placed on the opposite side of the hot aisle. The liquid cooled servers use direct-to-chip cooling technology. The liquid cooling loop directly feeding coolant to the racks is known as the Technology Cooling System (TCS). An 8 ft. wide hot aisle is designed for the high-density pods to ensure proper airflow. Ducted hot aisles and a common ceiling plenum return hot air to the fan walls for cooling.

L2A CDUs allow liquid-cooled racks to be deployed in data centers without the need for facility water. The CDUs supply coolant to the racks and reject heat into the air. Six *Uniflair FWCV* chilled water fan walls with redundant piping deliver supply air to the IT room in an N+1 configuration.

The 12 kW IT racks are powered by 1+1 40 A *NetShelter Metered* rPDUs. The 40 kW networking racks are configured with 1+1 100 A *NetShelter Advanced* rPDUs. The 73 kW liquid-cooled AI racks are configured with 3+3 OCP V3 power shelves, each fed with a 60 A power feed. Each rack is powered by 2N redundant feeds from their respective pod's PDUs, providing A- and B-side power to each rack. The pods of 12 kW IT racks are powered by *APC Modular 266 kVA PDU* cabinets feed power to a pair of *Galaxy RPPs*, with *PowerLogic BCPM* for branch circuit monitoring and can be configured with shunt trip units on circuit breakers feeding liquid-cooled racks for leak detection, which distribute power to rows of 73 kW AI racks and 40 kW networking racks.

### IT Room 1B Attributes

Name	Value	Unit
IT load	1864	kW
Supply voltage to IT	415	V
Single or dual	Dual	
Number of 12kW air-cooled racks	80	racks
Number of 73kW liquid-cooled racks	8	racks
Number of 40kW networking racks	8	racks
IT floor space	4467	ft <sup>2</sup>
CRAC/CRAH type	Fan wall	
CRAC/CRAH redundancy	N+1	
CRAC/CRAH supply air temperature	79	°F
CW supply temperature	68	°F
CW return temperature	86	°F
Containment type	Ducted hot aisle	
CDU type	L2A	
CDU redundancy	N	
TCS loop supply temperature	104	°F
TCS loop return temperature	122	°F

# Retrofit IT Room: Scenario 1C

## IT Room 1C Diagrams

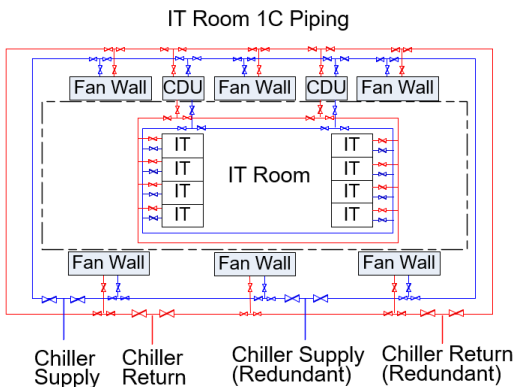
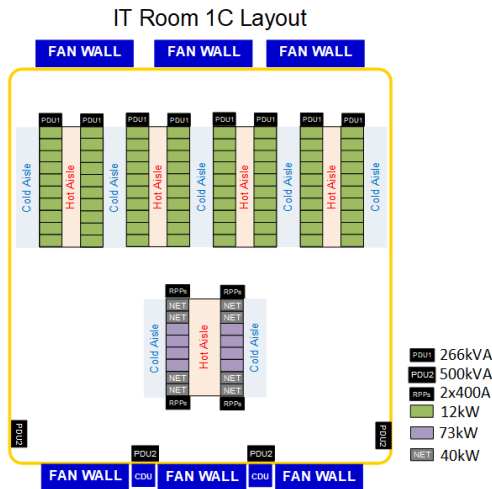

### Design Options

This reference design can be modified as follows without a significant effect on the design's performance attributes:

- Use *Uniflair FXCV* fan walls
- CRAHs can be selected instead of fan walls
- Variations in AI cluster configuration

The third retrofit IT room scenario features eighty 12 kW air-cooled IT racks. The load has been expanded with an AI cluster consisting of eight 73 kW liquid-cooled IT racks and eight 40 kW air-cooled networking racks (modeled after Nvidia's *DGX SuperPOD*). The AI cluster is configured with four liquid cooled racks together and two networking racks on each end of the row. For the liquid-cooled racks, two *Uniflair CPOR* liquid-to-liquid (L2L) CDUs provide coolant to the racks. The L2L CDUs are placed in the service hallway. The liquid cooled servers use direct-to-chip cooling technology. The liquid-cooled pod shares an 8 ft. wide hot aisle for proper airflow.

L2L CDUs are the heat exchange interface between liquid-cooled IT racks and the facility water system (FWS). In this scenario, the CDUs are tied together on a common loop providing N+1 redundancy. The CDUs are fed the same facility supply water as the fan walls. Six *Uniflair FWCV* chilled water fan walls with redundant piping deliver supply air to the IT room in an N+1 configuration.

The 12 kW IT racks are powered by 1+1 40 A *NetShelter Metered* rPDUs. The 40 kW networking racks are configured with 1+1 100 A *NetShelter Advanced* rPDUs. The 73 kW liquid-cooled AI racks are configured with 3+3 OCP V3 power shelves, each fed with a 60 A power feed. Each rack is powered by 2N redundant feeds from their respective pod's PDUs, providing A- and B-side power to each rack. The pods of 12 kW IT racks are powered by *APC Modular 266 kVA PDU* cabinets feed power to a pair of *Galaxy RPPs*, with *PowerLogic BCPM* for branch circuit monitoring and can be configured with shunt trip units on circuit breakers feeding liquid-cooled racks for leak detection, which distribute power to rows of 73 kW AI racks and 40 kW networking racks.

### IT Room 1C Attributes

Name	Value	Unit
IT load	1864	kW
Supply voltage to IT	415	V
Single or dual cord	Dual	
Number of 12kW air cooled racks	80	racks
Number of 73kW liquid cooled racks	8	racks
Number of 40kW networking racks	8	racks
IT floor space	4467	ft <sup>2</sup>
CRAC/CRAH type	Fan wall	
CRAC/CRAH redundancy	N+1	
CRAC/CRAH supply air temperature	79	°F
CW supply temperature	68	°F
CW return temperature	86	°F
Containment type	Ducted hot aisle	
CDU type	L2L	
CDU redundancy	2N	
TCS loop supply temperature	104	°F
TCS loop return temperature	122	°F

# New Build IT Room 2

## IT Room 2 Diagrams

### IT Room 2 Layout

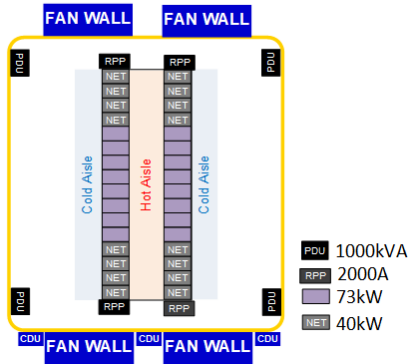

### IT Room 2 Piping

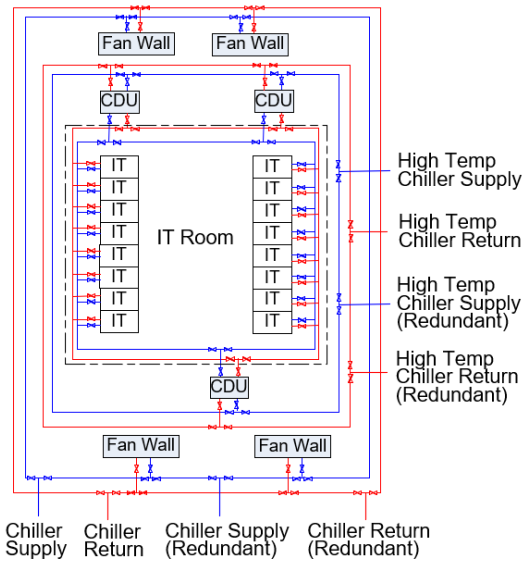

## DESIGN OPTIONS

This reference design can be modified as follows without a significant effect on the design's performance attributes:

- Use *Uniflair FXCV* fan walls
- CRAHs can be selected instead of fan walls
- Variations in AI cluster configuration

IT Room 2 is dedicated to a new AI cluster and features sixteen 73 kW liquid-cooled IT racks with sixteen 40 kW air-cooled networking racks placed at the ends of the rows. The racks are configured in one pod and share a 6 ft wide hot aisle. For the liquid-cooled racks, three *Uniflair CPOR* liquid-to-liquid (L2L) CDUs provide coolant to the racks. The L2L CDUs are placed in the service hallway. The liquid cooled servers use direct-to-chip cooling technology.

Four *Uniflair FWCV* chilled water fan walls deliver supply air to the IT room in an N+1 configuration. Three *Uniflair CPOR* L2L CDUs are tied together on a common TCS loop with N+1 redundancy to provide coolant to the liquid-cooled racks. The CDUs run on a separate, high-temperature chilled water loop to increase free cooling opportunity. *Uniflair XRAF* extra high temperature chillers make it possible to operate this chiller-based cooling loop at temperatures not seen in the industry today providing unmatched cooling efficiency.

The 40 kW networking racks are configured with 1+1 100 A *NetShelter Advanced* rPDUs. The 73 kW liquid-cooled AI racks are configured with 3+3 OCP V3 power shelves, each fed with a 60 A power feed. Each rack is powered by 2N redundant feeds from their respective pod's PDUs providing A- and B-side power to each rack. Each *Galaxy 1000 kVA PDU* cabinet feed power to a *Hyper High Density RPP*, with *PowerLogic HDPM* for branch circuit monitoring and can be configured with shunt trip units on circuit breakers feeding liquid-cooled racks for leak detection, which distribute power to a row of 73 kW AI racks and 40 kW networking racks.

## IT Room 2 Attributes

Name	Value	Unit
IT load	1808	kW
Supply voltage to IT	415	V
Single or dual cord	Dual	
Number of 73kW liquid-cooled racks	16	racks
Number of 40kW networking racks	16	racks
IT floor space	1711	ft <sup>2</sup>
CRAC/CRAH type	Fan wall	
CRAC/CRAH redundancy	N+1	
CRAC/CRAH supply air temperature	79	°F
CW supply temperature	70	°F
CW return temperature	86	°F
Containment type	Ducted hot aisle	
CDU type	L2L	
CDU redundancy	N+1	
CDU CW supply temperature	88	°F
CDU CW return temperature	104	°F
TCS loop supply temperature	104	°F
TCS loop return temperature	122	°F

# Lifecycle Software

High-density AI clusters push the limits of data center facility infrastructure, so it's critical to leverage advanced planning and operation tools to ensure safe and reliable operations.

## Planning & Design

**Electrical Safety and Reliability:** Due to the high amount of power supplied to an AI cluster, design specifications such as available fault current, arc flash hazards and breaker selectivity must be analyzed in the design phase. Applications like *Ecodial* and *eTAP* simulate the electrical design and reduce the chance of costly mistakes or even worse, injury.

**Cooling:** AI clusters are pushing the limits of what can be done with air-cooling. Modeling the IT space with computational fluid dynamics (CFD) helps spot issues including high pressure areas, rack recirculation, and hot spots. This is especially true when retrofitting an existing data center with an AI cluster. Schneider Electric's *IT Design CFD* can quickly model airflow, allowing rapid iteration to find the best design and layout.

## Operations

*EcoStruxure™* is Schneider Electric's open, interoperable, integrated Internet of Things (IOT)-enabled system architecture and platform. It consists of three layers: connected products, edge control, and applications, analytics, and services.

*EcoStruxure Data Center* is a combination of three domains of *EcoStruxure*: Power, Building, and IT. Each domain is focused on a subsystem of the data center: power, cooling, and IT. These three domains combined will reduce risks, increase efficiencies, and speed operations across the entire facility.

- *EcoStruxure Power* monitors power quality, generates alerts, while protecting and controlling the electrical distribution the electrical distribution system of the data center from the MV level to the LV level. It uses any device for monitoring and alerting, uses predictive analytics for increased safety, availability, and efficiency, while lowering maintenance costs.
- *EcoStruxure Building* controls cooling effectively while driving reliability, efficiency, and safety of building management, security, and fire systems. It performs data analytics on assets, energy use, and operational performance.
- *EcoStruxure IT* makes IT infrastructure more reliable and efficient while simplifying management by offering complete visibility, alerting and modelling tools. It receives data, generates alerts, predictive analytics, and system advice on any device to optimize availability and efficiency in the IT space.

There are several options for supervisory visibility and control. *AVEVA Unified Operations Center* can provide visibility at a site or across an entire enterprise.

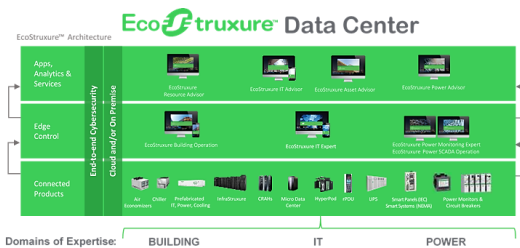
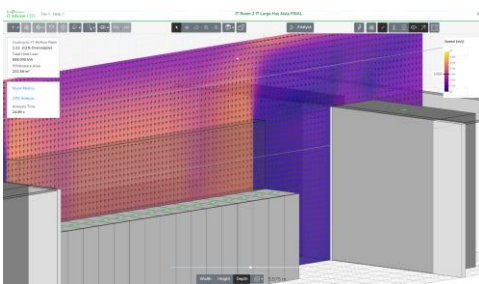
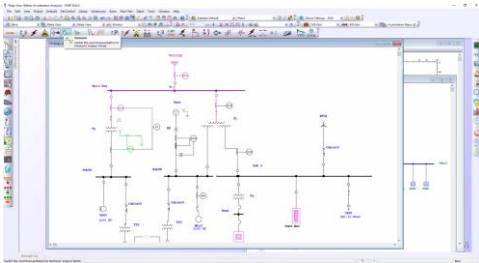

Visit [EcoStruxure for Data Center](#) for more details.

## Design Attributes

OVERVIEW	Value	Unit
Target availability	III	Tier
Annualized PUE at 100% load (1A & 2 / 1B & 2 / 1C & 2)	1.17 / 1.18 / 1.16	San Francisco, CA
	1.22 / 1.23 / 1.21	Dallas, TX
Data center IT capacity	3672 – 3818	kW
Data center overall space	32,920	ft <sup>2</sup>
Maximum rack density	73	kW/rack
FACILITY POWER	Value	Unit
Total facility peak power (IT and cooling)	6500	kW
Total amps (IT main bus, each)	3000	A
Input voltage (IT main bus)	480	V
Switchboard kAIC	65	kA
Generator redundancy (IT main bus)	Distributed redundant	
IT Power path	Dual	
IT space UPS capacity, per powertrain	2500	kW
IT space UPS redundancy	Distributed redundant	
IT space UPS runtime @ rated load	5	minutes
IT space UPS output voltage	480	V
Total amps (facility cooling bus, each)	1600	A
Input voltage (facility cooling bus)	480	V
Switchboard kAIC (facility cooling bus)	35	kA
Generator redundancy (facility cooling bus)	2N	
FACILITY COOLING	Value	Unit
Total max cooling capacity (chillers)	4976 (Dallas), 5450 (San Francisco)	kW
Input voltage	480	V
Heat rejection medium	Chilled water	
Chiller redundancy	N+1	
Outdoor heat exchange	Packaged chiller with free cooling	
CW supply temperature	68 – 70	°F
CW return temperature	86	°F
CW supply temp (IT Room 2, to CDUs)	88	°F
CW return temp (IT Room 2, from CDUs)	104	°F
Combined* storage tank size	989	ft <sup>3</sup>
Ride-through time	5	minutes
Outdoor ambient temperature range	11.1 to 110.5	°F
Economizer type	Water-side	

\*Summation of all three chilled water loops

## Design Attributes continued

IT SPACE	Retrofit room			New room	Total	Unit
	1A	1B	1C	2		
IT load	2010	1864	1864	1808	3672 – 3818	kW
Supply voltage to IT	415	415	415	415	415	V
Maximum density	40	73	73	73	73	kW/rack
Number of racks	110	96	96	32	128 – 142	racks
IT floor space	4467	4467	4467	522	4989	ft <sup>2</sup>
Single or dual cord	Dual	Dual	Dual	Dual	Dual	
CRAC/CRAH type	Fan wall	Fan wall	Fan wall	Fan wall	Fan wall	
CRAC/CRAH redundancy	N+1	N+1	N+1	N+1	N+1	
CRAC/CRAH supply air temperature	79	79	79	79	79	°F
Containment type	Ducted hot aisle	Ducted hot aisle	Ducted hot aisle	Ducted hot aisle	Ducted hot aisle	
CDU Type	N/A	L2A	L2L	L2L		
CDU redundancy	N/A	N	N+1	N+1		
CW supply temperature	68	68	68	21		°F
CW return temperature	86	86	86	30		°F
CDU CW supply temperature	N/A	N/A	68	88		°F
CDU CW return temperature	N/A	N/A	86	104		°F
TCS loop supply temperature	N/A	104	104	104		°F
TCS loop return supply temperature	N/A	122	122	122		°F

# Schneider Electric Lifecycle Services

High-density AI clusters push the limits of data center facility infrastructure, so it’s critical to leverage advanced planning and operations tools to ensure safe and reliable operations. To ensure cost-competitive and reliable data center operation over the data center’s lifecycle, data center operators must adopt new ways of adapting to mounting operational complexity.

While AI Factories represent new opportunities for data centers, AI Factories will also bring about many challenges to data center operators. Data centers today are facing increasing OpEx burdens driven by maintaining critical power, cooling, and IT infrastructure. Meanwhile, staffing qualified engineers and technicians to oversee and service that infrastructure has gotten highly competitive, and all pieces of this infrastructure are set to be pushed to the cutting edge by AI workloads and variability. It is critical to build intelligent, reliable infrastructure and systems that can meet the challenges ahead and adapt to the next generation of data center computing.

## Design and Build for the Entire Lifecycle of the AI Factory

Intelligent infrastructure starts at the design phase. While digitizing and monitoring critical assets is essential at every phase of a data center’s lifecycle, ensuring digital-ready infrastructure at the outset of data center design avoids costly, disruptive shutdowns that may likely leave gaps in monitoring coverage. Designing with digital services in mind leads to a seamless system ready to deliver real-time insights from day one – meaning, a data center designed for the future.

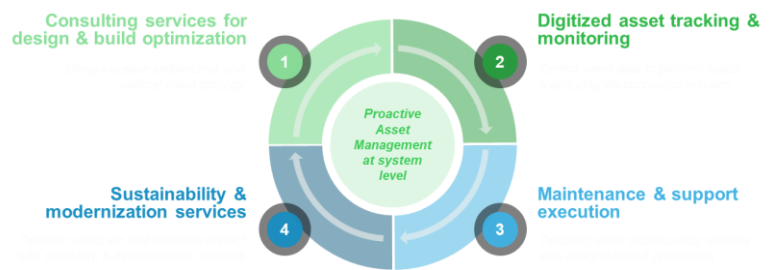

## EcoConsult

Whether a data center operator is using a brand-new facility, upgrading an existing facility, or repurposing a non-data center facility to be equipped to support an AI Factory, it is critical to leverage advanced planning and operations tools to ensure safe and reliable operations. EcoConsult is a comprehensive portfolio of best-in-class data center solutions, from hardware to software & services. Continuous reevaluation as the next generation of technology enters data centers is critical to ensuring success in the next phase of the data center evolution. Schneider Electric delivers an integrated engineering approach purpose-built for AI and high-density data centers, where power density, thermal constraints, and operational risk are amplified. **Design** and **system studies** validate electrical and thermal architectures upfront to support high-density GPU clusters, ensuring safety, power quality, coordination, and resilience before deployment. **Audits** establish a clear baseline of readiness for existing facilities being retrofitted for AI workloads, identifying risks tied to capacity, protection, and operational continuity. The **Electrical Digital Twin** connects design intent with real-world operations, providing a living model of the electrical network to manage rapid load growth, enable scenario analysis, and maintain reliability as AI demand scales.

## Future Ready Data Center Life Extension with EcoFit

After evaluating existing infrastructure, addressing any outdated equipment should be a key priority. Outdated equipment and installations waste energy and increase operating costs, reducing efficiency. EcoFit helps data center operators solve these problems and modernize equipment and installations at the level needed to ensure a future ready data center. It enables high-performance digital technologies and supports your decarbonization journey by leveraging circularity services.

- *EcoFit Essential:* Upgrade your existing equipment with new features.
- *EcoFit Advanced:* Replace the core components with active and natively connectable new components.
- *EcoFit Replacement:* Get a comprehensive replacement with one of our latest equipment products/platforms/solutions.

## Operate and Maintain with EcoCare

Get the most out of equipment installation through its entire lifecycle with EcoCare service plans for next-level predictive, preventive, and onsite maintenance. EcoCare from Schneider Electric is a subscription-based service plan offering 24/7 proactive remote monitoring, AI-powered predictive analytics through EcoStruxure, and expert on-site and remote support for electrical equipment and building management systems. EcoCare enables operators to revolutionize how they maintain their critical assets through condition-based maintenance.

## Systemic AI-Driven Condition-Based Maintenance

Traditional time-based maintenance approaches are poorly suited for AI and high-density environments, where load profiles, thermal behavior, and failure modes change rapidly. Because time-based maintenance is disconnected from real-time asset health, it often results in over-maintenance, unnecessary interventions, and increased risk of human error. In contrast, AI-enabled condition-based maintenance is designed around continuous visibility into critical power and cooling infrastructure, using real-time data, advanced analytics, and strategic sensor placement to detect early failure indicators. This design-led approach enables proactive intervention before faults occur, reducing unplanned downtime, and allowing maintenance to be executed based on actual equipment condition rather than fixed intervals. A condition-based strategy leads to improving resilience, lowering risk, and optimizing operational efficiency in high-density AI data centers. The Health Index in EcoStruxure translates real-time asset data, AI analytics, and deep domain expertise into a single, intuitive view of equipment health across the entire data center. By combining simple, at-a-glance visibility with the ability to drill into asset-level detail, the Health Index enables engineers and technicians to prioritize risk, make informed maintenance decisions, and manage their full asset portfolio with confidence.

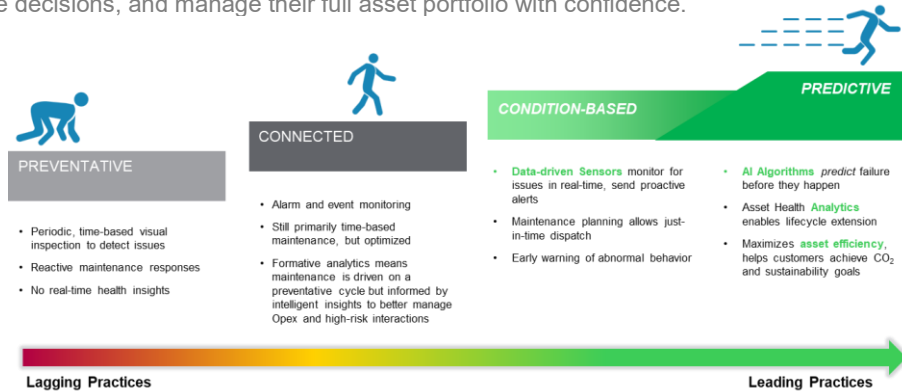

### What are system-level analytics?

A data center is made up of systems within systems. Any solution monitoring critical assets within a data center needs to not only understand the performance of each individual asset but also the performance of its surrounding systems. Considering the entire system unlocks deeper understanding of critical data center infrastructure.

While this does mean evaluating enormous amounts of data, AI is enabling the change from an asset level approach to an end-to-end systemic approach. Schneider Electric’s AI Hub is a global center of excellence that combines data science expertise with Schneider Electric’s domain expertise to create valuable insights to data center systems. This leading hub looks to continue its intense growth to match pace with the need for technological & operational advancements within Data Centers.

#### Examples of system level analytics:



#### In operation today:

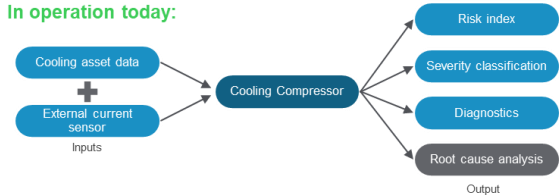

### Data Aggregation and Collection

At the asset level, EcoStruxure aggregates data from a variety of intelligent sensors, including, thermal and environmental sensors for switchgear, partial discharge sensors, CDU controllers, oil transformer condition sensing, and leak detection for liquid cooling. Critical asset data can be collected through a variety of methods on-site. Schneider Electric solution architects and subject matter experts work with end users to ensure the necessary data is aggregated from the customer’s BMS, EPMS, DCIM, and/or a corporate data lake. Collected data is then reviewed by AI-driven models and validated by Schneider Electric’s subject matter experts, bringing decades of experience across power and cooling systems

### Cybersecurity & Connectivity

Cybersecurity is embedded by design across Schneider Electric’s AI-ready CBM and analytics architecture, ensuring that the massive volumes of operational and performance data generated by high-density AI infrastructure can be securely collected, transported, and analyzed. From intelligent devices and sensors to edge and cloud platforms, security controls are integrated across every layer to protect system integrity, data availability, and performance.

All connected components and digital services are designed and maintained in accordance with ISO/IEC 27001 information security management practices and SOC 2 Type II compliance requirements for cloud-hosted CBM platforms. These frameworks govern our access control, data governance, & incident response methodologies to ensure protection of operational and performance data.

# Get more information for this design:

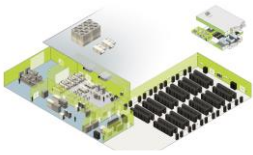

3D spatial views

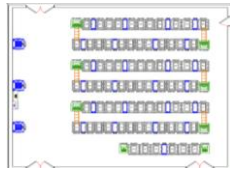

Floor layouts

## Engineering Package

Every reference design is built with technical documentation for engineers and project managers. This includes engineering schematics (CAD, PDF), floor layouts, equipment lists containing all the components used in the design and 3D images showing real world illustrations of our reference designs.

Documentation is available in multiple formats to suit the needs of both engineers and managers working on data center projects. For the engineering package of this design please email us at [referencedesigns@se.com](mailto:referencedesigns@se.com)

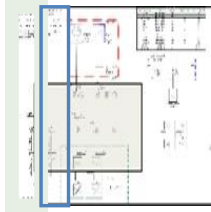

One-line schematics



Bill of materials

Email [referencedesigns@se.com](mailto:referencedesigns@se.com) for further assistance