

Thank you for choosing **Schneider Electric** Pieno's electronic accessories. Pieno pushes the boundaries of switch design by maximizing the jumbo dolly with slim edges, Pieno maintains an overall slim profile, despite the jumbo dolly thanks to the innovative S5 Mechanism and patented PerfectFace Switch Architecture. These two innovations also enable quick and high quality installation on any wall surface.

IMPORTANT NOTE

1. The products must be installed by qualified electricians.
2. Please check your local wiring regulations before installation.
3. Safekeeping the faceplate to prevent damage during product installation.
4. Turn off the power supply when you clean the product. Use a soft, slightly-moistened cloth or tissue paper to wipe off the dust and dirt on the surface. Clean with much diluted detergent if necessary but avoid using corrosive chemicals.

MOUNTING INSTRUCTION

1. Connect the wires to the terminals (recommend to leave 10-12mm bare metal wire) and tighten the terminal screws.
2. Screw the grid plate onto the wall box.
3. Snap the faceplate onto the grid plate.

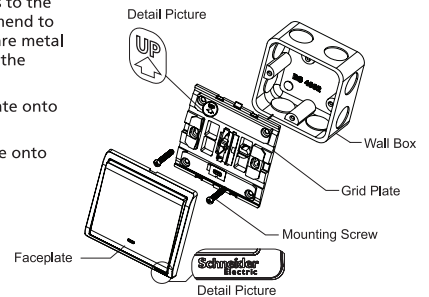

Insert a screwdriver into the clip lock, and twist the screwdriver to remove the faceplate.

