

Rotary module

User Guide



Art. no. MEG5252-03../-04..

Necessary accessories

- To be completed with:
- corresponding inserts (see function overview)
- Frame in corresponding design

For your safety

⚠ ⚠ DANGER

HAZARD OF ELECTRIC SHOCK, EXPLOSION, OR ARC FLASH

Safe electrical installation must be carried out only by skilled professionals. Skilled professionals must prove profound knowledge in the following areas:

- Connecting to installation networks
- Connecting several electrical devices
- Laying electric cables
- Safety standards, local wiring rules and regulations

Failure to follow these instructions will result in death or serious injury.

⚠ ⚠ DANGER

HAZARD OF ELECTRIC SHOCK

The PlusLink carries an electrical current and the outputs may carry an electrical current even when the device is switched off.

- Before working on the device or the loads, always disconnect the device from the supply via the upstream miniature circuit breaker.

If one or more PlusLink lines are separately fused in your installation then they are not electrically isolated from one another.

- In this case, you should use the PlusLink Expander.

Failure to follow these instructions will result in death or serious injury.

Notice

HAZARD OF EQUIPMENT DAMAGE

The voltage difference between different phases can damage the device.

- Connect all connected devices of one or several PlusLink lines to the same phase or use a PlusLink Distributor for cross-phase installation.

Ensure that the device is disconnected from its circuit during the insulation resistance test.

Failure to follow these instructions can damage the device.

Getting to know the rotary module

With the rotary module (referred to below as **module**), you can carry out various functions such as:

- Switching, dimming and controlling blinds
- Calling up, changing and saving Basic light and blind scenes

Function overview of the modules on receiving inserts

Complete the module with the receiving inserts for switching, dimming or controlling blinds/roller shutters in order to carry out **local** light and blind control.

Switching:

• Electronic switch insert	Local switching, calling up and saving local light scenes
• Relay switch insert	
• Electronic switch insert, 2-gang	Separate switching of both channels locally
• Relay switch insert, 2-gang	

Dimming:

• Universal dimmer insert	Local switching and dimming, calling up and saving local light scenes
• 1-10 V control insert	
• DALI insert	
• Universal dimmer insert, 2-gang	Separate dimming of both channels locally

Controlling blinds/roller shutters:

• Blind control insert	Local raising/lowering, calling up and saving local Basic blind scenes
------------------------	--

Function overview of the modules on sending inserts

Complete the module with the sending central unit insert in order to carry out **global** light and blind control via the PlusLink (PL).

Global light and blind control:

• Central unit insert	global switching, global dimming, global raising/lowering, calling up and saving global Basic light/ blind scenes
-----------------------	---

Connections, displays and operating elements

Front:

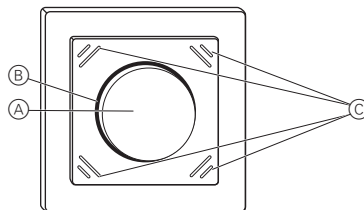

- (A) Rotary knob
- (B) LED segments (status, orientation)
- (C) Module push-buttons

Rear:

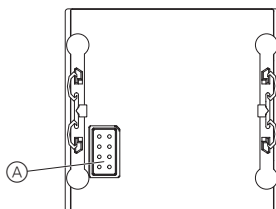

- (A) Module interface

Mounting the module

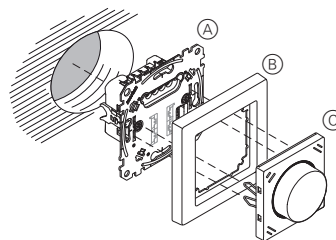

- (A) Insert (see function overview)
- (B) Frame
- (C) Module

i An initialisation period of approx. 15 s begins when mains voltage is switched on or the module is plugged in. The LED segments flash during this initialisation period. After this period has elapsed, the module is ready for operation.

Operating the module: local light and blind control

"Blind/roller shutter" will be referred to below as just "blind".

Switching loads on/off

In combination with 1-gang insert

- With push-buttons

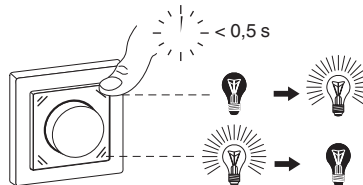

- With rotary knob
 - by rotating or briefly pressing the knob

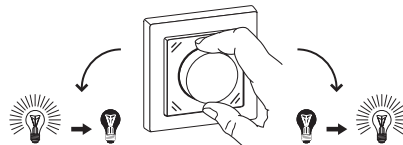

i With dimmer inserts a quick half turn is required to switch directly to full brightness.

In combination with 2-gang insert

- With push-buttons
 - right push-button: channel 1
 - left push-button: channel 2

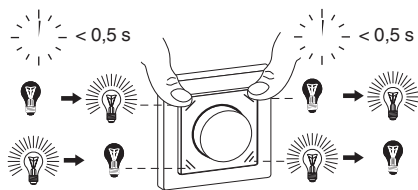

- With rotary knob
 - switch both channels together by rotating or briefly pressing the knob.

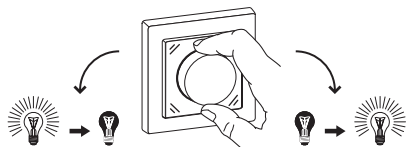

i If a channel is already switched on, then pressing the rotary knob will switch this channel off. If both channels are in the same state, then pressing the rotary knob will switch both channels together.

Dimming loads

In combination with 1-gang insert

- With push-buttons

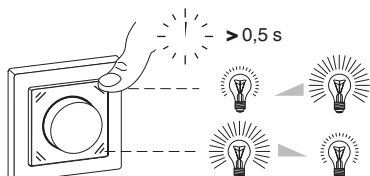

- With rotary knob
 - by rotating the knob

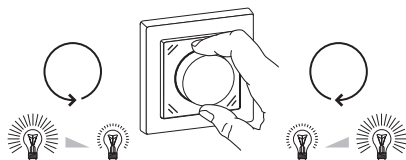

In combination with 2-gang insert

- With push-buttons
 - right push-button: channel 1
 - left push-button: channel 2

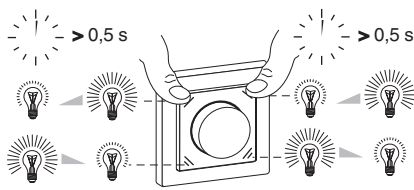

- With rotary knob
 - dim both channels together.
 - simultaneously to max. / min. brightness.

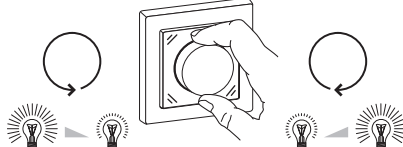

i If the channels have different brightness values then the difference between these remains constant when dimming to max. / min. brightness. When one channel reaches the max. / min. brightness, the difference is reduced until the common max. / min. brightness is reached.

Controlling blinds

- With push-buttons
 - raising/lowering ($> 0.5\text{ s}$)
 - up/down in steps ($< 0.5\text{ s}$)

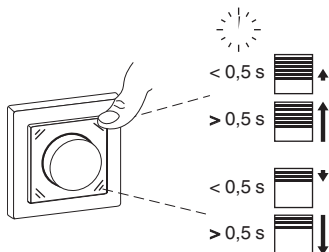

- With rotary knob
 - raising/lowering (fast half turn of the knob)
 - up/down in steps (slow rotation of the knob)

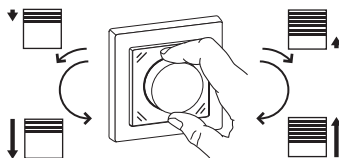

Retrieving local light or blind scenes

(Only in combination with 1-gang inserts)

Standard scenes

All devices are delivered from the factory with presettings for a light or blind scene.

Left upper push-but- Light on (100%) / blind up
ton:
Left lower push-but- Light off / blind down
ton:

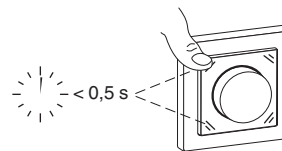

- 1 Retrieve scene: press the left **upper** push-button or the left **lower** push-button **briefly**.
- The devices of the light scene adopt the saved brightness value.
- The devices of the blind scene initially move to the upper position. After a running time of 2 minutes, they move to the saved position.

Changing and saving local light scenes

(Only in combination with 1-gang inserts)

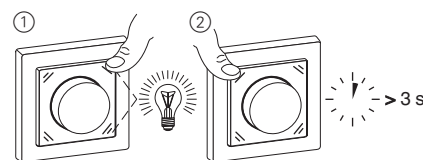

- 1 Set the brightness value.
- 2 Save scene: press and **hold** the left **upper** push-button or the left **lower** push-button.

All lamps are switched off briefly and then back on again to indicate that the saving procedure was successful. Then the lamps adopt the saved brightness value.

Changing and saving local Basic blind scenes

For Basic blind scenes, you can only save the fixed position values of "fully up/down".

- 1 Move the blind to the upper position and wait for the running time of 2 minutes until the LED segments go out.

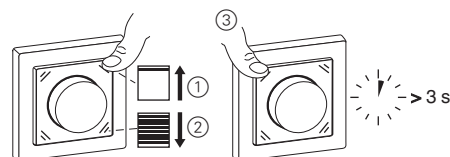

- 2 Set the desired position of the blind:
 - Position "up": no further settings required
 - Position "down": lower the blind
- 3 Save scene: press and **hold** the left **upper** push-button or the left **lower** push-button.

The blinds are lowered and raised by one step to indicate that the saving procedure was successful.

Controlling the module from another location

Controlling connected loads from another location via PlusLink with

- Central unit insert or side controller Plus, 1-gang/2-gang: switching, dimming, controlling blinds and retrieving scenes
- Mechanical push-button/double push-button

Operating the module: global light and blind control via PlusLink

- i** The global control via PlusLink is possible with the combination of a central unit insert and a rotary module.

Global light control

Example of globally switching on/off and dimming the 1-4 PL lines

Pressing the right push-button of the rotary module on the central unit insert controls all loads in the PL lines together:

- Short press on the push-button (< 0.5 s): switching on/off
- Long press on the push-button (> 0.5 s): dimming

- i** Rotating the knob has no effect on the loads in the PL lines.

- i** Pressing the knob switches off all loads in the PL lines and lowers the blinds by one step.

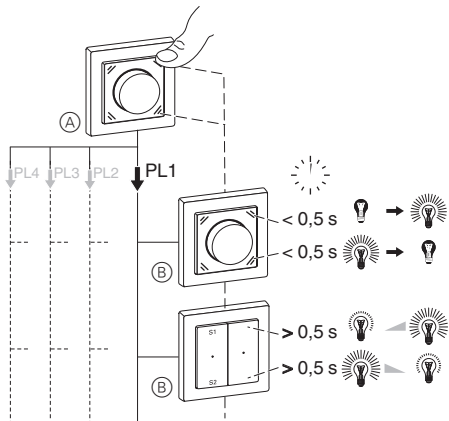

- (A) Module on central unit insert
- (B) Inserts for switching and dimming (see function overview)

Global blind control

Example of global raising/lowering and up/down in steps of the 1-4 PL lines

Pressing the right push-button of the rotary module on the central unit insert controls all loads in the PL lines together:

- Long press on the push-button (> 0.5 s): raising/lowering
- Short press on the push-button (< 0.5 s): up/down in steps

- i** Rotating the knob has no effect on the loads in the PL lines.

- i** Pressing the knob switches off all loads in the PL lines and lowers the blinds by one step.

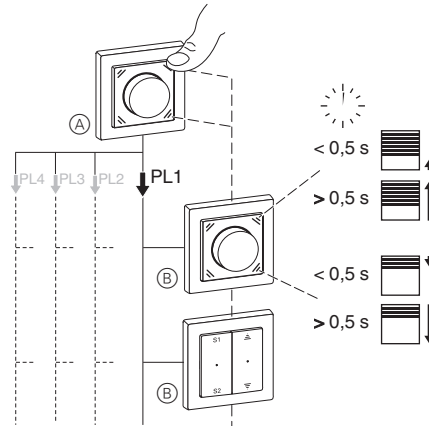

- (A) Module on central unit insert
- (B) Blind control insert

Operating the module: retrieving, changing and saving global scenes via PlusLink

- i** Global scenes via PlusLink are possible with the combination of central unit insert and rotary module.

- i** When you save a scene, this affects **all** connected devices of the PL lines.

Proceed as follows to change and save a scene according to your requirements:

- 1 Change the states of individual devices in the light and/or blind scene.
- 2 Save the scene.

Retrieving global light or blind scenes

Standard scenes

All devices are delivered from the factory with presettings for a light or blind scene.

- Left upper push-button: Light on (100%) / blind up
- Left lower push-button: Light off / blind down
- Panic button: Light on (100%) / blind down

- 1 Retrieve scene: press the left **upper** push-button or the left **lower** push-button **briefly**.
 - The devices of the light scene adopt the saved brightness value.
 - The devices of the blind scene initially move to the uppermost position. After the set running time has elapsed (the standard is 2 minutes), the blinds move to the saved position.

Changing and saving light scenes

Using a dimmer as an example:

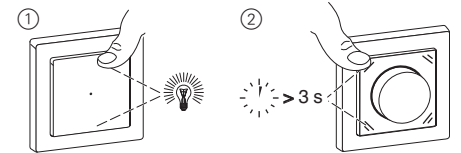

- 1 Set the brightness values of the lamps that you want to change on the receiving device.
- 2 Save scene: press and **hold** the left **upper** push-button or the left **lower** push-button.

All lamps are switched off briefly and then back on again to indicate that the saving procedure was successful. Then the lamps adopt the saved brightness value.

Changing and saving blind scenes

In combination with the rotary module or push-button module Basic on the receiving insert, you can only save the fixed position values of "fully up/down" (1(A)) for blind scenes.

In combination with the push-button modules Comfort, Comfort Plus and Wiser on the receiving insert, you can save any position values (1B).

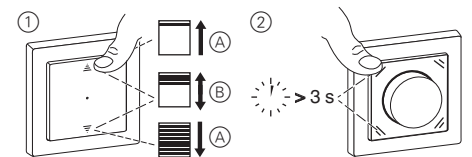

- 1 (A) Set the positions (fully up/down) of the blinds that you want to change on the receiving device.
 - (B) Set the positions (any values) of the blinds that you want to change on the receiving device.
- 2 Save scene: press and **hold** the left **upper** push-button or the left **lower** push-button.

The blinds are lowered and raised by one step to indicate that the saving procedure was successful.

Operating the module: basic functions

Status display

In combination with 1-gang insert

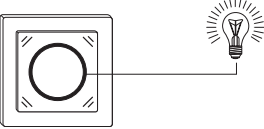
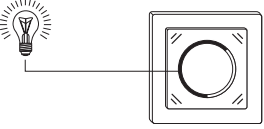
Operation	Status feedback
Switching 	All LED segments light up when the load is switched on
Dimming 	The LED segments light up corresponding to the brightness of the load

In combination with 2-gang insert

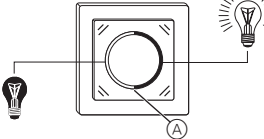
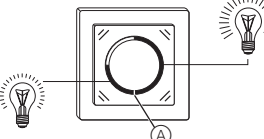
Operation	Status feedback
Switching 	<ul style="list-style-type: none"> The LED segments to the right of (A) show the status of channel 1 The LED segments to the left of (A) show the status of channel 2
Dimming 	<ul style="list-style-type: none"> The LED segments to the right of (A) show the dimming status of channel 1 The LED segments to the left of (A) show the dimming status of channel 2

In combination with a blind control insert

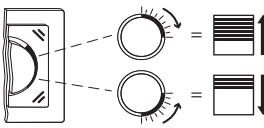
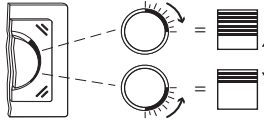
Operation	Status feedback
Raising/lowering 	<ul style="list-style-type: none"> A rotating LED indicator shows the direction of movement of the blind. Upwards in a clockwise direction. Display during the running time (max. 2 min)
Up/down in steps 	<ul style="list-style-type: none"> A rotating LED indicator moves according to the blind direction. Upwards in a clockwise direction. Display: half turn

Setting the brightness of the status display

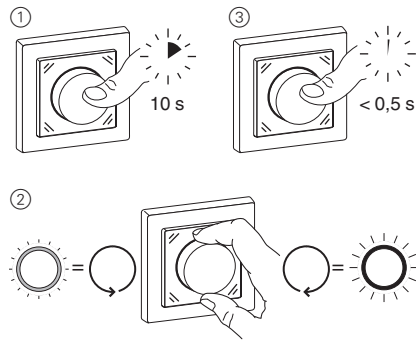

Switching orientation lighting on/off

All LED segments light up at min. brightness.

Standard: switched off

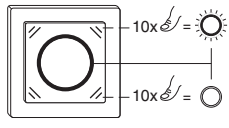
Operation	Status feedback
	Upper LED segments flash 4 times

Switching memory function on/off

(Only in combination with dimmer inserts)

The device memorises the brightness level that was last set.

Standard: switched off

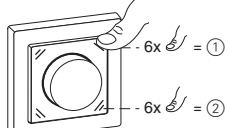
Operation	Status feedback
	Right LED segments flash 4 times

- Switching on memory function
- Switching off memory function

Resetting to default settings

Operation	Status feedback
	All LED segments flash 8 times

Changing operating mode

(Only available for modules with software from version 0B in combination with universal dimmer insert, 1-gang, art. no. MEG5171-0000 from version 0B)

The insert automatically recognises the connected loads. In some cases, the connected LED lamps may not work correctly with the automatic load detection. In this case you can switch the operating mode to RL LED (from trailing edge phase to leading edge phase).

i In the operating mode "leading edge phase for LED lamps" (RL LED mode), LED lamps can only be connected up to a lower dimmer load. (See operating instructions "Universal dimmer insert".)

Standard: automatic load detection

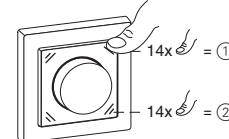
Operation	Status feedback
	Lower LED segments flash 4 times

- Setting the RL LED mode
- Resetting to automatic load detection

Technical data

Display elements:	8 LED segments
Operating elements:	<ul style="list-style-type: none"> 4 push-buttons Rotary knob/push-button module interface with 8 contact pins
Connection:	

 Dispose of the device separately from household waste at an official collection point. Professional recycling protects people and the environment against potential negative effects.

Merten GmbH

Fritz-Kotz-Str. 8
51674 Wiehl - Germany
se.com/contact

Schneider
Electric