

FRONT VIEW

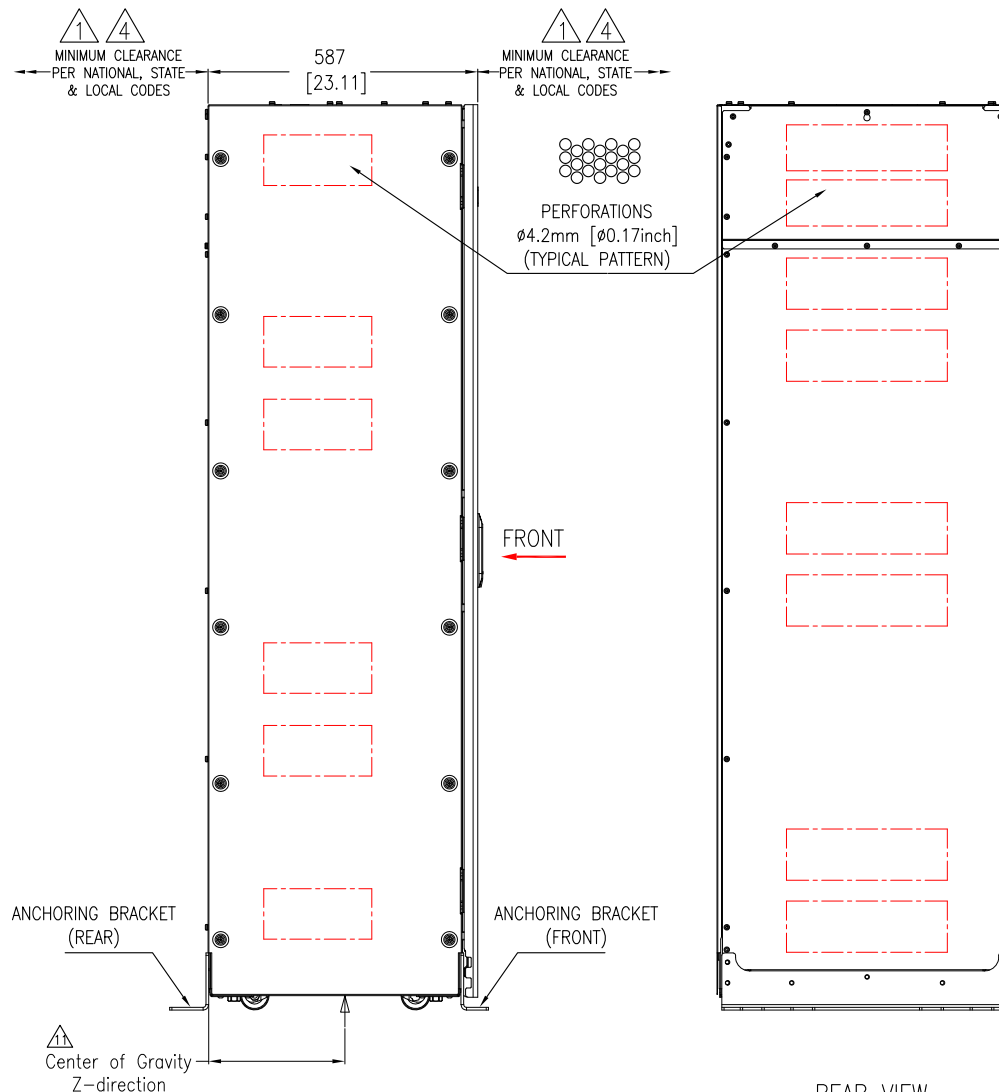

LEFT SIDE VIEW

REAR VIEW

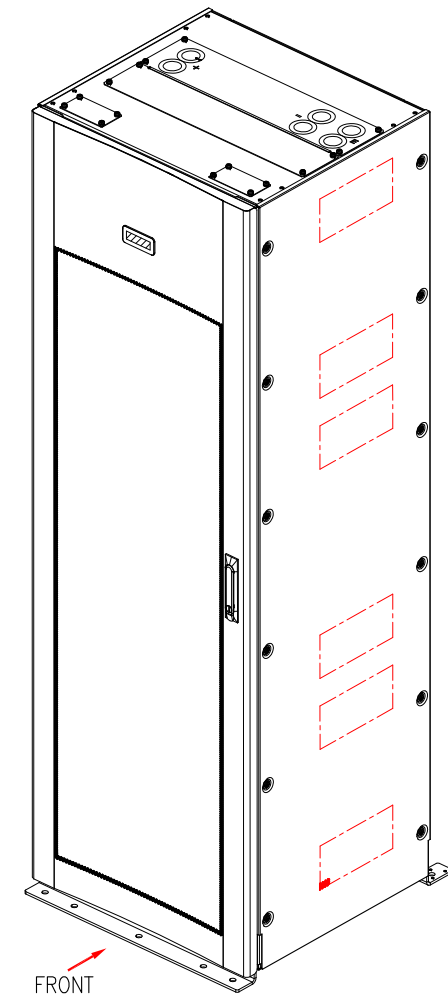

ISOMETRIC VIEW

NOTES:

- △ 1. INSTALLATION SHALL COMPLY WITH ALL APPLICABLE NATIONAL, STATE AND LOCAL ELECTRICAL REGULATIONS.
2. REFER TO PRODUCT DOCUMENTATION FOR ADDITIONAL DETAILS PRIOR TO INSTALLATION AND SITE PREPARATION WORK.
3. ALL DIMENSIONS ARE IN MILLIMETERS [INCHES].
- △ 4. A MINIMUM OF 1000mm [39.37 Inches] FRONT, 100mm [3.94 Inches] TOP CLEARANCE REQUIRED. 100mm [3.94 Inches] REAR CLEARANCE IS REQUIRED ONLY FOR SEISMIC ANCHORING INSTALLATION. CLEARANCE DIMENSIONS ARE FOR AIRFLOW AND SERVICE ACCESS ONLY.
- △ 5. ALL DIMENSIONS EXCLUDES SCREW PROJECTION OUTSIDE THE ENCLOSURE.
6. CABLE ENTRY IS FROM TOP OF THE UNIT.
- △ 7. REFER TO TABLE FOR APPLICABLE SKUs & WEIGHT DETAILS. WEIGHT OF ONE BATTERY MODULE IS 16.5 kg [36.38 lb].
8. COLOR: RAL9003, GLOSS LEVEL 85%.
9. PROTECTION CLASS: IP20.
10. OPERATING TEMPERATURE: 18 – 28°C [64 – 82°F].
TO OPTIMIZE THE LIFE OF BATTERY, IT IS RECOMMENDED TO MAINTAIN 25°C [77°F].
- △ 11. THIS INFORMATION PROVIDES APPROXIMATE CENTER OF GRAVITY CALCULATION.
12. BATTERY RACKS CAN BE BAYED SIDE BY SIDE AND BACK TO BACK. REFER TO INSTALLATION MANUAL FOR DETAILS.



SKU NUMBER	WEIGHT IN kg [lb]		COG IN mm [Inch]					
	Empty Rack	Fully loaded Rack	Empty Rack			Fully loaded Rack		
			X-diection	Y-direction	Z-direction	X-diection	Y-direction	Z-direction
LIBSESMG13IEC	211 [465]	415 [915]	321.5 [12.66]	1031.5 [40.61]	311.2 [12.25]	317.8 [12.51]	1061.4 [41.79]	282.4 [11.12]

THIS DRAWING AND SPECIFICATIONS HEREIN ARE THE PROPERTY OF SCHNEIDER ELECTRIC AND SHALL NOT BE COPIED, REPRODUCED OR USED IN WHOLE OR IN PART, AS THE BASIS FOR THE MANUFACTURE OR SALE OF ITEMS WITHOUT WRITTEN PERMISSION FROM SCHNEIDER ELECTRIC. THIS DRAWING IS BASED UPON LATEST AVAILABLE INFORMATION AND IS SUBJECT TO CHANGE WITHOUT NOTICE.

Schneider Electric

TITLE:
Lithium-ion Battery cabinet
Symmetra MW, IEC
GENERAL ARRANGEMENT

PROJECT: SUBMITTAL DRAWINGS SHEET 1 OF 9

DWG NO: LIBSESMGMWIEC
DRAWN: JAYAPRAKASH
ENGINEER: Fred XIA
APPROVED: Rick ZHANG

REV. 0
03-DEC-21
14-DEC-21
14-DEC-21
FIRST ANGLE PROJECTION

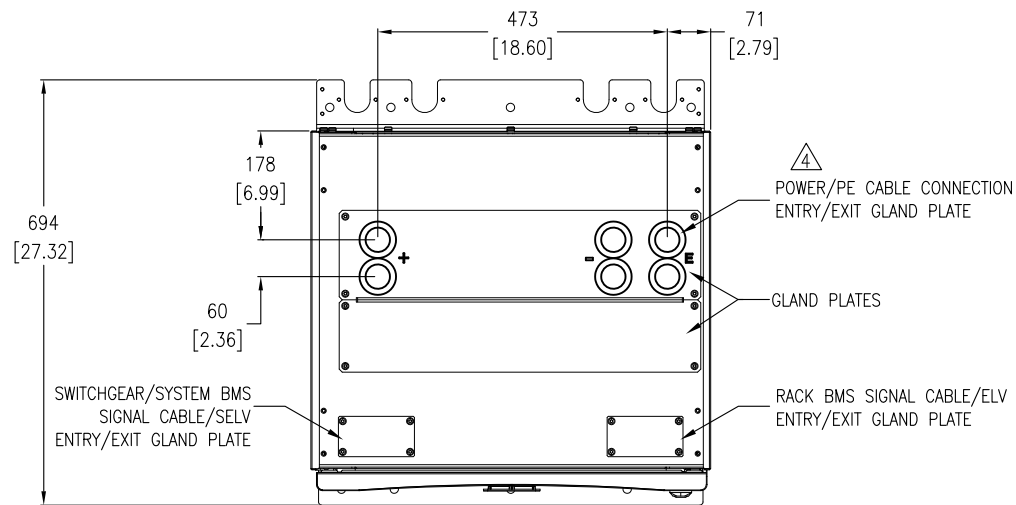

FRONT
TOP VIEW

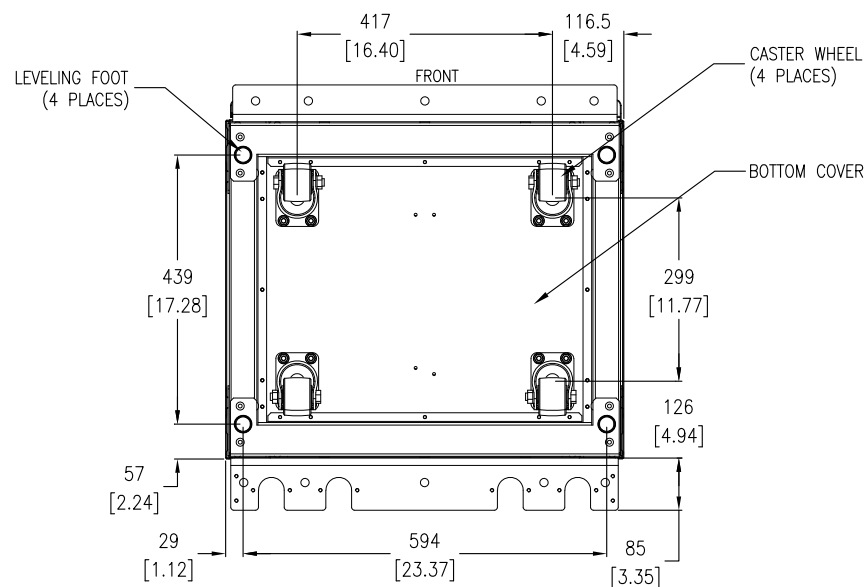

BOTTOM VIEW

- NOTES:
1. INSTALLATION SHALL COMPLY WITH ALL APPLICABLE NATIONAL, STATE AND LOCAL ELECTRICAL REGULATIONS.
 2. REFER TO PRODUCT DOCUMENTATION FOR ADDITIONAL DETAILS PRIOR TO INSTALLATION AND SITE PREPARATION WORK.
 3. ALL DIMENSIONS ARE IN MILLIMETERS [INCHES].
 4. DO NOT DRILL/PUNCH HOLES WITH THE GLAND PLATES INSTALLED.
REMOVE THE GLAND PLATE FROM BATTERY RACK BEFORE DRILLING/PUNCHING.
DRILL/PUNCH HOLES ACCORDING TO THE LABEL ON THE GLAND PLATE.
 5. USE ACCESSORY KIT (0M-95331) TO ANCHOR THE UNIT IN SEISMIC LOCATION.
FOR SEISMIC ANCHORING, M12 SCREWS OF STRENGTH GRADE 8.8 HARDWARE ARE REQUIRED TO BE USED.

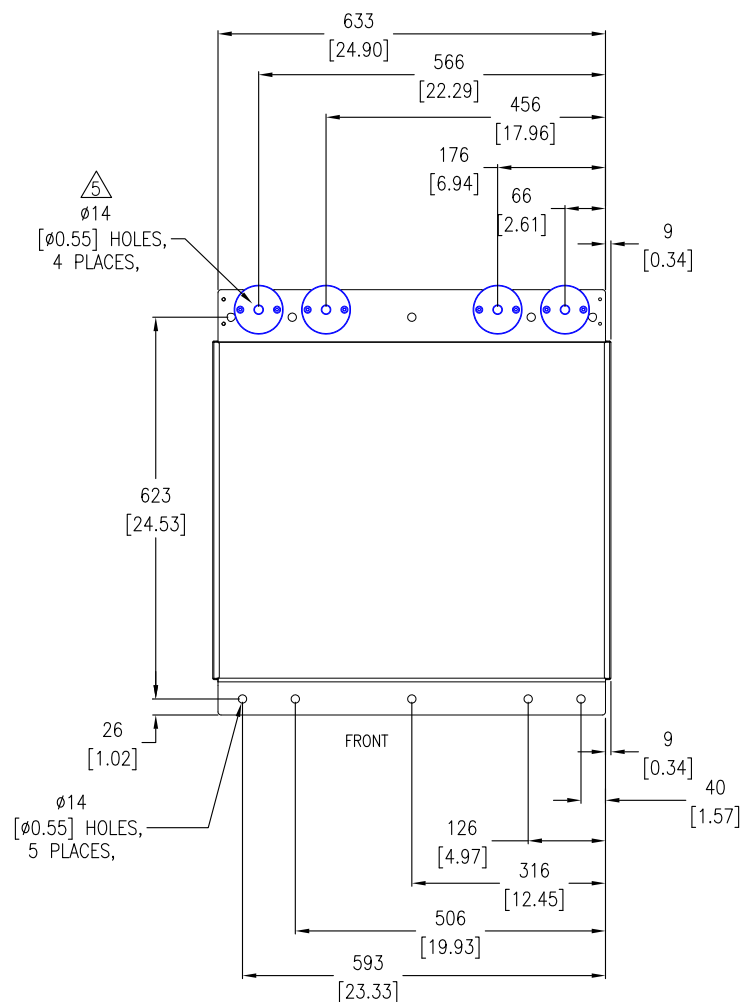

SEISMIC ANCHORING DETAILS - 1 BATTERY RACK

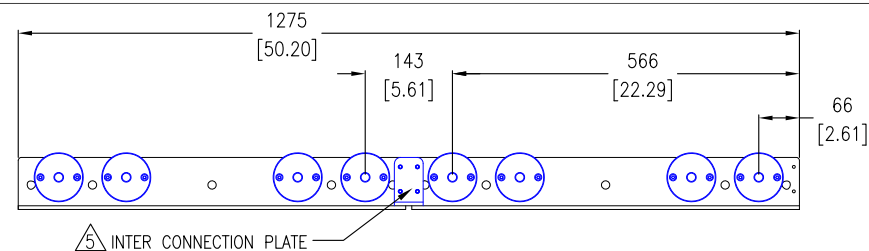

SEISMIC ANCHORING DETAILS FOR MORE THAN ONE BATTERY RACK

THIS DRAWING AND SPECIFICATIONS HEREIN ARE THE PROPERTY OF SCHNEIDER ELECTRIC AND SHALL NOT BE COPIED, REPRODUCED OR USED IN WHOLE OR IN PART, AS THE BASIS FOR THE MANUFACTURE OR SALE OF ITEMS WITHOUT WRITTEN PERMISSION FROM SCHNEIDER ELECTRIC. THIS DRAWING IS BASED UPON LATEST AVAILABLE INFORMATION AND IS SUBJECT TO CHANGE WITHOUT NOTICE.

Schneider Electric

TITLE:
Lithium-ion Battery cabinet
Symmetra MW, IEC
TOP/BOTTOM VIEW & ANCHORING DETAILS

PROJECT: SUBMITTAL DRAWINGS SHEET 2 OF 9

DWG NO: LIBSESMGMWIEC
DRAWN: JAYAPRAKASH
ENGINEER: Fred XIA
APPROVED: Rick ZHANG

REV: 0
03-DEC-21
14-DEC-21
14-DEC-21
FIRST ANGLE PROJECTION

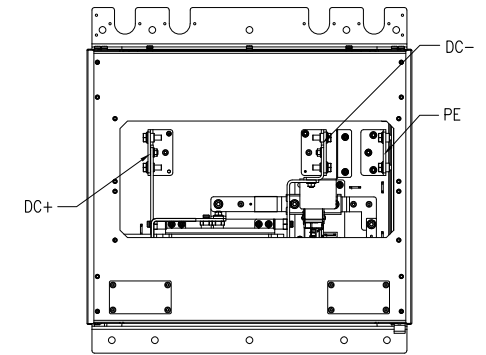
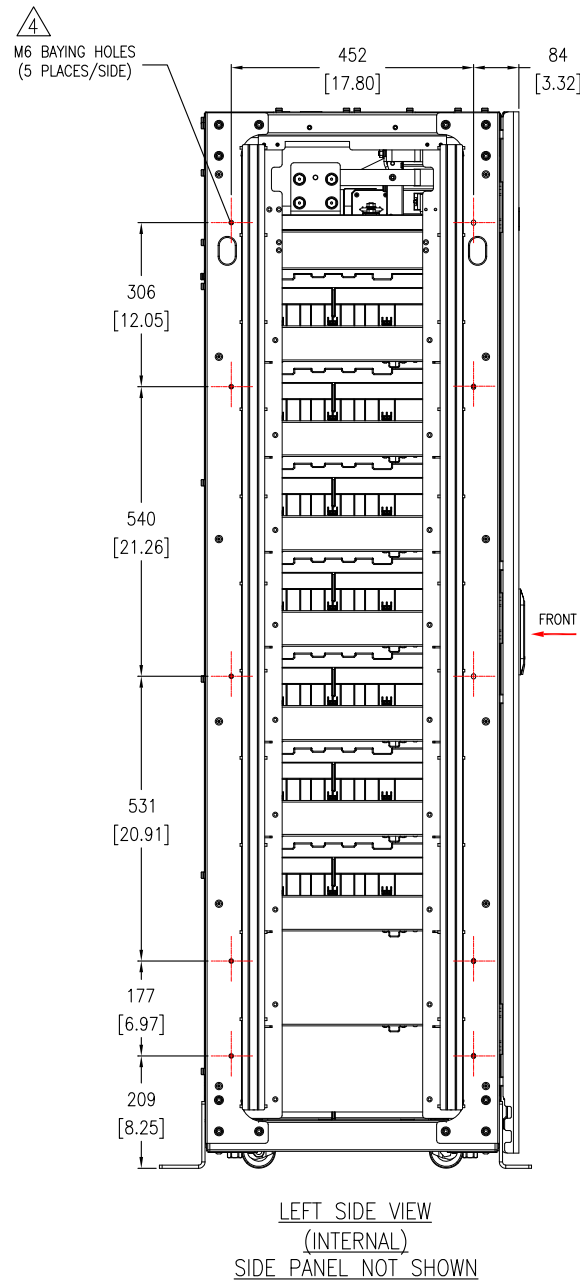
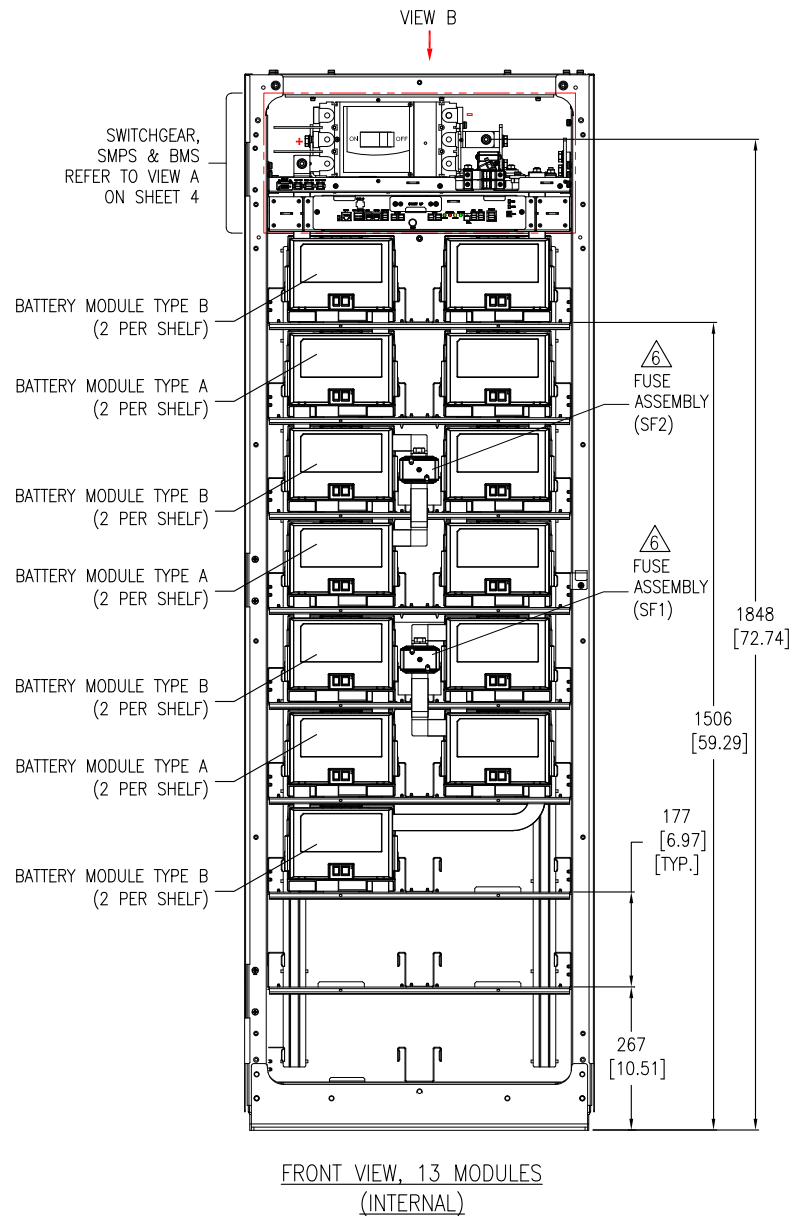

VIEW B
GLAND PLATES NOT SHOWN

BUSBAR DETAILS

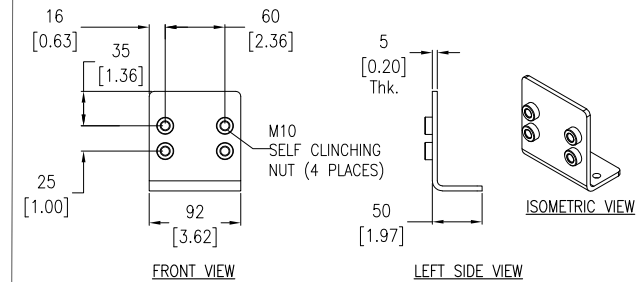

BUSBAR PE

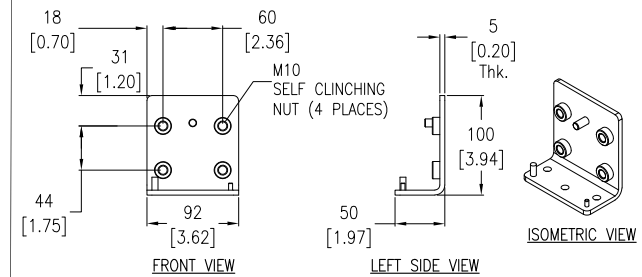

BUSBAR DC+/DC-

NOTE: BOLT AND NUTS ARE PROVIDED WITH THE TERMINALS.
RECOMMENDED TORQUE FOR M10 BOLTS IS 30Nm [22.13 lb-ft].

- NOTES:
1. INSTALLATION SHALL COMPLY WITH ALL APPLICABLE NATIONAL, STATE AND LOCAL ELECTRICAL REGULATIONS.
 2. REFER TO PRODUCT DOCUMENTATION FOR ADDITIONAL DETAILS PRIOR TO INSTALLATION AND SITE PREPARATION WORK.
 3. ALL DIMENSIONS ARE IN MILLIMETERS [INCHES].
 - △ 4. USE M6x16 SCREWS FOR MOUNTING MULTIPLE RACKS SIDE BY SIDE. REMOVE SIDE PANELS OF ADJACENT BATTERY RACKS WHILE BAYING.
 5. THE SYSTEM BMS IS LOCATED IN BATTERY RACK 1 ONLY.
 - △ 6. FUSE TYPE: Merson MPN PC33UD69V500TF OR LITTLEFUSE MPN PSR033FL0500Z WITH 500A 600Vdc 100KAIC.
 7. SOME STRUCTURAL DETAILS HAVE BEEN OMITTED FOR THE PURPOSE OF CLARITY.

THIS DRAWING AND SPECIFICATIONS HEREIN ARE THE PROPERTY OF SCHNEIDER ELECTRIC AND SHALL NOT BE COPIED, REPRODUCED OR USED IN WHOLE OR IN PART, AS THE BASIS FOR THE MANUFACTURE OR SALE OF ITEMS WITHOUT WRITTEN PERMISSION FROM SCHNEIDER ELECTRIC. THIS DRAWING IS BASED UPON LATEST AVAILABLE INFORMATION AND IS SUBJECT TO CHANGE WITHOUT NOTICE.

Schneider Electric

TITLE:

Lithium-ion Battery cabinet
Symmetra MW, IEC
INTERNAL VIEW

DWG NO:

LIBSESMGMWIEC

REV. 0

DRAWN:

JAYAPRAKASH

03-DEC-21

ENGINEER:

Fred XIA

14-DEC-21

APPROVED:

Rick ZHANG

14-DEC-21

FIRST ANGLE PROJECTION

PROJECT: SUBMITTAL DRAWINGS SHEET 3 OF 9

MCCB ($U_i=750V$; $I_r=600A$ dc)

3 SMPS FUSES

MCCB SETTINGS:
 $I_m = 1500A$
APPLY TO ALL CONFIGURATIONS.

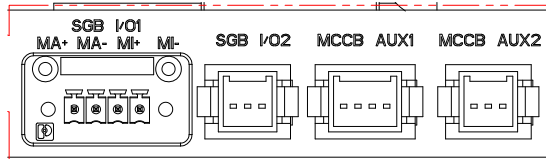

SWITCHGEAR PORTS

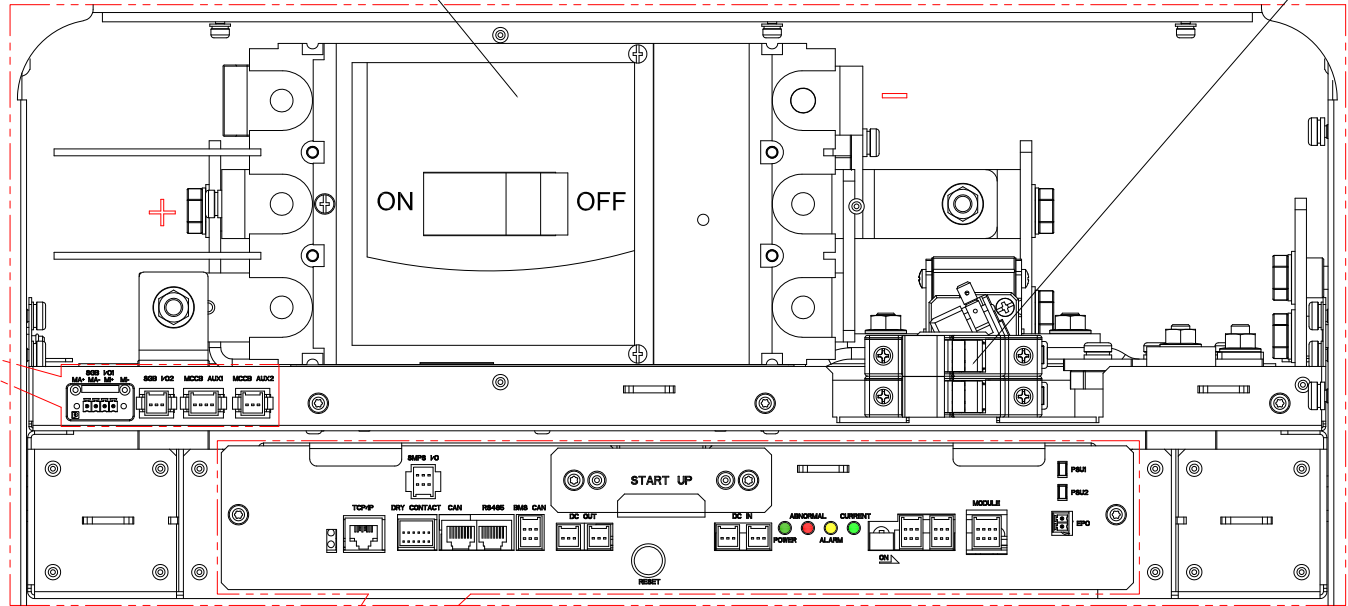

VIEW A (ENLARGED)
SWITCHGEAR SMPS AND BMS

CAN BUS LOOP TERMINATION RESISTOR SWITCH

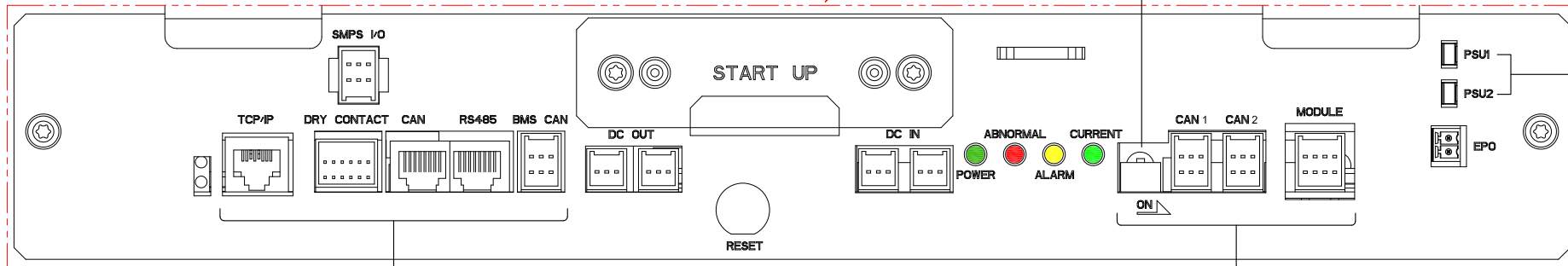

SYSTEM BMS PORTS

SMPS AND BMS

RACK BMS PORTS

CABLING NOTES:
CANBUS COMMUNICATIONS BETWEEN RACKS IS SUPPLIED AND INSTALLED BY SCHNEIDER ELECTRIC.

- NOTES:
1. INSTALLATION SHALL COMPLY WITH ALL APPLICABLE NATIONAL, STATE AND LOCAL ELECTRICAL REGULATIONS.
 2. REFER TO PRODUCT DOCUMENTATION FOR ADDITIONAL DETAILS PRIOR TO INSTALLATION AND SITE PREPARATION WORK.
 3. FUSE TYPE: LITTLEFUSE MPN OSPF003.T OR EQUIVALENT WITH 3A 1000Vdc 20KAIC.
 4. THE SYSTEM BMS IS LOCATED IN RACK 1 ONLY.

THIS DRAWING AND SPECIFICATIONS HEREIN ARE THE PROPERTY OF SCHNEIDER ELECTRIC AND SHALL NOT BE COPIED, REPRODUCED OR USED IN WHOLE OR IN PART, AS THE BASIS FOR THE MANUFACTURE OR SALE OF ITEMS WITHOUT WRITTEN PERMISSION FROM SCHNEIDER ELECTRIC. THIS DRAWING IS BASED UPON LATEST AVAILABLE INFORMATION AND IS SUBJECT TO CHANGE WITHOUT NOTICE.

Schneider Electric

TITLE:
Lithium-ion Battery cabinet
Symmetra MW, IEC
DETAIL VIEWS

PROJECT: SUBMITTAL DRAWINGS SHEET 4 OF 9

DWG NO:	LIBSESMGMWIEC	REV.	0
DRAWN:	JAYAPRAKASH	03-DEC-21	FIRST
ENGINEER:	Fred XIA	14-DEC-21	ANGLE
APPROVED:	Rick ZHANG	14-DEC-21	PROJECTION

13 MODULES/STRING

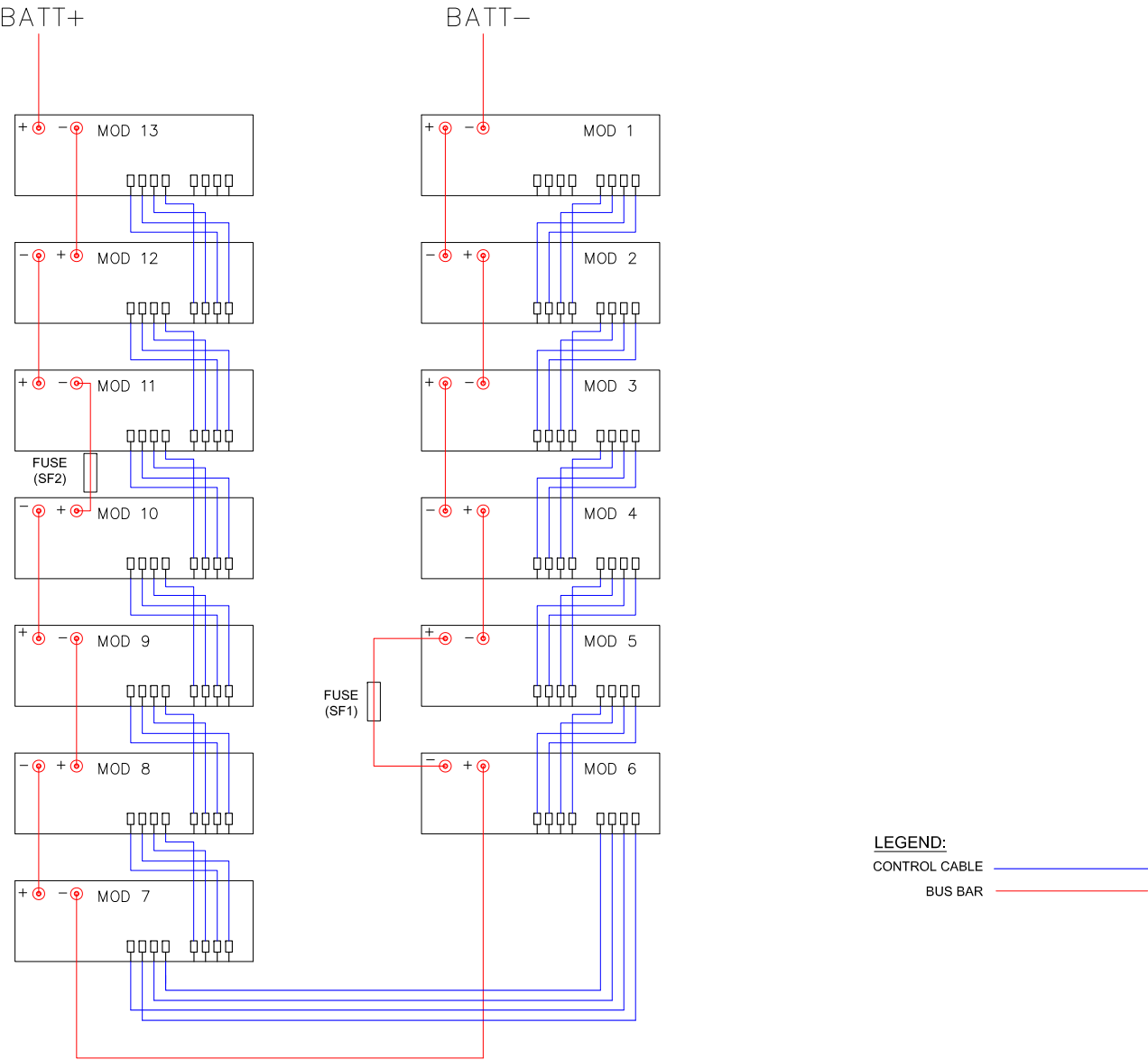

NOTES:

1. INSTALLATION SHALL COMPLY WITH ALL APPLICABLE NATIONAL, STATE AND LOCAL ELECTRICAL REGULATIONS.

2. REFER TO PRODUCT DOCUMENTATION FOR ADDITIONAL DETAILS PRIOR TO INSTALLATION AND SITE PREPARATION WORK.

THIS DRAWING AND SPECIFICATIONS HEREIN ARE THE PROPERTY OF SCHNEIDER ELECTRIC AND SHALL NOT BE COPIED, REPRODUCED OR USED IN WHOLE OR IN PART, AS THE BASIS FOR THE MANUFACTURE OR SALE OF ITEMS WITHOUT WRITTEN PERMISSION FROM SCHNEIDER ELECTRIC. THIS DRAWING IS BASED UPON LATEST AVAILABLE INFORMATION AND IS SUBJECT TO CHANGE WITHOUT NOTICE.



TITLE: Lithium-ion Battery cabinet Symmetra MW, IEC CABLING DIAGRAM	DWG NO: LIBSESMGMWIEC		REV. 0
	DRAWN: JAYAPRAKASH	03-DEC-21	ANGLE
	ENGINEER: Fred XIA	14-DEC-21	PROJECTION
PROJECT: SUBMITTAL DRAWINGS	SHEET 5 OF 9	APPROVED: Rick ZHANG	14-DEC-21

INTERFACE DETAILS WHEN BATTERY RACK ARE CONNECTED TO THE SYMW UPS

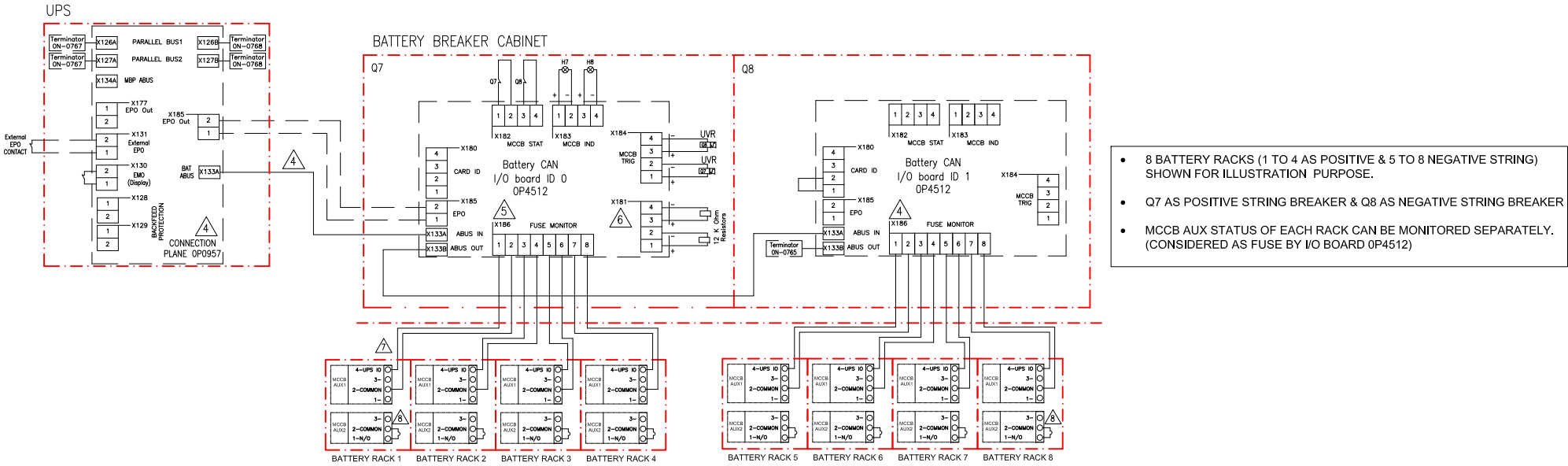

DRY CONTACT MANAGEMENT

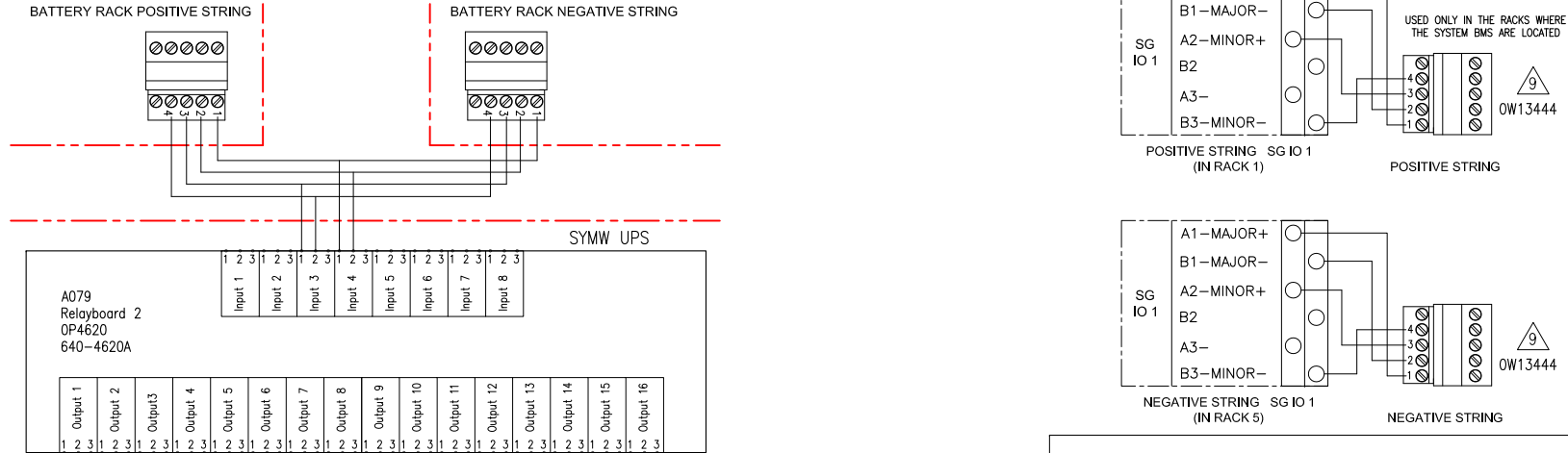

NOTES:

1. INSTALLATION SHALL COMPLY WITH ALL APPLICABLE NATIONAL, STATE AND LOCAL ELECTRICAL REGULATIONS.

2. REFER TO PRODUCT DOCUMENTATION FOR ADDITIONAL DETAILS PRIOR TO INSTALLATION AND SITE PREPARATION WORK.

3. ALL DIMENSIONS ARE IN MILLIMETERS [INCHES].

4. 15 CONDUCTOR IS SHIELDED TWISTED PAIR PROVIDED BY Schneider Electric.

5. UNUSED FUSE TERMINALS SHOULD BE FITTED WITH JUMPERS.

6. X181 CONNECTION IS APPLICABLE FOR FIRMWARE VERSION 24.87 ONLY. FOR LATER VERSION OF FIRMWARE, THESE TERMINAL CAN BE USED FOR TEMPERATURE SENSOR.

7. USE THE PROVIDED OW76929 TO CONNECT MCCB AUX 1 TO I/O BOARD OP4512.

8. USE THE PROVIDED OW76930 TO CONNECT MCCB AUX 2 TO CONTACT.

9. USE THE PROVIDED OW13444 TO CONNECT MAJOR & MINOR FAULT CONTACTS. THE ORIGINAL LENGTH OF OW13444 IS 5000mm. PLEASE CONTACT Schneider Electric IF CUSTOMER WANTS TO HAVE A SHORTER LENGTH OTHER THAN 5000mm INSIDE THE RACKS.

THIS DRAWING AND SPECIFICATIONS HEREIN ARE THE PROPERTY OF SCHNEIDER ELECTRIC AND SHALL NOT BE COPIED, REPRODUCED OR USED IN WHOLE OR IN PART, AS THE BASIS FOR THE MANUFACTURE OR SALE OF ITEMS WITHOUT WRITTEN PERMISSION FROM SCHNEIDER ELECTRIC. THIS DRAWING IS BASED UPON LATEST AVAILABLE INFORMATION AND IS SUBJECT TO CHANGE WITHOUT NOTICE.

Schneider Electric

TITLE: Lithium-ion Battery cabinet Symmetra MW, IEC INTERFACE DETAILS

PROJECT: SUBMITTAL DRAWINGS SHEET 6 OF 9

DWG NO: LIBSESMGMWIEC

DRAWN: JAYAPRAKASH 03-DEC-21

ENGINEER: Fred XIA 14-DEC-21

APPROVED: Rick ZHANG 14-DEC-21

REV. 0

ANGLE

PROJECTION

N.A

INTERFACE DETAILS WHEN TWO STRINGS CONNECTED TO UPS

POSITIVE STRING

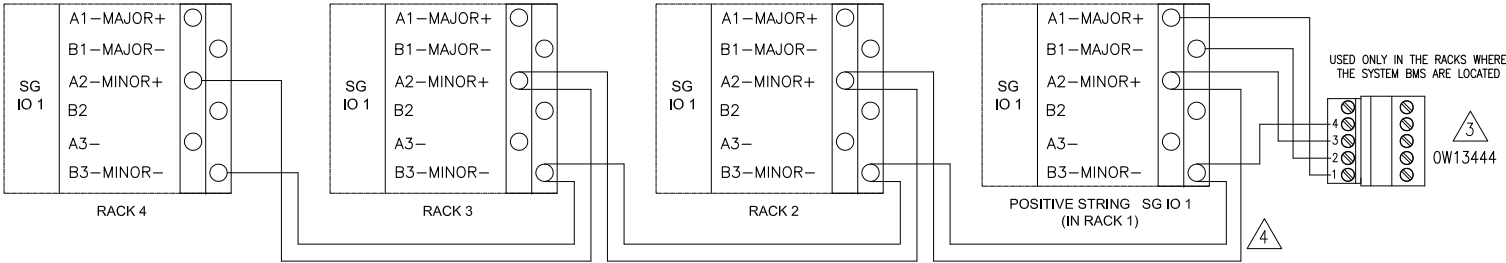

NEGATIVE STRING

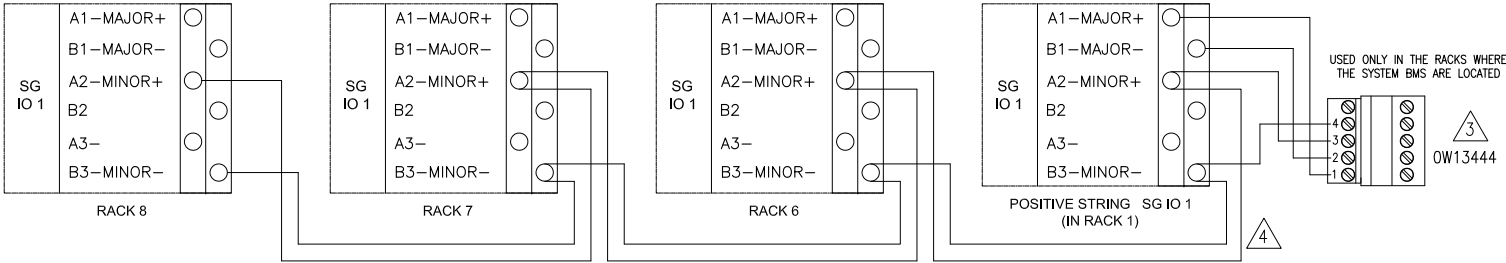

- NOTES:
- 1. INSTALLATION SHALL COMPLY WITH ALL APPLICABLE NATIONAL, STATE AND LOCAL ELECTRICAL REGULATIONS.
 - 2. REFER TO PRODUCT DOCUMENTATION FOR ADDITIONAL DETAILS PRIOR TO INSTALLATION AND SITE PREPARATION WORK.
 - △3. USE THE PROVIDED OW13444 TO CONNECT MAJOR & MINOR FAULT CONTACTS.
 - △4. USE THE PROVIDED OW76972 TO CONNECT MINOR FAULT ALARM CONTACTS.

THIS DRAWING AND SPECIFICATIONS HEREIN ARE THE PROPERTY OF SCHNEIDER ELECTRIC AND SHALL NOT BE COPIED, REPRODUCED OR USED IN WHOLE OR IN PART, AS THE BASIS FOR THE MANUFACTURE OR SALE OF ITEMS WITHOUT WRITTEN PERMISSION FROM SCHNEIDER ELECTRIC. THIS DRAWING IS BASED UPON LATEST AVAILABLE INFORMATION AND IS SUBJECT TO CHANGE WITHOUT NOTICE.



TITLE:
Lithium-ion Battery cabinet
Symmetra MW, IEC
INTERFACE DETAILS 1

PROJECT: SUBMITTAL DRAWINGS SHEET 7 OF 9

DWG NO: LIBSESMGMWIEC

DRAWN: JAYAPRAKASH 03-DEC-21

ENGINEER: Fred XIA 14-DEC-21

APPROVED: Rick ZHANG 14-DEC-21

REV. 0

ANGLE

PROJECTION

N.A

BMS WIRING DETAILS UP TO EIGHT BATTERY RACKS (FOUR RACKS PER STRING)

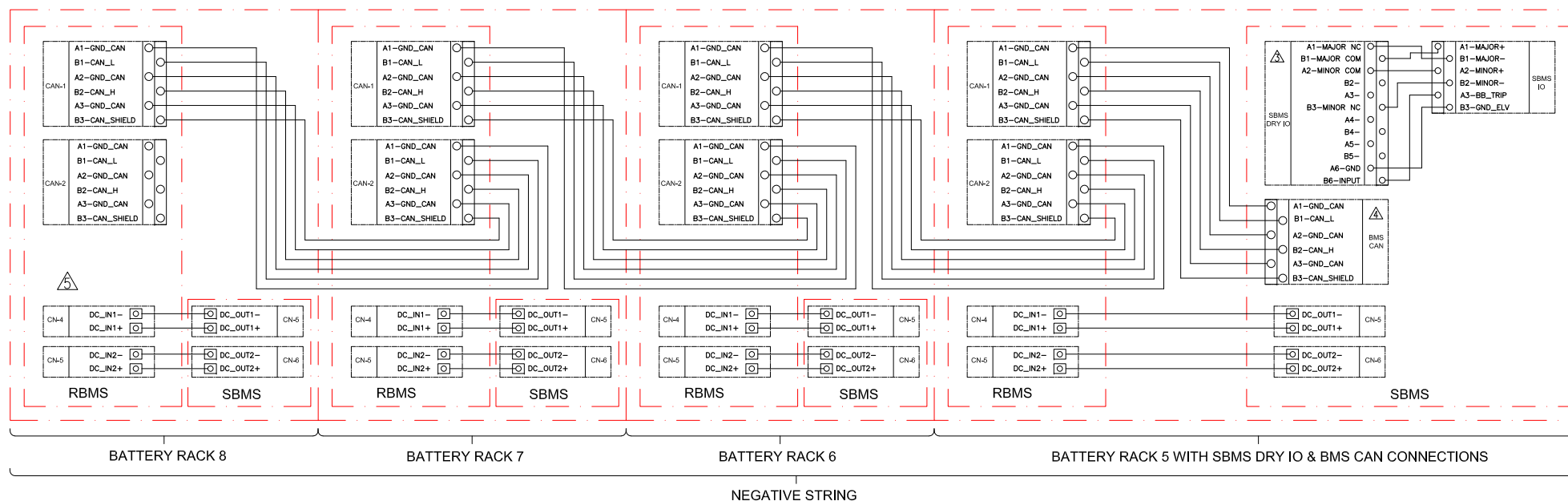
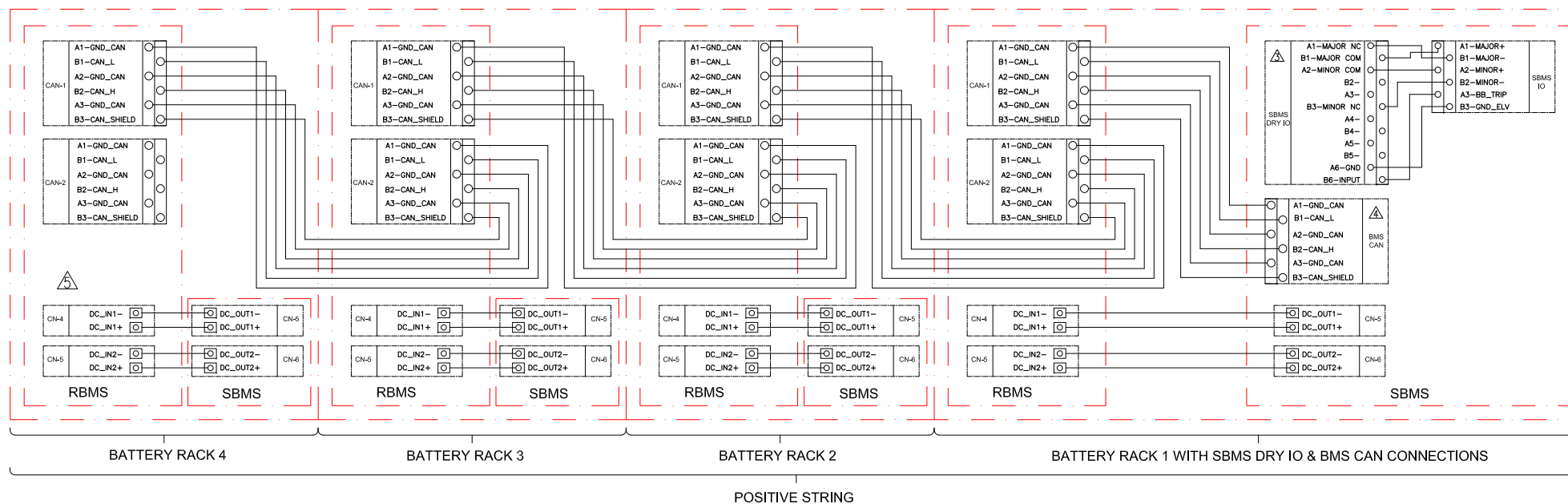

NOTES:

1. INSTALLATION SHALL COMPLY WITH ALL APPLICABLE NATIONAL, STATE AND LOCAL ELECTRICAL REGULATIONS.
2. REFER TO PRODUCT DOCUMENTATION FOR ADDITIONAL DETAILS PRIOR TO INSTALLATION AND SITE PREPARATION WORK.
3. **SBMS DRY 10** IS CONNECTED IN BATTERY RACK 1 OF POSITIVE STRING AND BATTERY RACK 5 OF NEGATIVE STRING ONLY.
4. **BMS CAN** IS CONNECTED IN BATTERY RACK 1 OF POSITIVE STRING AND BATTERY RACK 5 OF NEGATIVE STRING ONLY.
5. SLIDE THE **CAN** BUS LOOP TERMINATION RESISTOR SWITCH TO **ON** POSITION IN THE LAST ONE BATTERY RACK.

THIS DRAWING AND SPECIFICATIONS HEREIN ARE THE PROPERTY OF SCHNEIDER ELECTRIC AND SHALL NOT BE COPIED, REPRODUCED OR USED IN WHOLE OR IN PART, AS THE BASIS FOR THE MANUFACTURE OR SALE OF ITEMS WITHOUT WRITTEN PERMISSION FROM SCHNEIDER ELECTRIC. THIS DRAWING IS BASED UPON LATEST AVAILABLE INFORMATION AND IS SUBJECT TO CHANGE WITHOUT NOTICE.

Schneider
Electric

TITLE: Lithium-ion Battery cabinet
Symmetra MW, IEC
INTERFACE DETAILS-SBMS TO RBMS

PROJECT: SUBMITTAL DRAWINGS	SHEET 8 OF 9
-----------------------------	--------------

DWG NO: L1R55MCMW15C

DRAWN:	JAYAPRAKASH	03-DEC-21
--------	-------------	-----------

ENGINEER:	Fred XIA	14-DEC-21
-----------	----------	-----------

REV.	0
ANGL	
PROJECT	
N.	

