

LC1E120...N-LC1E630...N

Contacteur

接触器

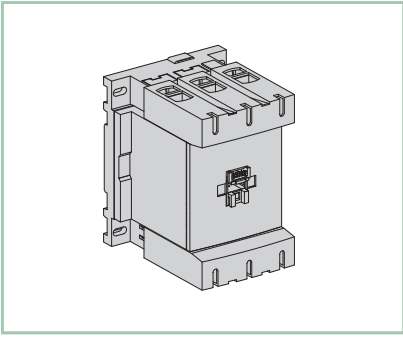

Schneider Electric Industries SAS  
35 rue Joseph Monier  
92500 Rueil-Malmaison, France

www.se.com

HRB44996-07-D01

© 2025 Schneider Electric.  
All rights reserved.

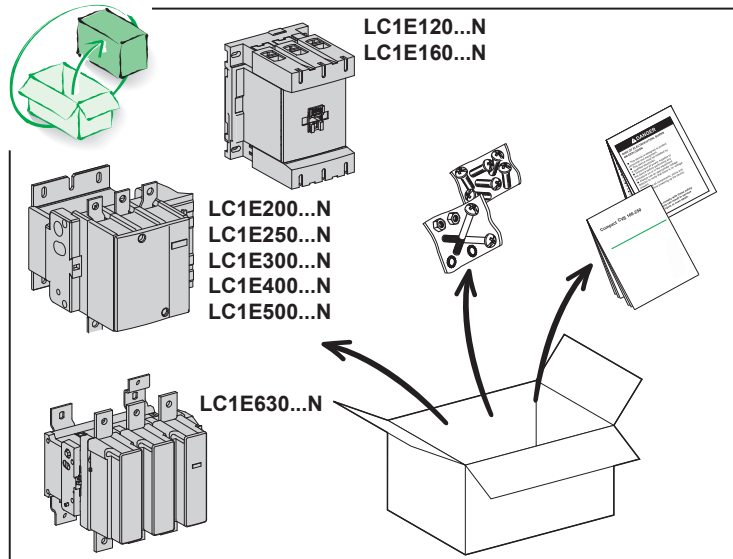

LC1E120...N  
LC1E160...N

LC1E200...N  
LC1E250...N  
LC1E300...N  
LC1E400...N  
LC1E500...N

LC1E630...N

**⚠️ DANGER / 危险**  
**HAZARD OF ELECTRIC SHOCK, EXPLOSION, OR ARC FLASH.**  
Disconnect all power before servicing equipment.  
**Failure to follow these instructions will result in death or serious injury.**

**电击、爆炸或电弧闪光的危险。**  
在此电力设备上工作时,请先切断所有电源。  
**不遵循上述说明将导致人员伤亡。**

**⚠️ WARNING / 警告**  
**HAZARD OF FIRE OR ELECTRIC SHOCK( FOR CONTACTOR WITH HI-FAULT SHORT CIRCUIT CURRENT RATINGS ONLY)**  
●The opening of the branch-circuit protective device may be an indication that a fault current has been interrupted.  
●To reduce the hazard of fire or electric shock, current-carrying parts and the other components of the controller should be examined and replaced if damaged.  
**Failure to follow these instructions can result in death, serious injury, or equipment damage.**

**可能有火灾或者触电的危险(仅限于高故障短路电流额定值的接触器)**  
●支路保护设备断开,表明故障电流已被中断。  
●为降低火灾或触电风险,应检查带电部件和其他控制元件,如有损坏,需及时更换。  
**不遵循上述说明可能导致人员伤亡或设备损坏。**

**PLEASE NOTE**  
● Electrical equipment should be installed, operated, serviced, and maintained only by qualified personnel.  
● No responsibility is assumed by Schneider Electric for any consequences arising out of the use of this material.

**请注意**  
● 电气设备的安装、操作、维修和维护工作仅限于合格人员执行。  
● Schneider Electric不承担由于使用本资料所引起的任何后果。

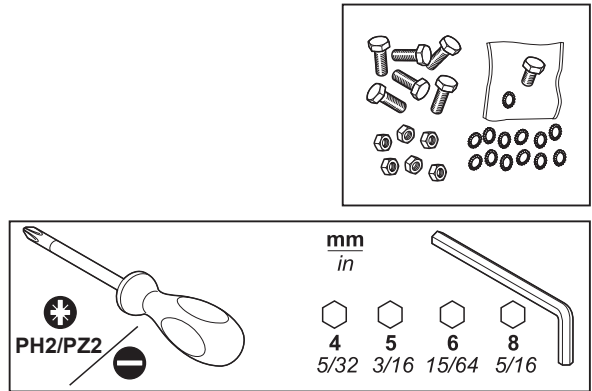

\* For Motor Starting Use Schneider Electric Overload Relay Series LR E.  
马达起动机请配合施耐德电气的LRE系列热继电器

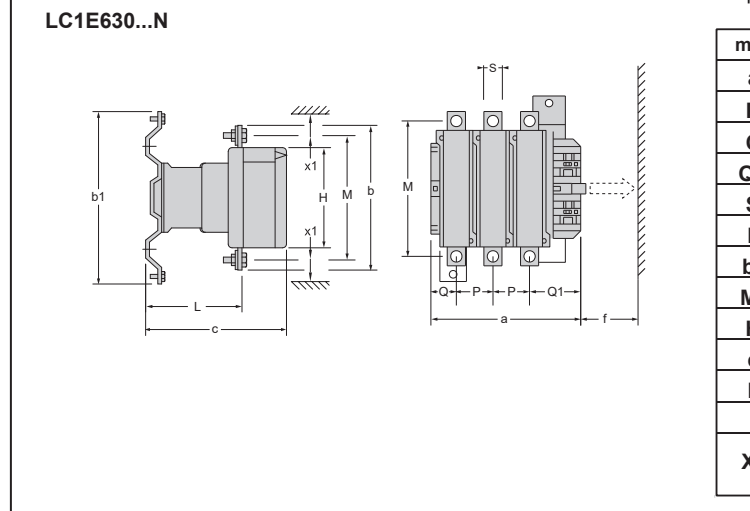
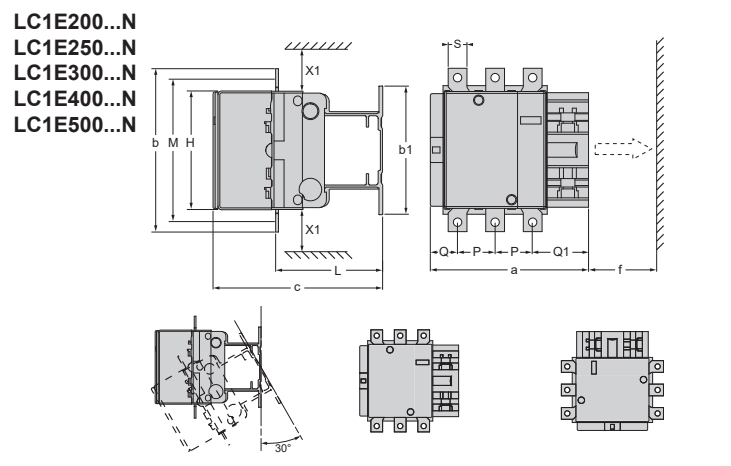
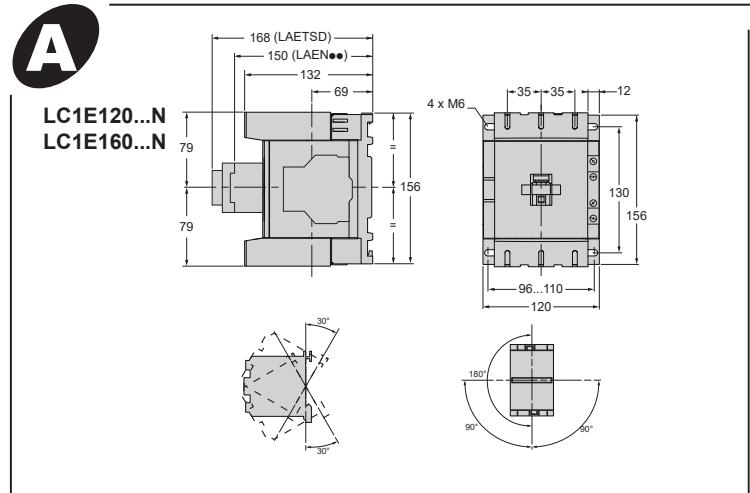

mm	LC1E200...N	LC1E250...N	LC1E300...N	LC1E400...N	LC1E500...N	LC1E630...N
a	168.5	168.5	213	213	233	309
P	40	48	48	48	55	80
Q	29	21	43	43	46	60
Q1	59.5	51.5	74	74	77	89
S	20	25	25	25	30	40
b	174	197	206	206	238	304
b1	137	137	145	209	209	280
M	154	172	181	181	208	264
H	127	127	147	158	172	202
c	181	181	219	219	232	255
L	113.5	113.5	145	145	146	155
f	u130	u130	u147	u146	u150	u181
X1	u 10 (220...500V)			u 15		u20
	u 15 (500...690V)			u 20		u30

**B**

LC1E120...N  
LC1E160...N

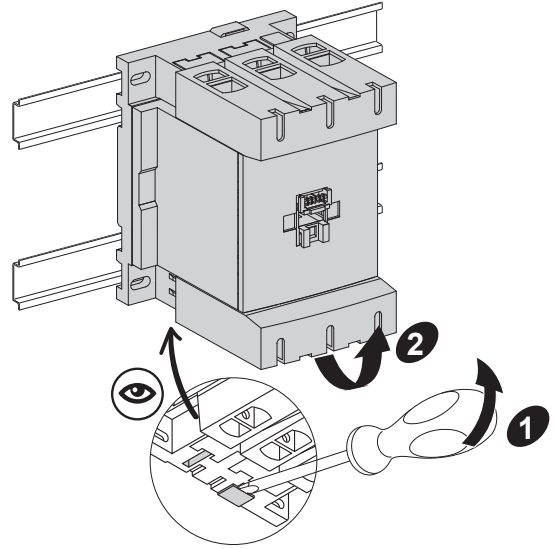
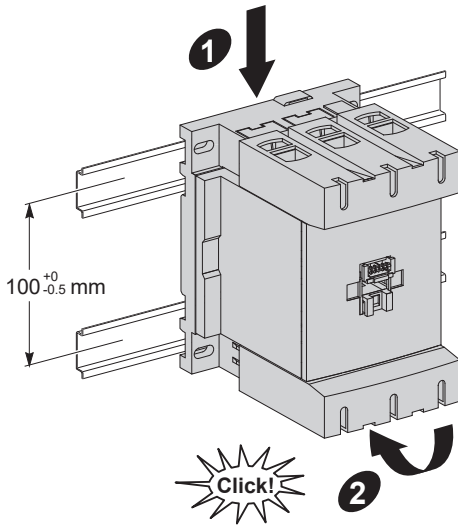

LC1E200...N LC1E400...N LC1E630...N  
LC1E250...N LC1E500...N  
LC1E300...N

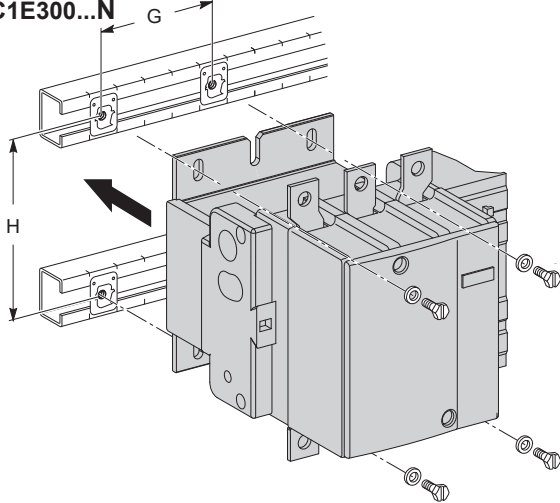

	LC1E200...N LC1E250...N	LC1E300...N	LC1E400...N	LC1E500...N	LC1E630...N
G	80 mm	96 mm	80 mm	140 mm	180 mm
H	110...120 mm		170...180 mm		180...190 mm

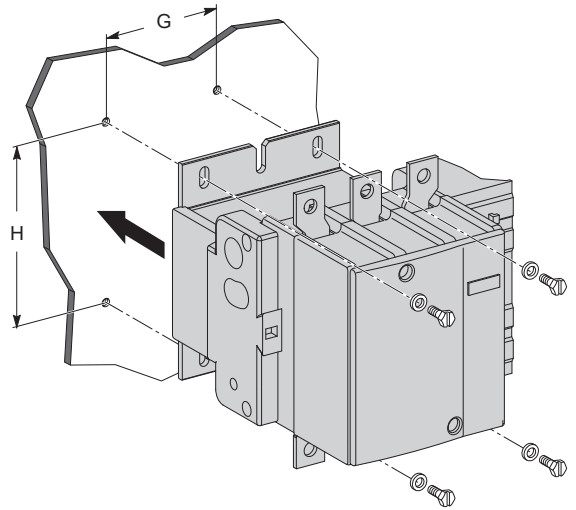

**C**

LC1E120...N  
LC1E160...N

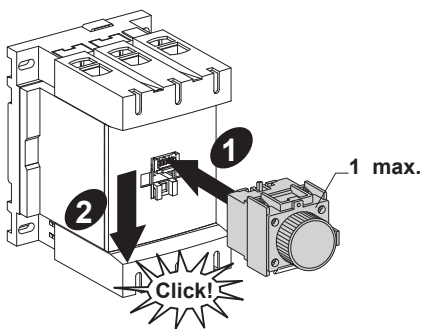

LC1E200...N  
LC1E250...N  
LC1E300...N  
LC1E400...N  
LC1E500...N  
LC1E630...N

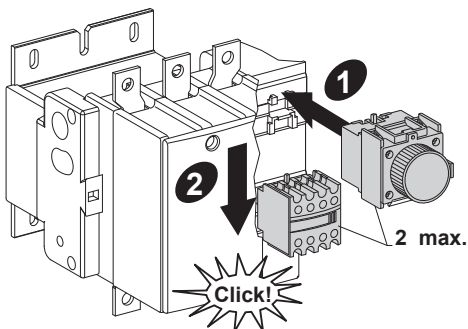

	<b>LANN11N</b>	$\begin{array}{c} 53/NO \\ 54 \\ 61/NC \\ 62 \end{array}$	1 NO + 1 NC
	<b>LANN20N</b>	$\begin{array}{c} 53/NO \\ 54 \\ 63/NO \\ 64 \end{array}$	2 NO
	<b>LANN02N</b>	$\begin{array}{c} 51/NC \\ 52 \\ 61/NC \\ 62 \end{array}$	2 NC
	<b>LANN22N</b>	$\begin{array}{c} 53/NO \\ 54 \\ 61/NC \\ 62 \\ 71/NC \\ 72 \\ 83/NO \\ 84 \end{array}$	2 NO + 2 NC
	<b>LAETSD</b>	$\begin{array}{c} 55/NC \\ 56 \\ 67/NO \\ 68 \end{array}$	On-delay 1 NO + 1 NC 1...30 s

**D**

LC1E120...N  
LC1E160...N

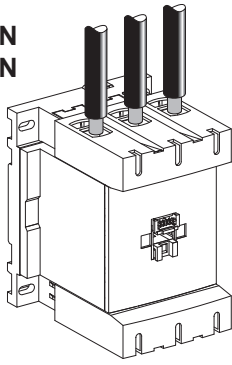

LC1E120...N LC1E160...N	20 mm	10...120 mm <sup>2</sup>	10...120 mm <sup>2</sup> + 10...50 mm <sup>2</sup>	12 N.m		4 mm
LAEX5●● LAEX51●●	10 mm	1...2.5 mm <sup>2</sup>	1...2.5 mm <sup>2</sup>	1.2 N.m	PH2/PZ2	
LAE●●						

LC1E200...N  
LC1E250...N  
LC1E300...N  
LC1E400...N  
LC1E500...N  
LC1E630...N

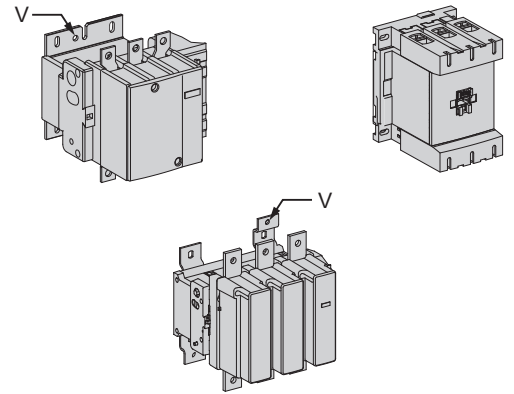
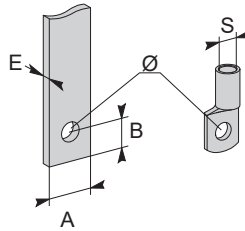
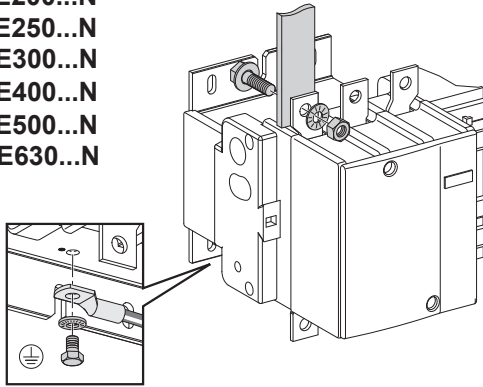

	LC1E200...N	LC1E250...N	LC1E300...N	LC1E400...N	LC1E500...N	LC1E630...N
A (mm)	25	32	30	30	40	60
B (mm)	12.5	15	15	15	20	25
E (mm)	3	4	5	8	10	10
Ø(mm)	9	11	11	11	11	13
S(mm <sup>2</sup> )	150	185	240	2X150	2X240	-
V⊥	M8	M10	M10	M10	M10	M12
C(N.m)⊥	10	10	10	35	35	58

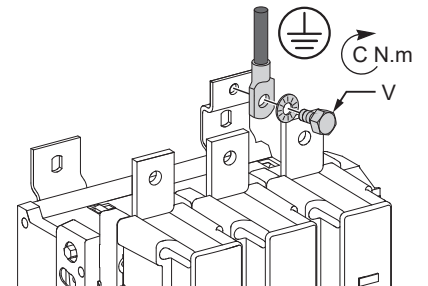

LAEX6●●  
LAEX7●●

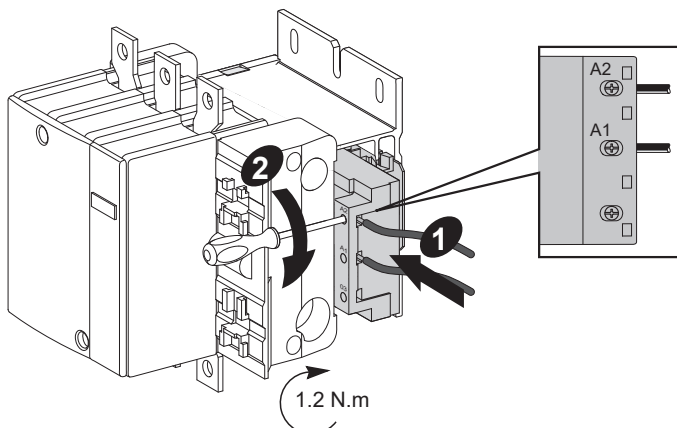
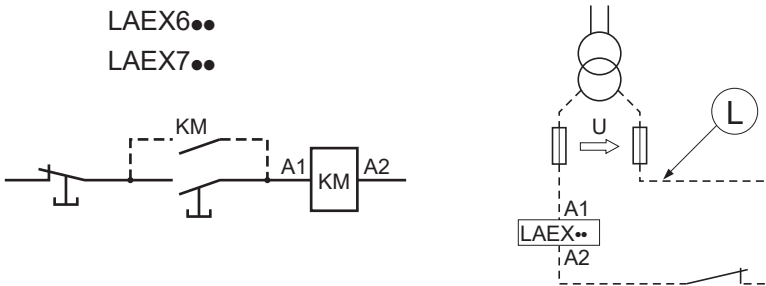

U (V ~)	L max (m)	 (mm <sup>2</sup> )
24	4	2.5
48	10	1.5
	20	2.5
110	40	1
	60	1.5
	100	2.5
220 240	150	1
	250	1.5
	400	2.5
380 415 440	500	1
	750	1.5
	1200	2.5

