

ComPacT NSX100-630
PowerPacT H-, J-, L-Frame

9-wire auxiliary connector
Prise déconnectable 9 fils
Toma desconectable para 9 hilos
9 线辅助连接器

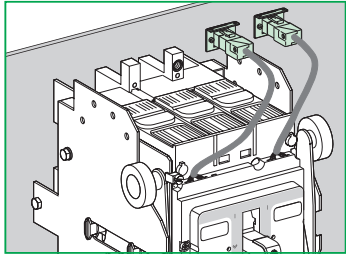

PLEASE NOTE

■ Electrical equipment should be installed, operated, serviced, and maintained only by qualified personnel.
■ No responsibility is assumed by Schneider Electric for any consequences arising out of the use of this material.

REMARQUE IMPORTANTE

■ L'installation, l'utilisation, la réparation et la maintenance des équipements électriques doivent être assurées par du personnel qualifié uniquement.
■ Schneider Electric décline toute responsabilité quant aux conséquences de l'utilisation de cet appareil.

TENGA EN CUENTA

■ La instalación, manejo, puesta en servicio y mantenimiento de equipos eléctricos deberán ser realizados sólo por personal cualificado.
■ Schneider Electric no se hace responsable de ninguna de las consecuencias del uso de este material.

请注意

■ 电气设备的安装、操作、维修和维护工作仅限于合格人员执行。
■ Schneider Electric不承担由于使用本资料所引起的任何后果。

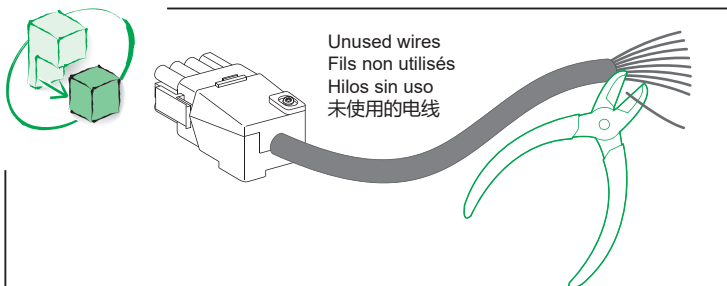
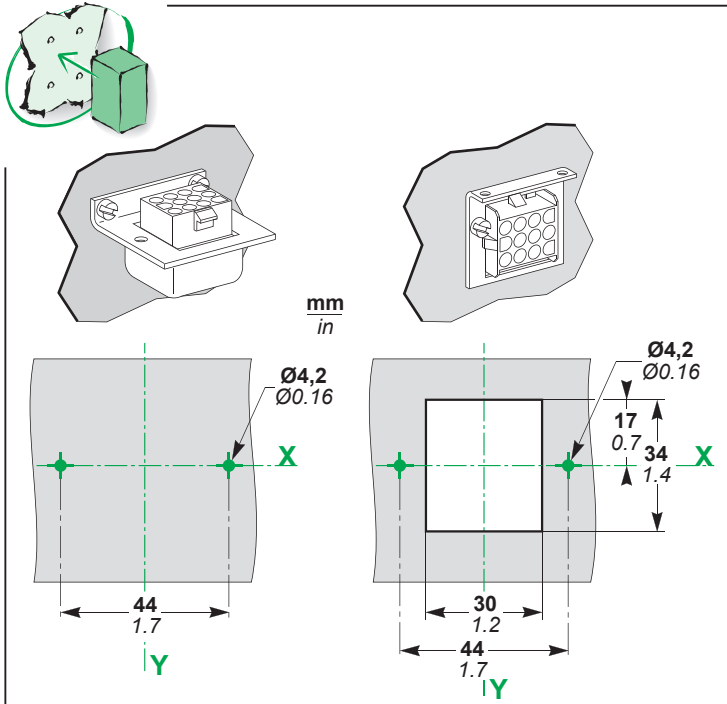
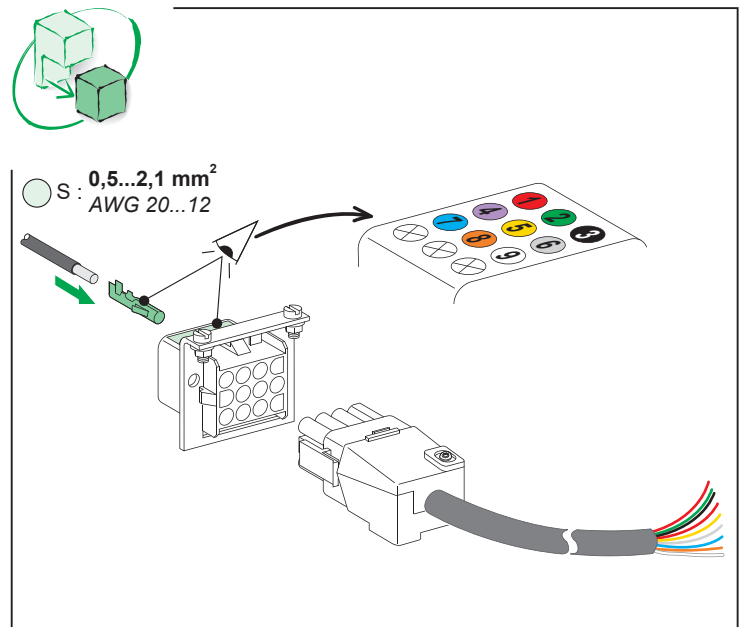
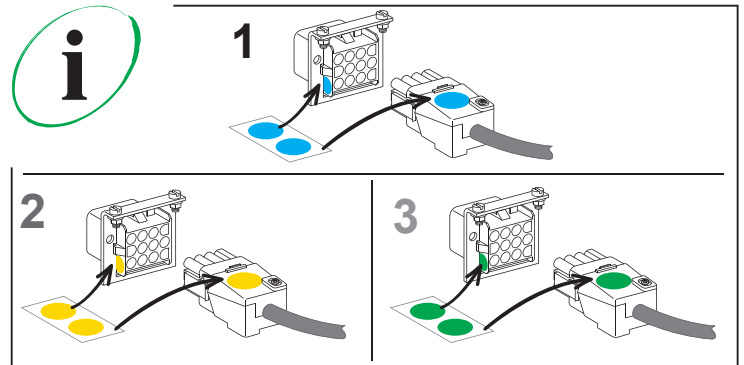
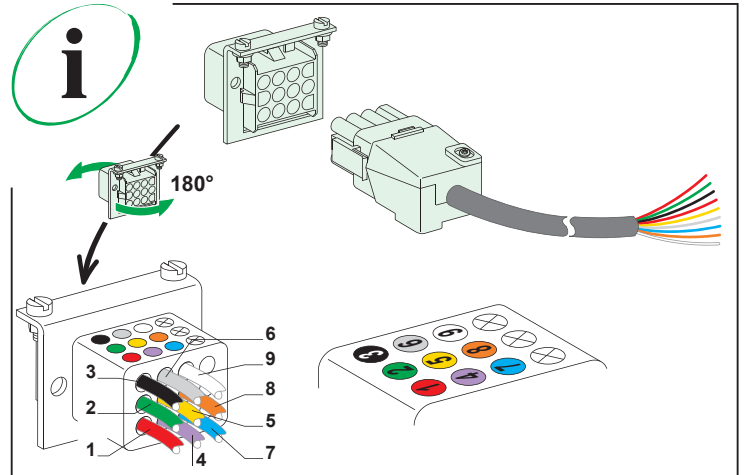
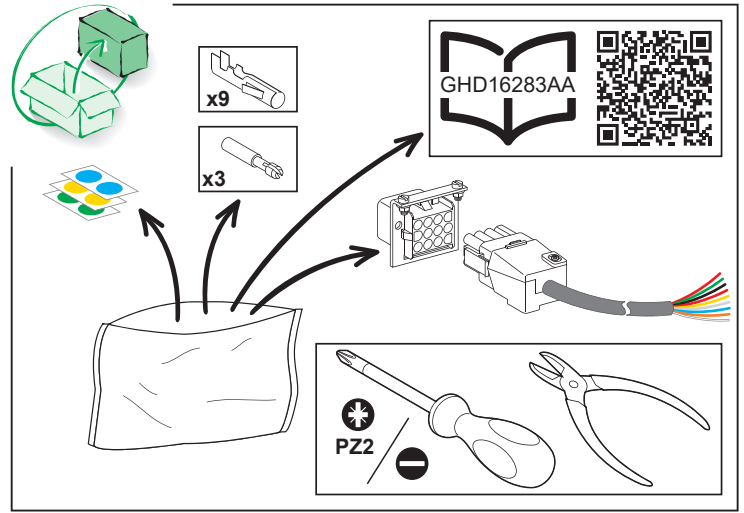



100-250 A

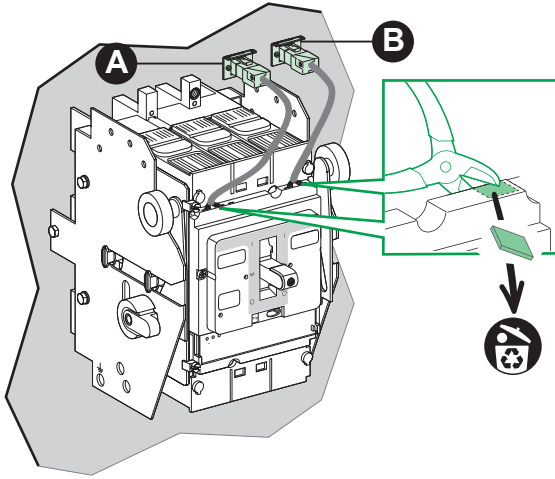

400-630 A

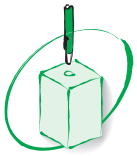
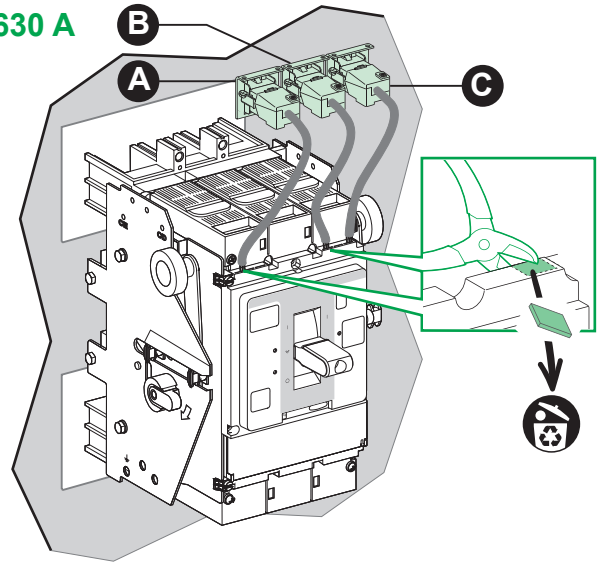

100-250 A | 400-630 A

| | 100-250 A | 400-630 A | |
|----------------------|-----------|-----------|--|
| SD AL | | | 29450 29452 |
| OF1 AX1 | | | 29450 29452 |
| MN / MX SHT / UVR | | | or / ou / o / 或 or / ou / o / 或 |
| SDx / SDTAM | | | 9 (SD3) |

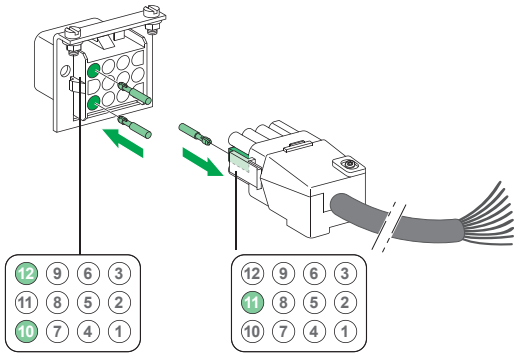

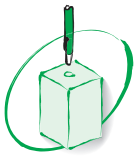

100-250 A **400-630 A**

SDE
OAL

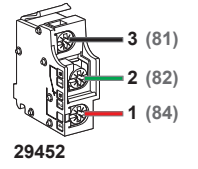
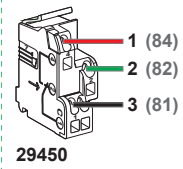

OF2
AX2
SDV

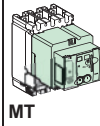
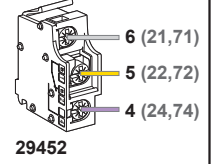
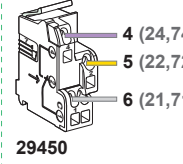

MT

SDE
OAL

SDE
OAL

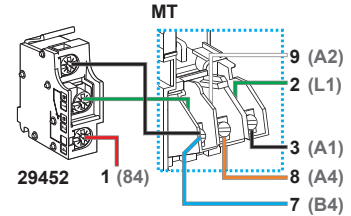
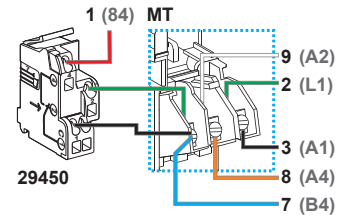
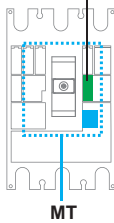

B

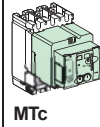
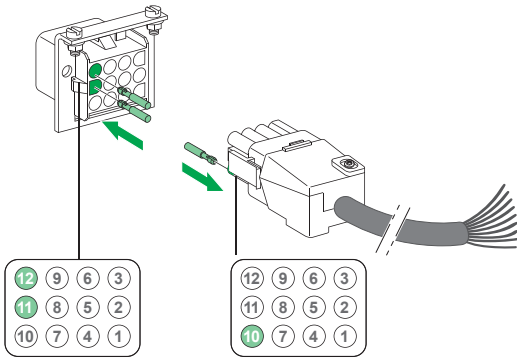

MTc

NSX cord

NSX cord

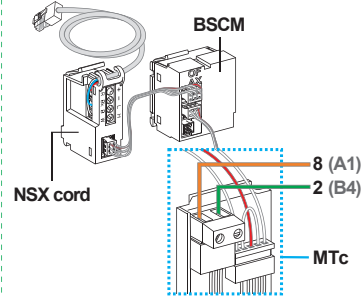
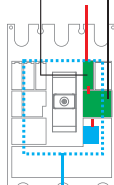
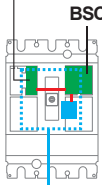

MTc
+
NSX cord
+
BSCM

24 V

24 V

24 V

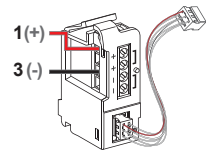
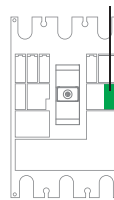
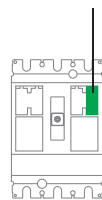

MicroLogic
5.2 / 6.2

ZSI out

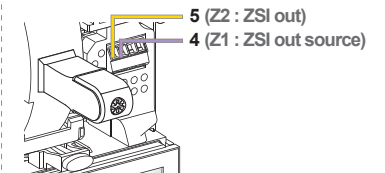
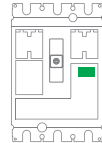

NSX cord

NSX cord

NSX cord

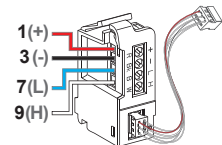
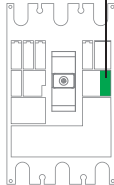
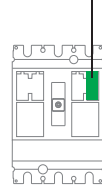

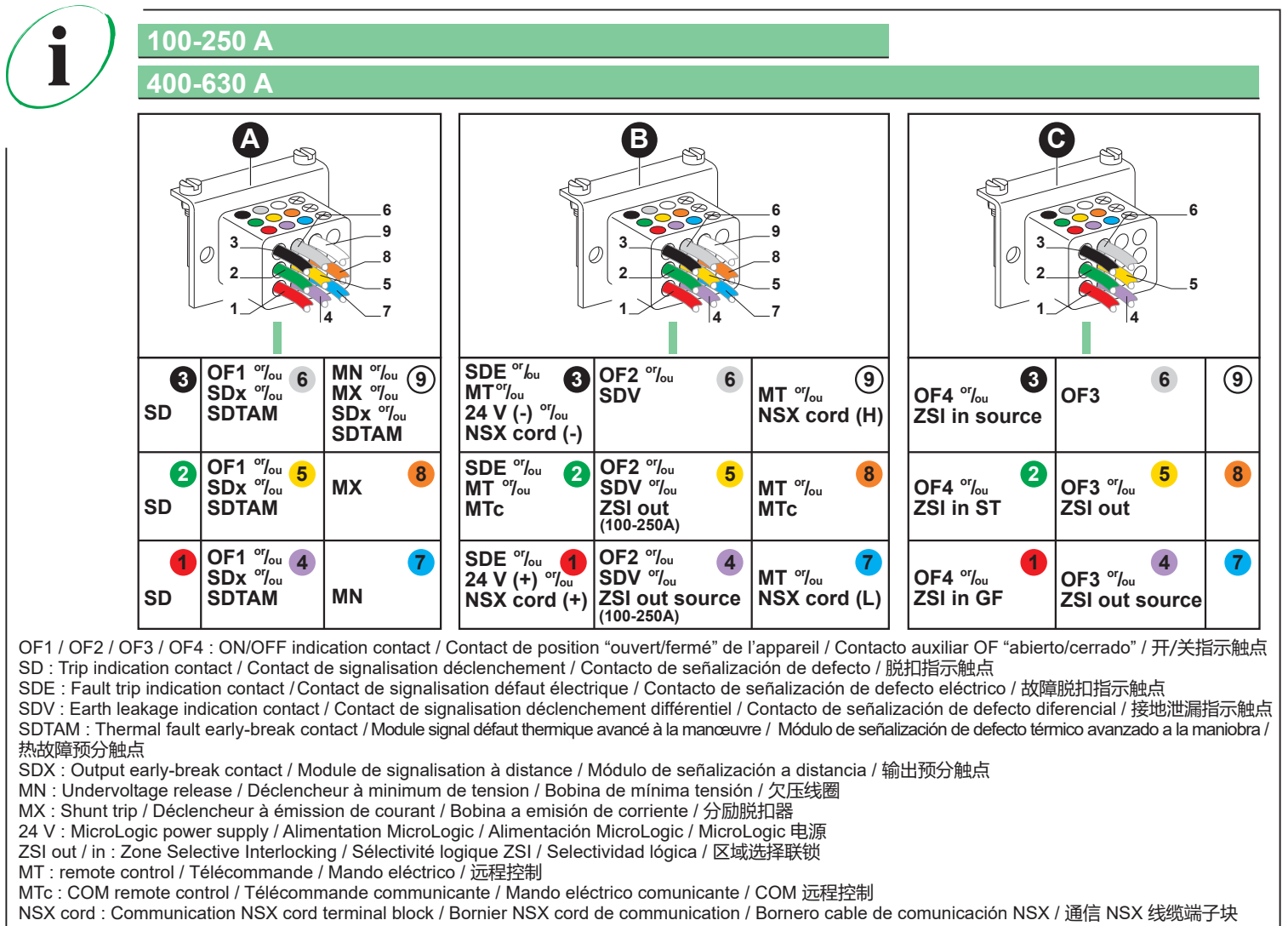
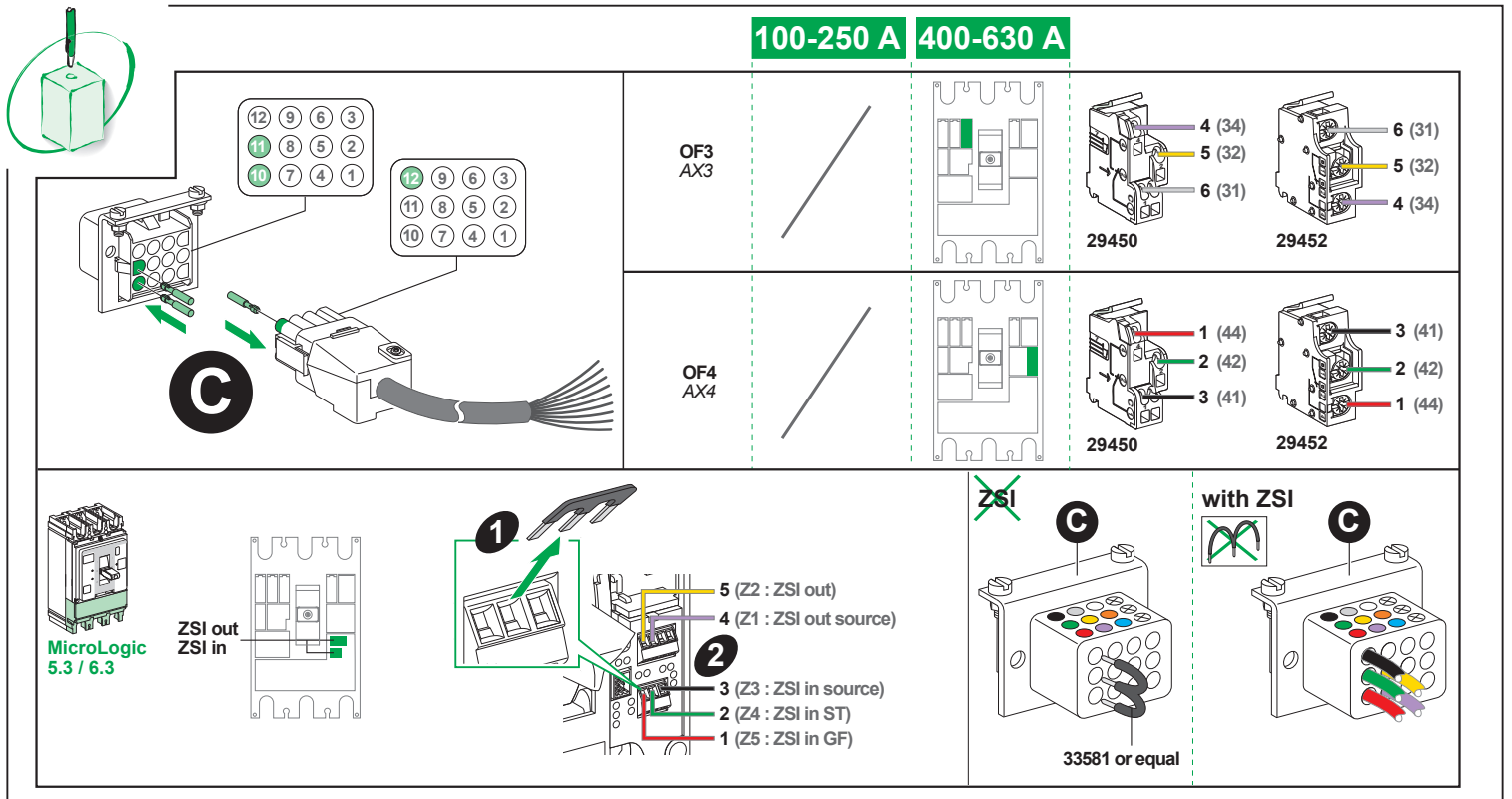

Schneider Electric Industries SAS
35 rue Joseph Monier
CS 30323
F - 92506 Rueil Malmaison Cedex
www.se.com



Schneider Electric Limited
Stafford Park 5
Telford, TF3 3BL
United Kingdom
www.se.com/uk

UK
CA