

EasyLogic™ Sensors

Differential Wet Pressure Transmitters

CP Series



Product Description

CP Series differential wet pressure transmitters are used to monitor pressure in HVAC pipe systems. The CP Series is ideal for measuring pressure across pumps, filters, heat exchangers, compressors, and other non-corrosive wet media applications.

The output signal is converted to a standard current or voltage signal compatible with most control systems.

This product features diffused-silicon sensor technology, ensuring exceptional accuracy and reliability.

The total linearity, hysteresis and repeatability are $\pm 1.0\%$ FS (typical). The device is equipped with mounting bracket, screw and a ferrule fitting connection with bite-type fittings.

Features

- Resistant to extreme temperatures
- Supports both AC and DC power supplies
- Supports both current and voltage outputs
- Ideal for liquid and neutral gas applications

Available Products

Part Number	Description	Range		Max. Pressure Tolerance at Single End	
		bar	PSI	P1 (bar)	P2 (bar)
CP-LI-DP-TR-0600	Differential Wet Pressure Transmitter	0-6	0-87	12	12
CP-LI-DP-TR-1600	Differential Wet Pressure Transmitter	0-16	0-232	32	32

Note: Select product based on maximum system pressure. For example, if maximum system pressure is 7 bar, then the 0-16 bar range product should be used.

North America (USA): +1 888 444 1311
 Europe, Middle East & Africa (Sweden): +46 10 478 2000
 Asia Pacific (Singapore): +65 6484 7877
 product.support@schneider-electric.com
 se.com

Life Is On

Schneider
Electric

Specifications

General	
Supply voltage	24VAC±10%/12-30VDC
Current consumption	Typical 15mA (for voltage output, non-loaded)
Output	DC power supply: 0-10V/4-20mA output AC power supply: 0-10V output
Output load	≥10k ohms for 0-10V output; ≤140 ohms for 4-20mA output and power supply 12VDC; ≤500 ohms for 4-20mA output and power supply ≥19VDC
Standard connection	2m cable
Pressure port	Ø8mm pipe connection
Medium compatibility	Water, neutral gas
Performance at 25°C	
Accuracy	±1% FS
Tolerable overload on one side: P1/P2	2x FS
Environmental	
Long term stability	±0.5 FS/year (typical)
TC zero point	<±0.04% FS/°C (-10-70°C)
TC sensitivity	<±0.04% FS/°C (-10-70°C)
Medium temperature	-40 to 105 °C
Operating temperature	-20 to 85 °C
Operating humidity	0 to 95 % RH (non-condensing)
Storage temperature	-40 to 105 °C
Storage humidity	0 to 95% RH (non-condensing)
Protection class	IP65, indoor use
Materials	
Connector	PA + 30% glass fiber
Diaphragm	Grade 316 stainless steel
Shell	Grade 304 stainless steel
Weight	
Weight	~ 1110g
Regulatory Information	
Agency approvals	European conformance (CE) EN 61326-1 according to 2014/30/EU directive, UKCA (UK), Green Premium: China RoHS 2.0, European RoHS, REACH

Dimensions (mm)

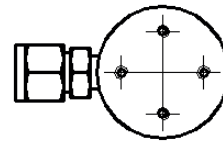
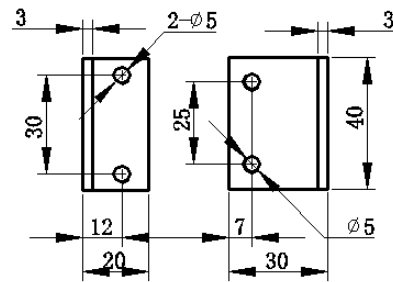
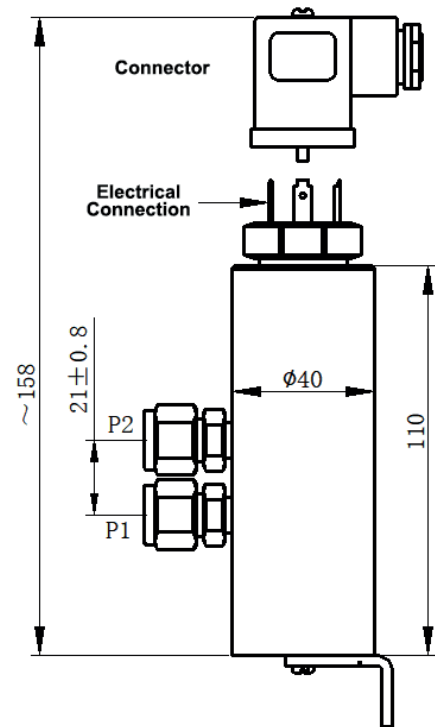

Wiring

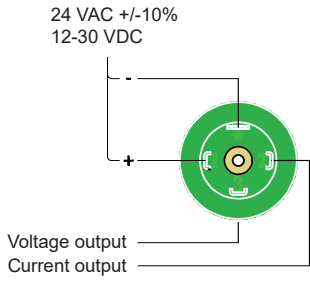
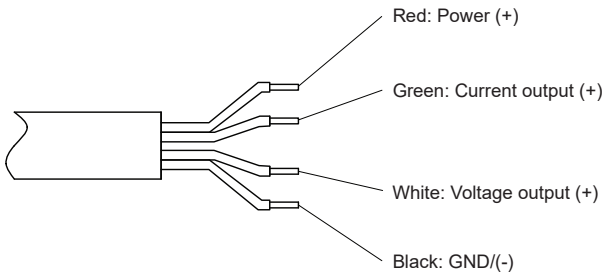

Notes:
 Choose either voltage output or current output. The unused wire must be well protected (i.e. wrapped with electrical tape) for safety.