

SpaceLogic Sensors

Duct Temperature Sensors

STD500 Series



Product Description

The STD500 temperature sensor is intended for air duct mounting. The sensor element is an NTC 10 k Ω for Continuum products. The STD500 housing is equipped with an M16x1.5 cable fitting and an M16/M20 adapter for conduit.

Accuracy

At Temperature	Accuracy
-25 °C (-13 °F)	± 0.5 °C (± 0.9 °F)
0 °C (32 °F)	± 0.2 °C (± 0.4 °F)
25 °C (77 °F)	± 0.2 °C (± 0.4 °F)
50 °C (122 °F)	± 0.2 °C (± 0.4 °F)
70 °C (158 °F)	± 0.2 °C (± 0.4 °F)
100 °C (212 °F)	± 0.5 °C (± 0.9 °F)

Specifications

Sensor element	NTC 10 k Ω at +25 °C (77 °F)
Systems	SpaceLogic, Andover Continuum
Time Constants	
Air velocity 1.5 m/s	72 sec. (approx.)
Air velocity 3.0 m/s	52 sec. (approx.)
Material	
Immersion tube	Stainless steel
Connection box	Polyamid plastic
Mounting flange	Black plastic
Enclosure rating	IP 65
Measurement current	<2 mW
Temperatures	
Ambient	-40 °C (-40 °F) min. 130 °C (266 °F) max.
Operating	-40 °C (-40 °F) min. 150 °C (302 °F) max.
Operating humidity range	0 to 95% (non-condensing)
Standards	
EMC	EN 61326-1, EN 61326-2-3

Available Products

Part Number	Model Number	Probe		NL		Weight (Item)		Weight (PG)		Weight (Flange)	
		mm	in.	mm	in.	g	lb.	g	lb.	g	lb.
5123076010	STD500-200	200	7.87	213	8.39	122.74	0.27	11.70	0.03	17.42	0.04
5123078010	STD500-250	250	9.84	263	10.35	126.16	0.28	11.70	0.03	17.42	0.04
5123080010	STD500-300	300	11.81	313	12.32	128.92	0.28	11.70	0.03	17.42	0.04
5123082010	STD500-400	400	15.75	413	16.26	134.64	0.30	11.70	0.03	17.42	0.04

North America (USA): +1 888 444 1311
 Europe, Middle East & Africa (Sweden): +46 10 478 2000
 Asia Pacific (Singapore): +65 6484 7877
 product.support@schneider-electric.com
 www.schneider-electric.com

Schneider
Electric

Dimensions mm (in.)

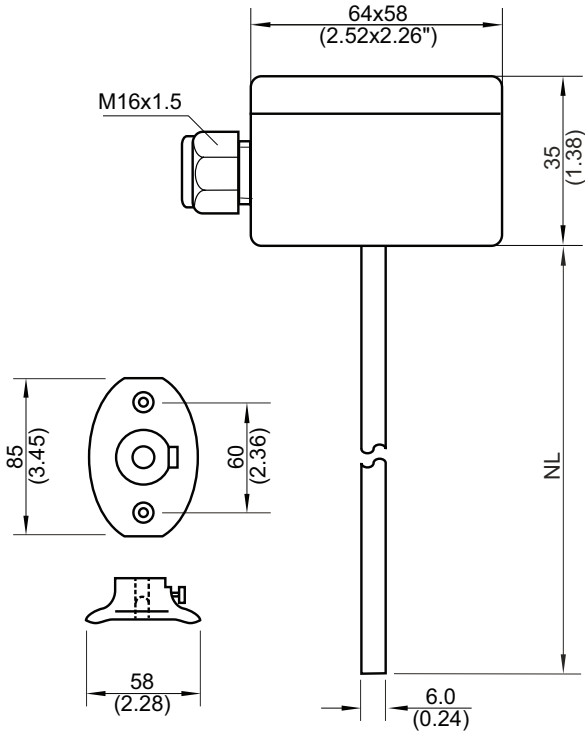

Wiring

