

# Product End of Life Instructions

**Variable speed drive, Altivar HVAC ATH600, ATH630, 45kW, 60hp, 380 to 480V, 3 phase, IP21, UL type 1**

## Altivar HVAC ATH600





## Potential disassembly risks

The information provided in this document assumes that the product is completely de-energized and uninstalled (refer to the instructions provided in the appropriate product manuals).

Dismantling/disassembling the product may entail hazards caused by, for example, sharp edges, chemical aggression or ejected parts.

### **⚠ WARNING**

#### **HAZARD DUE TO INSUFFICIENT PROTECTION**

- Implement all safety measures required by the applicable regulations and by the processes used to dismantle/disassemble and dispose of the product.
- Use all necessary personal protective equipment such as gloves and goggles.

**Failure to follow these instructions can result in death or serious injury.**

# End of Life Instructions

## Part A :

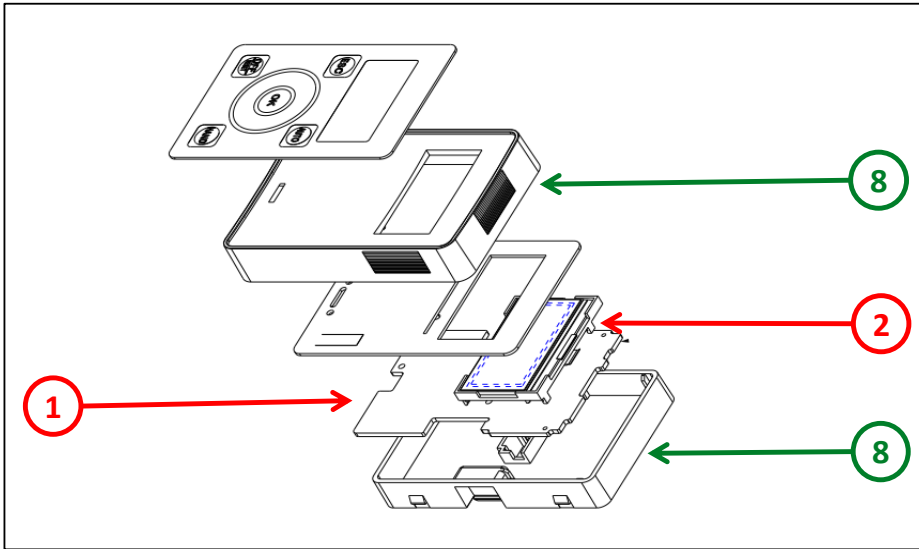

## Part B :

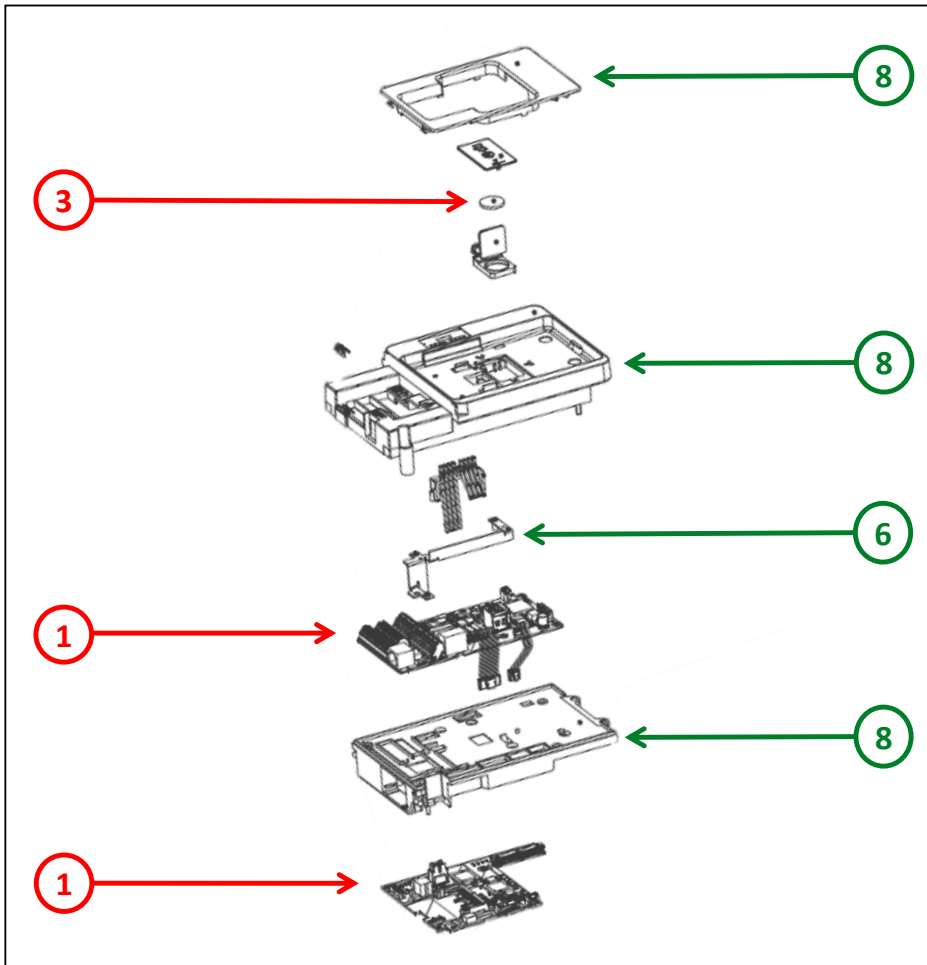

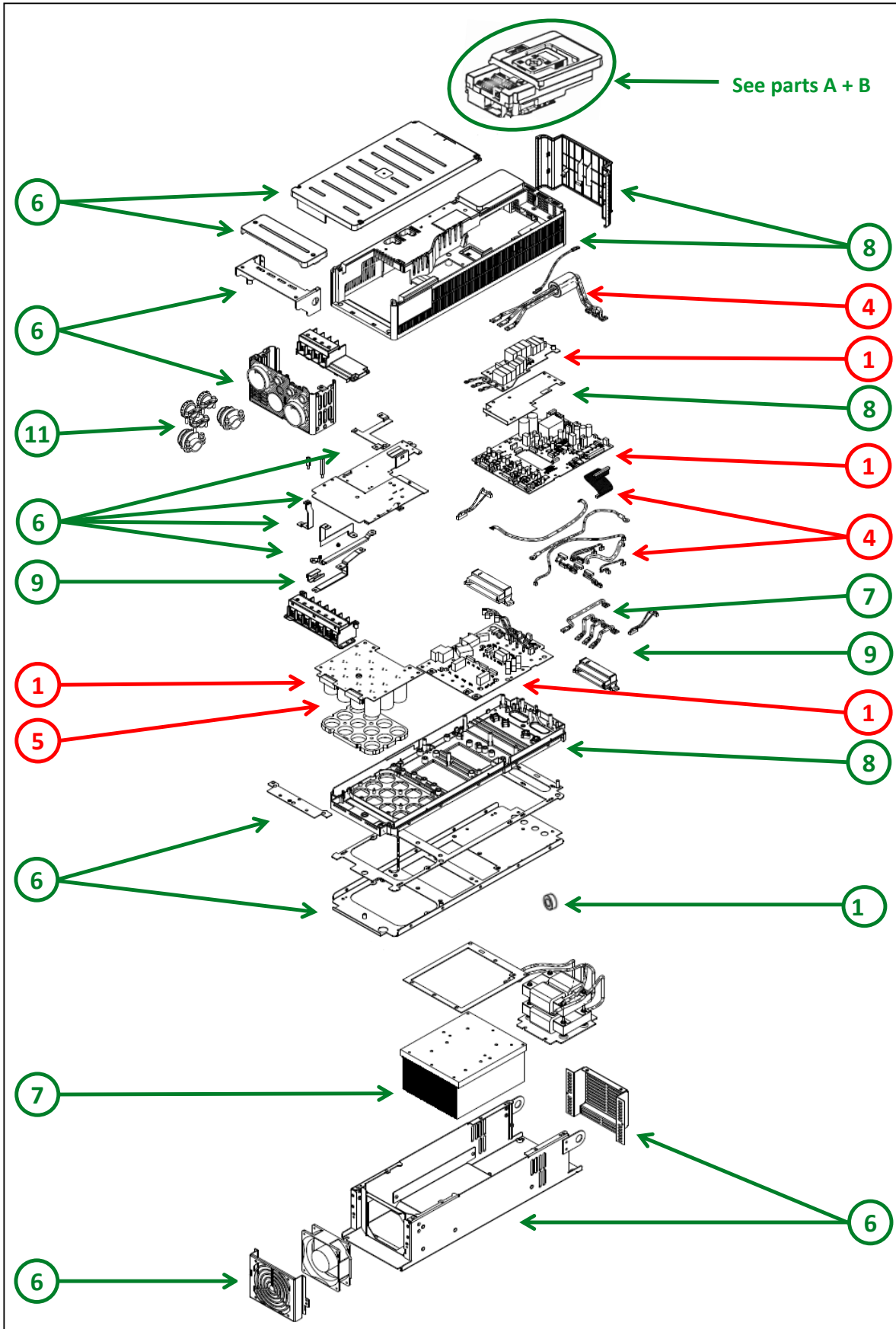

Recommendation	Number on drawing	Component / Material	Weight (in g)	Comment
To be depolluted	1	Electronic Board (Power and Communication) > 10cm <sup>2</sup>	2305	
To be depolluted	2	LCD (surface > 100cm <sup>2</sup> ) and all those back-lighted with gas discharge lamps	7	
To be depolluted	3	Battery	2,9	Lithium content: 0,07 g
To be depolluted	4	Cable (high current)	483	
To be depolluted	5	Electrolyte capacitors which size: height > 25 mm, diameter > 25 mm or proportionately similar volume	1050	
To be dismantled	6	Steel	8630	Supports - Groundings- Top Grid - Lowre Housing - Plates - Lifting Hole - Bars - Bottom Box
To be dismantled	7	Aluminium	5420	Heatsink - Links
To be dismantled	8	PC, ABS-PC, PA, PA6, HDPE, SAN with or without additive, PP+EPDM and PP	2456	Insulation Sheet - Covers - Housing - Chassis
To be dismantled	9	Copper	219	Links
To be dismantled	10	Zinc	471	Cable Gland
To be dismantled	11	Ferrite	260	Fer Toroid
Other			7396,1	

## Product description

<b>Manufacturer identification</b>	Schneider Electric Industries SAS
<b>Brand name</b>	Schneider Electric
<b>Product function</b>	The main function of the Altivar HVAC ATH600 product range is the speed control including speed variation for synchronous and asynchronous motors to provide energy efficiency, durability, safety and cybersecurity for HVAC equipments. The products is available in different variants to be mounted in a control panel, on the machines or on the wall inside a building.
<b>Product reference</b>	ATH630D45N4
<b>Description of the range</b>	This range, Altivar HVAC ATH600, consists of variable speed drive products designed for Original Equipment Manufacturers (OEMs), system integrators and contractors that meet pump, fan and compressor application requirements in HVAC equipments for 3 Phase synchronous and asynchronous motors from 15 to 45 kW (20 to 60 HP)
<b>Total representative product mass</b>	28700 g
<b>Representative product dimensions</b>	226mm x 691mm x 270,9mm
<b>Accessories</b>	No accessories needed.
<b>Date of information release</b>	02-2026



## Additional information

<b>Legal information</b>	This product family is in the scope of European Union directive 2012/19/EU on Waste Electrical and Electronic Equipment (WEEE). The product family must be disposed according to the legislation of the country. This document is intended for use by end of life recyclers or treatment facilities. It provides the basic information to assure an appropriate end of life treatment for the components and materials of the product.
<b>In case of special transportation: transportation method</b>	No special transportation.
<b>Recyclability potential</b>	<b>85%</b> The recyclability rate was calculated from the recycling rates of each material making up the product based on REEECY'LAB tool developed by Ecosystem, for components/materials not covered by the tool, data from the EIME database and the related PSR was taken. If no data was found a conservative assumption was used (0% recyclability).

Schneider Electric Industries SAS

Country Customer Care Center  
<http://www.se.com/contact>

35, rue Joseph Monier  
CS 30323  
F- 92500 Rueil Malmaison Cedex  
RCS Nanterre 954 503 439  
Capital social 928 298 512 €

[www.se.com](http://www.se.com)

ENVEOLI2510064\_V1

Published by Schneider Electric

© 2023 - Schneider Electric – All rights reserved

02-2026