

Product End of Life Instructions

ATH230 HVAC 1.5kW/2HP 380/500V 3PH EMC IP20 Variable

Altivar HVAC ATH200





Potential disassembly risks

The information provided in this document assumes that the product is completely de-energized and uninstalled (refer to the instructions provided in the appropriate product manuals).

Dismantling/disassembling the product may entail hazards caused by, for example, sharp edges, chemical aggression or ejected parts.

⚠ WARNING

HAZARD DUE TO INSUFFICIENT PROTECTION

- Implement all safety measures required by the applicable regulations and by the processes used to dismantle/disassemble and dispose of the product.
- Use all necessary personal protective equipment such as gloves and goggles.

Failure to follow these instructions can result in death or serious injury.

End of Life Instructions

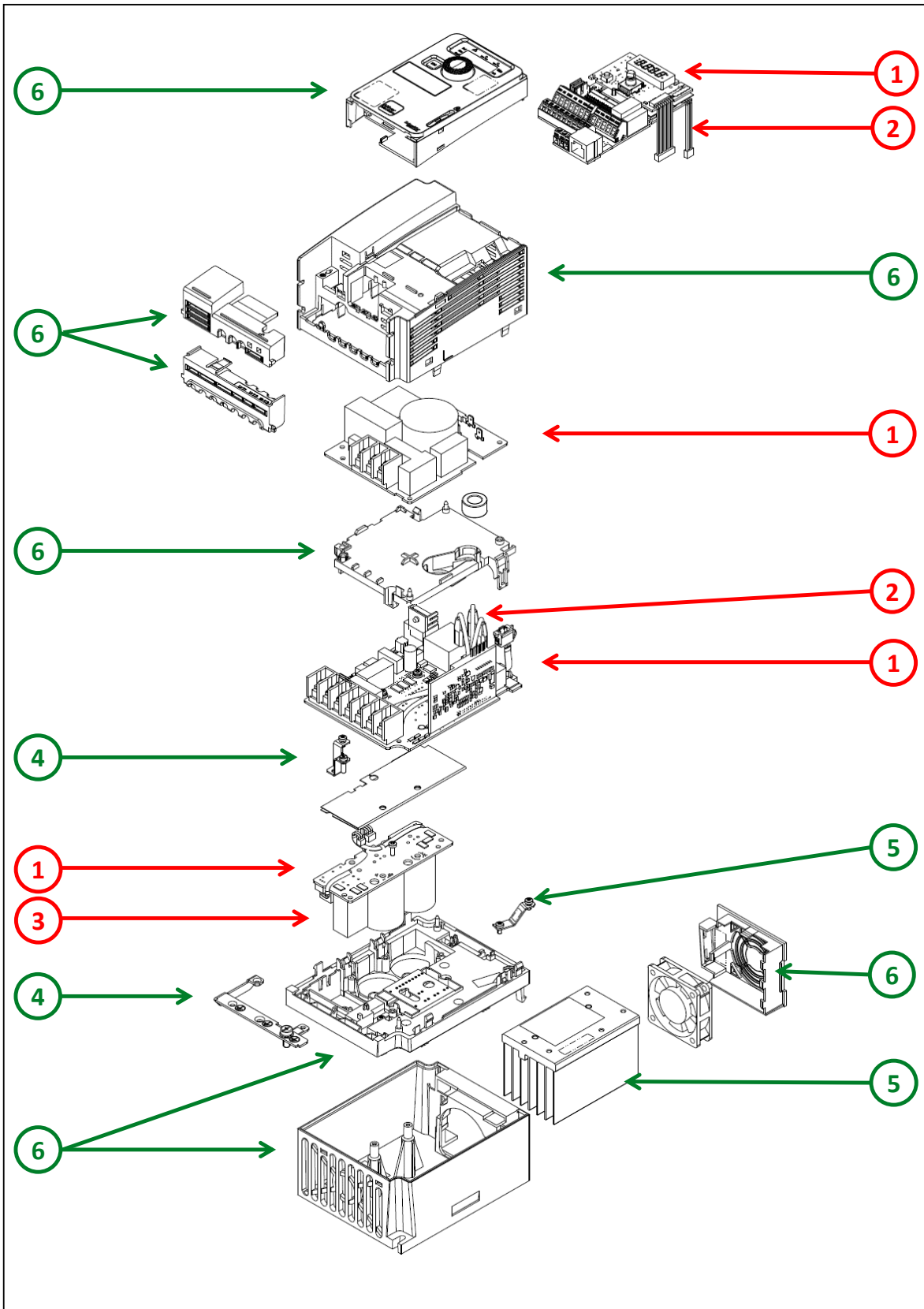

Recommendation	Number on drawing	Component / Material	Weight (in g)	Comment
To be depolluted	1	Electronic Board (Power and Communication) > 10cm ²	457,4	
To be depolluted	2	Cable (high current)	61,3	
To be depolluted	3	Electrolyte capacitors which size: height > 25 mm, diameter > 25 mm or proportionately similar volume	82,7	
To be dismantled	4	Steel	93,0	Ground Bar - Ground Plate
To be dismantled	5	Aluminium	183,4	Heatsink
To be dismantled	6	PC, ABS-PC, PA, PA6, HDPE, SAN with or without additive, PP+EPDM and PP	420,9	Housing - Support - Control Door - Wiring Trap - Wiring Cap - Chassis
Other			1,4	

Product description

Manufacturer identification	Schneider Electric Industries SAS		
Brand name	Schneider Electric		
Product function	The main function of the Altivar HVAC ATH200 product range is the speed control and variation of a synchronous and asynchronous motors in compact HVAC machines providing energy efficiency, reliability and safety in optimized control panel.		
Product reference	ATH230U15N4		
Description of the range	The environmental impacts of this reference product are representative of the impacts of the other products of the range which are developed with a similar technology. This range, Altivar HVAC ATH200, consists of a variable speed drive products designed for Original Equipment Manufacturers (OEMs) that meet pump and fan requirements in compact HVAC machines for 3 Phase synchronous and asynchronous motors from 0,55 to 1,5 kW (0,75 to 2 HP).		
Total representative product mass	1300 g		
Representative product dimensions	142mm x 105mm x 158mm		
Accessories	No accessories needed.		
Date of information release	10-2025		

Additional information

Legal information	This product family is in the scope of European Union directive 2012/19/EU on Waste Electrical and Electronic Equipment (WEEE). The product family must be disposed according to the legislation of the country. This document is intended for use by end of life recyclers or treatment facilities. It provides the basic information to assure an appropriate end of life treatment for the components and materials of the product.		
In case of special transportation: transportation method	No special transportation.		
Recyclability potential	53%	The recyclability rate was calculated from the recycling rates of each material making up the product based on REEECY'LAB tool developed by Ecosystem, for components/materials not covered by the tool, data from the EIME database and the related PSR was taken. If no data was found a conservative assumption was used (0% recyclability).	

Schneider Electric Industries SAS

*Country Customer Care Center
<http://www.se.com/contact>*

35, rue Joseph Monier

CS 30323

F- 92500 Rueil Malmaison Cedex

RCS Nanterre 954 503 439

Capital social 928 298 512 €

www.se.com

ENVEOLI2506011_V1

Published by Schneider Electric

© 2023 - Schneider Electric – All rights reserved

10-2025