

# Product End of Life Instructions

## RP Series Expansion Remote Control RP-C-RC-BLE





## End of Life Instructions

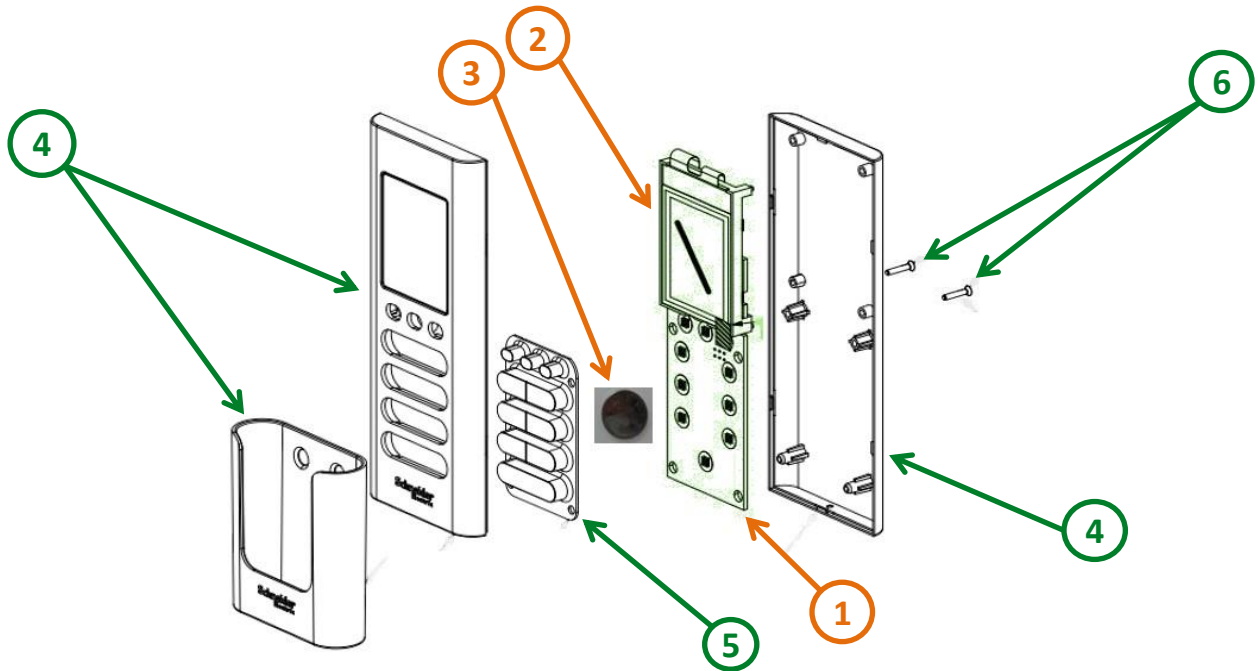

Recommendation	Number on drawing	Component / Material	Weight (in g)	Comment
To be depolluted	1	Printed Circuit Board Assy	18,27	
To be depolluted	2	LCD Module	14,23	
To be depolluted	3	Battery	5,9	Li/MNO2
To be dismantled	4	Plastic parts	51,94	PC
To be dismantled	5	Plastic parts	10,66	Silicon rubber
To be dismantled	6	Metal parts (Screws)	0,56	

## Product description

Manufacturer identification	Schneider Electric Industries SAS
Brand name	Schneider Electric
Product function	The RP-C-RC-BLE Remote Control enables occupants of modern office buildings to control the comfort level of their space. It provides immediate access to control lights, blinds, temperature setpoint, and fan speed.
Product reference	SXWRERCBLE10001
Total representative product mass	105 g
Representative product dimensions	143 mm x 57 mm x 18 mm
Date of information release	08-2025

## Additional information

<b>Legal information</b>	This product family is in the scope of European Union directive 2012/19/EU on Waste Electrical and Electronic Equipment (WEEE). The product family must be disposed according to the legislation of the country. This document is intended for use by end of life recyclers or treatment facilities. It provides the basic information to assure an appropriate end of life treatment for the components and materials of the product.
<b>In case of special transportation: transportation method</b>	No
<b>Recyclability potential</b>	<b>1%</b> The recyclability rate was calculated from the recycling rates of each material making up the product based on REEECY'LAB tool developed by Ecosystem, for components/materials not covered by the tool, data from the EIME database and the related PSR was taken. If no data was found a conservative assumption was used (0% recyclability).

Schneider Electric Industries SAS

Country Customer Care Center  
<http://www.se.com/contact>

35, rue Joseph Monier  
 CS 30323  
 F- 92500 Rueil Malmaison Cedex  
 RCS Nanterre 954 503 439  
 Capital social 928 298 512 €

[www.se.com](http://www.se.com)

ENVEOLI2505031\_V1

Published by Schneider Electric

© 2023 - Schneider Electric – All rights reserved

08-2025