

# Product End of Life Instructions

**Spacelogic MP-V, 9 points, 4 UI, 3 DO Triac, 2 AO**

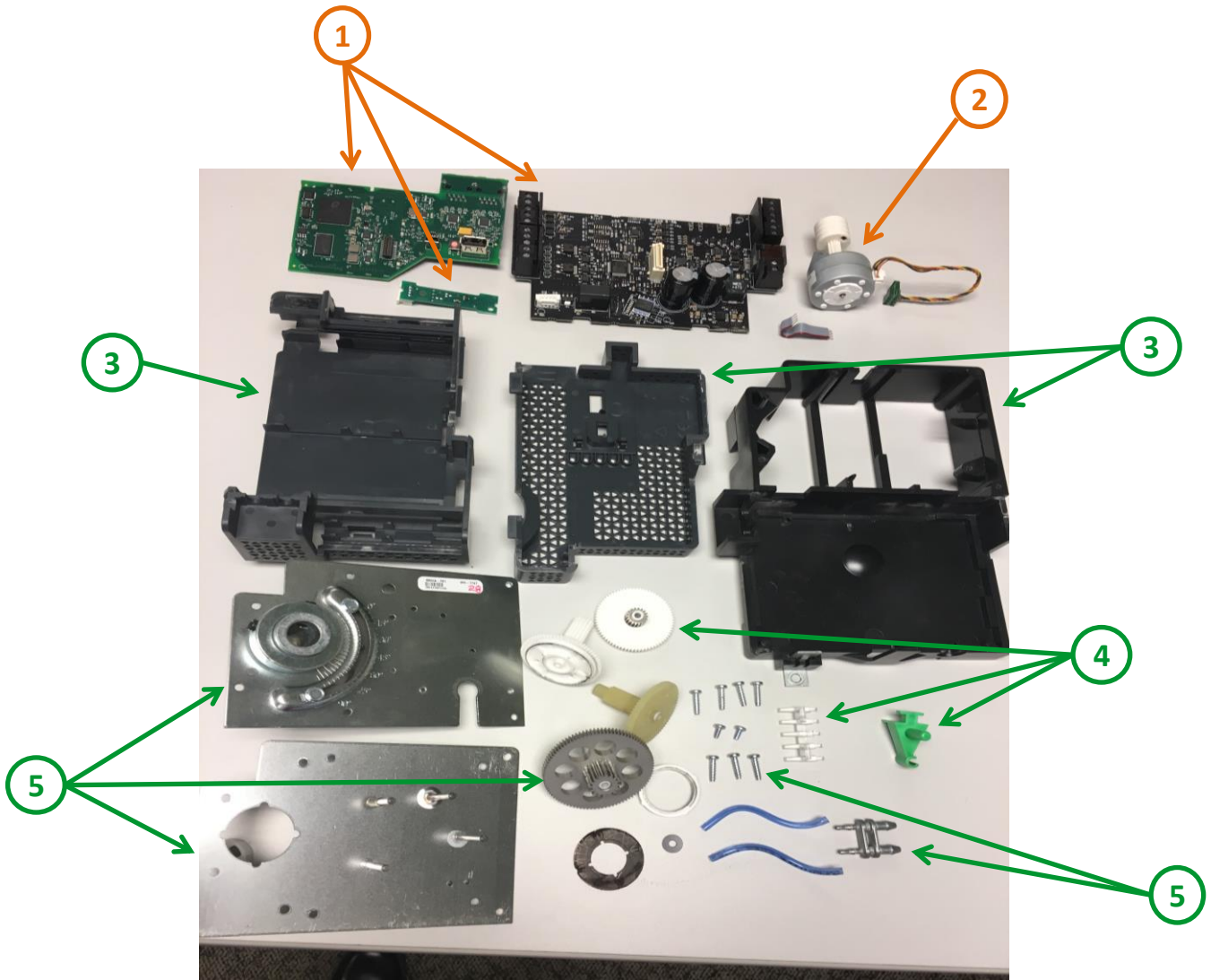

## End of Life Instructions



Recommendation	Number on drawing	Component / Material	Weight (in g)	Comment
To be depolluted	1	Printed Circuit Board Assy	169,17	Including 4 connectors
To be depolluted	2	Motor Assembly	84	
To be dismantled	3	Plastic Parts (Cover+Base+Actuator Base)	290,62	PC
To be dismantled	4	Plastic Parts	29,72	POM, PE, PVC (Including washers, gears, lightpipes, clutch button, tubes)
To be dismantled	5	Metal parts	560	Aluminium, Zamak-3



## Product description

Manufacturer identification	Schneider Electric Industries SAS
Brand name	Schneider Electric
Product function	MP-V is a multi-purpose, fully programmable, IP based field controller dedicated for VAV cooling and heating applications. MP-V integrates a controller, a damper actuator, and an air flow sensor in a single compact package for ease of installation. (This document describes the different stages of the product, from manufacturing to its end of life. For its end of life optimization, any dismantling or separation of parts required is carried out as mentioned in the EOLI document and in accordance with EU regulations, viz. WEEE)
Product reference	SXWMPV9AX10002
Additional similar product references	SXWMPV7AX10002 SXWMPV7AX10A02 SXWMPV7AX1S001 SXWMPV7AX1N001 SXWMPV9AX10A02 SXWMPV9AX1S001 SXWMPV9AX1N001
Total representative product mass	1130 g
Representative product dimensions	161 mm x 198 mm x 63 mm
Date of information release	2024-12-18



## Additional information

Legal information	This product family is in the scope of European Union directive 2012/19/EU on Waste Electrical and Electronic Equipment (WEEE). The product family must be disposed according to the legislation of the country. This document is intended for use by end of life recyclers or treatment facilities. It provides the basic information to assure an appropriate end of life treatment for the components and materials of the product.
Recyclability potential	<b>56%</b> The recyclability rate was calculated from the recycling rates of each material making up the product based on REEECYLAB tool developed by Ecosystem, for components/materials not covered by the tool, data from the EIME database and the related PSR was taken. If no data was found a conservative assumption was used (0% recyclability).

Schneider Electric Industries SAS

Country Customer Care Center  
<http://www.se.com/contact>

35, rue Joseph Monier

CS 30323

F- 92500 Rueil Malmaison Cedex

RCS Nanterre 954 503 439  
Capital social 928 298 512 €

[www.se.com](http://www.se.com)

ENVEOLI2412025\_V1

Published by Schneider Electric

© 2023 - Schneider Electric – All rights reserved

2024-12-18