

# Product End of Life Instructions

## SpaceLogic RP-C-EXT-MS-BLE Multi-Sensor Expansion Module

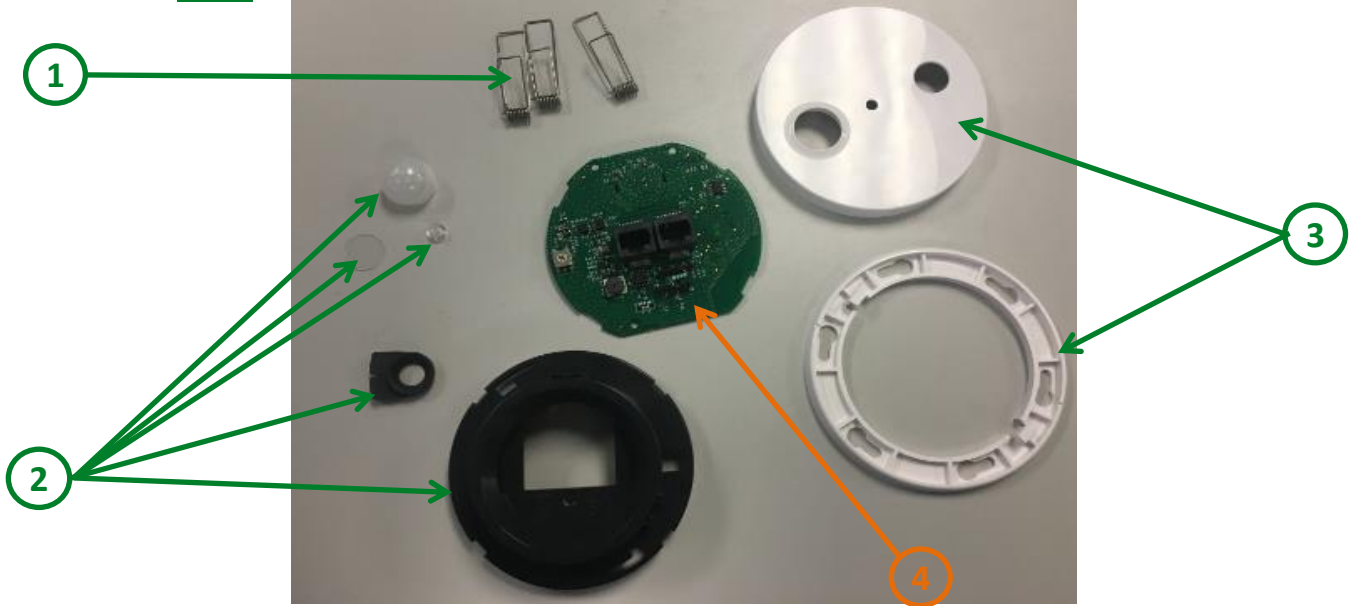

## ⚠ End of Life Instructions



Recommendation	Number on drawing	Component / Material	Weight (in g)	Comment
To be dismantled	1	Metal	3,21	Steel
To be dismantled	2	Plastic	32,5	PC, PE, PPE
To be dismantled	3	Plastic	28	ABS
To be depolluted	4	Electronic Board (Communication) > 10cm <sup>2</sup>	34	

## 📄 Product description

Manufacturer identification	Schneider Electric Industries SAS
Brand name	Schneider Electric
Product function	<p>The SpaceLogic Room Controller Multi-Sensor Expansion Module, RP-C-EXT-MS-BLE, connects to the RP controller and provides infrared motion detection and luminosity measurements at two levels in two independent zones. It supports Bluetooth Low Energy (BLE) based applications such as beaconing and remote control communication. This module is part of the RP Series expansion modules for connected room solution and can be combined with the other modules in the RP series.</p> <p>(This document describes the different stages of the product, from manufacturing to its end of life, for example the manufacturing stage includes the production and transportation of the product and its packaging through the entire process and to the last logistics platform. This product is assembled in Timisoara, Romania and distributed globally. For its end of life optimization, any dismantling or separation of parts required is carried out as mentioned in the document and in accordance with EU regulations, viz. WEEE.)</p>
Product reference	SXWREMSBLE10001
Additional similar product references	SXWREMSBLE10001 SXWREISBLE10001
Total representative product mass	97 g
Representative product dimensions	D97,5mm x 47mm
Accessories	No
Date of information release	12-2024

 **Additional information**

<b>Legal information</b>	This product family is in the scope of European Union directive 2012/19/EU on Waste Electrical and Electronic Equipment (WEEE). The product family must be disposed according to the legislation of the country. This document is intended for use by end of life recyclers or treatment facilities. It provides the basic information to assure an appropriate end of life treatment for the components and materials of the product.
<b>In case of special transportation: transportation method</b>	No
<b>Recyclability potential</b>	<b>3%</b> The recyclability rate was calculated from the recycling rates of each material making up the product based on REEECY'LAB tool developed by Ecosystem, for components/materials not covered by the tool, data from the EIME database and the related PSR was taken. If no data was found a conservative assumption was used (0% recyclability).

Schneider Electric Industries SAS  
 Country Customer Care Center  
<http://www.se.com/contact>  
 35, rue Joseph Monier  
 CS 30323  
 F- 92500 Rueil Malmaison Cedex  
 RCS Nanterre 954 503 439  
 Capital social 928 298 512 €

[www.se.com](http://www.se.com)

ENVEOLI2412024

Published by Schneider Electric

© 2023 - Schneider Electric – All rights reserved

12-2024