

Product End of Life Instructions

SpaceLogic Central I/O UI-8/DO-FC-4-H-2

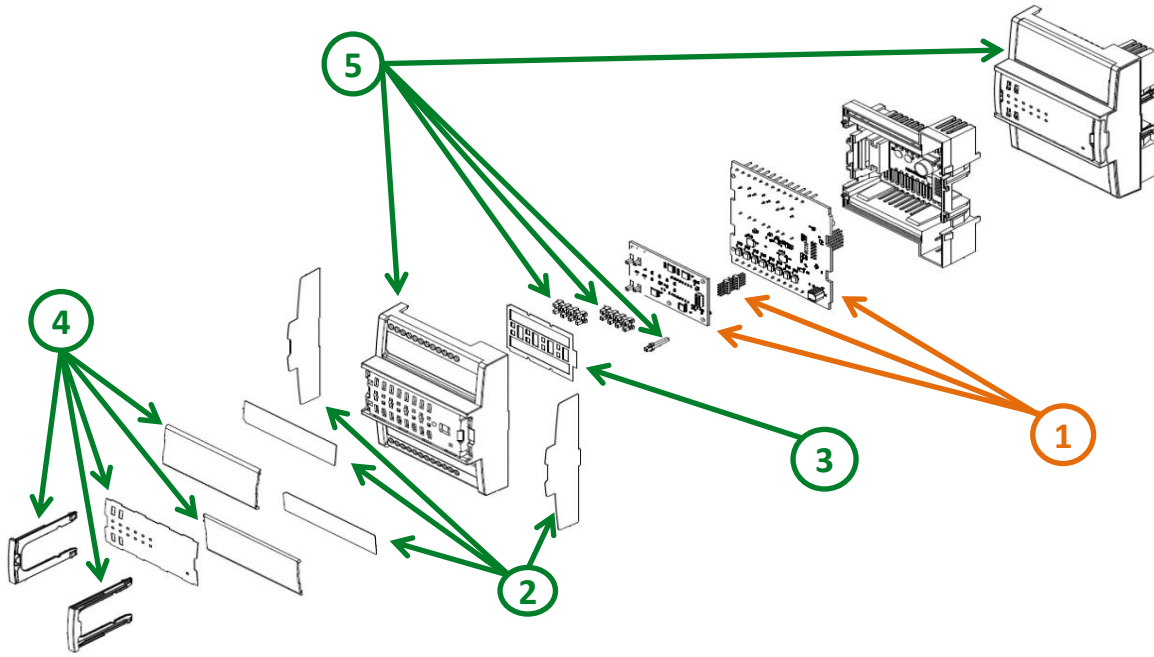

End of Life Instructions



Recommendation	Number on drawing	Component / Material	Weight (in g)	Comment
To be depolluted	1	Electronic Board (Communication) > 10cm ²		
To be dismantled	2	Plastic parts		PET
To be dismantled	3	Plastic parts		PP
To be dismantled	4, 5	Plastic parts		PC

Product description

Manufacturer identification	Schneider Electric Industries SAS
Brand name	Schneider Electric Industries SAS
Product function	<p>The SpaceLogic UI-8/DO-FC-4-H-2 is a universal input, 8 channel and digital output, 4 channel I/O expansion module for the SpaceLogic AS-P. The universal inputs are ideal for any mix of temperature, pressure, flow, status points and similar point types in a building control system. The digital outputs support digital Form C point types designed for direct load applications. The UI-8/DO-FC-4-H-2 I/O expansion module features 8 universal inputs and 4 digital Form C outputs with hand/off/auto override switches.</p> <p>(This document describes the different stages of the product, from manufacturing to its end of life, for example the manufacturing stage includes the production and transportation of the product and its packaging through the entire process and to the last logistics platform. This product is assembled in Timisoara, Romania and distributed globally. For its end of life optimization, any dismantling or separation of parts required is carried out as mentioned in the document and in accordance with EU regulations, viz. WEEE.)</p>
Product reference	SXWUI8D4H10002
Additional similar product references	SXWUI8D4H10002 SXWUI8A4H10002 SXWUI8A4X10002 SXWUI8D4X10002 SXWUI8V4H10002 SXWUI8V4X10002
Total representative product mass	168,78 g
Representative product dimensions	90mm x 113mm x 56mm
Date of information release	11-2024

Additional information

Legal information

This product family is in the scope of European Union directive 2012/19/EU on Waste Electrical and Electronic Equipment (WEEE). The product family must be disposed according to the legislation of the country. This document is intended for use by end of life recyclers or treatment facilities. It provides the basic information to assure an appropriate end of life treatment for the components and materials of the product.

Recyclability potential

0%

The recyclability rate was calculated from the recycling rates of each material making up the product based on REEECY'LAB tool developed by Ecosystem, for components/materials not covered by the tool, data from the EIME database and the related PSR was taken. If no data was found a conservative assumption was used (0% recyclability).

Schneider Electric Industries SAS

Country Customer Care Center
<http://www.se.com/contact>

35, rue Joseph Monier

CS 30323

F- 92500 Rueil Malmaison Cedex

RCS Nanterre 954 503 439

Capital social 928 298 512 €

www.se.com

Published by Schneider Electric

ENVEOLI2411003_V1

© 2023 - Schneider Electric – All rights reserved

11-2024