

Product End of Life Instructions

Resi9 Connect Communication Cabinet

as referent product for :
all Cabinets in Resi9 CONNECT BASIC range





End of Life Instructions

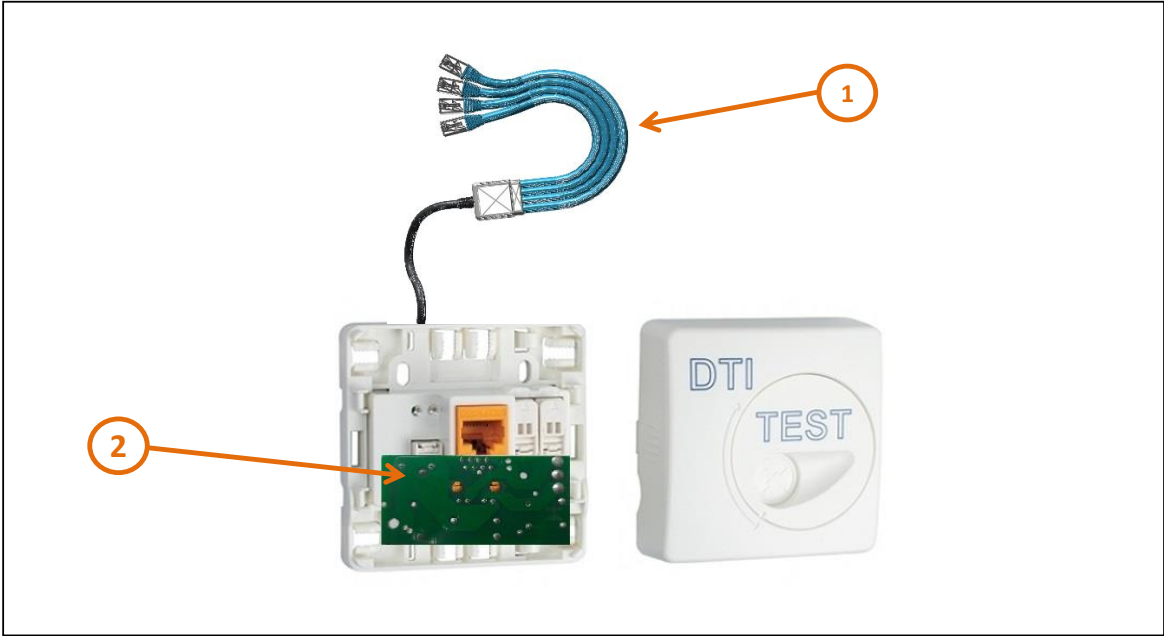

Recommendation	Number on drawing	Component / Material	Weight (g)	Comment
To be depolluted	1	Cable (Optical)	19	
To be depolluted	2	PCB assembly	15	



Product description

Manufacturer identification	Schneider Electric Industries SAS
Brand name	Schneider Electric
Product function	Resi9 connect basic product is a network / communication cabinet for residential purpose aiming to distribute communication signals (Phone, IP Data, TV, SAT, IPTV, LAN) to farthest corner of the house, safely and without interference. As central point, the network / communication cabinet can embed the ISP router to dispatch any IP Data (VoIP, IPTV, LAN) to RJ45 communication sockets on wall.
Product reference	VDIRM0036
Additional similar product references	VDIRM0006, VDIRM0042
Total representative product mass	1965 g
Representative product dimensions	500mm x 108mm x 252mm
Accessories	No
Date of information release	05-2024



Additional information

Legal information	This product family is in the scope of European Union directive 2012/19/EU on Waste Electrical and Electronic Equipment (WEEE). The product family must be disposed according to the legislation of the country. This document is intended for use by end of life recyclers or treatment facilities. It provides the basic information to assure an appropriate end of life treatment for the components and materials of the product.	
In case of special transportation: transportation method	No	
Recyclability potential	70%	Recyclability rate has been calculated based on REEECY'LAB tool developed by Ecosystem, for components/materials not covered by the tool, data from the "ECO'DEEE recyclability and recoverability calculation method" was taken. If no data was found a conservative assumption was used (0% recyclability).

Schneider Electric Industries SAS
Country Customer Care Center
<http://www.se.com/contact>
35, rue Joseph Monier
CS 30323
F- 92500 Rueil Malmaison Cedex
RCS Nanterre 954 503 439
Capital social 928 298 512 €

www.se.com

ENVEOLI2312011_V2

Published by Schneider Electric

© 2023 - Schneider Electric – All rights reserved

05/2024