

Product End of Life Instructions

Motor circuit breaker, TeSys Deca, Rotary handle

TeSys Deca Motor circuit breaker



End of Life Instructions

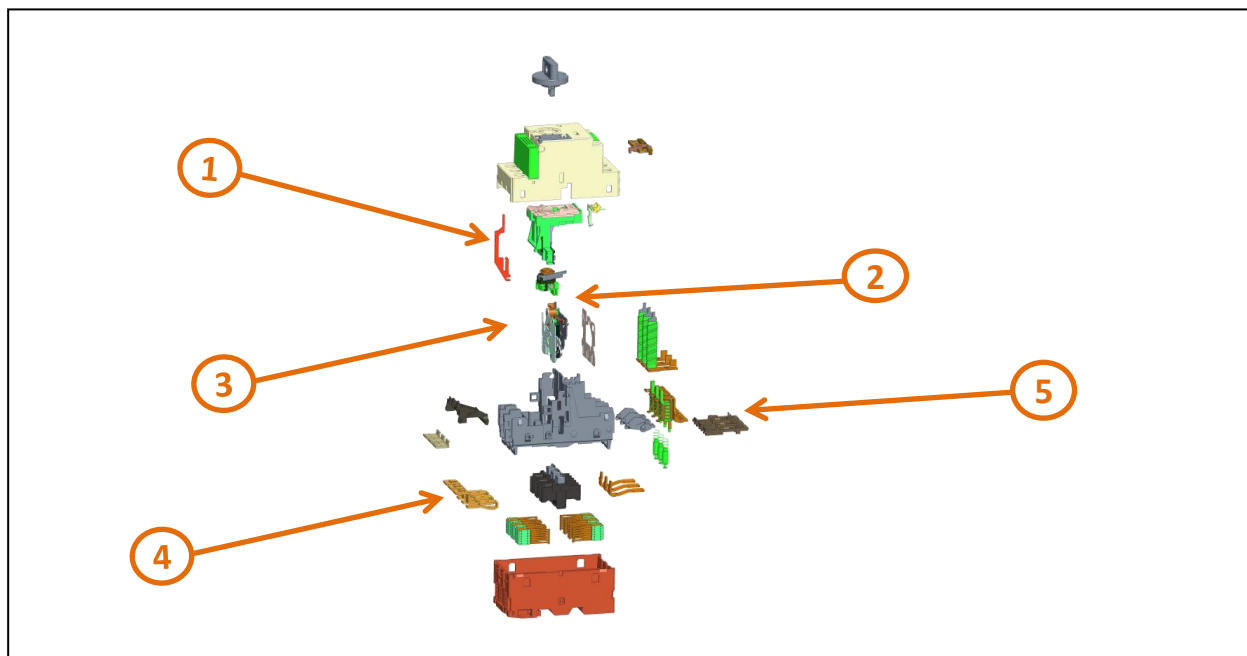

Recommendation	Number on drawing	Component / Material	Weight (in g)	Comment
To be depolluted	1,4	Other plastic parts with brominated flame retardants	0.366	Other plastic parts with brominated flame retardants
To be depolluted	2,3,5	PC, ABS-PC, PA, PA6, HDPE, SAN with brominated flame retardants	37.378	PC, ABS-PC, PA, PA6, HDPE, SAN with brominated flame retardants

Product description

Manufacturer identification	Schneider Electric Industries SAS
Brand name	Schneider Electric
Product function	The main purpose of the product is to protect three-phase motors, the cables, the people, against short circuits and overloads.
Product reference	GV2P22
Additional similar product references	Motor circuit-breaker, Magnetic circuit-breaker : GV2L, GV2P /01 to 32 Motor circuit-breaker, Magnetic circuit-breaker : GV2PMxxC /01 to 32, GV2LPxxC /03 to 32
Total representative product mass	313 g
Representative product dimensions	89mm x 45mm x 97mm
Accessories	No
Date of information release	30/03/2026

Additional information

Legal information	This product family is in the scope of European Union directive 2012/19/EU on Waste Electrical and Electronic Equipment (WEEE). The product family must be disposed according to the legislation of the country. This document is intended for use by end of life recyclers or treatment facilities. It provides the basic information to assure an appropriate end of life treatment for the components and materials of the product.
In case of special transportation: transportation method	No
Recyclability potential	52% The recyclability rate was calculated from the recycling rates of each material making up the product based on REEECYLAB tool developed by Ecosystem, for components/materials not covered by the tool, data from the EIME database and the related PSR was taken. If no data was found a conservative assumption was used (0% recyclability).

Schneider Electric Industries SAS
Country Customer Care Center
<http://www.se.com/contact>
35, rue Joseph Monier
CS 30323
F- 92500 Rueil Malmaison Cedex
RCS Nanterre 954 503 439
Capital social 928 298 512 €

www.se.com

ENVEOLI2211002_V4

Published by Schneider Electric

© 2023 - Schneider Electric – All rights reserved

30/03/2026