

Product End of Life Instructions

WISER PLUG - FR





Potential disassembly risks



End of Life Instructions

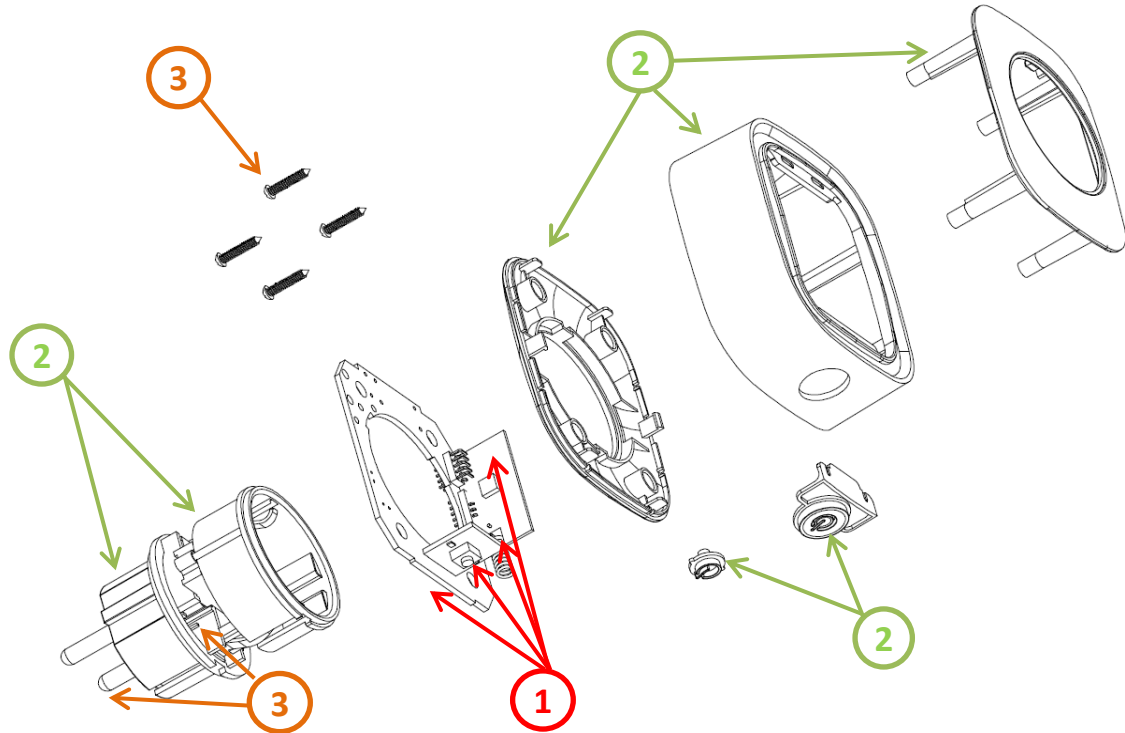

Recommendation	Number on drawing	Component / Material	Weight (in g)	Comment
To be depolluted	1	Electronic Board (Communication) > 10cm ²	30.151	26.145+1.2026+1.580272+1.223
Other	2	Plastics	60.662	
To be dismantled	3	Metals	21.0794	



Product description

Manufacturer identification	Schneider Electric Industries SAS
Brand name	Schneider Electric
Product function	Enabling you to set schedules for home appliances from the Wiser Heat app, the Wiser Plug can be controlled from your phone or by using voice activation with the Google Assistant and Amazon Alexa. As well as being able to control your home appliances remotely, the Wiser Plug also has a builtin range extender to enable connectivity to devices further away from the Heat HubR.
Product reference	CCTFR6500
Additional similar product references	CCTFR6500 WB704H1A0902 WB704H1A0902TS CCTFR6500 CCTFR6501
Total representative product mass	119 g
Representative product dimensions	79.6 x 67.9 x 62.8

Accessories	0
Date of information release	03/22

Additional information

Legal information	This product family is in the scope of European Union directive 2012/19/EU on Waste Electrical and Electronic Equipment (WEEE). The product family must be disposed according to the legislation of the country. This document is intended for use by end of life recyclers or treatment facilities. It provides the basic information to assure an appropriate end of life treatment for the components and materials of the product.	
In case of special transportation: transportation method	0	
Recyclability potential	72%	Based on "ECO'DEEE recyclability and recoverability calculation method" (version V1, 20 Sep. 2008 presented to the French Agency for Environment and Energy Management: ADEME).

Schneider Electric Industries SAS

Country Customer Care Center
<http://www.schneider-electric.com/contact>

35, rue Joseph Monier
 CS 30323
 F- 92506 Rueil Malmaison Cedex
 RCS Nanterre 954 503 439
 Capital social 896 313 776 €

www.schneider-electric.com

ENVEOLI2111003_V1

Published by Schneider Electric

© 2019 - Schneider Electric – All rights reserved

03/22