

Product End of Life Instructions

40-Series Module Rotary LED Dimmer

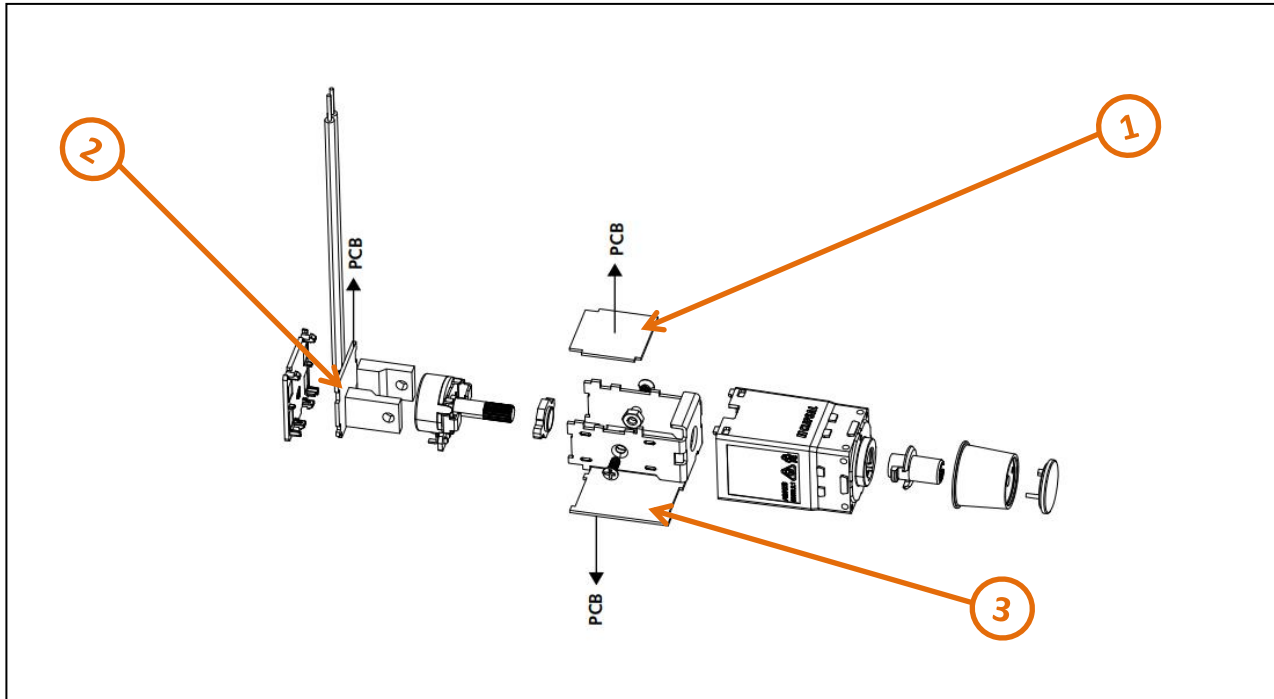

End of Life Instructions



Recommendation	Number on drawing	Component / Material	Weight (in g)	Comment
To be depolluted	1,2,3	Electronic Board (Communication) > 10cm ²	13.6	Including all soldering parts

Product description

Manufacturer identification	Schneider Electric Industries SAS
Brand name	Schneider Electric
Product function	Rotary LED dimmer is an electrical device that changes the light flux of the light source and adjusts the illumination level.
Product reference	42ELED2-VW
Total representative product mass	33 g
Representative product dimensions	22.84mm x 22.84mm x 54.65mm
Accessories	No
Date of information release	11/2021

Additional information

Legal information	This product family is in the scope of European Union directive 2012/19/EU on Waste Electrical and Electronic Equipment (WEEE). The product family must be disposed according to the legislation of the country. This document is intended for use by end of life recyclers or treatment facilities. It provides the basic information to assure an appropriate end of life treatment for the components and materials of the product.
In case of special transportation: transportation method	No

Recyclability potential	15%	Based on “ECO'DEEE recyclability and recoverability calculation method” (version V1, 20 Sep. 2008 presented to the French Agency for Environment and Energy Management: ADEME).
-------------------------	-----	---

Schneider Electric Industries SAS
 Country Customer Care Center
<http://www.schneider-electric.com/contact>
 35, rue Joseph Monier
 CS 30323
 F- 92506 Rueil Malmaison Cedex
 RCS Nanterre 954 503 439
 Capital social 896 313 776 €
www.schneider-electric.com

Published by Schneider Electric

ENVEOLI2108010_V1

© 2019 - Schneider Electric – All rights reserved

11/2021