

# Product End of Life Instructions

**ATV310, 3ph 380V, HD 22kW ND 30kW, EMC**

**Altivar Easy 310**



## Potential disassembly risks

The information provided in this document assumes that the product is completely de-energized and uninstalled (refer to the instructions provided in the appropriate product manuals).

Dismantling/disassembling the product may entail hazards caused by, for example, sharp edges, chemical aggression or ejected parts.

### WARNING

#### HAZARD DUE TO INSUFFICIENT PROTECTION

- Implement all safety measures required by the applicable regulations and by the processes used to dismantle/disassemble and dispose of the product.
  - Use all necessary personal protective equipment such as gloves and goggles.
- Failure to follow these instructions can result in death or serious injury.**

## End of Life Instructions

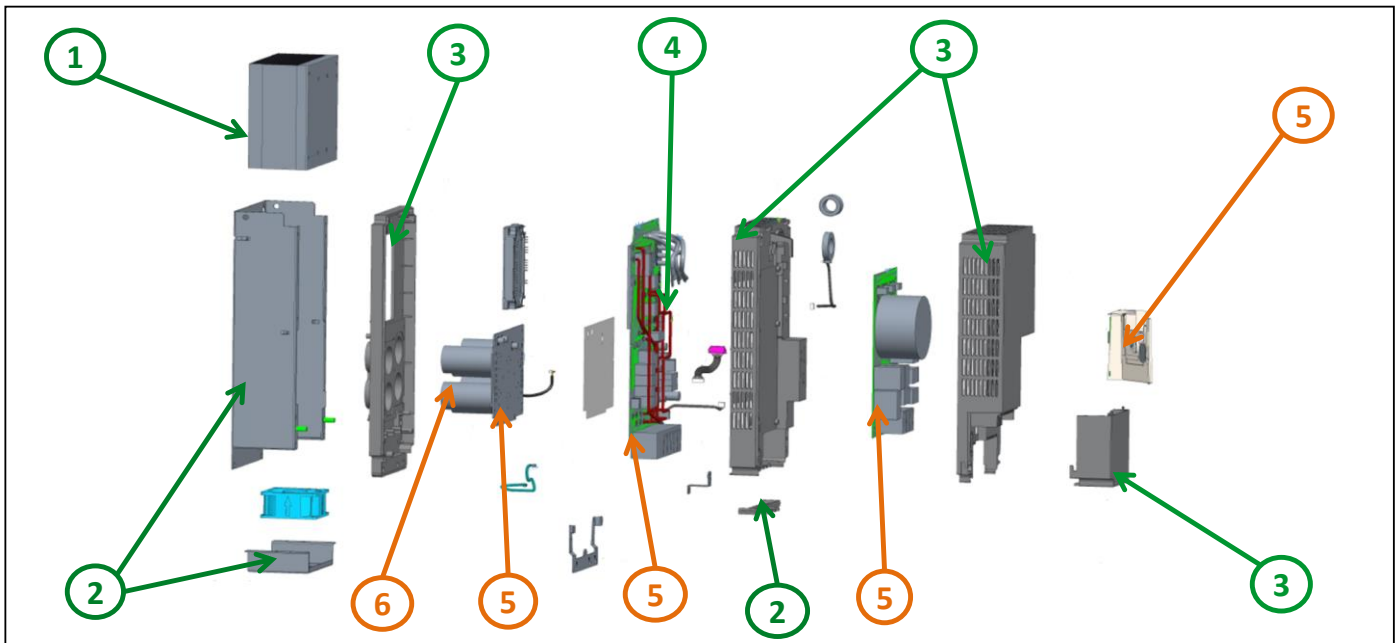

Recommendation	Number on drawing	Component / Material	Weight (in g)	Comment
To be dismantled	1	Aluminum	2740	Heatsink
To be dismantled	2	steel	1933	Plate, support, housing
To be dismantled	3	PC	1180	Chassis, cover, housing
To be dismantled	4	copper	240	Copper bar
To be depolluted	5	Electronic boards	2139	PCBA
To be depolluted	6	Electrolyte capacitors which size: height > 25 mm, diameter > 25 mm or proportionately similar volume	912	Electrolyte Capacitors
Other		Others	606	Except of the above parts



## Product description

Manufacturer identification	Schneider Electric Industries SAS
Brand name	Schneider Electric
Product function	The Altivar Machine ATV310 Power extension driver is a variable speed for three-phase asynchronous and synchronous motors.
Product reference	ATV310HD22N4EF
Additional similar product references	ATV310HD22N4EF ATV306H037N4A ATV306H075N4A ATV306HU15N4A ATV306HU22N4A ATV306HU30N4A ATV306HU40N4A ATV306HU55N4A ATV310H037N4A ATV310H037N4E ATV310H037N4S ATV310H075N4A ATV310H075N4E ATV310H075N4S ATV310HD11N4A ATV310HD11N4A116 ATV310HD11N4E ATV310HD11N4S ATV310HD15N4A ATV310HD15N4A116 ATV310HD15N4AF ATV310HD15N4E ATV310HD15N4EF ATV310HD18N4A ATV310HD18N4A116 ATV310HD18N4AF ATV310HD18N4E ATV310HD18N4EF ATV310HD22N4A ATV310HD22N4A116 ATV310HD22N4AF ATV310HD22N4E
Total representative product mass	9750 g
Representative product dimensions	390mm x 180mm x 212mm
Accessories	No
Date of information release	15/07/2025



## Additional information

Legal information	This product family is in the scope of European Union directive 2012/19/EU on Waste Electrical and Electronic Equipment (WEEE). The product family must be disposed according to the legislation of the country. This document is intended for use by end of life recyclers or treatment facilities. It provides the basic information to assure an appropriate end of life treatment for the components and materials of the product.
In case of special transportation: transportation method	No
Recyclability potential	<b>24%</b> The recyclability rate was calculated from the recycling rates of each material making up the product based on REEECYLAB tool developed by Ecosystem, for components/materials not covered by the tool, data from the EIME database and the related PSR was taken. If no data was found a conservative assumption was used (0% recyclability).

Schneider Electric Industries SAS

Country Customer Care Center  
<http://www.se.com/contact>

35, rue Joseph Monier  
CS 30323  
F- 92500 Rueil Malmaison Cedex  
RCS Nanterre 954 503 439  
Capital social 928 298 512 €

[www.se.com](http://www.se.com)

ENVEOLI2007007\_V2

Published by Schneider Electric

© 2023 - Schneider Electric – All rights reserved

15/07/2025