

Product End of Life Instructions

Altivar Machine ATV320, Variable speed drive, 0.75 kW, 200 to 240V, 1 phase, IP65, Vario

Altivar Machine ATV320





Potential disassembly risks

The information provided in this document assumes that the product is completely de-energized and uninstalled (refer to the instructions provided in the appropriate product manuals).

Dismantling/disassembling the product may entail hazards caused by, for example, sharp edges, chemical aggression or ejected parts.

▲ WARNING

HAZARD DUE TO INSUFFICIENT PROTECTION

- Implement all safety measures required by the applicable regulations and by the processes used to dismantle/disassemble and dispose of the product.
- Use all necessary personal protective equipment such as gloves and goggles.

Failure to follow these instructions can result in death or serious injury.

 **End of Life Instructions**

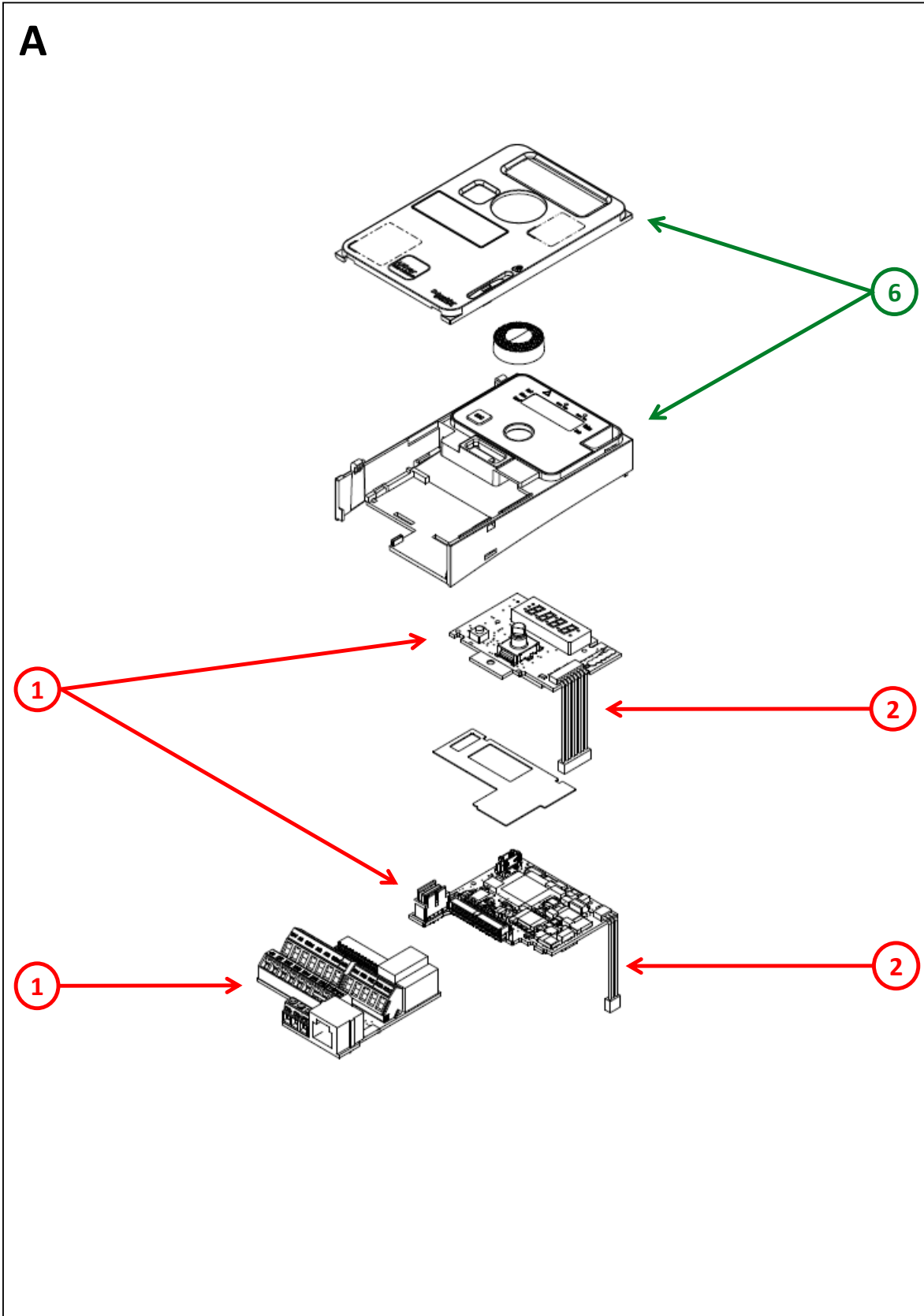

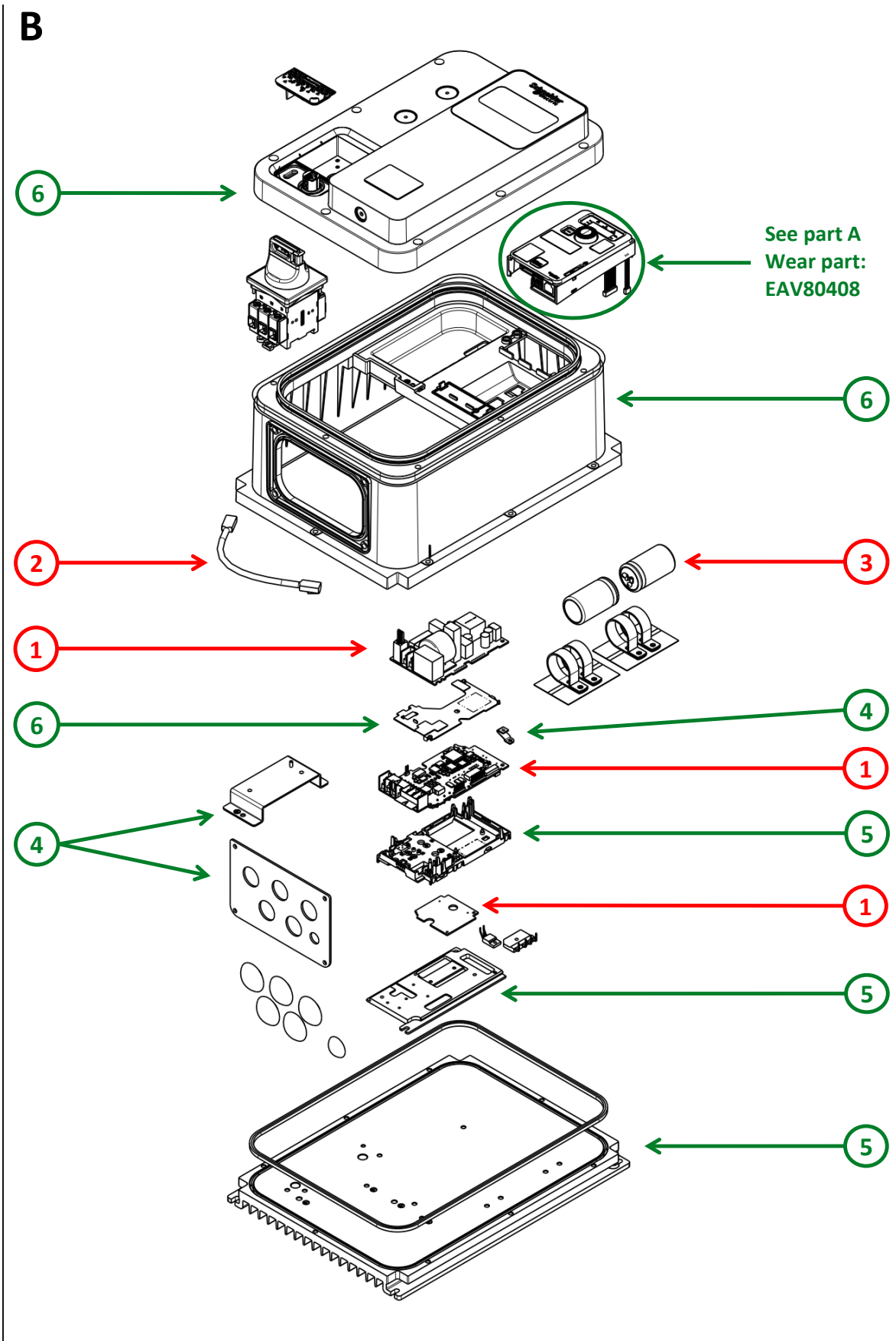

| Recommendation | Number on drawing | Component / Material | Weight (in g) | Comment |
|------------------|-------------------|---|---------------|--|
| To be depolluted | 1 | Electronic Board (Power and Communication) > 10cm ² | 335 | |
| To be depolluted | 2 | Cable (high current) | 87 | |
| To be depolluted | 3 | Electrolyte capacitors which size: height > 25 mm, diameter > 25 mm or proportionately similar volume | 121 | |
| To be dismantled | 4 | Steel | 287 | Plate - Ground Bar - Vario Support |
| To be dismantled | 5 | Aluminium | 2882 | Base Plate - Heatsink |
| To be dismantled | 6 | PC, ABS-PC, PA, PA6, HDPE, SAN with or without additive, PP+EPDM and PP | 1385 | Control Door - Housing - Cover - PCB Insulation - Control Support - PCBA Support |
| Other | | | 403 | |

Product description

| | |
|-----------------------------------|---|
| Manufacturer identification | Schneider Electric Industries SAS |
| Brand name | Schneider Electric |
| Product function | The main function of the Altivar Machine product range is the speed control and variation of a synchronous, asynchronous electric motor for fluid management and industrial applications. |
| Product reference | ATV320U07M2WS |
| Description of the range | This range consists of products Altivar Machine ATV320, a variable speed drive designed for Original Equipment Manufacturers (OEMs) that meets simple and advanced application requirements for a single-Phase synchronous and asynchronous motors from 0,18 to 0,75 kW (0,25 to 1 HP). |
| Total representative product mass | 5,5 kg |
| Representative product dimensions | 340mm x 250mm x 182mm |
| Accessories | No accessories needed. |
| Date of information release | 01/09/2025 |

Additional information

| | |
|--|--|
| Legal information | The product family must be disposed according to the legislation of the country. This document is intended for use by end of life recyclers or treatment facilities. It provides the basic information to assure an appropriate end of life treatment for the components and materials of the product. |
| In case of special transportation: transportation method | No special transportation. |
| Recyclability potential | 86% The recyclability rate was calculated from the recycling rates of each material making up the product based on REEECY'LAB tool developed by Ecosystem, for components/materials not covered by the tool, data from the EIME database and the related PSR was taken. If no data was found a conservative assumption was used (0% recyclability). |

Schneider Electric Industries SAS
Country Customer Care Center
<http://www.se.com/contact>
35, rue Joseph Monier
CS 30323
F- 92500 Rueil Malmaison Cedex
RCS Nanterre 954 503 439
Capital social 928 298 512 €

www.se.com

ENVEOLI1908002_V2

Published by Schneider Electric

© 2023 - Schneider Electric – All rights reserved

09-2025