

# Product End of Life Instructions

## PowerLogic ION9000





## Potential disassembly risks

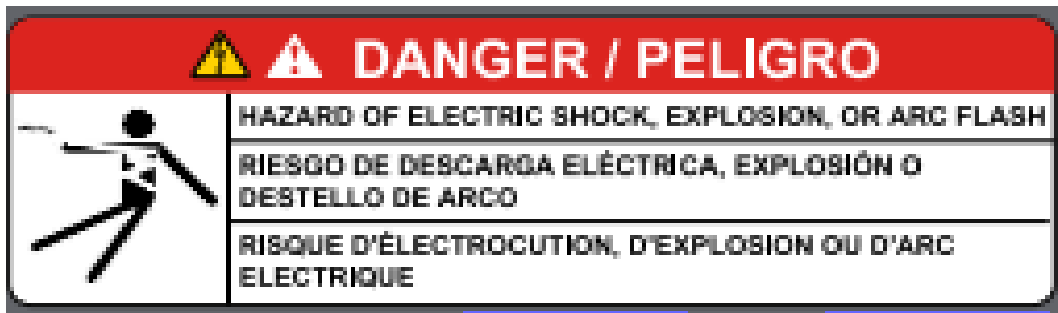

## End of Life Instructions

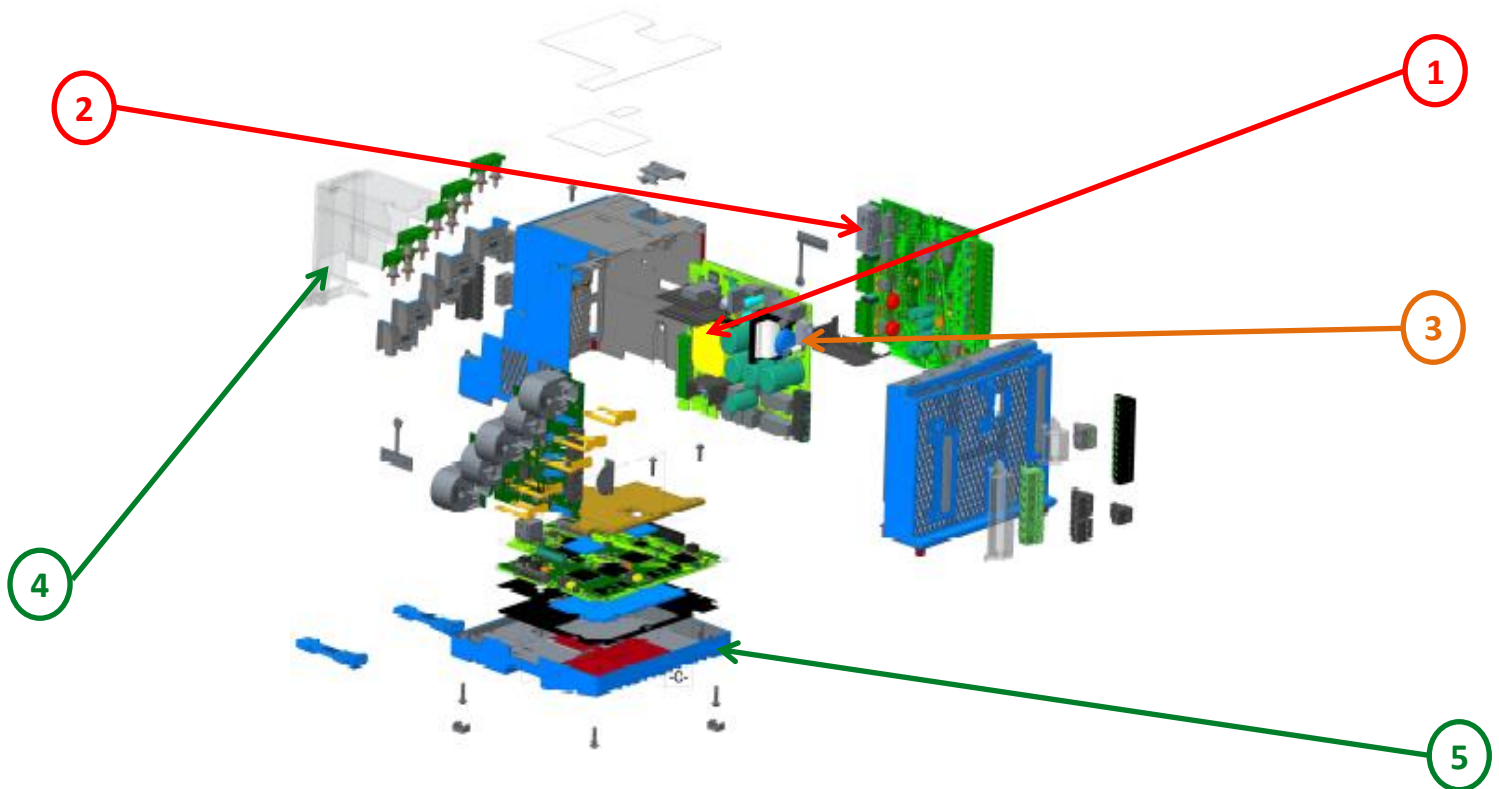

Recommendation	Number on drawing	Component / Material	Weight (in g)	Comment
To be depolluted	1	BATTERY 3V 120mAh	1.5	
To be depolluted	2 & 3	PCBA, PM9000 CPU PCBA, PM9000 PSU PCBA, PM9000 IO	1236.25	
To be depolluted		Display devices	400	
Other		Cables	131.34	
Other		Metals	484.82	
Other		Plastics	819.37	
Other	4	TERMINAL COVER, CT INPUTS	5.47	
Other	5	REAR COVER METSERD192	122.38	



## Product description

<b>Manufacturer identification</b>	Schneider Electric Industries SAS
<b>Brand name</b>	Schneider Electric
<b>Product function</b>	<p>The Power Meter measures, records, communicates. It can be on din-rail or panel mounted. It is powered by 240vAC supply. The functionalities and accuracy:</p> <p>Power meters monitor Power (Voltage, Current, Power, Energy) and Power quality (harmonics, Sag/swell, Transient).</p> <p>Data can be recorded (fast recording) to be uploaded on Edge software. Most of meters have a display to configure and visualize the data. Communication with Edge software is also available on advance meters.</p>
<b>Product reference</b>	METSEION95040
<b>Additional similar product references</b>	METSEION95040 METSEION92043 METSEION92044 METSEION92130 METSEION92140 METSEION92143 METSEION92144 METSEION95043 METSEION95044 METSEION95130 METSEION95140 METSEION95143 METSEION95144 METSEION92040 METSEION92030 METSEION95030
<b>Total representative product mass</b>	3201.13 g
<b>Representative product dimensions</b>	136mm x 160mm x 160mm
<b>Accessories</b>	Connectors & B25 cables
<b>Date of information release</b>	11/2018



## Additional information

<b>Legal information</b>	This product family is in the scope of European Union directive 2012/19/EU on Waste Electrical and Electronic Equipment (WEEE). The product family must be disposed according to the legislation of the country. This document is intended for use by end of life recyclers or treatment facilities. It provides the basic information to assure an appropriate end of life treatment for the components and materials of the product.	
<b>Recyclability potential</b>	<b>21%</b>	Based on "ECO'DEEE recyclability and recoverability calculation method" (version V1, 20 Sep. 2008 presented to the French Agency for Environment and Energy Management: ADEME).

Schneider Electric Industries SAS

Country Customer Care Center  
<http://www.schneider-electric.com/contact>

35, rue Joseph Monier

CS 30323

F- 92506 Rueil Malmaison Cedex

RCS Nanterre 954 503 439

Capital social 896 313 776 €

[www.schneider-electric.com](http://www.schneider-electric.com)

Published by Schneider Electric

ENVEOLI1801009\_V1

© 2017 - Schneider Electric – All rights reserved

11/2018