

Product End-of-Life Instructions

ALTIVAR PROCESS

Product Range

ALTIVAR PROCESS – Low Harmonic Drive Systems. Ranges: 90 to 800kW - 400V- 3PH – IP23/IP54

Marketing Model

ATV680C31Q4X1, ATV680C11Q4X1, ATV680C13Q4X1, ATV680C16Q4X1, ATV680C20Q4X1, ATV680C25Q4X1, ATV680C35Q4X1, ATV680C40Q4X1, ATV680C45Q4X1, ATV680C50Q4X1, ATV680C56Q4X1, ATV680C63Q4X1, ATV680C71Q4X1, ATV680C80Q4X1



Size in mm:

W x H x D : 1000 x 2350 x 664

Weight in g:

From 445000 to 2045000 for the product range.

Weight is 803000 for ATV680C31Q4X1 including packaging and batteries (weight of the battery is 3).



Operations recommended for the end of life treatment

There are several steps to process the products at the end of life so as to recover components, materials or energy :

Reuse \Rightarrow Separation for special treatment \Rightarrow Other Dismantling \Rightarrow Shredding

This product contains electrolytic capacitors which may cause electrical shock during the end of life treatment process. **BEFORE SERVICING, REMOVE ALL POWER, WAIT 15 MINUTES.**

The components of the products that optimize the recycling performances are listed, identified and located hereunder.

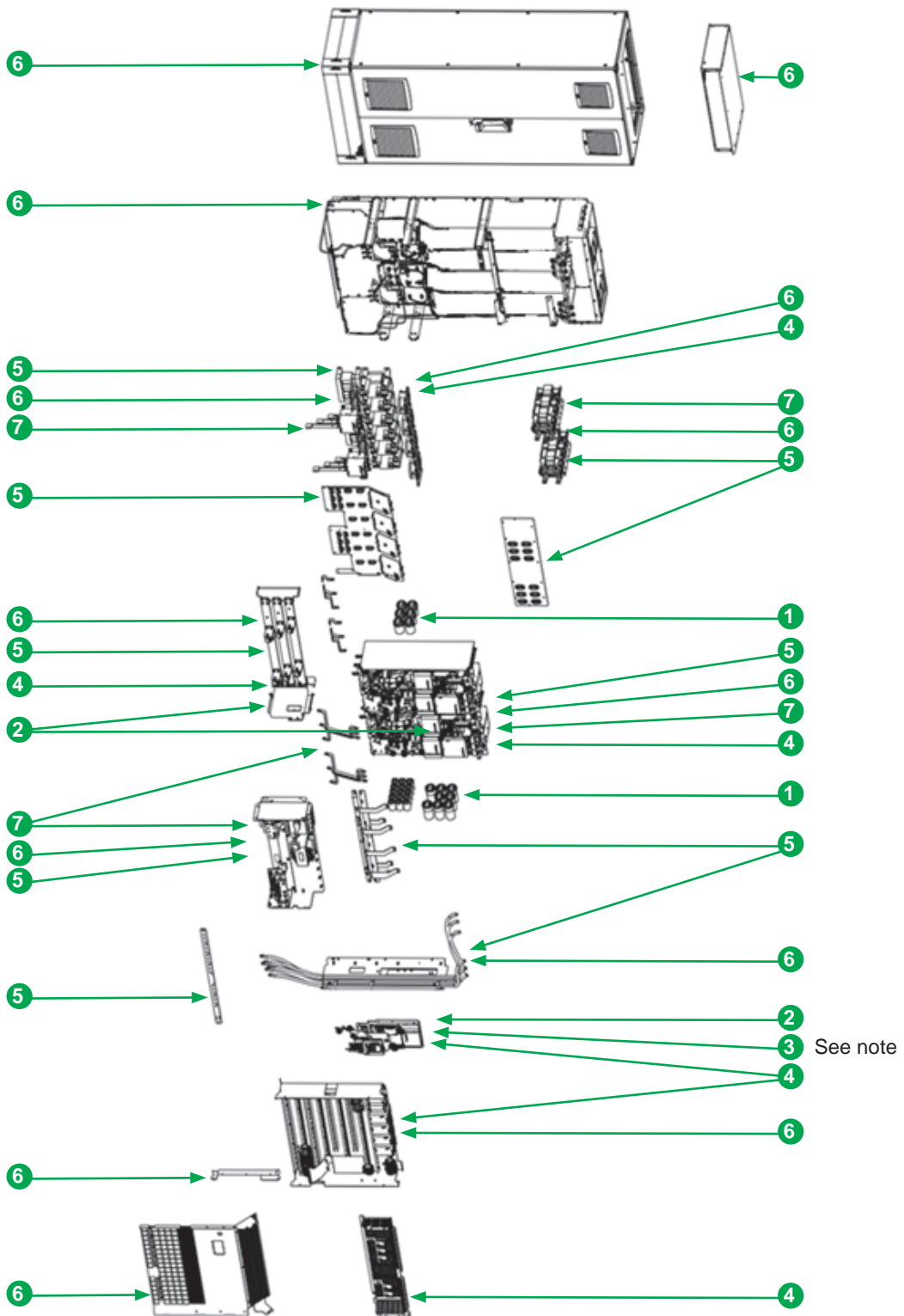

Note:



| Recommendation | Number on drawing | Components | Weight (g) | Comment |
|-------------------|-------------------|---|------------|--|
| Operating hazards | 1 | Electrolytic capacitors | 15628 | 28 pieces are included |
| Special treatment | 2 | Printed Circuit Board Assembly (PCBA) or power components | 6290 | 26 PCBAs are included |
| | 3 | Manganese Dioxide Lithium Coin Battery | 3 | The battery is located inside the Keypad |
| Other dismantling | 4 | Plastic part | 10664 | – |
| | 5 | Aluminium | 112085 | – |
| | 6 | Steel | 521831 | – |
| | 7 | Copper | 44374 | – |

Schneider Electric Industries SAS

35, rue Joseph Monier
CS30323
F - 92506 Rueil Malmaison Cedex

RCS Nanterre 954 503 439
Capital social 896 313 776 €
www.schneider-electric.com

The version of the Guide used to create the document: End of Life Instruction Drafting Guide of Schneider Electric version V6.

Publication : Schneider Electric