

Product End-of-Life Instructions

**TESYS OVERLOAD RELAY CHINA
(LRD01C to LRD35C)**

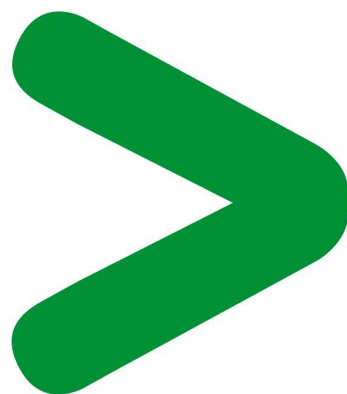
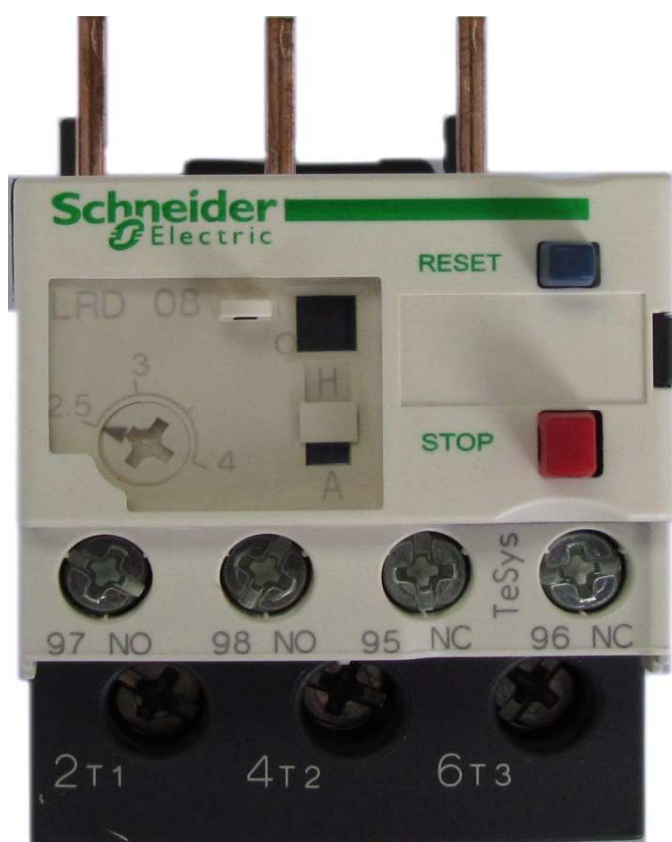

Product End-of-Life Instructions – EoLI

Product overview

Product Range: TESYS OVERLOAD RELAY CHINA (LRD01C to LRD35C)

Marketing Model/Name: TESYS OVERLOAD RELAY S/A 2.5-4A, LRD08C

Size: H x L x D in mm = **65 x 45 x 70**

Weight in g = **126.5**

Purpose

The product family must be disposed according to the legislation of the country. This document is intended for use by end of life recyclers or treatment facilities. It provides the basic information to assure an appropriate end of life treatment for the components and materials of the product.

Note:

This product family is in the scope of European Union directive 2012/19/EU on Waste Electrical and Electronic Equipment (WEEE).

Additional information

Energy-efficiency:

This product family is available with Active and off mode power demand phases. The availability of modes is as follow: It is 0.46 W at 30% load in Active mode (30% of the time) and 0 W in OFF mode (at 70% of the time) for the referenced model.

Resource-efficiency:

The recyclability potential of the products has been evaluated using the “ECO DEEE recyclability and recoverability calculation method” (version V1, 20 Sep. 2008 presented to the French Agency for Environment and Energy Management: ADEME).

According to this method, the potential recyclability ratio without packaging is: **33%**.

As described in the recyclability calculation method this ratio includes only metals and plastics which have proven industrial recycling processes.

Operations recommended for the end of life treatment

There are several steps to process the products at the end of life so as to recover components, materials or energy :

Reuse → Separation for special treatment → Other dismantling → Shredding

Product End-of-Life Instructions – EoLI

The components of the products that optimize the recycling performances are listed, identified and located hereunder.

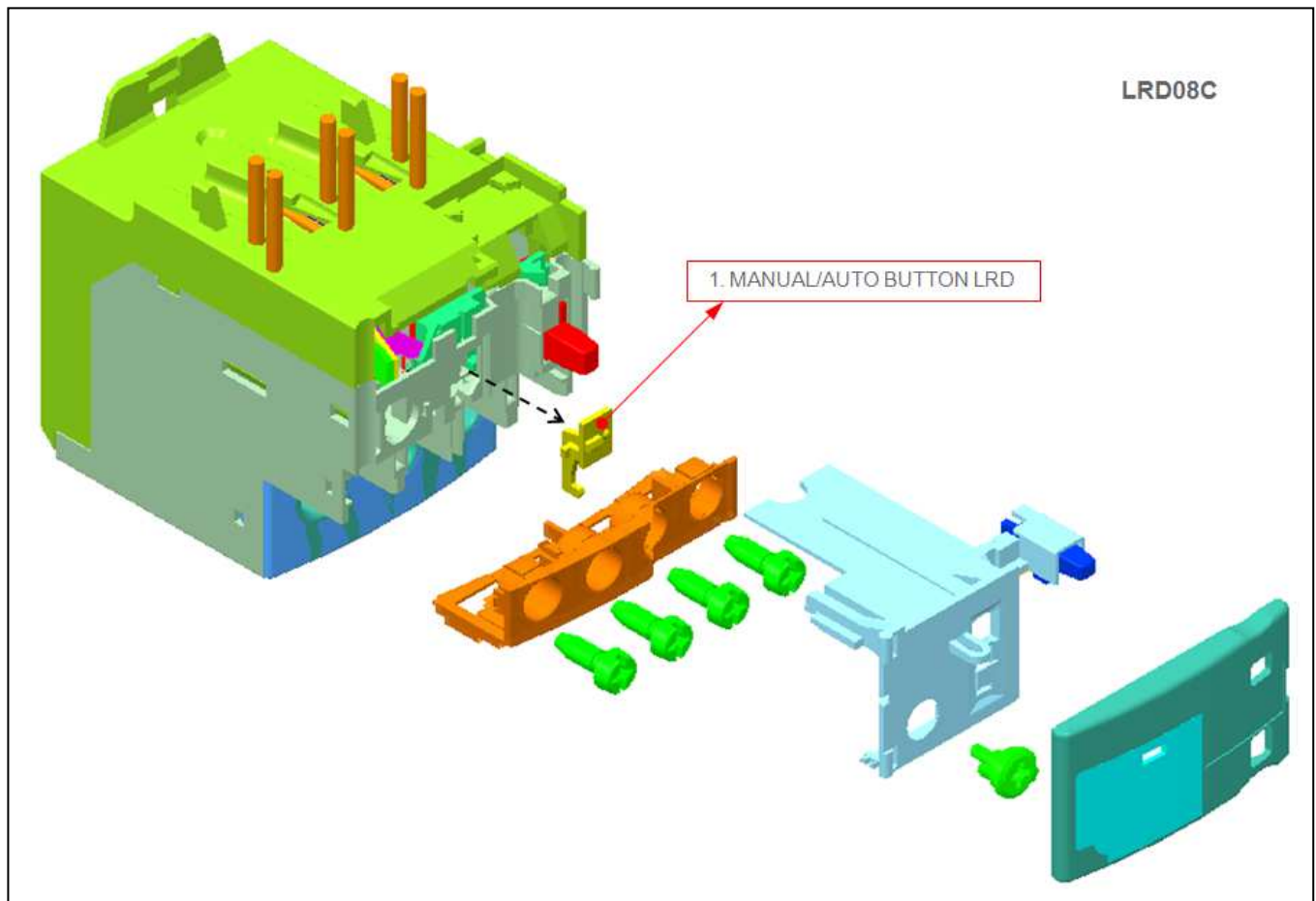

Recommendation	Number on drawing	Components	Weight (in g)	Comment
Components listed for special treatment which improves the recycling performances	1. W416365110911C	MANUAL/AUTO BUTTON LRD	0.14	Contains Brominated flame retardant

EoLI achieved with Schneider-Electric TT03 V6 procedure

Schneider Electric Industries SAS

35, rue Joseph Monier
CS 30323
F- 92506 Rueil Malmaison Cedex
RCS Nanterre 954 503 439
Capital social 896 313 776 €

www.schneider-electric.com