

ELG745050, MEG4841-0300

Sigma care

Additional information →

Scan the QR code or follow the link.

Further information about the Sigma Care call system are available online.



ELG745050

<https://www.go2se.com/ref=ELG745050>
<https://www.go2se.com/ref=MEG4841-0300>

MEG4841-0300

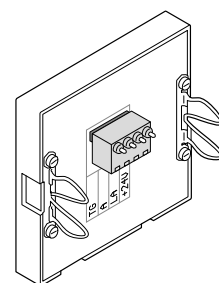
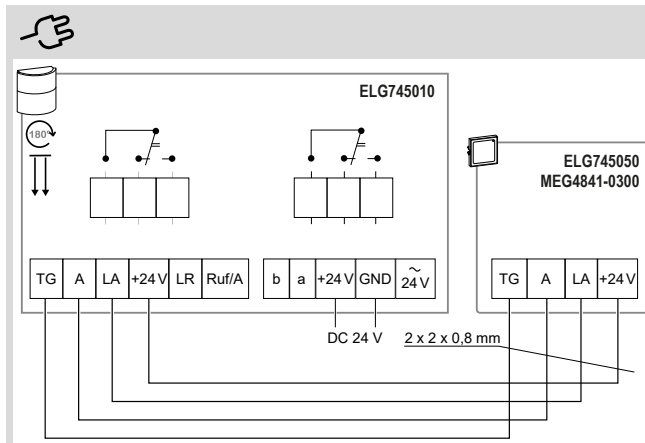
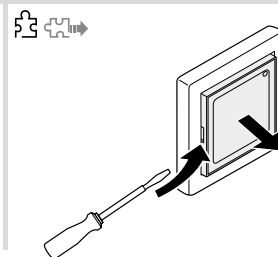
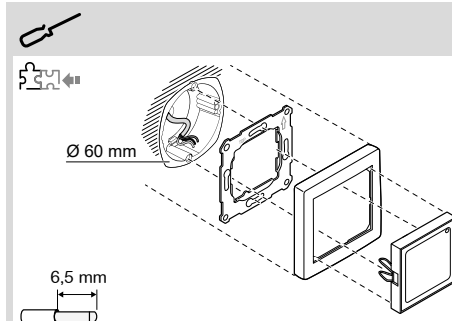

en Presence / cancel button

Installation instructions

⚠ ⚠ WARNING

DANGER RISK OF FATAL INJURY FROM IMPROPER INSTALLATION

Safe electrical installation must be carried out by qualified professionals. Qualified professionals must demonstrate an in-depth knowledge of:

- Connecting to installation networks
- Connecting multiple electrical appliances
- Installation of electric cables
- Connection and installation of call systems in accordance with DIN VDE 0834
- Safety standards, local connection rules and regulations

The commissioning and further work or changes to the call system may only be carried out by a call system specialist in accordance with DIN VDE 0834.

Failure to observe these instructions can lead to death or serious injuries.

⚠ ⚠ DANGER

DANGER RISK OF FATAL INJURY FROM ELECTRIC SHOCK

Insulation and protection against contact must be maintained. Devices of the call system and devices of the low-voltage system (e.g. switches, sockets) must not be covered with a shared cover plate.

Failure to observe these instructions will lead to death or serious injuries.

Additional Information →

Scan the QR code or follow the link.

A detailed description of the presence / cancel button and other useful information about the Sigma care call system are available online in the Online User Guide.

Required accessories

To be completed with the design frames:

- ELSO Joy, ELSO Fashion with adaptor frame
- Merten System M, Merten System D frame with adaptor frame

Getting to know the device

Sigma care devices are installed, for example, in disabled toilets. The presence / cancel button is used by personnel to cancel a triggered call and, where appropriate, to indicate presence with acoustic call forwarding. Optical and audible signaling is displayed on a room module mounted visibly outside the room.

- With a large green cancel button and a green LED indicating presence.
- With integrated sound transmitter that serves as audible call forwarding if personnel presence indicated.

Installation location

Cancel buttons must be mounted at a height of 0.7 m to 1.5 m in accordance with DIN 0834.

Installation is carried out in the room in which calls are triggered (typically next to the door).

Installation →

Installation is carried out on a 60 mm flush-mounted box.

Connection →

Note A maximum of 4 presence / cancel buttons can be connected to a room module with signal lamp. The max. cable length of 50 m must be observed.

Note Interchanging cables (with regard to the connection diagram) results in malfunctions.

TG	Sound transmitter
A	Cancel / presence button
LA	Presence lamp
+24 V	Operating voltage

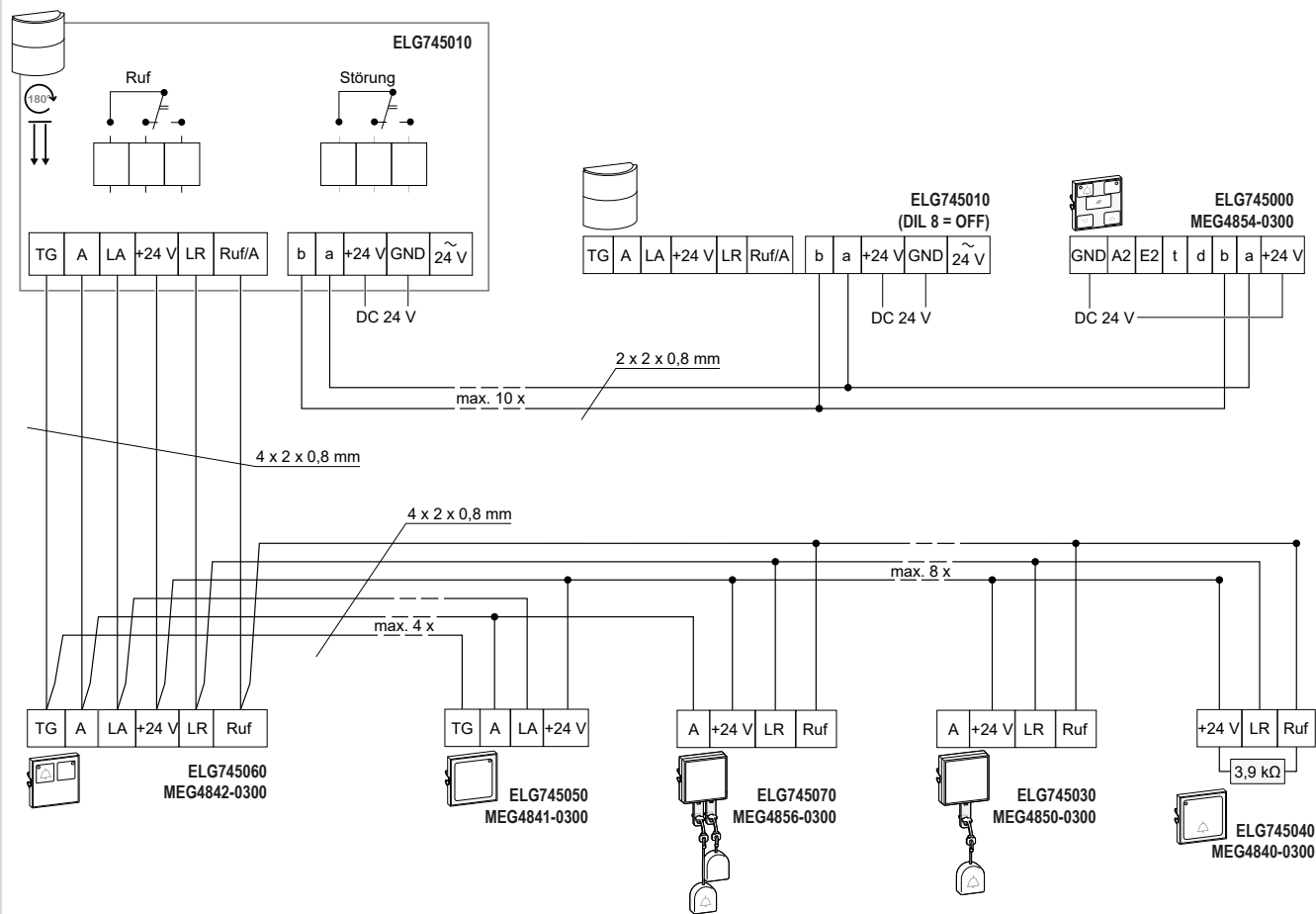

Technical data

Supply

Operating voltage: DC 24 V $\pm 10\%$,
via the ELG745010
room module

Current consumption: max. 20 mA

Cancel / presence line

Line termination resistor
(standby current)
to +24 V: $-/- \text{ k}\Omega \pm 5\%$

Standby current: 3.5 mA $\pm 10\%$

Working resistor active
to +24 V with button op-
eration parallel to the ter-
minator: 1.0 k $\Omega \pm 5\%$

Working current: 5 mA $\pm 10\%$

Calming lamp

Current consumption: 20 mA

Sound transmitter

Volume: 45 - 50 dB(A) at a
distance of 2 m

Connecting terminal

Terminal: Plug-in terminal,
4-pole

Conductors per pole: 2

Stripped length: 6.5 mm

Environmental conditions

Ambient temperature
during operation: 0 °C ... 50 °C

Relative humidity: max. 85%,
non-condensing

Protection rating:

IP20

Cable type:

J-Y(St)Y,
2 x 2 x 0.8 mm

Cable length:

max. 50 m

Dimensions (W x H x D):

55 x 55 x 10 mm



Schneider Electric GmbH c/o ELSO

Am der Wipper 5-7 | D-99706 Sondershausen
Tel: +49 3632 51 0
e-mail: info.elseo@schneider-electric.com
www.se.com/de

Schneider Electric GmbH c/o Merten

Gothaer Strasse 29 | D-40880 Ratingen
www.merten.de | www.se.com/de