

Test rods for XUSL2E / XUSL4E (Original instruction sheet)

Flash the Qr-code to access the complete User Manual and this Instruction Sheet in different languages.

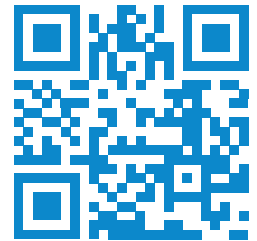

<http://qr.tesensors.com/XU0006>

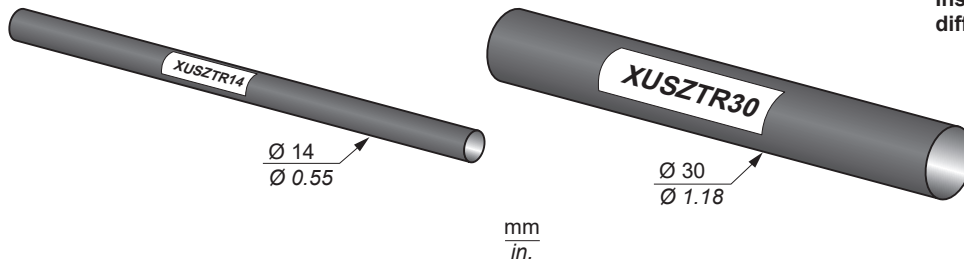

Test process

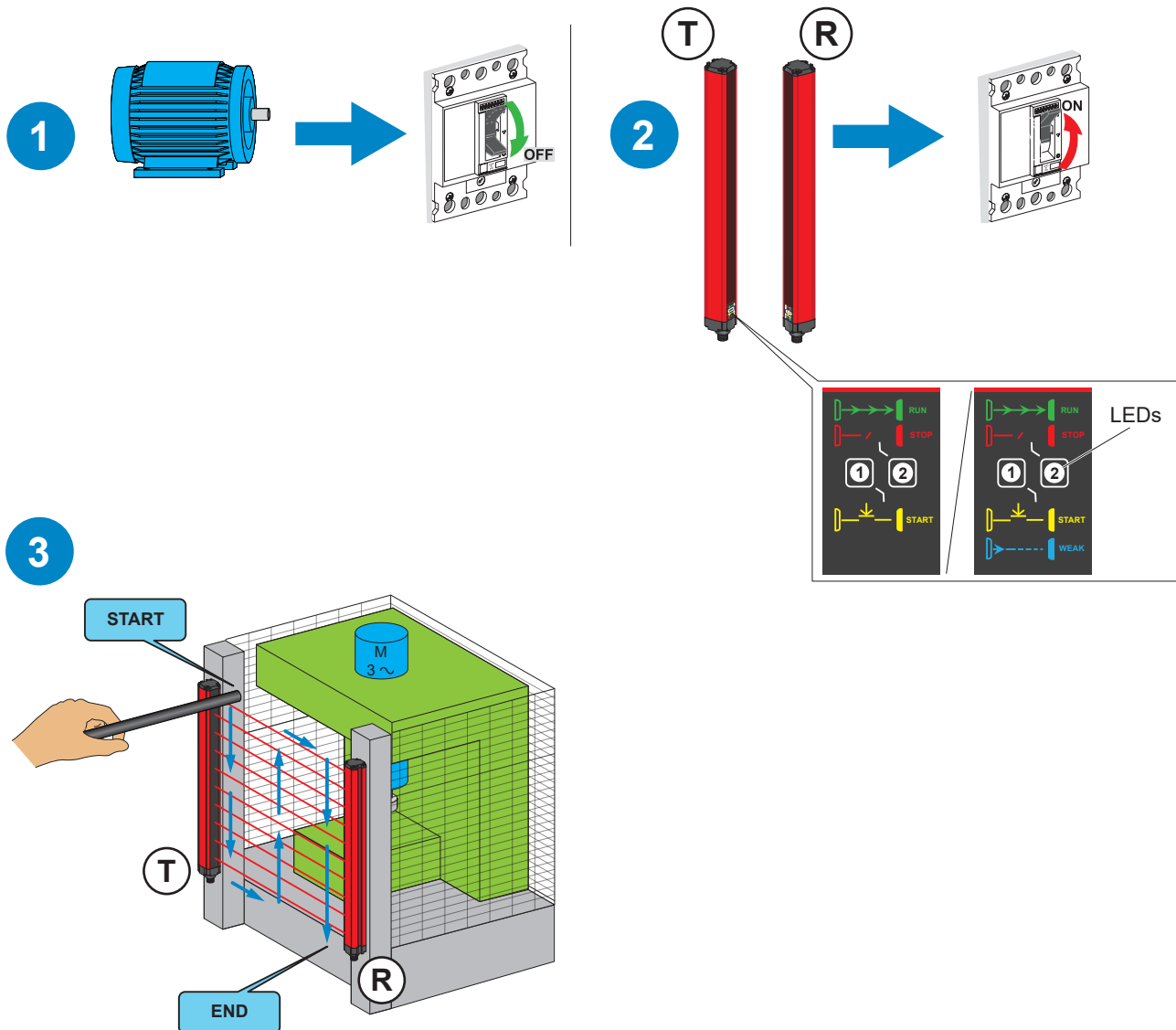

The test is to be performed in accordance to the figure above by moving the test rod slowly along the indicated path:
 Before starting the test, the green LED 1 must be lit on the receiver. During the test, the Red LED 2 must remain ON (lit) and the Green LED 1 must be OFF.
 For multiple light beam systems (2-3 or 4 beams), use an opaque object to interrupt the beams one after the other by starting at the center and then close to the transmitter and receiver.

Electrical equipment should be installed, operated, serviced, and maintained only by qualified personnel.
 No responsibility is assumed by Schneider Electric for any consequences arising out of the use of this material.

© 2018 Schneider Electric. "All Rights Reserved."

Test rods for XUSL4M

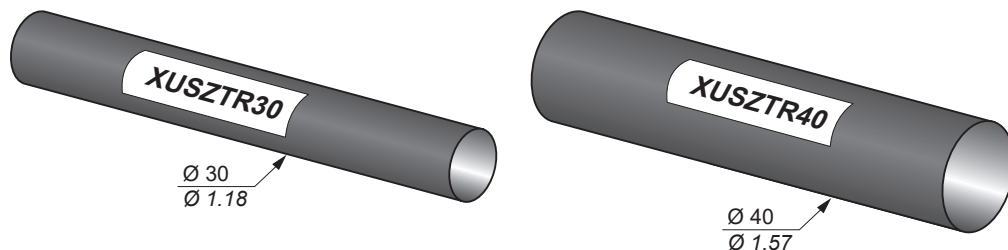

Test process

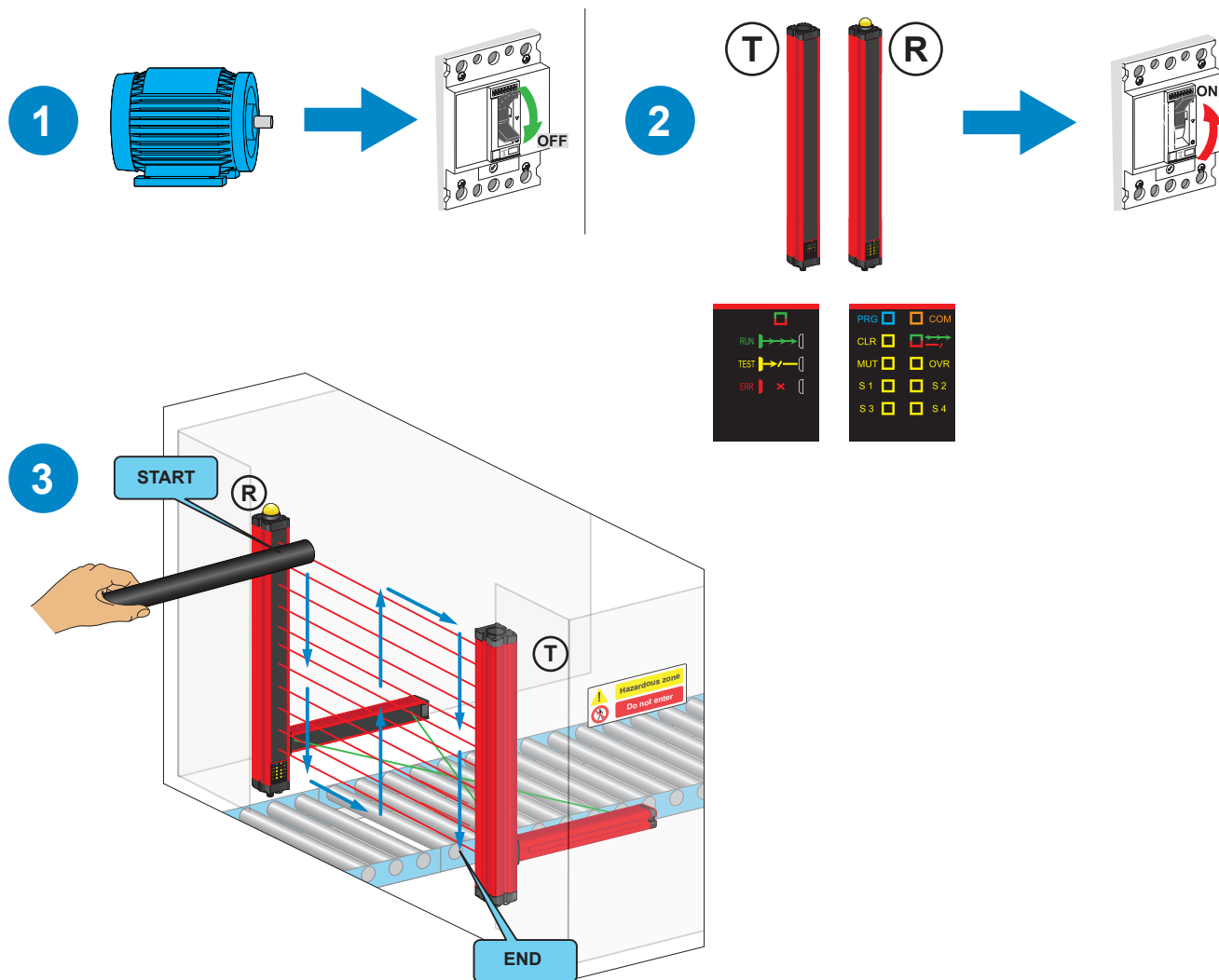

Verify protected zone resolution: For the test, use the correct test rod be ordered separately (For 30mm and 40mm resolution models, the diameter must equal to the Safety Light Curtain resolution).

Process:

- Insert the test rod into the controlled area and move it slowly as indicated on the drawing following the same path as the arrows.
- Check that at each stage of the test rod movement, the red LED  on the receiver remains in any case switched on (lit), and the Green LED stays OFF.

Note: For multiple light beam systems (2-3 or 4 beams) use an opaque object to interrupt the beams one after the other by starting at the center and then close to the transmitter and receiver.