

NEMA SIZE OD, O, 1 STARTER
 3-POLE POLYPHASE - 600 VAC, 50-60 HZ

NEMA SIZE	CONTINUOUS CURRENT RATINGS	TYPE CODE (1)
OD	8	A012
D	18	B02
1	27	C03

COIL VOLTAGE CODE (2)	VOLTAGE	
	60 HZ	50 HZ
V01	24	-
V02S	120#	110
V08	208	-
V03	240	220
V06	480	440
V07	500	550
V99	SPECIFY	SPECIFY

= 120 Volt Polyphase starters are wired for separate control.

TYPE CODE (3)	SOLID STATE OVERLOAD RELAY PROTECTION
H10	CLASS 10
H20	CLASS 20
H30	SELECTABLE CLASS 10/20

MOTOR VOLTS	MAX. HP FOR NEMA SIZE		
	00	0	1
200	1.5	3	7.5
230	1.5	3	7.5
480	2	5	10
575	2	5	10

MINIMUM TO WALL OR BARRIER TO INSURE ADEQUATE WIRE BENDING SPACE TO LUG SURFACE WHEN THE MAXIMUM WIRE SIZE IS USED. REF. NEC 430-10

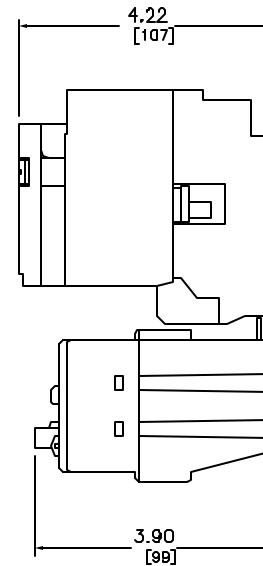
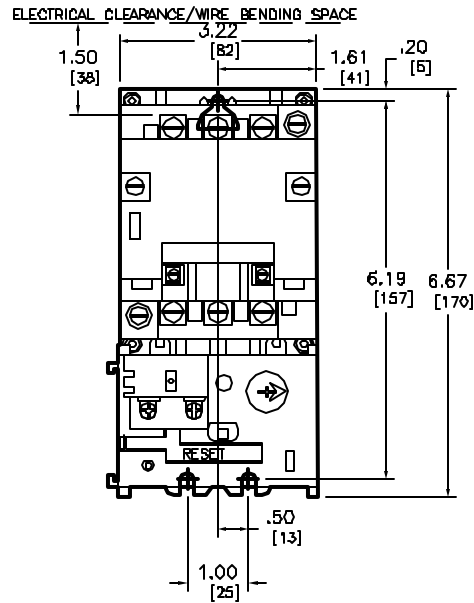

Catalog Number: 8536-S(1)(2)(3)
 Ratings: SEE CHART
 UL File/CCN: NLDX
 CSA File/Class: 32011-04
 Meets Standards: -
 Weight: 3.98 lbs
 Wire Size: POWER - #14-#8, CONTROL - #16-#12
 Terminal torque: 20 lb./in.
 Mounting Hwd.: (3) #8 screws

DUAL DIMENSIONS: INCHES
 MILLIMETERS

NEMA SIZE OD, O, 1 STARTER W/SSOLR
 CLASS 8536 TYPE S (1) (2) (3)



DWG# E0320401-01
 NO.