

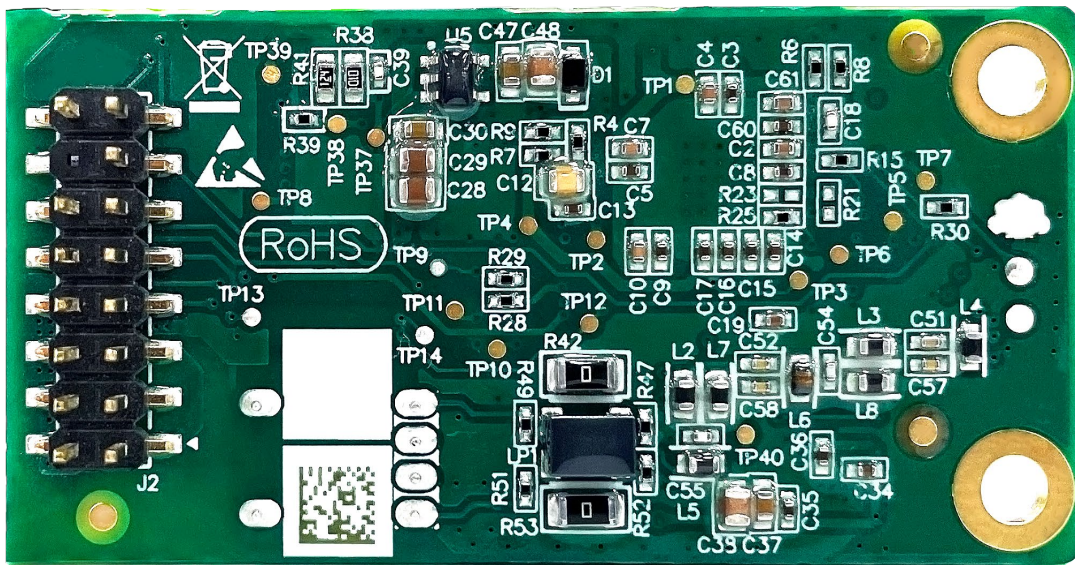

www.se.com

D3994683

en Schneider Charge Pro - ISO 15118
Module Installation Guide



Customer Care Center

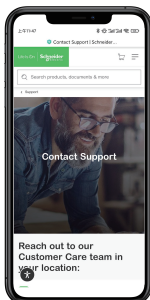

Safety	3
Important Information	3
1. Content	4
2. Module Installation	5
2.1 Tools Supplied by User.....	5
2.2 Module Assembly.....	5
3. Inspection and Power On	8
3.1 Power On.....	8
3.2 Firmware Upgrade after Module Assembly.....	8
3.3 Inspection by eSetup.....	8
4. Recycling Packaging	8

The information provided in this document contains general descriptions, technical characteristics and/or recommendations related to products/solutions.

This document is not intended as a substitute for a detailed study or operational and site-specific development or schematic plan. It is not to be used for determining suitability or reliability of the products/solutions for specific user applications. It is the duty of any such user to perform or have any professional expert of its choice (integrator, specifier or the like) perform the appropriate and comprehensive risk analysis, evaluation and testing of the products/solutions with respect to the relevant specific application or use thereof.

The Schneider Electric brand and any trademarks of Schneider Electric SE and its subsidiaries referred to in this document are the property of Schneider Electric SE or its subsidiaries. All other brands may be trademarks of their respective owner.

This document and its content are protected under applicable copy right laws and provided for informative use only. No part of this document may be reproduced or transmitted in any form or by any means (electronic, mechanical, photocopying, recording, or otherwise), for any purpose, without the prior written permission of Schneider Electric.

Schneider Electric does not grant any right or license for commercial use of the document or its content, except for a non-exclusive and personal license to consult it on an "as is" basis.

Schneider Electric reserves the right to make changes or updates with respect to or in the content of this document or the format thereof, at any time without notice.

To the extent permitted by applicable law, no responsibility or liability is assumed by Schneider Electric and its subsidiaries for any errors or omissions in the informational content of this document, as well as any non-intended use or misuse of the content thereof.

Electrical equipment should be installed, operated, serviced, and maintained only by qualified personnel. No responsibility is assumed by Schneider Electric for any consequences arising out of the use of this material.

Safety

Important Information



Read these instructions carefully, and look at the equipment to become familiar with the device before trying to install, operate, service, or maintain it. The following special messages may appear throughout this documentation or on the equipment to warn of potential hazards or to call attention to information that clarifies or simplifies a procedure.



The addition of this symbol to a "Danger" or "Warning" safety label indicates that an electrical hazard exists which will result in personal injury if the instructions are not followed.



This is the safety alert symbol. It is used to alert you to potential personal injury hazards. Obey all safety messages that follow this symbol to avoid possible injury or death.

⚠ DANGER

DANGER indicates a hazardous situation which, if not avoided, **will result** in death or serious injury.

⚠ WARNING

WARNING indicates a hazardous situation which, if not avoided, **could result** in death or serious injury.

⚠ CAUTION

CAUTION indicates a hazardous situation which, if not avoided, **could result** in minor or moderate injury.

NOTICE

NOTICE is used to address practices not related to physical injury.

PLEASE NOTE

- All applicable local, regional and national regulations must be complied with during the installation, use, maintenance and replacement of this device.
- Schneider Electric cannot be held responsible in the event of non-compliance with the instructions in this document and in the documents to which it refers.
- The service instruction must be observed throughout the life time of this device.
- For a charging station with an earlier software version, perform a FW upgrade to the latest version after installation.

⚠ ⚠ DANGER

HAZARD OF ELECTRIC SHOCK, EXPLOSION OR ARC FLASH

- It is mandatory to read the detailed instruction sheet of this device and to look at the device to become familiar with it before attempting to install it, operate it, repair it or perform maintenance on it.
- Wear suitable personal protective equipment (PPE) and follow all safety procedures.
- Turn off all power supplying this device before working on the charging station.
- Always use a properly rated voltage sensing device to confirm power is off.

Failure to follow these instructions will result in death or serious injury.

⚠ ⚠ WARNING

RISK OF ELECTRIC SHOCK, SERIOUS INJURY OR DAMAGING THE CHARGING STATION

- The installation, maintenance and eventual replacement of this device must only be carried out by a qualified electrician.
- Do not install the product under bad weather condition without adequate protections.

Failure to follow these instructions could result in death, serious injury, or equipment damage.

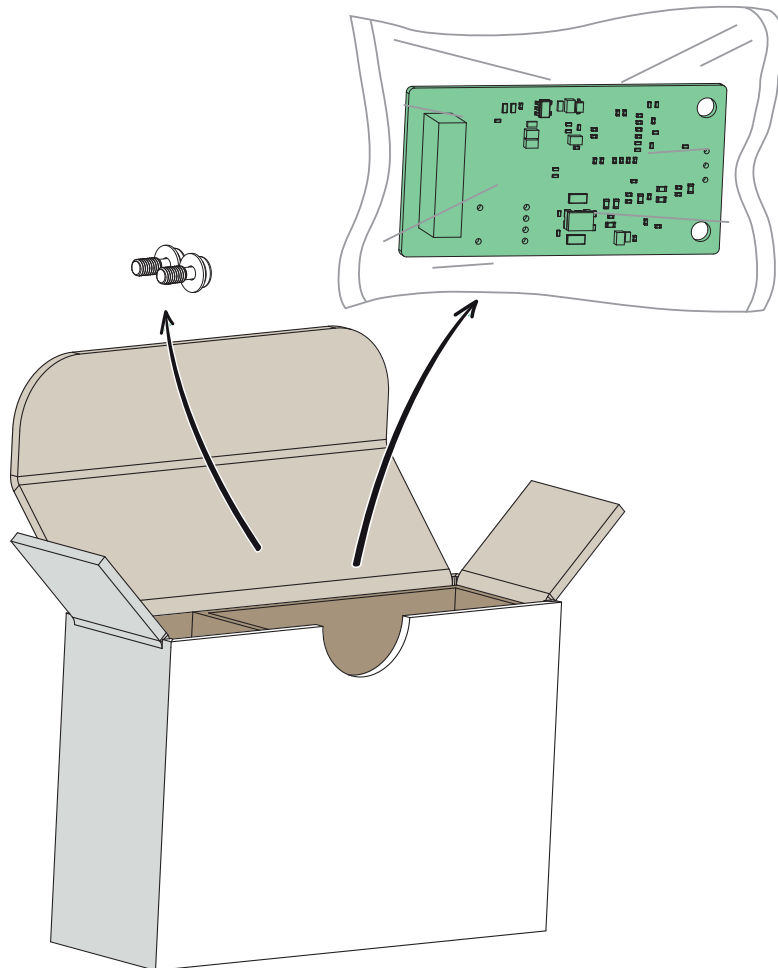
**⚠ CAUTION****HAZARD OF ELECTROSTATIC DISCHARGE OR POWER SURGE**

- Do not touch the sharp pin of the electronic board.
 - Use anti-static protection when making connection operations inside the charging station.
- Failure to follow these instructions could result in injury, or equipment damage.

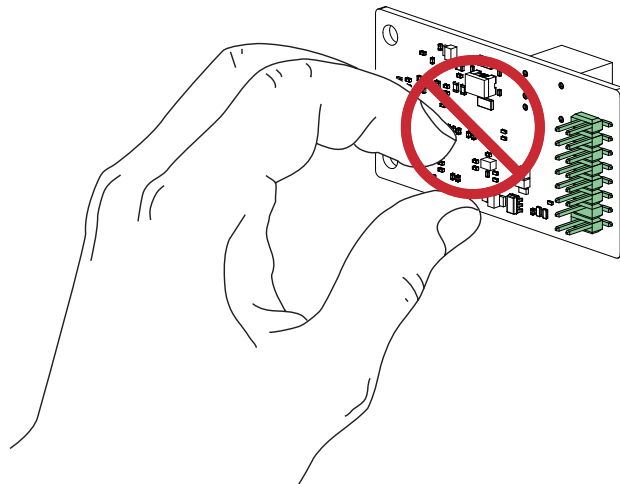

2

Module Installation

2.1 Tools Supplied by User

i

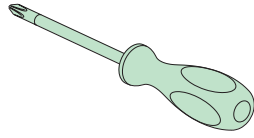

+ PH2

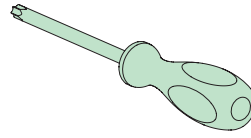

+ T20 security

2.2 Module Assembly

⚠ ⚠ DANGER

HAZARD OF MODEM DAMAGE OR ELECTRIC SHOCK, EXPLOSION OR ARC FLASH

- Take all necessary precautions when handling and installing the modem in the connector on the motherboard.
- Turn off all power supplying this device before working on the charging station.

Failure to follow these instructions will result in death, serious injury, or equipment damage.

1

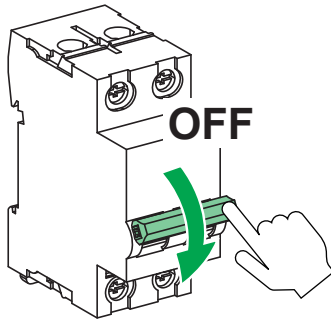

2

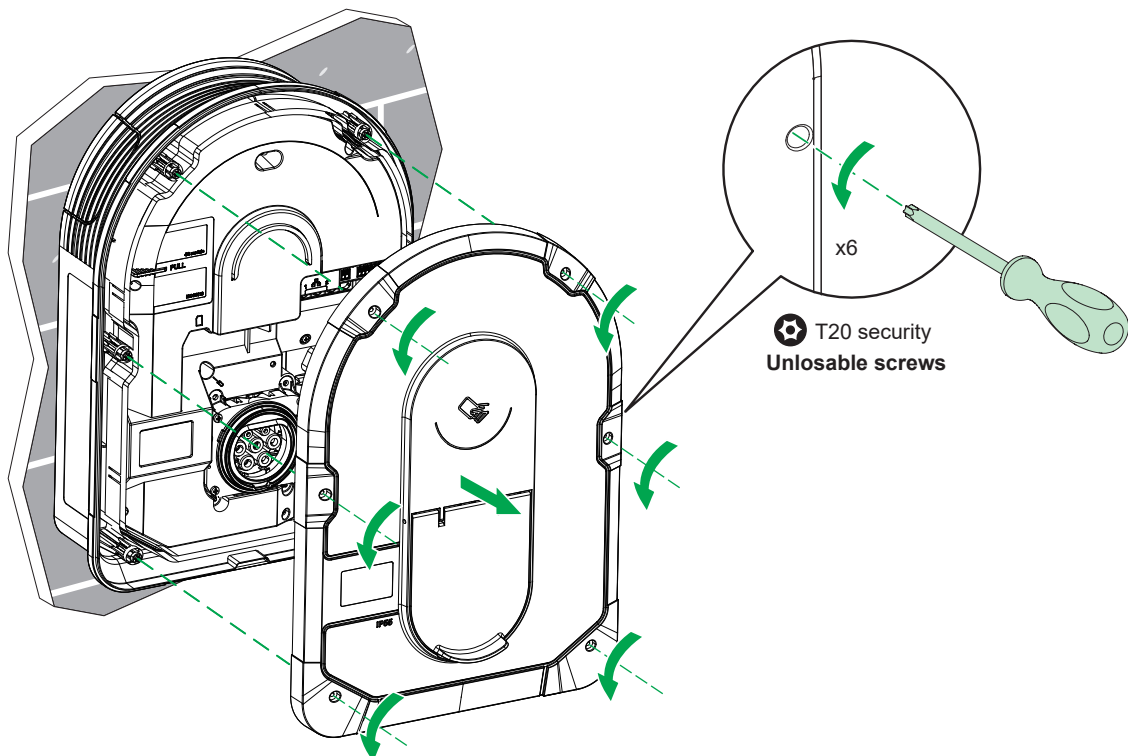

2.2 Module Assembly

3

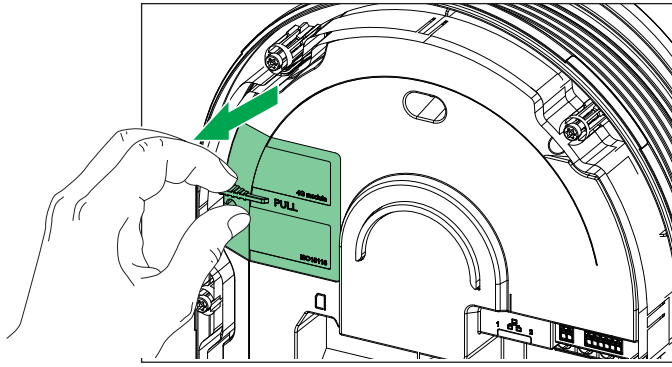

4

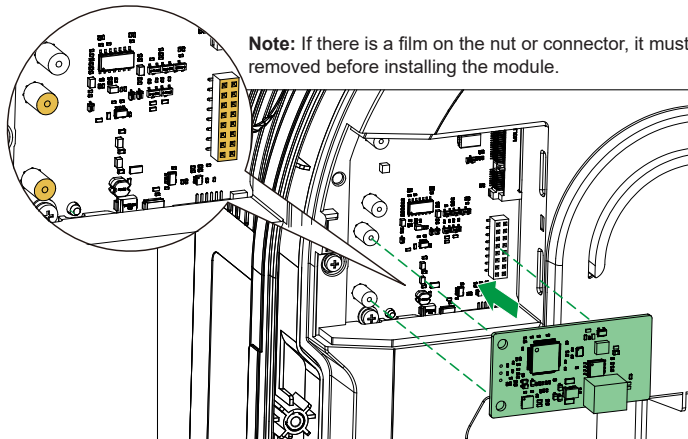

5

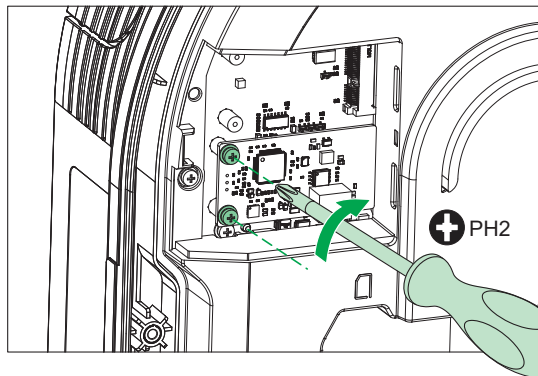

6

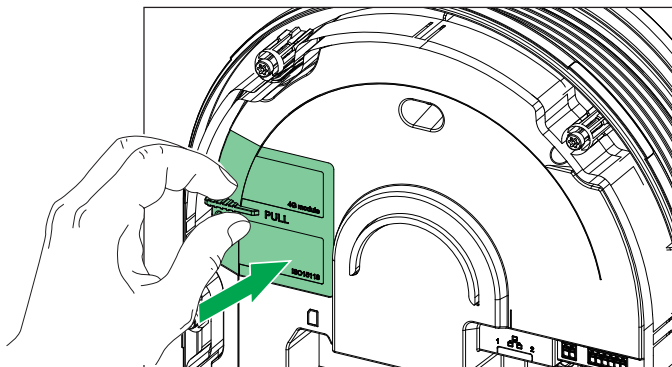

2.2 Module Assembly

7

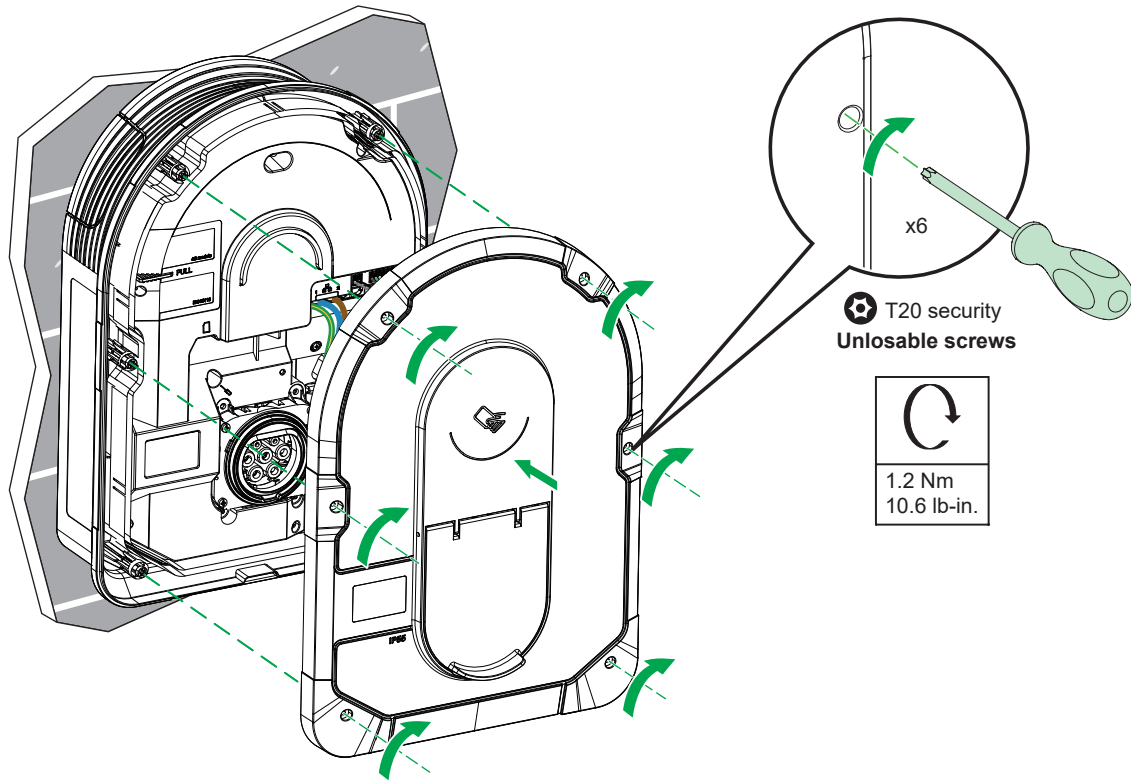

3 Inspection and Power On

3.1 Power On

⚠ ⚠ DANGER

HAZARD OF ELECTRIC SHOCK, EXPLOSION OR ARC FLASH.

Beware of potential hazards, and carefully inspect the work area for tools and objects that may have been left inside the device.
Failure to follow these instructions will result in death or serious injury.

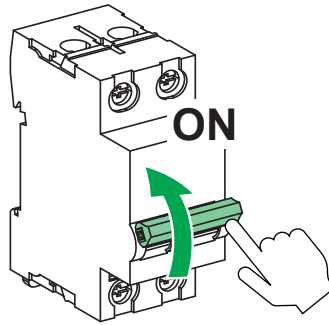

3.2 Firmware Upgrade after Module Assembly

For a charging station with an earlier software version, perform a firmware upgrade to the latest version before installation. Refer to doc BRU9949500-Schneider Charge Pro Commissioning Guide.

3.3 Inspection by eSetup

- After connecting to the charging station via eSetup, proceed to commissioning and press the button shown in the picture 3-1.
- If it displays “yes” for Module ISO 15118 in picture 3-2, that means the installation is complete and the function is correct. If it displays “no”, please verify the installation steps and software upgrade. If the issue persists, please contact Schneider Electric CCC.

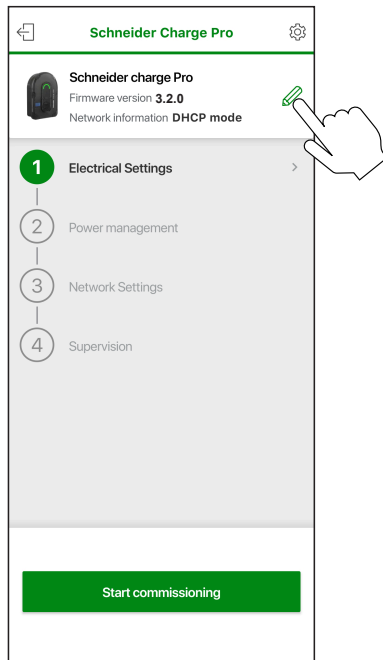

3-1

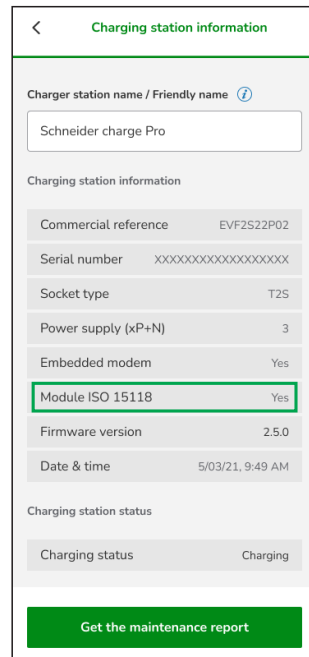

3-2

4 Recycling Packaging

- The packaging materials from this accessory can be recycled.
- Please help protect the environment by recycling them in appropriate containers.
- Thank you for playing your part in protecting the environment.