



Clipsal WilcoROWCO WMB Series Appliance Inlets WMB332R and WMB532R



WMB332R



WMB532R

Installation Instructions

Earthing

Ensure continuity of the earth is maintained throughout the installation.
All metal parts must be earthed according to AS/NZS3000 wiring regulations.

IP Rating

Torque levels for fixing of cover screws should be set between 0.8Nm - 1.2Nm
To ensure the IP66 Rating is maintained, all conduit entry points and mounting holes
must be sealed.

Suitable silicone sealants include:

- Dow Corning 732, 739 and 1080
- Ramset RC804 and RBC833
- Selleys Roof and Gutter Sealant

Notice: do not use incorrect silicone sealant. Internal plastic may fail.

Terminal Screws

Notice: check terminal screws for tightness before completing install, they may have loosened during transit. Failure to check may result in equipment damage.

Compatibility of Units

New Cat No.	Rating	Number of Pins	Cond. Term. Size in mm	Compatible Plug Socket
WMB332R	250V 32A	3	Min. 6, Max. 16	56CSC332
WMB532R	500V 32A	5		56CSC532

Assembly Instructions

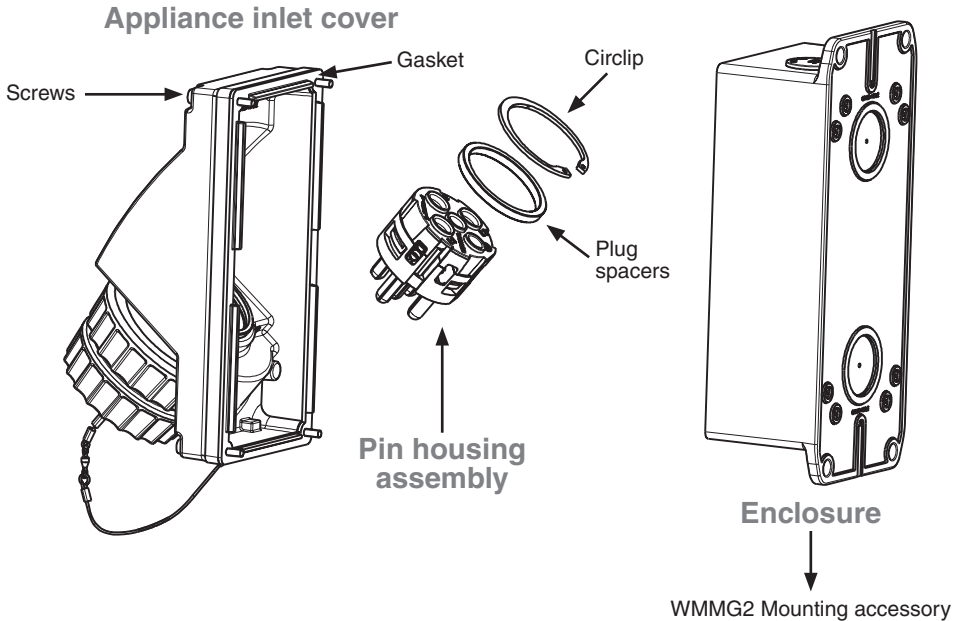

Wiring Instructions

1. Strip Flexible cables as shown.
2. Remove pin housing assembly from parts pack.
3. Place cable through plug spacer and connect conductors into pin housing assembly terminals and tighten screws on bared end of conductor to ensure good electrical contact.
4. Check earth wire is connected to E ⊕ terminal.
5. Reseat pin housing assembly in appliance inlet cover and secure in place with plug spacer and circlip.
6. Place assembled unit on mounting accessory and tighten mounting screws firmly, ensuring gasket is evenly seated.

Stripping Detail (All Conductors)

Actual Size



Schneider Electric (Australia) Pty Ltd

Contact us: clipsal.com/feedback

National Customer Care Enquiries:

Tel 1300 2025 25

Fax 1300 2025 56

clipsal.com

Schneider Electric (Australia) Pty Ltd reserves the right to change specifications, modify designs and discontinue items without incurring obligation and whilst every effort is made to ensure that descriptions, specifications and other information in this catalogue are correct, no warranty is given in respect thereof and the company shall not be liable for any error therein.

© 2014 Schneider Electric. All Rights Reserved.
Trademarks are owned by Schneider Electric Industries SAS or its affiliated companies.