

CLIPSAL[®]

by **Schneider** Electric

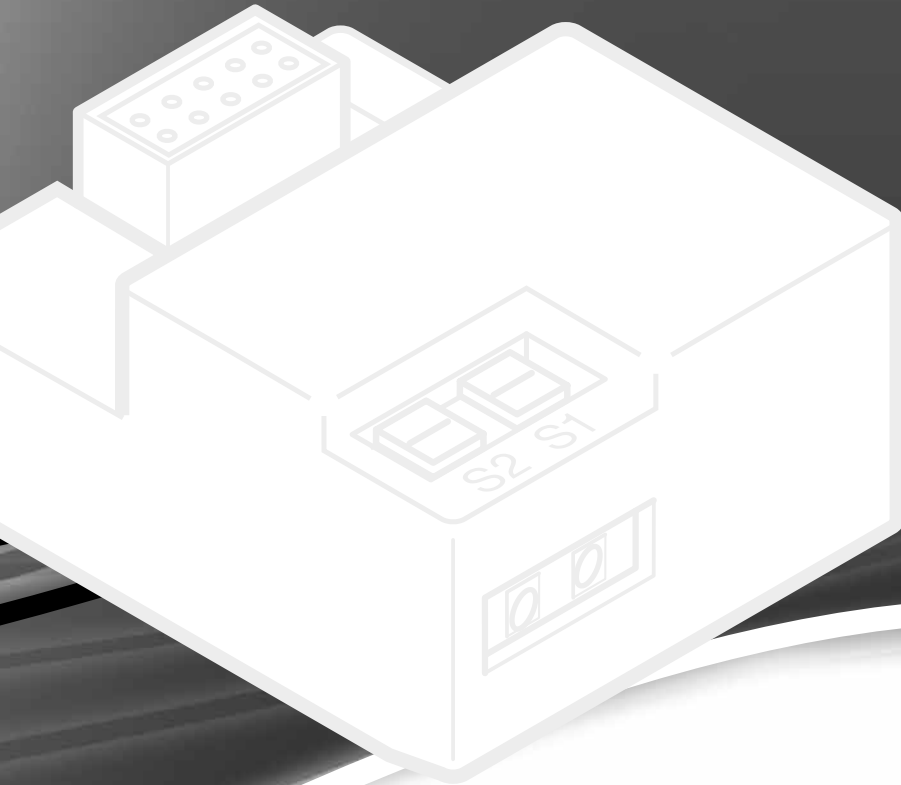

**Floating Relay Module
for 757SRR Infrascan[®]**

757FRM



Installation Instructions

Wiring Diagram

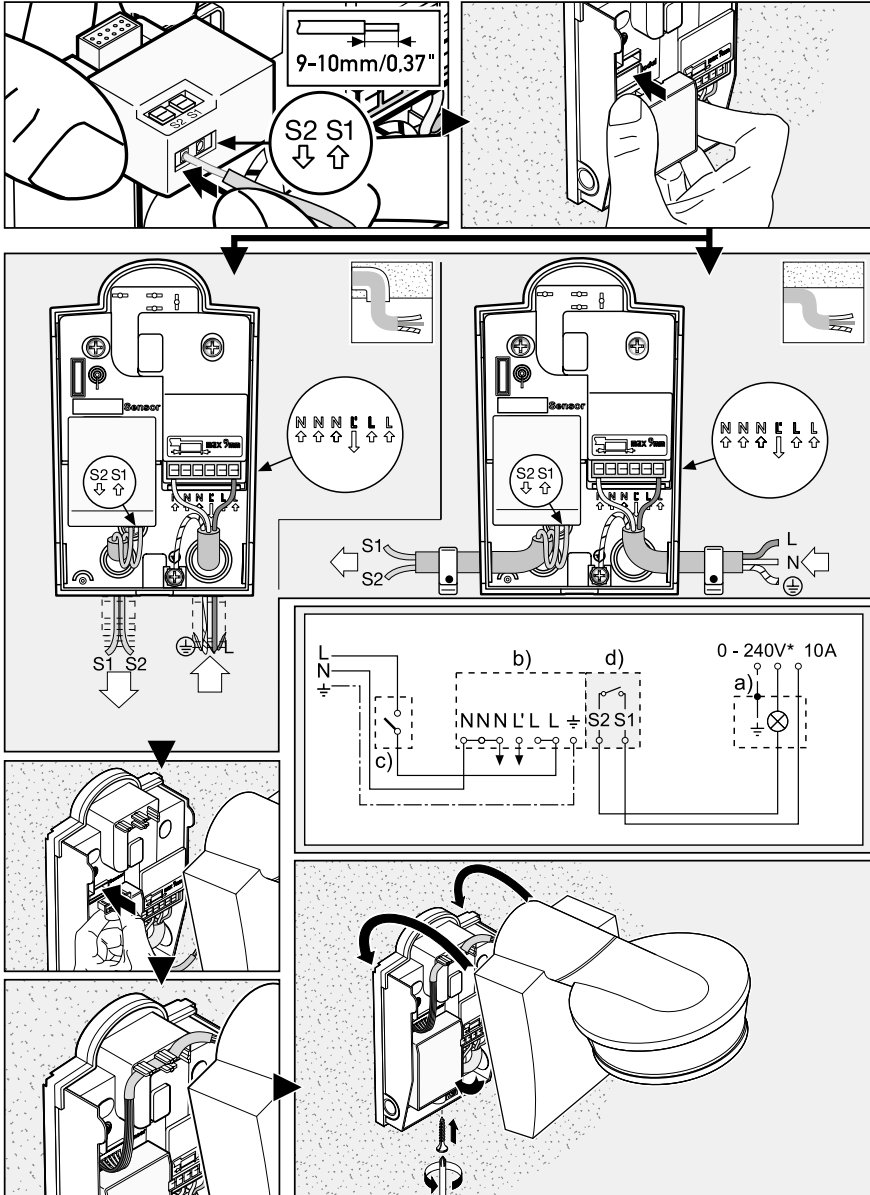

- a) Load, see Technical Specifications
- b) Sensor connection terminals
- c) Switch
- d) Floating Relay Module 757FRM

*Supply voltage must be connected according to AS3000 wiring rules.







757FRM Principle

This Floating Relay Module provides a voltage-free switched output for the 757SRR Infracan, intended for operating independent devices or systems. The module does not affect the built-in switching output on the 757SRR. The IR remote control supplied with the 757SRR operates the floating output in exactly the same way as the built-in switching output on the 757SRR.

Safety Precautions

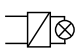
- The 757FRM is suitable for use **ONLY** in conjunction with the Clipsal 757SRR.
- The system must be installed by a qualified electrician in compliance with the standards that apply at the place of installation.
- Please only insert the module with the supply voltage switched off.
- All cabling used must be suitable for mains voltage.

Technical Specifications

Parameter	Value		
Nominal Operating Voltage	0 - 240 V~		
Wiring Configuration	Plug in module		
Terminals Accommodate	1 x 2.5mm ² (max)		
Compatible Loads*		Incandescent Lighting Halogen 240V Lamps	2400W
*Also suitable for use with Safety Extra Low Voltage SELV loads		Fluorescent Lamps** (10AX @ cosφ 0.85) - Conventional Ballast (uncompensated, cosφ < 0.5) - Conventional Ballast (compensated, 45.6μF max) - Electronic Ballast (176μF max, 8 x 58W Ballasts)	1000W
		Low voltage lighting with electronic transformers (176μF maximum capacitive loading) (8 x LED Drivers maximum loading)	1000W
		Low voltage lighting with iron-core transformers	2000VA
		Compact Fluorescent Lamps (8 x CFL lamps maximum loading)	20W x 8 max.
		Small Motor Loads	N/A
Incompatible Loads			
Operating Temperature Range	-20 to 50°C		
Operating Humidity Range	10 to 90% R.H.		
Safety Compliances	AS/NZS3100, IEC60669-2-1		
EMC Emission Compliance	AS/NZS CISPR15, IEC61000-3-2		
Specifications Typical @ 240V~ 25°C			
No User Serviceable Parts Inside			

**Derate for use with fluorescent loads (cosφ < 0.5, 1000W max).

Functional Warranty

1. The benefits conferred herein are in addition to, and in no way shall be deemed to derogate; either expressly or by implication, any or all other rights and remedies in respect to the Clipsal by Schneider Electric product, which the consumer has under the Commonwealth Trade Practices Act or any other similar State or Territory Laws.
2. The warrantor is Schneider Electric (Australia) Pty Ltd With registered offices in all Australian States.
3. This Clipsal by Schneider Electric product is guaranteed against faulty workmanship and materials for a period of three (3) years from the date of installation.
4. Schneider Electric (Australia) Pty Ltd reserves the right, at its discretion, to either repair free of parts and labour charges, replace or offer refund in respect to any article found to be faulty due to materials, parts or workmanship.
5. This warranty is expressly subject to the Clipsal by Schneider Electric product being installed, wired, tested, operated and used in accordance with the manufacturer's instructions.
6. All costs of a claim shall be met by Schneider Electric (Australia) Pty Ltd., however should the product that is the subject of the claim be found to be in good working order all such costs shall be met by the claimant.
7. When making a claim the consumer shall forward the Clipsal by Schneider Electric product to the nearest office of Schneider Electric (Australia) Pty Ltd with adequate particulars of the defect within 28 days of the fault occurring. The product should be returned securely packed, complete with details of the date and place of purchase, description of load, and circumstances of malfunction.

Schneider Electric (Australia) Pty Ltd

Contact us: clipsal.com/feedback

National Customer Care Enquiries:

Tel 1300 2025 25

Fax 1300 2025 56

clipsal.com

Schneider Electric (Australia) Pty Ltd reserves the right to change specifications, modify designs and discontinue items without incurring obligation and whilst every effort is made to ensure that descriptions, specifications and other information in this catalogue are correct, no warranty is given in respect thereof and the company shall not be liable for any error therein.

© 2012 Schneider Electric. All Rights Reserved.
Trademarks are owned by Schneider Electric Industries SAS or its affiliated companies.