

CLIPSAL[®]

by **Schneider** Electric

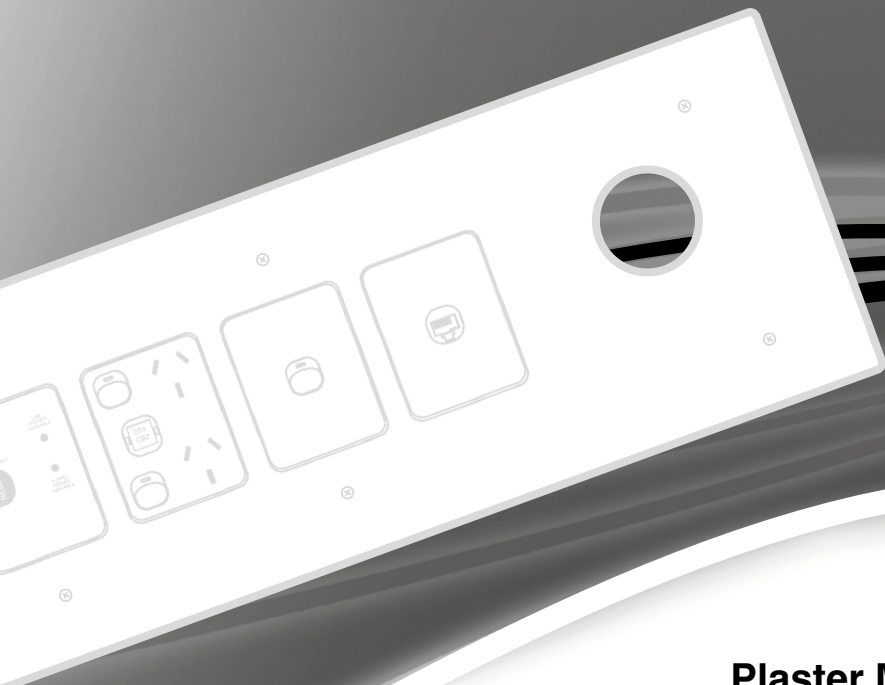

**Medilec
Plaster Mounted
Recessed Solution**

ML2165

Series

Installation Instructions

Product Range

ML2165 Plaster Mounted Recess solution

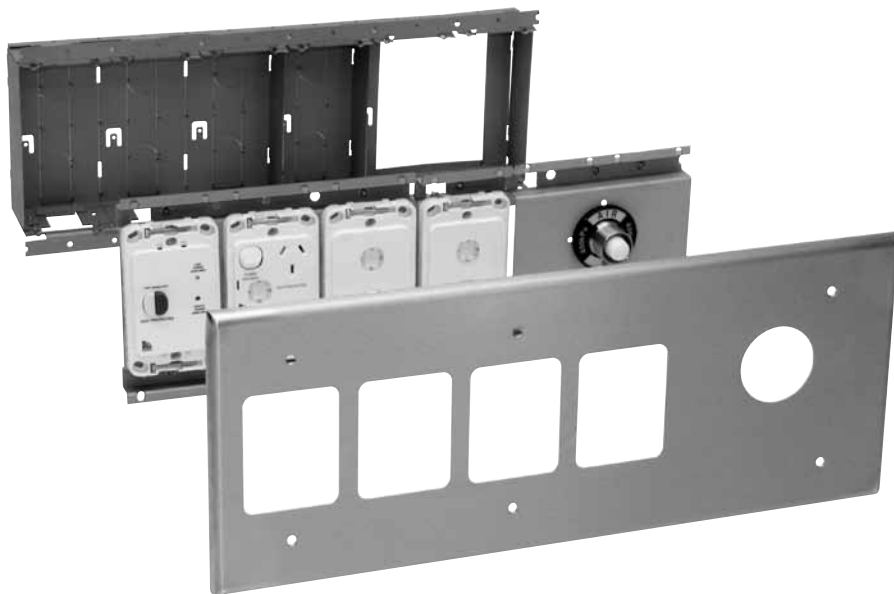

Description

The Clipsal Medilec ML2165 Series is a modular, plaster mount, metal plate range of medical service panels, which have been specifically designed for patient treatment areas of hospitals, and medical and dental practices. The system consists of a recessed plaster mounted wall box, grid, 2000 Series accessories and a fascia powder-coated or stainless steel plate.

Wall Box Installation

The metal wall box is mounted within the wall cavity, through a cut-out in the plaster board to the equal size of the wall box. The wall must be framed to allow panel size. The box is then fixed to the plaster via mounting brackets that are attached to the back of the wall box. They are lifted up and pushed back to the underside of the plaster wall. Screws are then put through the front of the wall box and through to the bracket behind to achieve plaster fixing.

If required, it is recommended that the Clipsal Medilec segregation barriers be installed prior to the wall box installation.

Grid Installation

The metal grid plate is mounted to the wall box via four screws, which are fixed to each corner of the grid. There are no adjustments required with this product.

There are different grids required for 2000 Series accessories and gas outlets. The gas grid plates allow for installation of both ESCO and BOC outlets with or without a scavenge.

2000 Accessories Installation

Each 2000 Series accessory is installed onto the grid with two screws.

When fixing a 2000 Series accessory to the grid, back the screws off slightly to allow the 2000 Series accessory to move from side to side.

It is recommended that for easier installation, the 2000 Series accessories are mounted to the grid prior to the grid being mounted to the wall box.

Fascia Installation

The fascia is fixed to the grid with two or four countersunk screws.

A slight adjustment of the positioning of the accessories may be necessary to align them up with the cut-outs within the fascia.

Customising

On top of our standard range of one to four gang components, the ML2165 can be customised to extend in length to suit the customer's requirements.

Segregation can also be added within the wall box to allow different services to be mounted within the one wall box.

Customised medical service panels will be supplied fully assembled from Medilec.

Segregation Installation

The segregation is made of one metal plate. The segregation plate is riveted into the wall box at each end. Pre-punched 3.3mm holes are in the segregation plates and wall boxes, making it easy to locate and rivet the segregation and wall box together. If wall box is already mounted into plaster wall, there are raised guiding fins on the bottom of the segregation that line up with slots in the back of the wall box. Once put into place, the grid plate either side of the segregation then provides a fixing by sandwiching the segregation plate.

Wall Box

There are break lines at each module on the wall box that allow the wall box to be broken down into a custom length. All fixing points for grid plates are completely modular along the whole length of the wall box, allowing any combination of services to be mounted on wall box (maximum length 2.4m).

Mounting Bracket

There are break lines at each module on the mounting bracket, which allow the mounting bracket to be broken down into a custom length. All fixing points for the mounting bracket are completely modular along the whole length of the bracket, allowing the mounting bracket to match the fixing points and length of the custom wall box (maximum length 2.4m).

Fascia Mounting Installation

All fascias are custom-made in one length to match the services layout required. Fixing points are provided along the fascia matching those on the grid plates behind. The fascia mounts over the top of all services.

Warranty

The benefits conferred herein are in addition to, and in no way shall be deemed to derogate, either expressly or by implication, any or all other rights and remedies in respect to the Schneider Electric product, which the consumer has in the location where the product is sold.

The warrantor is Schneider Electric with offices worldwide. This Schneider Electric product is guaranteed against faulty workmanship and materials for a period of two (2) years from the date of installation.

Schneider Electric reserves the right, at its discretion, to either repair free of parts and labour charges, replace or offer refund in respect to any article found to be faulty due to materials, parts or workmanship.

This warranty is expressly subject to the Schneider Electric product being installed, wired, tested, operated and used in accordance with the manufacturer's instructions. Any alterations or modifications made to the product without permission of Schneider Electric might void the warranty.

Schneider Electric shall meet all costs of a claim. However, should the product that is the subject of the claim be found to be in good working order, all such costs shall be met by the claimant.

When making a claim, the consumer shall forward the Schneider Electric product to the nearest Schneider Electric office and provide adequate particulars of the defect within 28 days of the fault occurring. The product should be returned securely packed, complete with details of the date and place of purchase, description of load, and circumstances of malfunction.

Schneider Electric (Australia) Pty Ltd

Contact us: clipsal.com/feedback

National Customer Care Enquiries:

Tel 1300 2025 25

Fax 1300 2025 56

clipsal.com

Schneider Electric (Australia) Pty Ltd reserves the right to change specifications, modify designs and discontinue items without incurring obligation and whilst every effort is made to ensure that descriptions, specifications and other information in this catalogue are correct, no warranty is given in respect thereof and the company shall not be liable for any error therein.

© 2012 Schneider Electric. All Rights Reserved.
Trademarks are owned by Schneider Electric Industries SAS or its affiliated companies.