

# Ceiling Sweep Fan ACES52R5L

## Installation Instructions

Thank you for purchasing this Airflow Ceiling Sweep Fan. You can be assured years of trouble free operation by having your ceiling fan installed carefully and according to these instructions.

### Included with your Fan

- A. Motor Assembly
- B. 5 x Wooden Blades - Silver/Black Colours
- C. R.F. Remote Controller
- D. Screw Pack
- E. Hangsure Mounting Bracket
- F. Instruction Sheet.

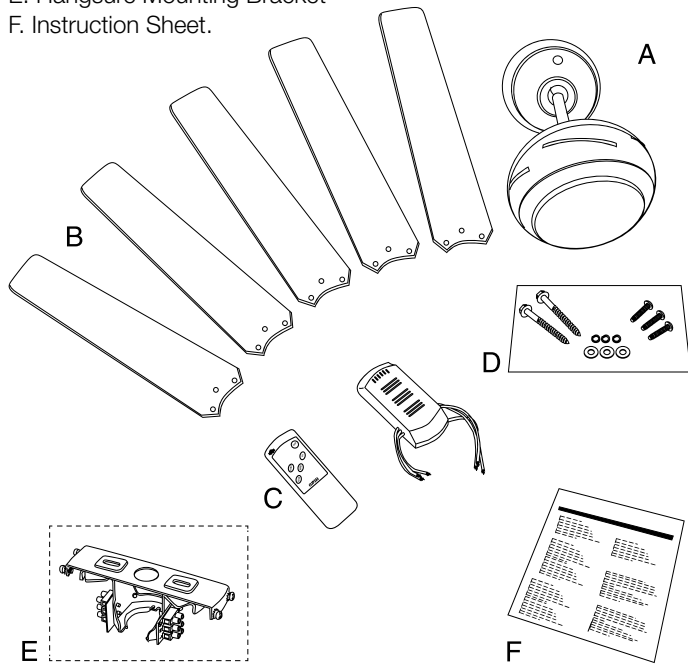

#### IMPORTANT NOTE:

- The blades are a matched set to ensure proper balance.
- Do not mix-up the blades with those from another fan.

**All electrical work must be carried out by a qualified electrician.**

### Clearances and Angled Ceilings

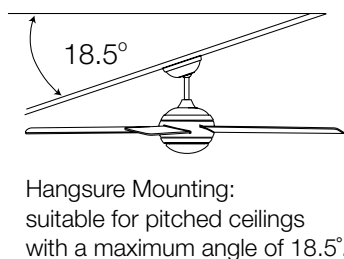
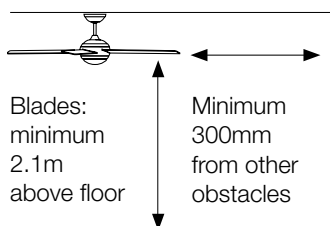

### Controlling a Single Fan

This fan has been supplied with a remote controller that is designed to operate a single or multiple fans.

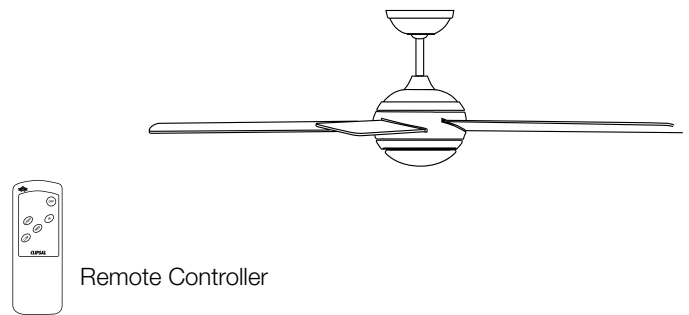

### Mounting the Fan Support Bracket

Select a suitable location to mount the fan support bracket.

The mounting bracket must be fixed to a solid structural member, such as a ceiling joist or a securely fixed noggin, and be capable of supporting 15kgs.

Additionally, it must be located to provide the blade with a minimum clearance of 2.1m from the floor and at least 300mm from other obstructions.

#### Hangsure Mounting

Secure fixing to support 15kg

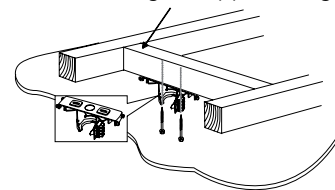

#### Hangsure Bracket

Locate and mark the centre of the joist. Secure the bracket to the ceiling joist by using the flat washers and spring washers.

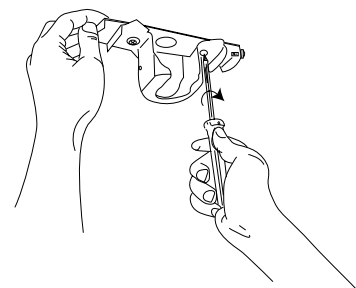

## 2. Hanging the Fan

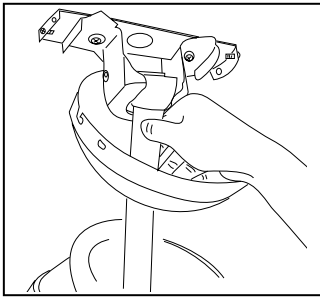

1. Lift the fan up and place the nylon ball onto the bracket. Make sure the guide pin of the bracket is fitted into slot of ball joint.

## Installing the Fan

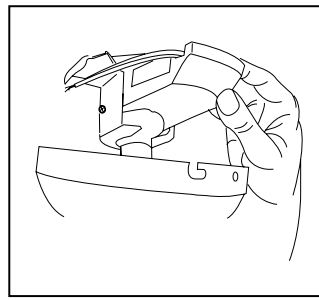

1. Install the receiver to the bracket as shown. Connect the wires according to the remote control wiring instructions (page 3).

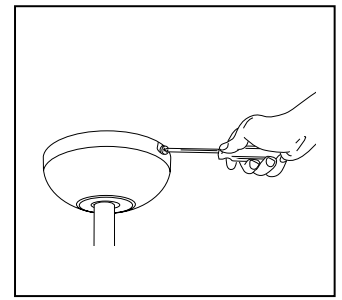

2. Manoeuvre the canopy into place over the mounting bracket.

## Remote Control Setup

The remote control is a 16 Channel Radio Frequency (RF) type. To ensure correct operation of the fan please follow this setup.

- Both the remote control and the receiver have a DIP switch. The remote control DIP switch is located in the battery compartment and the receiver's DIP switch is located on the side (both as shown in diagrams).

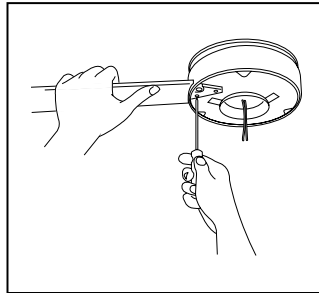
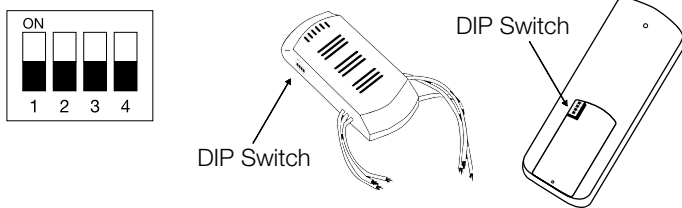

4. Insert fan blade into the blade holder. Ensure fan blade holes align with blade bracket holes. Mount blade brackets and fan blades together by three set screws.

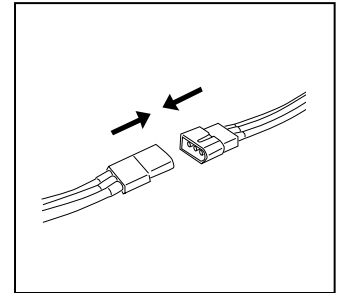

5. Insert the male connector securely into the female connector for light kit installation.

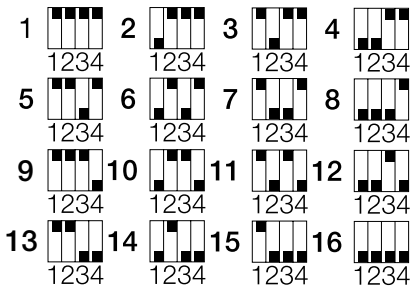

- These switches **must** be set to the same values on both the remote control and the receiver for the fan/s to operate correctly.
- Multiple channels are available, so you are able to control multiple fans individually or control a number of fans as one.

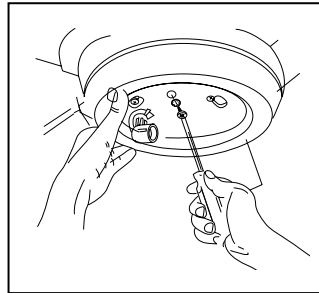

6. Loosen the three large screws. Pass the three screws through the keyway holes and tighten. Make sure no wires are trapped. Rotate the light kit clockwise to lock into place and tighten the three screws.

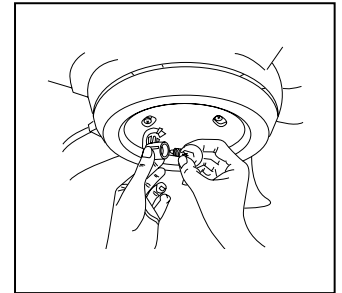

7. Install the light bulb (E27, Max. 60W) into the lampholder. Switch the power on to check the operation of the light kit and fan.

**All electrical work must be carried out by a qualified electrician.**

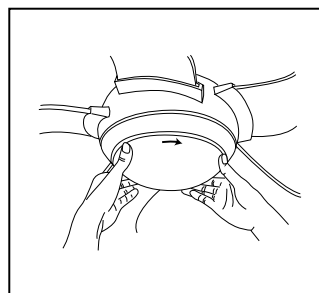

8. Using one hand to support the glass shade, place it into the gallery. Carefully rotate the glass shade clockwise. Check for signal light on the transmitter. Switch the power on and check the operation of ceiling fan.

## 5. Wiring Instructions

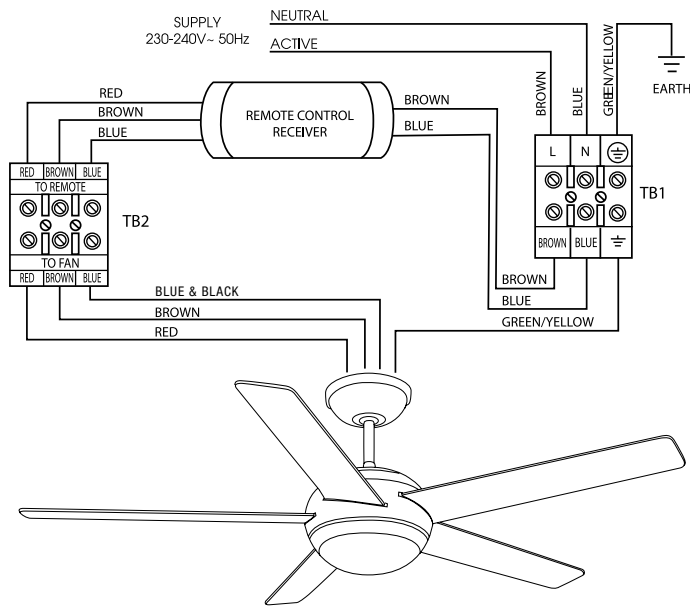

Means for all pole disconnection must be incorporated in the fixed wiring, in accordance with the wiring rules.

## Check Forward/Reversible Switch

The forward/reversible switch is located on the bottom cowl.

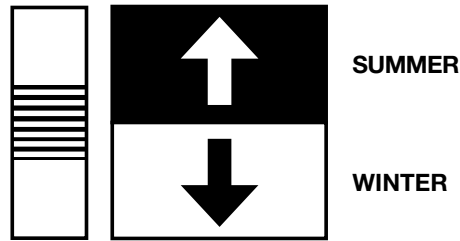

Check switch and make sure it is in correct setting, depending on cold weather or hot weather.

**Cold weather:** Push switch DOWN for the blades to move the warm air trapped near the ceiling.

**Hot weather:** Push switch UP for the blades to create a breeze and circulate the air.

**Note:** The forward/reversible switch must be fully engaged for the fan to operate.

## Cleaning Instructions

To clean the fan, wipe over with a damp, soapy cloth. Do not use scourers or abrasive cleaners.

## 6. Operating Instructions

- Use the remote control to change the speed of the fan and to switch the light and fan off.
- Replace the batteries by sliding the battery compartment panel on the remote in the direction of the arrow. Fit 1 x 9V battery. Slide on the battery compartment cover.

**Note:** Batteries NOT included.

- ALWAYS ensure that the battery compartment panel is secure.
- NEVER leave the remote control in direct sunlight.
- NEVER attempt to recharge primary batteries, either in a charger or by applying heat to them. There are special rechargeable batteries, which are clearly marked as such.
- NEVER dispose of batteries in fire because this can cause them to explode.
- The light on/off can be controlled by pressing 'LIGHT' button on the remote control transmitter.
- The speed can be selected by pressing the 'SPEED' button on the remote control transmitter:

**HI** - High Speed  
**MED** - Medium Speed  
**LOW** - Low Speed  
**OFF** - Off

## Troubleshooting Guide

### Fan will not switch on:

- Switch off the fan.
- Forward/reverse switch on fan motor not fully engaged in desired setting.
- Connections not as per installation diagram.
- Fuse blown, circuit breaker tripped or there is a power failure.
- Check DIP switches in remote control and receiver to ensure they are set the same.

### Fan will not operate at varying speed control settings:

- Controller connections not as per wiring instruction.

### Ticking, rattling, mechanical noises:

- Ensure all screws and bolts are tight.
- Ensure the mounting assembly is secure.
- Ensure the wires are not tapping against the canopy.

### WARNING

- Do not attempt to stop the blades by hand, even at low speed.
- This appliance is not intended for use by persons (including children) with reduced physical, sensory or mental capabilities, or lack of experience and knowledge, unless they have been given supervision or instruction concerning use of the appliance by a person responsible for their safety. Children should be supervised to ensure that they do not play with the appliance.
- Ensure all supplies are disconnected before cleaning, maintenance and attachment of lamp kit.

## Warranty

The benefits conferred by this warranty are in addition to all implied warranties, other rights and remedies in respect of the product which the consumer has under the Competition and Consumer Act and similar State and Territory Laws.

The original purchaser of this Clipsal ceiling fan is provided with this warranty subject to the following conditions, which warrants this product for a period of three years from the date of purchase for all parts defective in workmanship or materials. All products used in commercial applications are limited to a 90 day warranty.

All defective parts will be replaced free of charge. The following exclusions do not preclude the purchaser from those statutory rights consumers have under the Competition and Consumer Act or similar State and Territory Laws.

### WARRANTY CONDITIONS

1. This warranty is only valid for appliances installed according to the manufacturer's instructions and for indoor use only.
2. This appliance must not be modified or changed in any way and all electrical connections must be carried out by a qualified electrician only.
3. Connection must be to the voltage requirements as specified in the ratings label located on the product.
4. The manufacturer does not accept liability for any direct or consequential damage, loss or other expense arising from misuse or incorrect installation and operation of the appliance.
5. Warranty will only be given where proof of purchase is provided, e.g. original invoice.
6. For warranty to be valid, only Clipsal accessories, such as down rods and light kits, shall be installed with the Clipsal Airflow Ceiling Sweep Fan.

**For further technical support, contact the Clipsal by Schneider Electric National Customer Care Centre on 1300 2025 25.**

### IMPORTANT

Record this warranty information at the time of purchase, but do not send this information unless you are making a claim or are asked to do so. To obtain service under warranty you must retain your original purchase receipt. Service will otherwise be charged at current rates.

Model no.: .....

Purchased from: .....

Name: .....

Address: .....

..... Postcode: .....

Date of purchase: .....

**Schneider Electric (Australia) Pty Ltd**

Contact us: [clipsal.com/feedback](http://clipsal.com/feedback)

**National Customer Care Enquiries:**

**Tel 1300 2025 25 Fax 1300 2025 56**

**clipsal.com**

Schneider Electric (Australia) Pty Ltd reserves the right to change specifications, modify designs and discontinue items without incurring obligation and whilst every effort is made to ensure that descriptions, specifications and other information in this catalogue are correct, no warranty is given in respect thereof and the company shall not be liable for any error therein.

© 2011 Schneider Electric. All Rights Reserved.

Trademarks are owned by Schneider Electric Industries SAS or its affiliated companies.