

PDL "S" RANGE ENCLOSED MAINS SWITCHES

Instructions for use of 20A, 32A, 40A and 63A
Enclosed Mains Switches.

WIRING OPTIONS

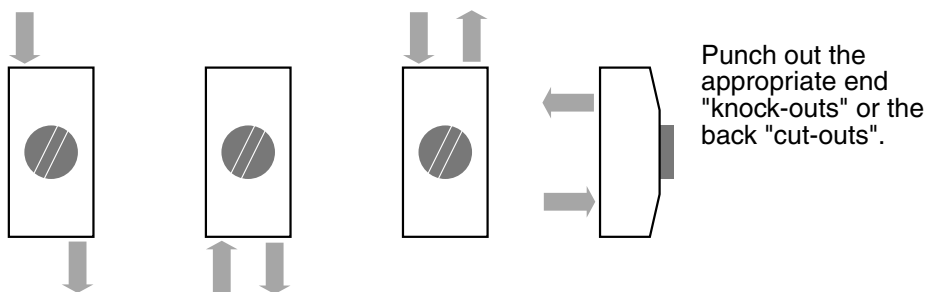

"LOCK-ON" FEATURE

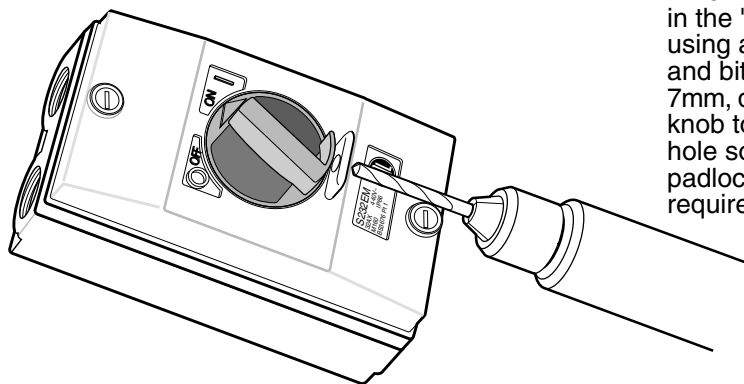

When the switch knob is in the "ON" position, using a slow speed drill and bit no larger than 7mm, drill a hole through knob to align with cover hole so a suitable padlock can be fitted as required.

SEALING FOR ADDED WEATHER PROTECTION

Conduit entry points may require sealing to prevent condensation.

We recommend:

Dow Corning 732
Dow Corning 1080
Dow Corning 739 Plastic Adhesive
Selleys Window and Glass Sealant
Ramset RC 804
Ados Neutral Cure Sealant

TIE WIRE SEALING FEATURE

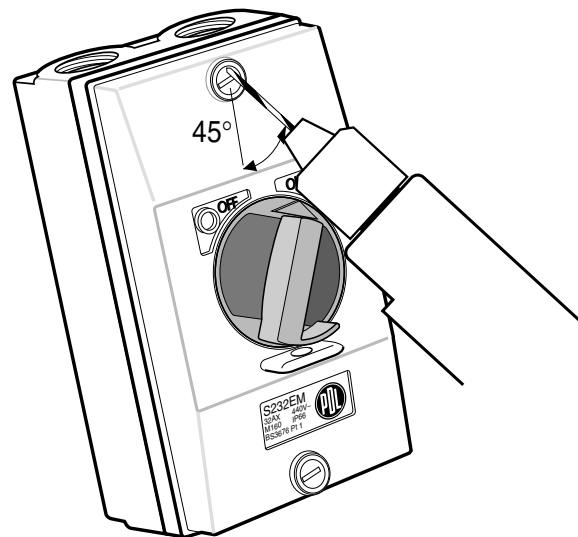

Using a 2mm (or smaller) bit, drill a hole angled at 45° through the side of the enclosure screw and the cover so a wire seal can be fitted.

SPECIFICATIONS

Pole Configuration:	Single, double, triple.
Rated current:	20A, 32A (single, double, triple, and four) 40A, 63A (triple and four)
Rated voltage:	240V a.c. 50Hz (Single) 415V a.c. 50Hz (Double, Triple, Four).
Overall dimensions:	165.0mm high x 82.0mm wide x 81.0mm deep
Conduit Entry:	2 x 25mm, 4 x 20mm back-entry cut-outs, and 2 x M25 threaded entries each end
Mounting centres:	Top centre and bottom centre 144.4mm separation.
Maximum cable size:	20A & 32A accept 16mm ² cable, 40A & 63A accept 25mm ² cable.
Type tested to:	IEC60947-3:2001 AS1939:1990 IP66



New Zealand Head Office: PO Box 15 355, Auckland, New Zealand
Telephone +64-9-829 0490, Fax +64-9-829 0491
www.schneider-electric.co.nz

Australia Head Office: Locked Bag 5500, Baulkham Hills Business Centre,
NSW 2153, Australia
Telephone +61-2-9851 2800, Fax +61-2-9629 8340
www.schneider-electric.com.au

