

681MT16

DESCRIPTION:

681MT16 Single 600 Series push button switch module, single pole two way with optional LED

RATING:

250V a.c., 50Hz
- 16A resistive, 16AX fluorescent

For detailed wiring options see reverse

681MT10PB

DESCRIPTION:

681MT10PB Single 600 Series N/O - N/C push button switch module, with optional LED

RATING:

250V a.c., 50Hz
- 10A resistive, 10AX fluorescent

24V d.c.
- 10A resistive
M50 Motor Rating

INSTALLATION PROCESS:

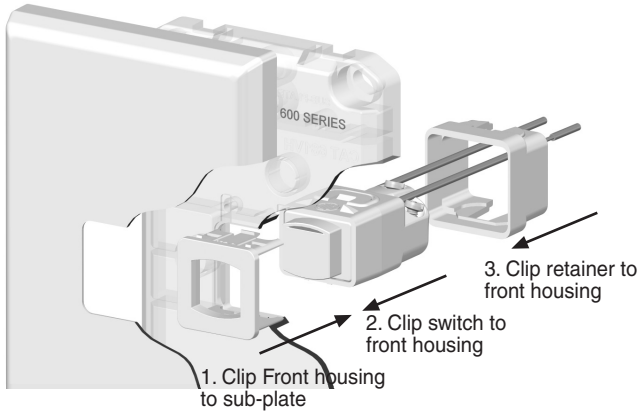

681MT16

DESCRIPTION:

681MT16 Single 600 Series push button switch module, single pole two way with optional LED

RATING:

250V a.c., 50Hz
- 16A resistive, 16AX fluorescent

For detailed wiring options see reverse

681MT10PB

DESCRIPTION:

681MT10PB Single 600 Series N/O - N/C push button switch module, with optional LED

RATING:

250V a.c., 50Hz
- 10A resistive, 10AX fluorescent

24V d.c.
- 10A resistive
M50 Motor Rating

INSTALLATION PROCESS:

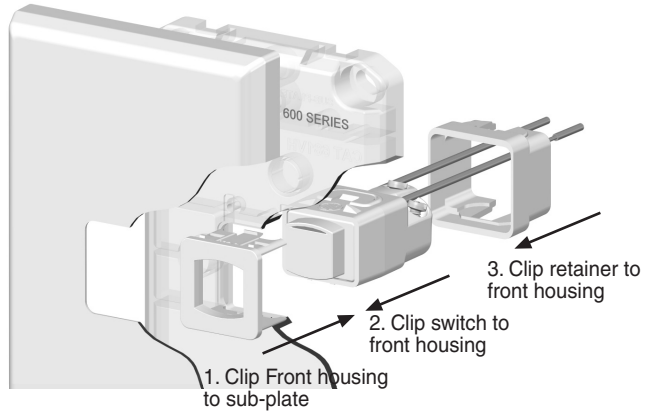

681MT16

DESCRIPTION:

681MT16 Single 600 Series push button switch module, single pole two way with optional LED

RATING:

250V a.c., 50Hz
- 16A resistive, 16AX fluorescent

For detailed wiring options see reverse

681MT10PB

DESCRIPTION:

681MT10PB Single 600 Series N/O - N/C push button switch module, with optional LED

RATING:

250V a.c., 50Hz
- 10A resistive, 10AX fluorescent

24V d.c.
- 10A resistive
M50 Motor Rating

INSTALLATION PROCESS:

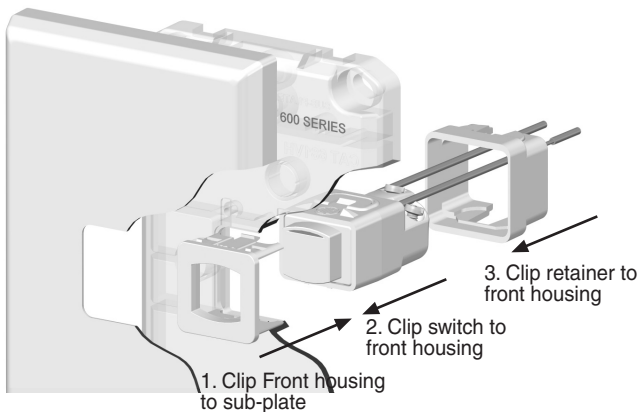

681MT16

DESCRIPTION:

681MT16 Single 600 Series push button switch module, single pole two way with optional LED

RATING:

250V a.c., 50Hz
- 16A resistive, 16AX fluorescent

For detailed wiring options see reverse

681MT10PB

DESCRIPTION:

681MT10PB Single 600 Series N/O - N/C push button switch module, with optional LED

RATING:

250V a.c., 50Hz
- 10A resistive, 10AX fluorescent

24V d.c.
- 10A resistive
M50 Motor Rating

INSTALLATION PROCESS:

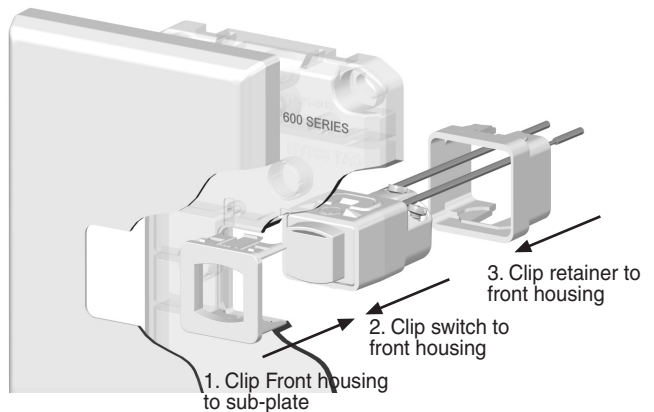

681MT16 WIRING OPTIONS:

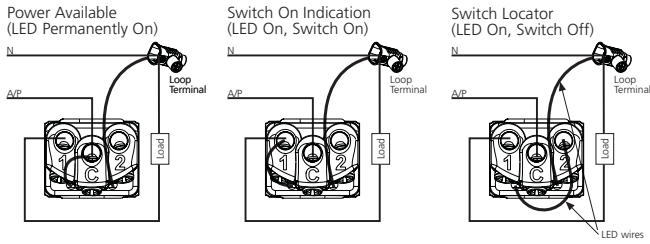

Note: LED is factory fitted and is not replaceable. LED does not have to be connected if not required.

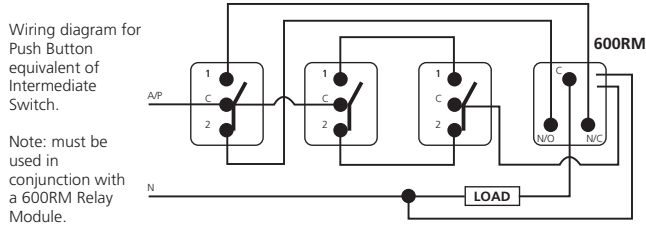

Note: must be used in conjunction with a 600RM Relay Module.

681MT16 WIRING OPTIONS:

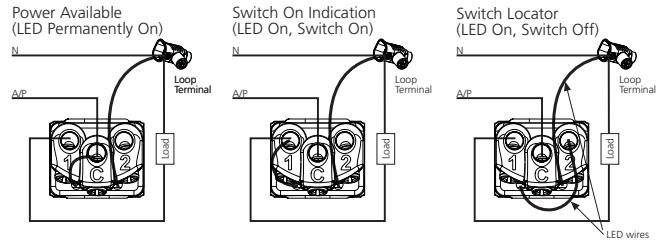

Note: LED is factory fitted and is not replaceable. LED does not have to be connected if not required.

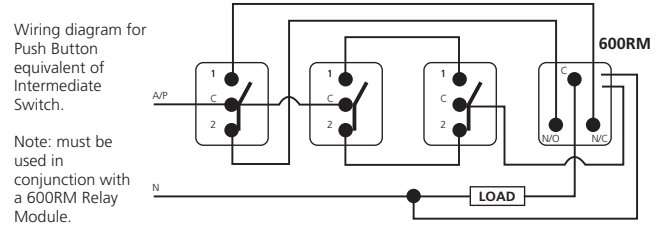

Note: must be used in conjunction with a 600RM Relay Module.

681MT10PB:

N/O: Wire as above

N/C: For this option connect the load to the '2' terminal



681MT16 & 681MT10PB leaflet.pdf 19 July, 2007

410479

Rev0

681MT10PB:

N/O: Wire as above

N/C: For this option connect the load to the '2' terminal



681MT16 & 681MT10PB leaflet.pdf 19 July, 2007

410479

Rev0

681MT16 WIRING OPTIONS:

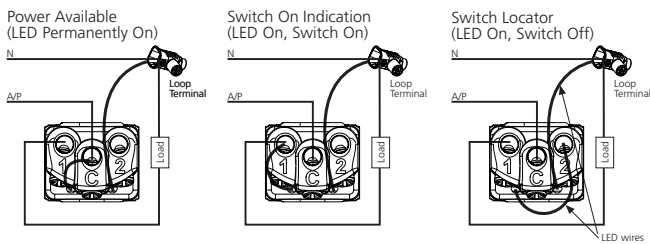

Note: LED is factory fitted and is not replaceable. LED does not have to be connected if not required.

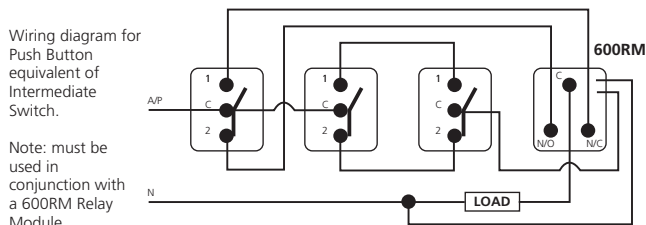

Note: must be used in conjunction with a 600RM Relay Module.

681MT16 WIRING OPTIONS:

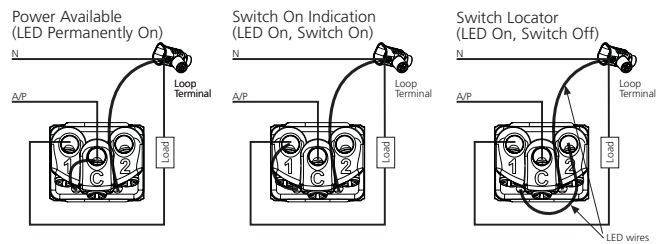

Note: LED is factory fitted and is not replaceable. LED does not have to be connected if not required.

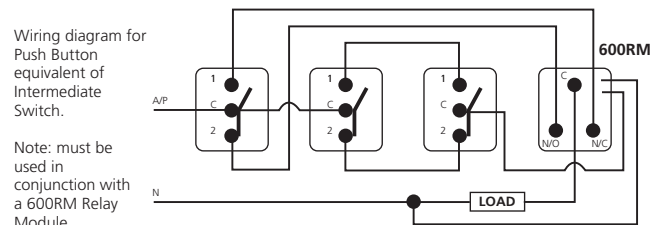

Note: must be used in conjunction with a 600RM Relay Module.

681MT10PB:

N/O: Wire as above

N/C: For this option connect the load to the '2' terminal



681MT16 & 681MT10PB leaflet.pdf 19 July, 2007

410479

Rev0

681MT10PB:

N/O: Wire as above

N/C: For this option connect the load to the '2' terminal



681MT16 & 681MT10PB leaflet.pdf 19 July, 2007

410479

Rev0