

Wiser Window/Door Sensor

Device user guide

Information about features and functionality of the device.

02/2024

IMPORTANT: Select your system to access the right user guide

If you have
Wiser Gateway
(CCT501901) and
Wiser app, continue
reading this
device user guide.

Wiser by SE System



Wiser app



CCT501901
Wiser Gateway

If you have
Wiser Hub/HubR
2nd Generation
(CCT501801 or
CCTFR6311G2) and
Wiser Home app, then
click here 

Wiser Home System



Wiser Home app



CCT501801
Wiser Hub
2nd Generation



CCTFR6311G2
Wiser HubR
2nd Generation

Legal Information

The information provided in this document contains general descriptions, technical characteristics and/or recommendations related to products/solutions.

This document is not intended as a substitute for a detailed study or operational and site-specific development or schematic plan. It is not to be used for determining suitability or reliability of the products/solutions for specific user applications. It is the duty of any such user to perform or have any professional expert of its choice (integrator, specifier or the like) perform the appropriate and comprehensive risk analysis, evaluation and testing of the products/solutions with respect to the relevant specific application or use thereof.

The Schneider Electric brand and any trademarks of Schneider Electric SE and its subsidiaries referred to in this document are the property of Schneider Electric SE or its subsidiaries. All other brands may be trademarks of their respective owner.

This document and its content are protected under applicable copyright laws and provided for informative use only. No part of this document may be reproduced or transmitted in any form or by any means (electronic, mechanical, photocopying, recording, or otherwise), for any purpose, without the prior written permission of Schneider Electric.

Schneider Electric does not grant any right or license for commercial use of the document or its content, except for a non-exclusive and personal license to consult it on an "as is" basis.

Schneider Electric reserves the right to make changes or updates with respect to or in the content of this document or the format thereof, at any time without notice.

To the extent permitted by applicable law, no responsibility or liability is assumed by Schneider Electric and its subsidiaries for any errors or omissions in the informational content of this document, as well as any non-intended use or misuse of the content thereof.

Table of Contents

Safety information	5
Wiser Window/Door Sensor	6
For your safety	6
About the device	6
Installing the device	6
Pairing the device	7
Pairing device manually	7
Pairing device with auto scan	8
Configuring the device	9
Changing the device icon	9
Renaming the device	10
Changing the device location	11
Removing the device from Wiser system	11
Resetting the device	12
Using the Device	13
Checking the device history	14
Creating an automation	14
Replacing the batteries	18
LED Indications	19
Troubleshooting	19
Technical Data	19
Compliance	21
Compliance information for Green Premium products	21
EU Declaration of Conformity	22
Trademarks	22

Safety information

Important information

Read these instructions carefully and look at the equipment to become familiar with the device before trying to install, operate, service, or maintain it. The following special messages may appear throughout this manual or on the equipment to warn of potential hazards or to call attention to information that clarifies or simplifies a procedure.



The addition of either symbol to a “Danger” or “Warning” safety label indicates that an electrical hazard exists which will result in personal injury if the instructions are not followed.



This is the safety alert symbol. It is used to alert you to potential personal injury hazards. Obey all safety messages that accompany this symbol to avoid possible injury or death.

⚡ ⚠ DANGER
DANGER indicates a hazardous situation which, if not avoided, will result in death or serious injury. Failure to follow these instructions will result in death or serious injury.
⚠ WARNING
WARNING indicates a hazardous situation which, if not avoided, could result in death or serious injury.
⚠ CAUTION
CAUTION indicates a hazardous situation which, if not avoided, could result in minor or moderate injury.
NOTICE
NOTICE is used to address practices not related to physical injury.

Wiser Window/Door Sensor



CCT591011

For your safety

NOTICE

EQUIPMENT DAMAGE

- Do not install the sensor near magnetic devices to avoid degrading its performance.
- With a window/door in the closed state, the distance between the primary and secondary parts of the sensor should be <math><18\text{ mm}</math> for a non-metallic base (for example, wood or plastic surfaces) and <math><10\text{ mm}</math> for a metallic base.

Failure to follow these instructions can result in equipment damage.

About the device

The Wiser Window/Door Sensor (hereinafter referred to as **sensor**) consists of two separate parts: Primary and Secondary. The primary part includes the sensing circuit which detects the secondary part. The secondary part is a magnet.

When the sensor is connected to the **Wiser Gateway** and the window/door is opened or closed, the primary part directly reports the change to the app via **Wiser Gateway**.

Operating elements

- Primary part (sensing circuit)
- Secondary part (magnet)
- Status LED
- Function key

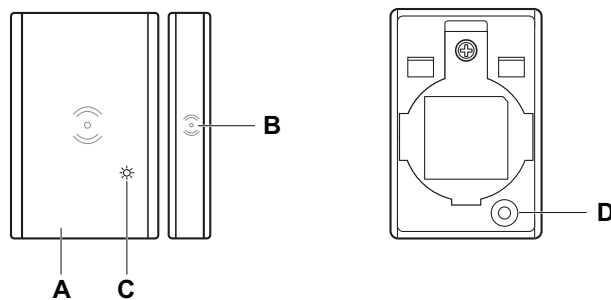

Installing the device

Refer to the installation instruction supplied with this product.

See Wiser Window/Door Sensor.

Pairing the device

Using the Wiser app, pair your device with the to access and control the device. You can either add the device manually or do an auto-scan to pair it.

Pairing device manually

To pair the device manually:

1. On **Home** page, tap **+**.
2. Tap , select the required **Wiser Hub** on the slide-up menu.
3. Select an option to add the device(A):
 - **Add Device with Install Code**
 - **Add Device without Install Code**

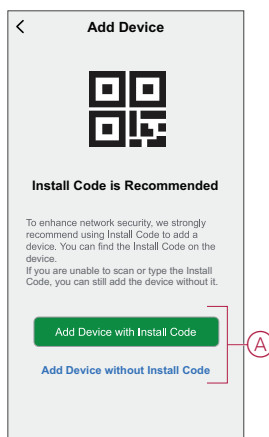

TIP: It is highly recommended to add the device with install code.

4. To pair the device with install code, tap **Add Device with Install Code** to display the slide-up menu. Select any one of the options (B):
 - **Scan Install Code** - you can scan the device for the install code.
 - **Enter Install Code Manually** - you can manually enter the install code from the device.

After pairing the device with install code, proceed to **Step 6**.

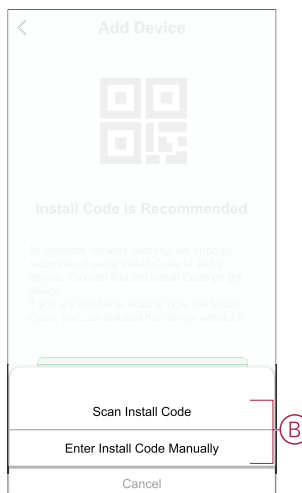

5. To pair the device without install code, tap **Add Device without Install Code**.
6. On the back of the device, short press (< 0,5 s) the function key 3 times on the device.

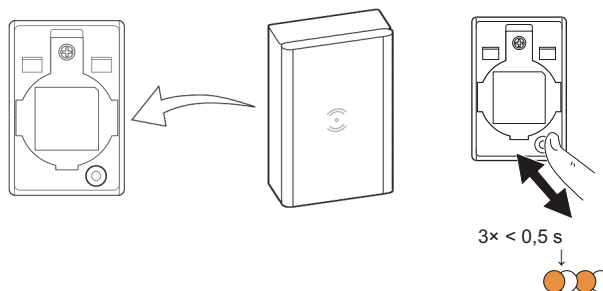

The LED blinks orange.

7. In the app, select **Confirm LED is Flashing Orange** and tap **Start Configuration (C)**.

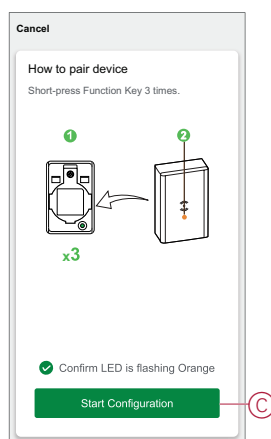

8. After a few seconds, a solid green LED indicates that the device has been successfully paired to the Gateway.

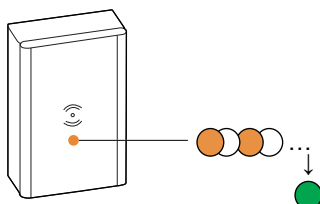

9. Once the device is added in the app, tap **Done**.

Pairing device with auto scan

Pairing the device with auto scan automatically discovers the device when it is powered on.

To pair the device:

1. On the **Home** page, tap **+**.
2. Tap **Auto scan** and then tap **Confirm**.
3. If you have multiple hubs, do Step 4 or proceed to Step 5.
4. Tap **Select hub** and select the Wiser hub from the slide-up menu.

5. Short press the function key 3 times (< 0,5 s).

NOTE:

- The LED blinks orange.
- Wait for a few seconds until the device is detected.

6. If more than one device is in pairing mode, select the required device and tap **Next (A)**.

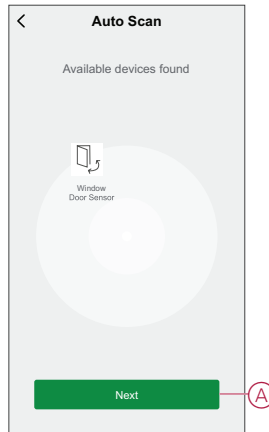



7. Once the device is added successfully, tap **Done**.

Configuring the device

Changing the device icon

You can change the device icon using the Wiser app.

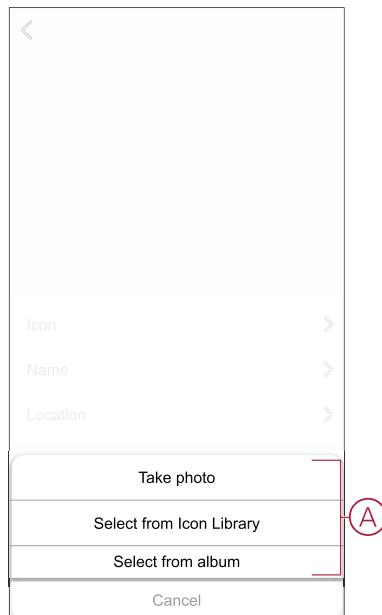

1. On the Home page, select and tap the device you wish to change the icon.
2. At the top right corner of the device screen, tap .
3. Tap edit  next to the device name.
4. Tap **Icon** to view the menu.

5. In the slide-up menu, select any one of the following (A):
- **Take photo** - Allows you to click a photo from the mobile camera.
 - **Select from Icon Library** - Allows you to select an icon from the app library.
 - **Select from Album** - Allows you to select a photo from the mobile gallery.



Renaming the device

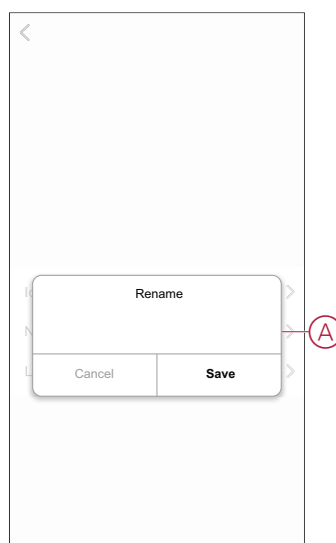

You can rename the device using the Wiser app.

1. On the Home page, select and tap the device you wish to rename.
2. At the top right corner of the device screen, tap .
3. Tap edit  next to the device name.
4. Tap **Name**, enter the name (A) and then tap **Save**.



Changing the device location

You can change the device location using the Wiser app.

1. On the Home page, select and tap the device you wish to change the location.
2. At the top right corner of the device screen, tap .
3. Tap edit  next to the device name.
4. Tap **Location**.
5. Select the desired location from the list (A) and tap **Save**.

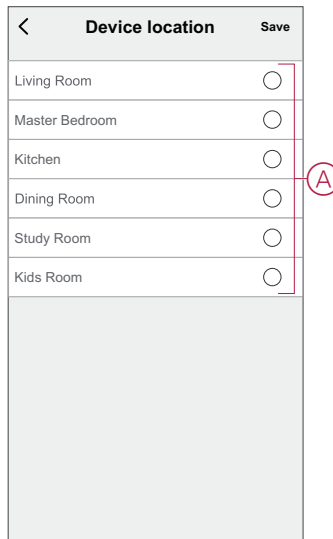

Removing the device from Wiser system

You can remove a device from the device list using the Wiser app,
To remove the device:

1. On the **Home** page, tap **All devices > Window/Door Sensor**.
2. Tap  to display more details.

3. Tap **Remove and Factory Reset Device** (A) and tap **Confirm**.

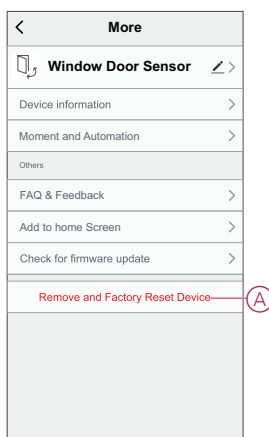

TIP: Alternatively, you can tap and hold on the **Window/Door Sensor** on the **Home** page to remove the device.

NOTE: By removing the device, you will reset the device. If you still have a problem with the reset, then refer to resetting the device, page 12.

Resetting the device

You can reset the sensor to factory default manually.
To reset the sensor:

1. Remove the primary part from the base plate by sliding it upwards.

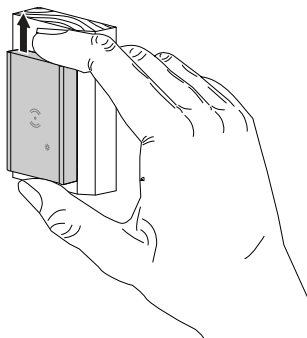

- Short-press the function key 3 times (<0.5 s) and then long-press the function key once (>10 s), the LED blinks red after 10 s, and then release the function key.

Upon successful reset of the sensor, the LED stops blinking. Then, the sensor restarts and blinks green for a few seconds.

NOTE: After reset, the LED turns off to save the battery.

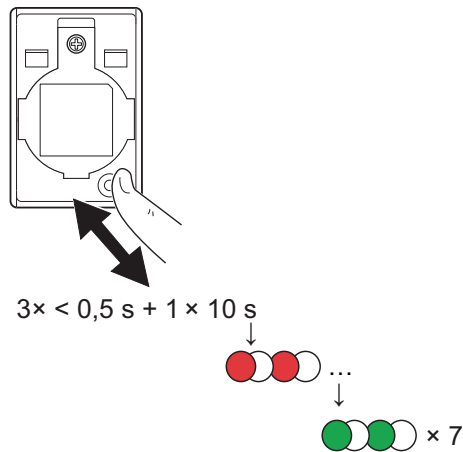

Using the Device

The Control Panel of the Sensor allows you to view if the window/door is opened or closed.

On the **Home** page, tap **All devices** > **Window/Door Sensor** to access the control panel.

On the Sensor control panel page, you can see the following:

- Battery level (A)
- Window/Door status (B)
- History (C)

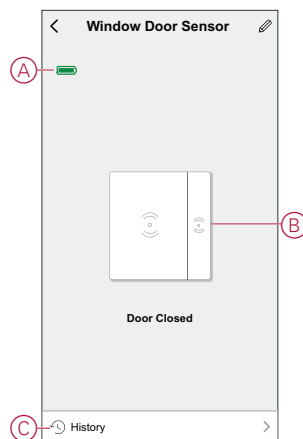

Checking the device history

You can monitor the opening and closing of the window/door by accessing the device history in the Wiser app

To see the device history:

1. On the **Home** page, tap **All devices > Window/Door Sensor**.
2. On the device control panel page, tap **History**.
3. In the **History** page, you can see the date and time when the window/door was opened or closed.

History	
2021-09-24	
19:18:26	Closed
19:18:26	Open
16:37:12	Closed
16:37:10	Open
16:37:06	Closed
2021-09-25	
16:04:37	Open
16:04:33	Closed
16:04:31	Open
16:04:30	Closed
16:04:31	Open
16:04:30	Closed

Creating an automation

An automation allows you to group multiple actions that are usually done together, triggered automatically or at scheduled times. By using the Wiser app, you can create automations based on your needs.

To create an automation:

1. On the **Home** page, tap the .
2. Go to **Automation > +** to create an automation.
3. Tap **Edit name**, enter the name of the automation (A) and tap **Save**.

TIP: You can choose the cover image that represents your automation by tapping .

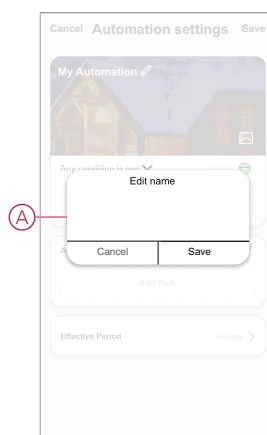

4. Tap **Any condition is met** to select any one of the condition type (B):
 - **All conditions are met**- The automation is triggered when all the conditions are met.
 - **Any condition is met**- The automation is triggered when at least one condition is met.

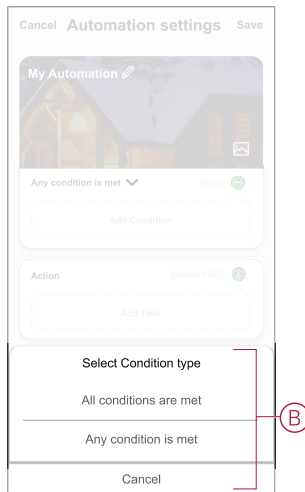

5. Tap **Add Condition** to open the slide-up menu.
6. In the **Add Condition** menu, you can do either or all of the following options (C):
 - **When weather changes**- Select the various weather settings
 - **Schedule**- Set the time and day
 - **When device status changes** - Select the device and it's function

NOTE: You can add one or more conditions using .

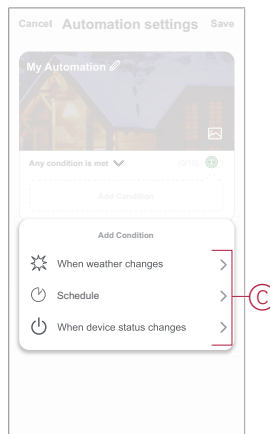

7. Tap **When device status changes > Window/Door Sensor** to select either or all of the functions to add in the automation:
- **Open**- When the window/door is opened (D)
 - **Closed**- When the window/door is closed (E)

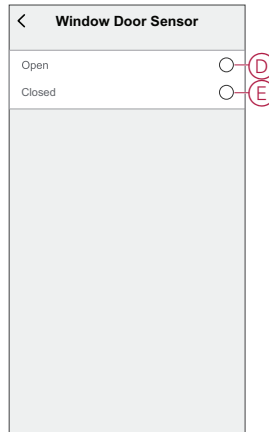

8. Tap **Add task** to open the slide-up menu.
9. In the **Add task** menu, you can do either or all of the following options (F):
- **Run the device**- Select the devices that you want to be triggered
 - **Moment or Automation**- Select the moment which you want to trigger or select the automation that you want to enable or disable
 - **Send notification**- Turn On notification for the automation
 - **Delay** - Set the delay time

NOTE: You can add one or more actions using .

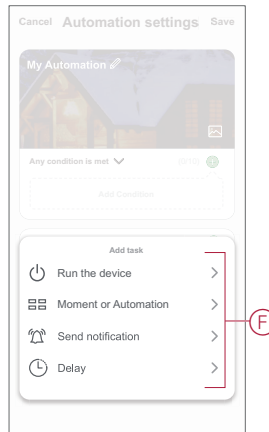

10. Tap on Effective period to set the time range for the automation. You can select any one of the following (G):
 - **All-day - 24 hours**
 - **Daytime - From sunrise to sunset**
 - **Night - From sunset to sunrise**
 - **Custom - User defined time period**

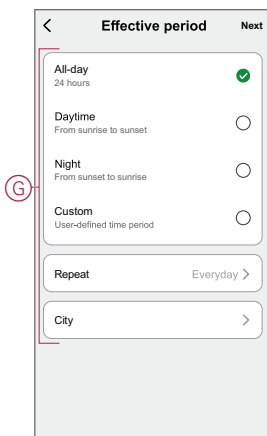

11. Once all the actions and conditions are set, tap **Save**.

Example of an automation

This demonstration shows you how to create an automation to switch On the light when the door is opened.

1. Go to **Automation** > **+** to create an automation.
2. Tap **Edit name**, enter the name of the automation and tap **Save**.
TIP: You can choose the cover image that represents your automation by tapping  .
3. Tap **Add Condition** > **When device status changes** > **Window/Door Sensor**.
4. Tap **Window/Door Sensor** > **Open**.
5. Tap **Add task** > **Run the device** and select **Micro Module Light Switch**.
6. Tap **Switch** > **On (A)** and tap **Save**.
7. Tap **Next**.

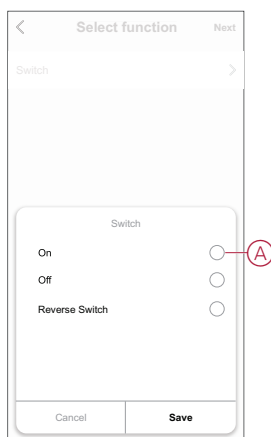

- In the **Automation Settings** page, tap **Save**.

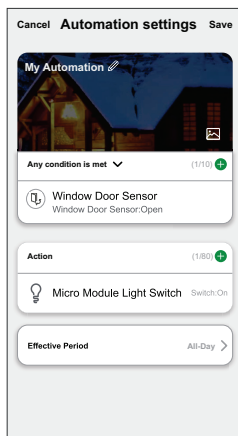

Once the automation is saved, it is visible on the **Automation** tab. You can tap the toggle switch on the automation to enable it.

Editing an automation

To edit an automation:

- On the **Automation** tab, locate the automation you want to edit and tap **⋮**.
- On the **Edit** page, you can tap each item (such as dimmer, shutter, delay, temperature, etc.) to change the settings.

TIP:

- You can add one or more actions using **+**.
- To delete an existing condition or action, slide each item towards left and tap **Delete**.

Deleting an automation

To delete an automation:

- On the **Automation** tab, locate the automation that you want to delete and then tap **⋮**.
- Tap **Delete** and tap **Ok**.

NOTE: After deleting an automation, the device action can no longer be triggered.

Replacing the batteries

Follow the steps to replace the batteries:

- Remove the primary part from the base plate by sliding it upwards.
- Unscrew the battery cover using a screwdriver.
- Replace the battery with the proper polarity.
- Re-install the battery cover and tighten the screw using a screwdriver.
The LED blinks green seven times and then stops blinking.

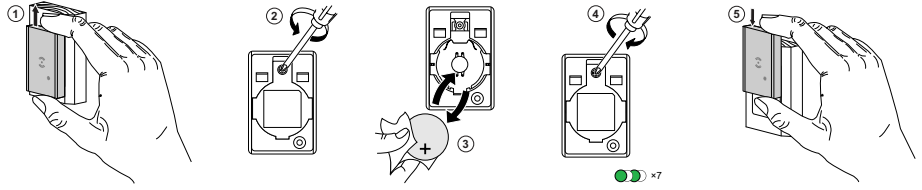

5. Install the primary part on the base plate by sliding it down.

IMPORTANT: Dispose used batteries, as per statutory regulations.





LED Indications

Pairing

User Action	LED Indication	Status
Press the function key 3 times	LED blinks orange, once per second. 	Pairing mode is active for 30 seconds. When pairing is completed, LED glows green for some time before turning Off. 

Resetting

User Action	LED Indication	Status
Press the function key 3 times and hold it down once for > 10 s.	After 10 s, the LED starts blinking red. 	The sensor is in reset mode. It is reset to the factory settings after 10 seconds. The sensor then restarts and the LED starts blinks green before turning Off. 

Battery level

LED Indication	Status
LED blinks orange once per minute. 	The battery is low (< 10%), replace the battery, page 18. NOTE: A notification pop-up will appear on the app.

Troubleshooting

Symptom	Possible cause	Solution
The sensor triggers the automation/schedule, but does not show the status on the app.	The sensor may be undergoing an over-the-air (OTA) firmware update.	Wait for the firmware update to complete and then check that the sensor is reporting status. NOTE: The firmware update runs in the background.
LED blinks orange.	The sensor battery is low or drained.	Replace the sensor battery, page 18 NOTE: A notification pop-up will appear on the app.

Technical Data

Battery	3 VDC, CR2450
Battery life	Up to 5 years (may vary based on the usage, frequency of firmware update and environment)

Nominal power	≤90 mW
IP rating	IP20
Operating frequency	2405 - 2480 MHz
Max. radio frequency power transmitted	≤7 dBm
Operating temperature	-10 °C to 50 °C
Relative humidity	10 % to 95 %
Primary part dimensions (H × W × D)	50.3 × 33.0 × 16.3 mm
Secondary part dimensions (H × W × D)	50 × 9 × 9 mm
Communication protocol	Zigbee 3.0 certified

Compliance

Compliance information for Green Premium products

Find and download comprehensive information about Green Premium products, including RoHS compliance and REACH declarations as well as Product Environmental Profile (PEP) and End-of-Life instructions (EOLI).

<https://checkaproduct.se.com/>



General information about Green Premium products

Click the link below to read about Schneider Electric's Green Premium product strategy.

<https://www.schneider-electric.com/en/work/support/green-premium/>



EU Declaration of Conformity

Hereby, Schneider Electric Industries, declares that this product is in compliance with the essential requirements and other relevant provisions of RADIO DIRECTIVE 2014/53/EU. Declaration of conformity can be downloaded on se.com/docs.

Trademarks

This guide makes reference to system and brand names that are trademarks of their relevant owners.

- Zigbee® is a registered trademark of the Connectivity Standards Alliance.
- Apple® and App Store® are brand names or registered trademarks of Apple Inc.
- Google Play™ Store and Android™ are brand names or registered trademarks of Google Inc.
- Wi-Fi® is a registered trademark of Wi-Fi Alliance®.
- Wiser™ is a trademark and the property of Schneider Electric, its subsidiaries and affiliated companies.

Other brands and registered trademarks are the property of their respective owners.

Schneider Electric
35 rue Joseph Monier
92500 Rueil Malmaison
France

+ 33 (0) 1 41 29 70 00

www.se.com

As standards, specifications, and design change from time to time,
please ask for confirmation of the information given in this publication.

© 2021 – 2024 Schneider Electric. All rights reserved.

DUG_Window/Door Sensor_WSE-02