

Wiser Micro Module Shades Control

Device user guide

Information about features and functionality of the device.

03/2024

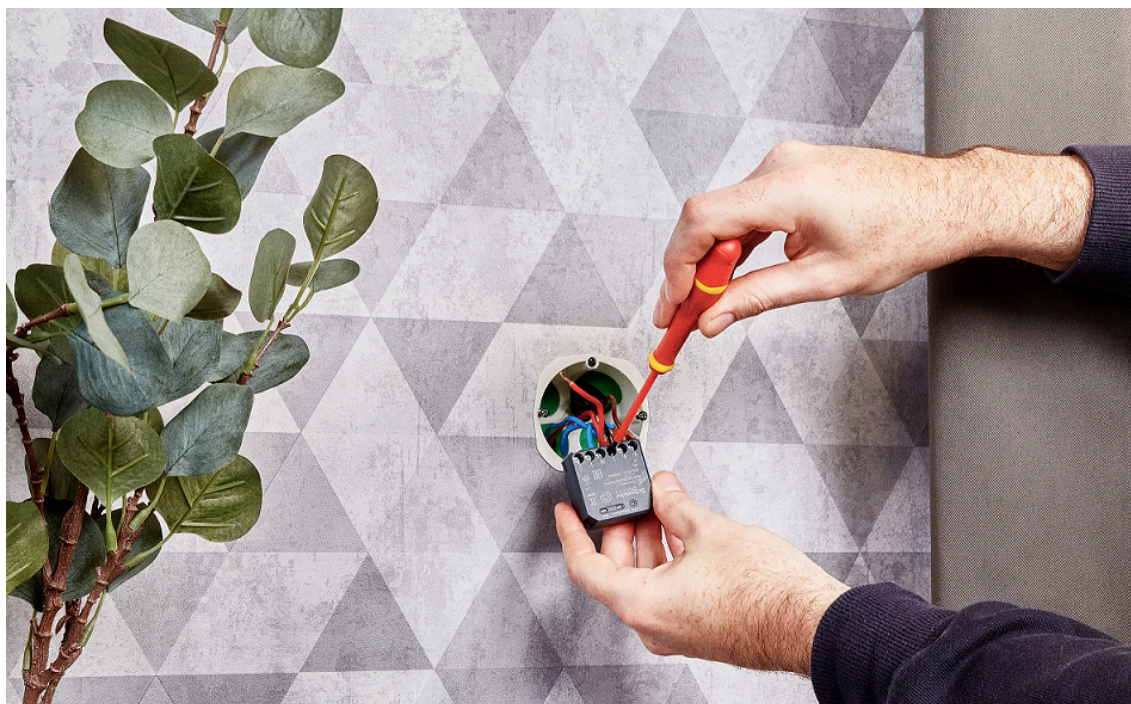

Legal Information

The information provided in this document contains general descriptions, technical characteristics and/or recommendations related to products/solutions.

This document is not intended as a substitute for a detailed study or operational and site-specific development or schematic plan. It is not to be used for determining suitability or reliability of the products/solutions for specific user applications. It is the duty of any such user to perform or have any professional expert of its choice (integrator, specifier or the like) perform the appropriate and comprehensive risk analysis, evaluation and testing of the products/solutions with respect to the relevant specific application or use thereof.

The Schneider Electric brand and any trademarks of Schneider Electric SE and its subsidiaries referred to in this document are the property of Schneider Electric SE or its subsidiaries. All other brands may be trademarks of their respective owner.

This document and its content are protected under applicable copyright laws and provided for informative use only. No part of this document may be reproduced or transmitted in any form or by any means (electronic, mechanical, photocopying, recording, or otherwise), for any purpose, without the prior written permission of Schneider Electric.

Schneider Electric does not grant any right or license for commercial use of the document or its content, except for a non-exclusive and personal license to consult it on an "as is" basis.

Schneider Electric reserves the right to make changes or updates with respect to or in the content of this document or the format thereof, at any time without notice.

To the extent permitted by applicable law, no responsibility or liability is assumed by Schneider Electric and its subsidiaries for any errors or omissions in the informational content of this document, as well as any non-intended use or misuse of the content thereof.

Table of Contents

| | |
|---|----|
| Safety Information..... | 4 |
| Wiser Micro Module Shades Control | 5 |
| For your safety | 5 |
| About the device..... | 6 |
| Installing the device | 6 |
| Testing the device..... | 7 |
| Quick Home Connect..... | 8 |
| About Quick Home Connect..... | 8 |
| Pairing Wireless switch with Micro module shades control (Puck) | 9 |
| Using the Wireless switch in Quick Home Connect | 9 |
| Resetting the device in Quick Home Connect..... | 10 |
| LED indications in Quick Home Connect..... | 10 |
| Troubleshooting in Quick Home Connect | 10 |
| Pairing the device | 11 |
| Configuring the device | 12 |
| Setting the device location | 12 |
| Renaming the device | 14 |
| Selecting device type | 15 |
| Setting the default run time | 16 |
| Shutter calibration with Wiser app | 17 |
| Setting Summer Comfort Mode..... | 19 |
| Identifying the device | 23 |
| Using the device..... | 24 |
| Manual operation | 24 |
| Opening/Closing the shutter using app | 24 |
| Setting up a schedule..... | 25 |
| Creating a moment | 27 |
| Creating an automation | 31 |
| Removing the device from Wiser system | 38 |
| Resetting the device manually | 39 |
| LED indication..... | 39 |
| Troubleshooting | 39 |
| Technical data | 40 |
| Compliance..... | 41 |
| Compliance information for Green Premium products | 41 |
| EU Declaration of Conformity..... | 42 |
| Trademarks | 42 |

Safety Information

Important Information

Read these instructions carefully and look at the equipment to become familiar with the device before trying to install, operate, service, or maintain it. The following special messages may appear throughout this manual or on the equipment to warn of potential hazards or to call attention to information that clarifies or simplifies a procedure.



The addition of either symbol to a “Danger” or “Warning” safety label indicates that an electrical hazard exists which will result in personal injury if the instructions are not followed.



This is the safety alert symbol. It is used to alert you to potential personal injury hazards. Obey all safety messages that accompany this symbol to avoid possible injury or death.

DANGER

DANGER indicates a hazardous situation which, if not avoided, **will result in** death or serious injury.

Failure to follow these instructions will result in death or serious injury.

WARNING

WARNING indicates a hazardous situation which, if not avoided, **could result in** death or serious injury.

CAUTION

CAUTION indicates a hazardous situation which, if not avoided, **could result in** minor or moderate injury.

NOTICE

NOTICE is used to address practices not related to physical injury.

Wiser Micro Module Shades Control



CCT5015-0002W

For your safety

⚠️⚠️ DANGER

HAZARD OF ELECTRIC SHOCK, EXPLOSION, OR ARC FLASH

Safe electrical installation must be carried out only by skilled professionals. Skilled professionals must prove profound knowledge in the following areas:

- Connecting to installation networks.
- Connecting several electrical devices.
- Laying electric cables.
- Safety standards, local wiring rules and regulations.

Failure to follow these instructions will result in death or serious injury.

⚠️ DANGER

HAZARD OF ELECTRIC SHOCK

- Make sure that the terminal connection area does not come in contact with the metallic parts of any device installed in the same location.
- Do not short the outputs to neutral.
- The motor contacts and live conductor connection must be separated from one another by a 240 VAC basic insulation.

Failure to follow these instructions will result in death or serious injury.

⚠️ WARNING

HAZARD OF ELECTRIC SHOCK

- Observe the regulations for working on live parts.
- Only actuate the device buttons using insulated auxiliary equipment that meets the requirements of EN 60900.

Failure to follow these instructions can result in death, serious injury, or equipment damage.

About the device

The Wiser Micro Module Shades Control (hereinafter referred to as **Puck**) combines the advantages of smart shutter functionality with ordinary mechanical double push-button switches. It transforms a conventional switch into a connected device that you can control from the switch or through the Wiser app. Relay contacts are mechanically locked against each other to prevent simultaneous triggering of the two relay outputs.

NOTE: Do not control any devices that depend on a permanent power supply.

Control options

Home control using Wiser Home app: To control the puck through the Wiser app you will need the **Wiser Hub**. Refer to [Pairing the device](#), page 11.

Direct operation: The puck can always be controlled directly on-site. You can also connect it with mechanical double push-button switch. Refer to [Manual operation](#), page 24.

Additional features:

- Remote control with maximum of 10 mechanical double push-button switches.
- Protection of the motor against damage with two mutually mechanically and electronically locked relay contacts.
- Electronic overload protection, overheating protection and short-circuit protection.
- Setting a time schedule via Wiser Home app.

Installing the device

Refer to the installation instructions supplied with this product.

Testing the device

Before using the Puck, manually test the Puck and make sure that it works when connected to the shutter.

⚠ WARNING

HAZARD OF ELECTRIC SHOCK

- Observe the regulations for working on live parts.
- Only actuate the device buttons using insulated auxiliary equipment that meets the requirements of EN 60900.

Failure to follow these instructions can result in death, serious injury, or equipment damage.

- Short press the test button once, the shutter opens/closes gradually.
- Press and hold the test button, the shutter opens/closes fully, record the time it takes to fully open/close the shutter.

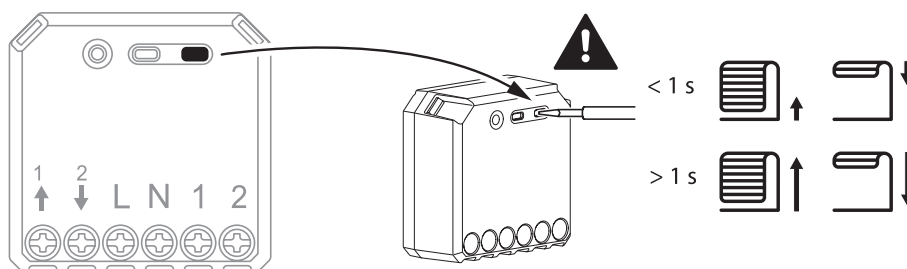

Quick Home Connect

About Quick Home Connect

Quick Home Connect is a wireless connectivity solution for Zigbee devices without the need for a Hub or smartphone application. Quick Home Connect is your starting point for wireless home automation. It performs functions like switching, dimming and shutter control using the Connected Wireless Switch 1-gang/2-gang (hereinafter referred to as Wireless switch) via a Zigbee network.

The **Wireless switch** is a battery-powered wireless push-button switch that is used to control Zigbee devices (such as shutter control) within the same Zigbee network.

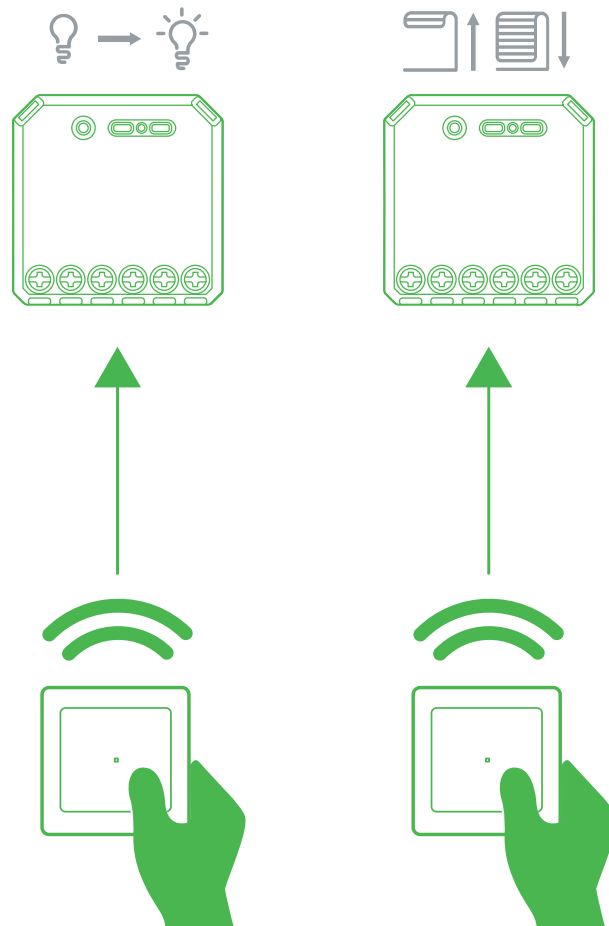

Supported devices

- Wiser Micro Module Light Switch
- Wiser Micro Module Shades Control

Limitations

- Quick Home Connect serves as a room control solution.
- You cannot mix dimmer switch with shutter control on a 1-gang Wireless switch but in 2-gang Wireless switch you can use the first for dimming and the second for shutter control, or vice versa.
- The solution does not support remote control, smartphone app usage, or scheduling features.
- Only battery-powered connected wireless switches work with Quick Home Connect.

Pairing Wireless switch with Micro module shades control (Puck)

1. Short press the upper push-button 5 times in quick succession on the Wireless switch.

The status LED blinks green.

NOTE: The pairing mode will be active for about a minute.

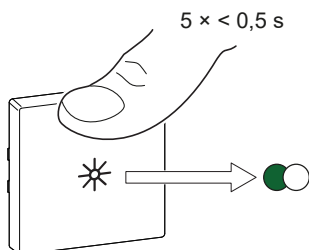

2.

⚠ WARNING

HAZARD OF ELECTRIC SHOCK

- Observe the regulations for working on live parts.
- Only actuate the device buttons using insulated auxiliary equipment that meets the requirements of EN 60900.

Failure to follow these instructions can result in death, serious injury, or equipment damage.

Follow any one of the options to pair Puck:

- Short press the Setup/Reset button 5 times in quick succession on the Puck with a screwdriver.
- Short press the mechanical double push-button 1 for 5 times in quick succession.

The status LED blinks green on the Puck.

NOTE: If the Puck is located behind the mechanical double push-button, the status LED is not visible.

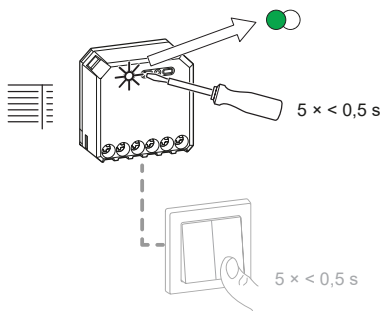

The shutter will move up and down a few times. The status LED stops blinking green on the Wireless switch and the Puck. The Puck can now be controlled by the Wireless switch.

Using the Wireless switch in Quick Home Connect

Operating a shades control

You can operate the shades control using the Wireless switch.

Long press the Wireless switch ($> 0,5$ s) to move the shades control up or down.

- Press to open the shades control (A)
- Press to close the shades control (B)

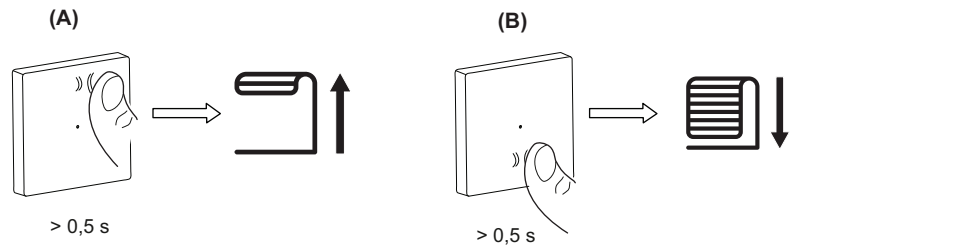

Short press top or bottom Wireless switch (< 0,5 s) to stop the moving shades control (C).

Short press top or bottom Wireless switch (< 0,5 s) to adjust the slat position (D).

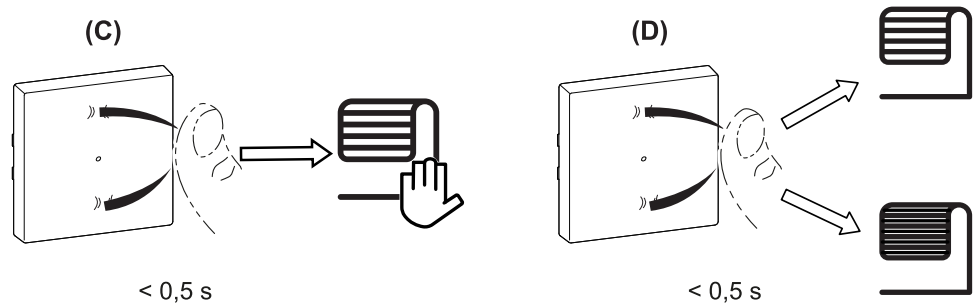

Resetting the device in Quick Home Connect



It is necessary to reset the devices in the following scenarios:

- Unpair the device in Quick Home Connect:
 - Refer to [Resetting the Wireless switch, Micro module shades control](#).

When reset is done successfully. The **Wireless switch** and device returns to **factory default**.
- Integrating into Wiser System
 - If you wish to integrate the devices into Wiser System, reset all the devices in Quick Home Connect and refer to [Pairing the device with Wiser Hub](#), page 11.

LED indications in Quick Home Connect

Pairing the device in Quick Home Connect

| User Action | LED Indication | Status |
|--|---|---|
| Press the push button 5 times in quick succession. | LED blinks green, once per second.  | Pairing mode is active for 60 seconds. When pairing is completed, LED stops blinking.  |

Troubleshooting in Quick Home Connect

| Symptom | Possible cause | Solution |
|---|--|--|
| LED displays amber in Puck (Micro module shades control). | Pairing not completed and returned to factory reset. | Pair the Wireless switch and the device again. Refer to Pairing the Wireless switch with Micro module shades control (Puck) , page 9 . |
| Wireless switch not able to control the device reliably. | The Wireless switch and the device are too far away from each other. | Place the Wireless switch in a position closer to the device. |

| Symptom | Possible cause | Solution |
|---------|--|---|
| | The Wireless switch lost pairing. | Pair the device again <ul style="list-style-type: none"> Refer to Pairing the Wireless switch with Micro module shades control (Puck), page 9. |
| | The Wireless switch battery is discharged. | Replace the battery of the Wireless switch. |

| Scenario | Procedure |
|--|--|
| Control multiple devices with one Wireless switch (For users with multiple Home Connect kits). | To centralize control with one Wireless switch, first pair it with already connected devices. Then, pair the new device to existing group/network. |

Pairing the device

Using the Wiser Home app, pair your Puck with the **Wiser Hub** to access and control the Puck.

- On the Home page, tap .
- Tap **Devices** >  and tap **Shutters** > **Micromodule Switch** > **Next**.

NOTE: The next screen shows the joining process of **Puck**.

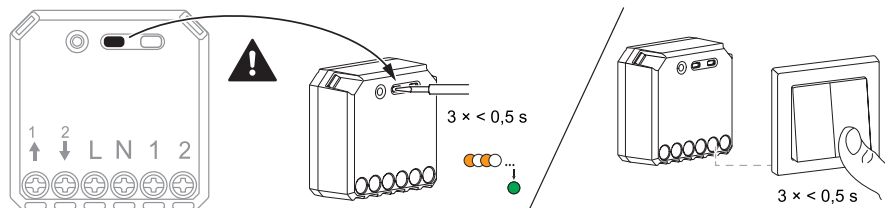

- Select any one of the options to add the device:
 - Short press the setup/reset button 3 times on the Puck with a screwdriver and make sure the LED blinks amber.
 - Short press the push button 3 times.

NOTE: If the puck is located behind the push button, the status LED is not visible.

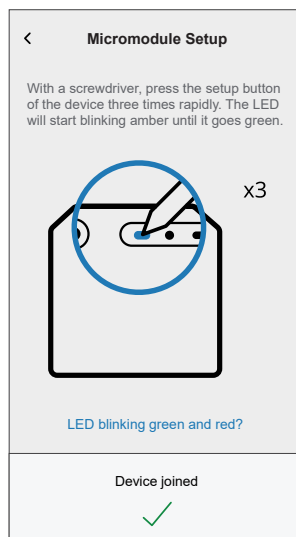

- Wait for a few seconds until the LED turns green. You can also see in the app that the device is joined.





5. Tap , enter a name of the device, tap **Next** and assign the device to a new room or an existing room.
6. Tap **Next** >  and select a **Device Type**:
If you have selected the device type as:
 - **Shutter**: Proceed to step 7.
 - **Shutter with tilting slats**: Proceed to step 8 and step 9.
7. Tap **Shutter** > **Next** and enter the open/close duration of shutter. Refer to [Setting default run time](#), page 16.
8. Tap **Shutter with tilting slats** > **Slat Type**, select a slat type and tap **Set**:
 - Horizontal
 - Tilted
 - Vertical
9. Tap **Next** and enter the following durations:
 - a. **Open duration**: Time taken to open the shutter.
 - b. **Close duration**: Time taken to close the shutter.
 - c. **Tilt duration**: Time taken to rotate the slats completely from closed to open position.
Refer to [Setting default run time](#), page 16.
10. Tap **Submit**.
Once the pairing process is completed, the device name (example, Puck) is listed under **All** devices in **Home** page.

Configuring the device

Setting the device location

You can change the device location using Wiser Home app (such as bedroom, living room, dining room etc.).

1. On the Home page, tap .
2. Tap **Devices**, select the device from the list for which you wish to change the location.
3. Tap **Location**  to open setup page.

4. On setup page, you can enter **New room name** (A) or select an existing room from the list (B).

The screenshot shows the 'Device Setup' screen. At the top, there is a back arrow and the title 'Device Setup'. Below the title, the question 'Where does this device control?' is displayed. Underneath, there is a text input field labeled 'New room name' with a red circle 'A' next to it. Below the input field is a list of existing rooms: 'Living Room' (3 Devices) with a green checkmark, 'Kitchen' (2 Devices), 'Bathroom' (3 Devices), and 'Bedroom' (2 Devices). A red box labeled 'B' highlights this list. At the bottom of the screen, there are two buttons: a red 'Remove from Room' button labeled 'C' and a green 'Submit' button labeled 'D'.

TIP: If the device is already assigned, you can remove it from the existing room. Tap **Remove from Room** (C).

5. Once changes are done, tap **Submit** (D).

Renaming the device

Rename the device using the Wiser Home app.

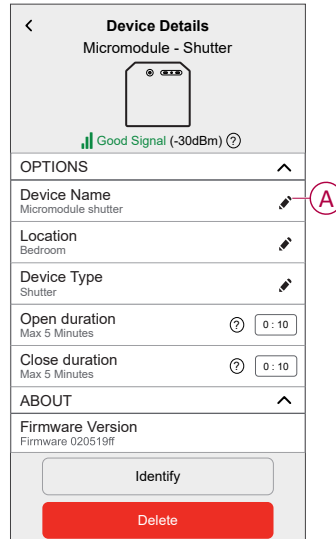

1. On the Home page, tap .
2. Tap **Devices > Micromodule Shutter > Device Name (A)** to rename the device.



Selecting device type

Using the Wiser Home app, you can change the device type according to your need.

NOTE: The device type was selected as **Shutter** when pairing with the **Wiser Hub**. You can change the device type as **Shutter with tilting slats** if it has a tilt function.

1. On the Home page, tap .
2. Tap **Devices > Shutters > Micromodule shutter**.
3. Tap  (A) and select a device type.
4. If the device type is selected as **Shutter with tilting slats**, tap  (B) and select a slat type (C).
5. Tap **Set**.

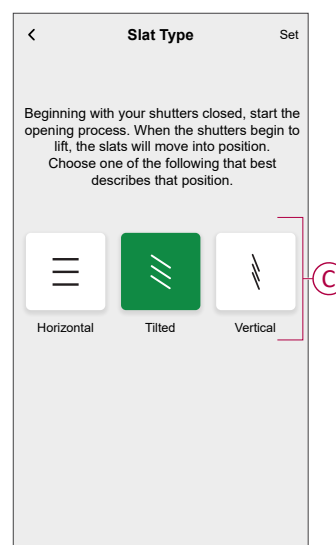
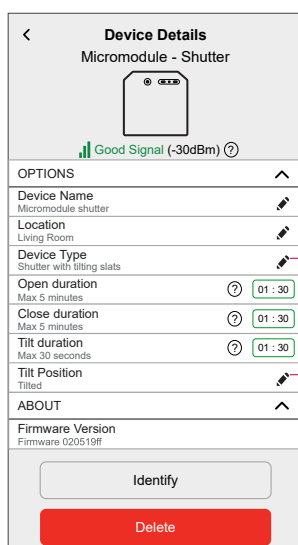

Setting the default run time

Each shutter motor varies in the time it takes to complete the opening/closing movement (i.e., edge to edge). Therefore, the opening/closing time of the shutter must be determined in the app.

To determine the default run time, manually open/close the shutter.

1. Record the time it takes to open/close the shutter completely.
2. Record the time it takes to rotate the slats completely from closed to open position for shutter with tilting slats.

For more information refer to [Testing the device](#), page 7.

Follow the procedure according to your shutter type:

- Shutter, page 16
- Shutter with tilting slats, page 17

Shutter

1. On the Home page, tap .
2. Tap **Devices > Shutters**.
3. Tap **Open duration/Close duration (A)** and enter the recorded shutter opening/closing time.

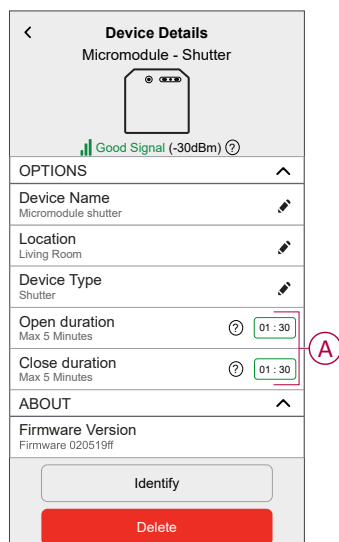

Shutter with tilting slats

1. On the Home page, tap .
2. Tap **Devices > Shutters > Shutter with tilting slats**
3. Tap **Open duration/Close duration** (A) and enter the recorded shutter opening/closing time.
4. Tap (B) and enter the slat tilt duration according to the tilt position.

IMPORTANT: The minimum value to set the default time for Tilt duration is 01.00 s. If you set a value less than 01.00 s, it will not be saved.

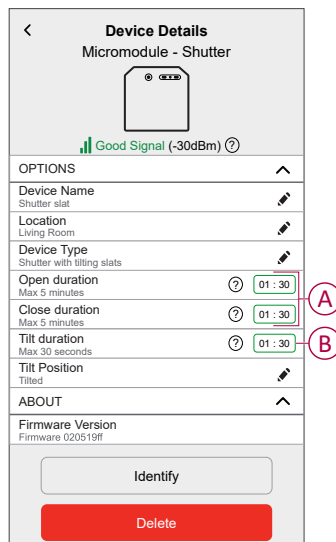

Device Details
Micromodule - Shutter

Good Signal (-30dBm)

OPTIONS

Device Name
Shutter slat

Location
Living Room

Device Type
Shutter with tilting slats

Open duration
Max 5 minutes 01 : 30

Close duration
Max 5 minutes 01 : 30

Tilt duration
Max 30 seconds 01 : 30

Tilt Position
Tilted

ABOUT

Firmware Version
Firmware 020519ff

Identify

Delete

Shutter calibration with Wiser app

The shutter motor is supplied in an uncalibrated state. Each shutter motor varies in the time it takes to complete the opening/closing movement (i.e., edge to edge).

IMPORTANT:

- It is necessary to select the device type and set the default run time before proceeding with shutter calibration. Refer to [Selecting device type](#), page 15 and [Setting default run time](#), page 16.
- Do not use the shutter either manually or on the app during calibration to avoid interruption.
- Follow the procedure for shutter calibration according to the device type: **Shutter** or **Shutter with tilting slats**.

Shutter

1. Upon setting the default run time, go to the Home page, tap **All** and find the device.
2. On the control panel page, drag the sliding bar up/down to set the desired shutter opening percentage (A).

The shutter opens completely and then it reaches to the desired position set in step 2. The shutter is now calibrated.

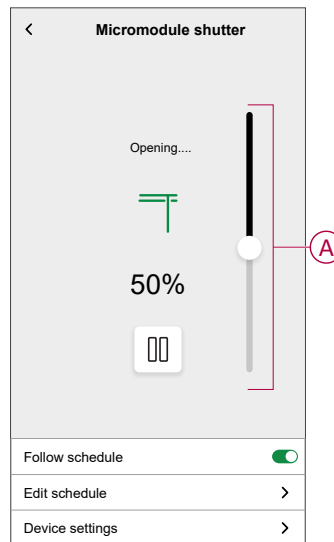

Shutter with tilting slats

1. On the Home page, tap **All** and find the device.
2. On the control panel page, in the **Position** tab, drag the sliding bar up/down to set the desired shutter opening percentage (A).

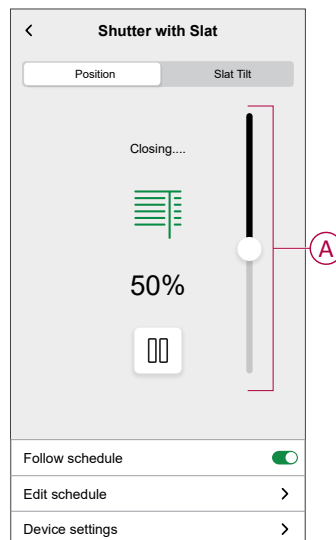

3. Tap **Slat Tilt** tab, drag the sliding bar up/down to set the desired shutter opening percentage (B) according to any one of the following tilt position:
- Horizontal
 - Tilted
 - Vertical

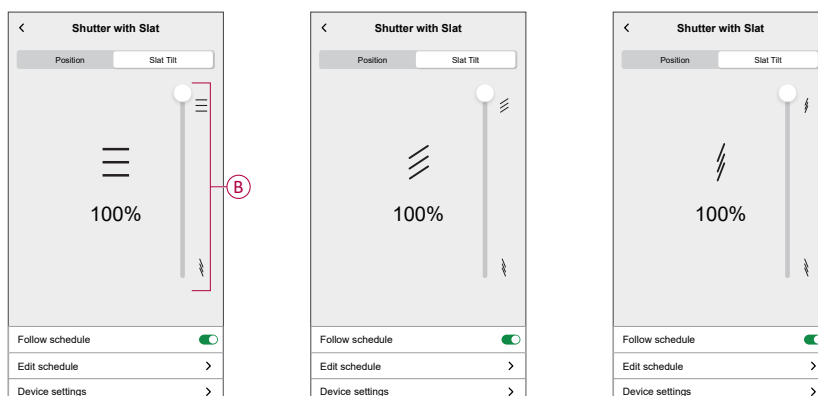

Setting Summer Comfort Mode



The **Summer Comfort Mode** automatically adjusts the shutters to a specific position when temperature is too hot both indoor and outdoor. This solution passively cools your home by lowering your shutters.

Features:

- The inside temperature is measured by sensor and the outside temperature is measured based on your location.
- Works only when the sun is out (during daytime).
- By default the blinds closes to 50%
- This feature is active only when there is minimum of 2 degrees difference between inside and outside temperature. For example: Inside temperature a minimum of 26 degrees, while the outside temperature a minimum of 28 degrees.

Pre-requisite:

- You must have a temperature sensor to measure the indoor temperature.
- Add address to your account. Tap  > **Account** > **My Home**.
- Calibrate your shutters. Refer to *Shutter calibration*, page 17 or *Shutter calibration with titling slats*, page 17 based on the shutter type.

1. On the **Home** page, tap  > **Smart Modes**.
2. Tap  to view information about **Summer Comfort Mode**.

3. Tap  (A) to go to the **Summer Comfort Mode** configuration page.

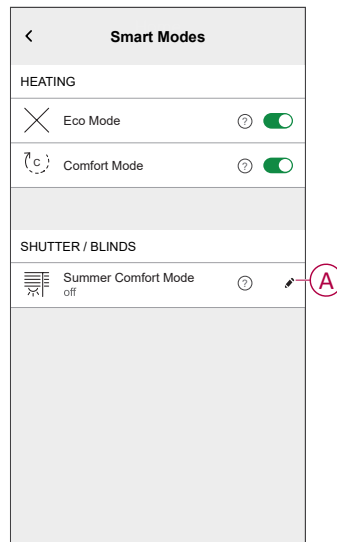

4. Tap the toggle switch (B) to enable **Summer Comfort Mode**.

5. Tap  (C) to set the temperature.

6. Select the indoor and outdoor discomfort temperature (D).

NOTE: Indoor temperature must be lower than your outdoor temperature.
(minimum of 2 degrees difference between inside and outside).

7. Tap **Set** (E).

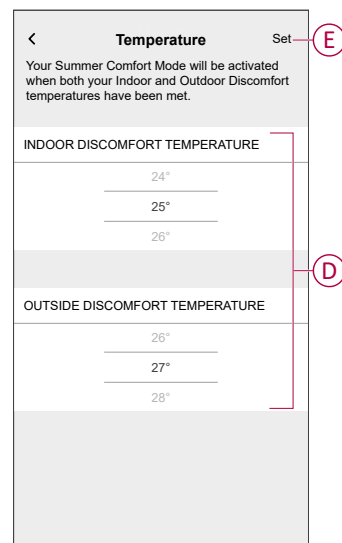
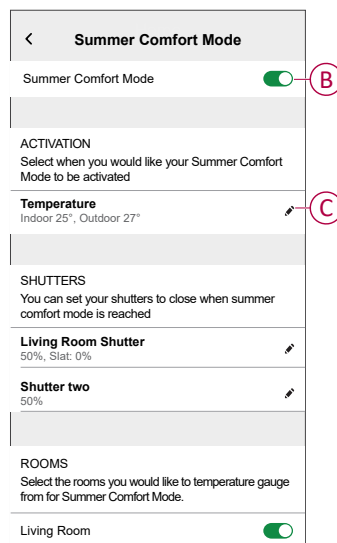

8. Tap  **Living Room Shutter** (F) and enable the toggle switch (G).

NOTE:

- Only the shutters that are eligible for Summer comfort mode will be shown.
- Example, if you have installed both shutters and temperature sensor in your home. Summer comfort mode will measure the ambient temperature sensed in any room and control all the shutters except the legacy ones.

9. Tap  **Shutter Controls** (H), set the shutter position (I) according to the shutter type and tap **Set**.



The following demonstration is shown for shutter with tilting slats.

- **Shutter with tilting slats:**
 - In the **Position** tab, drag the sliding bar (I) up/down to set the desired shutter opening percentage.
 - Tap **Slat Tilt** tab, drag the sliding bar up/down to set the desired shutter opening percentage according to the tilt position: Horizontal, Tilted, Vertical.

IMPORTANT:

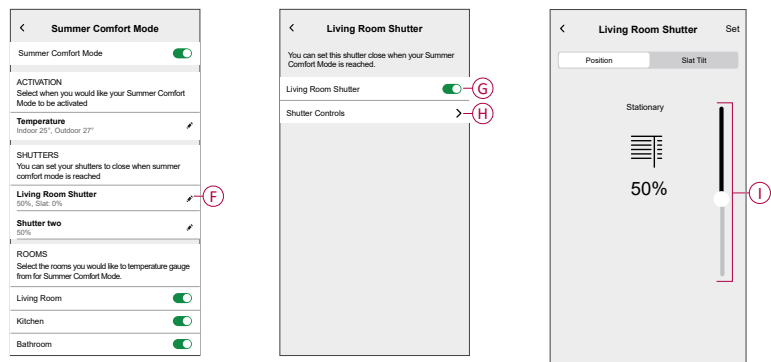
- By default the shutter position is set to 50%
- The shutter must not close to 100% to avoid any problems like someone stuck outside (their balcony or garden).



10. Tap  (J) and enable the toggle switch (K) to set the shutter position.
- a. Tap  **Shutter Controls** (L) and drag the sliding bar up/down to set the desired shutter opening percentage and tap **Set**.

TIP: All rooms are enabled by default, you can enable or disable the rooms of your choice (M). Example, you can disable the rooms which cause nuisance triggers (conservatories, utility rooms).

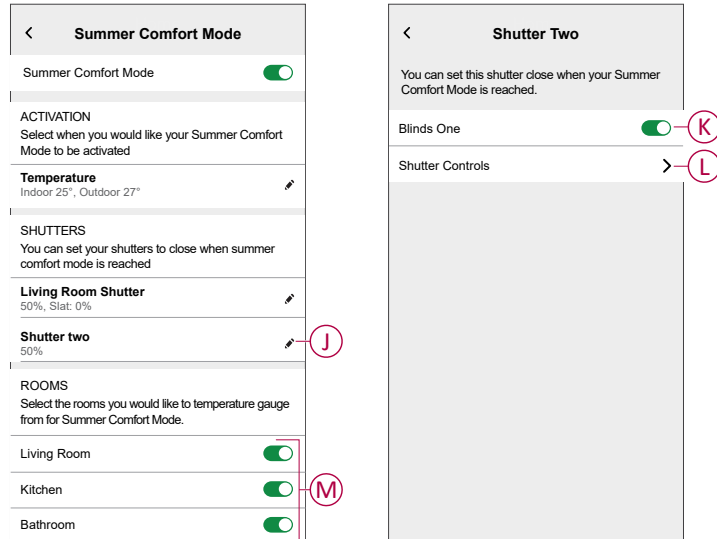

The shutters set as **Summer Comfort Mode** appears on the **Home** page.

NOTE:

- If any change is required, tap (N) > **Device settings** > **Summer Comfort Mode** > **Shutter controls** and set the shutter position.
- To disable the **Summer Comfort Mode** specific to a shutter, tap (N) > **Device settings** > **Summer Comfort Mode** and disable the toggle switch.

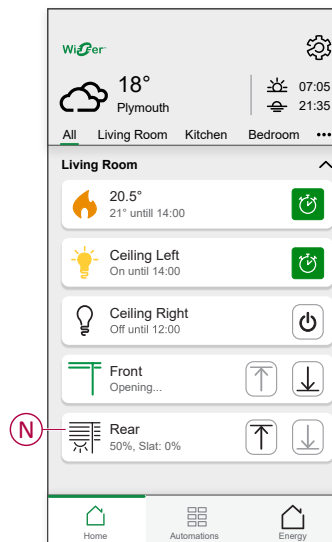

- To disable the **Summer Comfort Mode** completely, tap  > **Smart Modes** > **Summer Comfort Mode** and disable the toggle switch.

Identifying the device

Using the Wiser Home app, identify the Puck among the devices available in a home.

1. On the Home page, tap .
2. Tap **Devices > Shutters > Micromodule Shutter** or **Shutter slat > Identify (A)**.

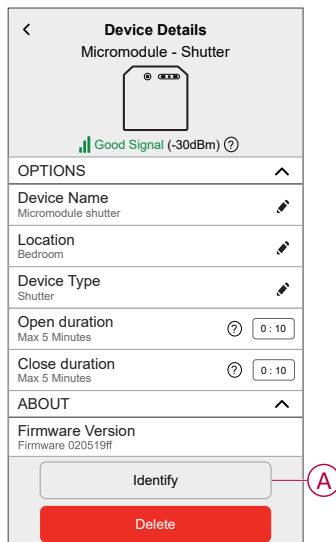

The status LED blinks red and the shutter opens/closes gradually, upon successful identification of the Puck or shutter slat.

3. Tap **OK** to finish identifying the device.

Using the device



Manual operation

When the puck is connected to a mechanical double push-button switch, the shutter can be controlled manually.

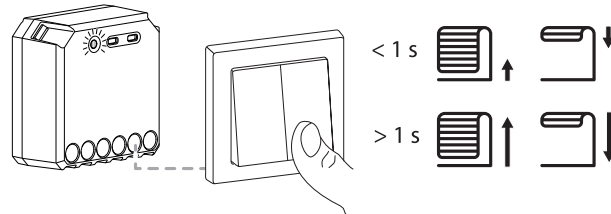
- Short press the push button once, the shutter opens/closes gradually.
- Press and hold the push button, the shutter opens/closes fully.



Opening/Closing the shutter using app

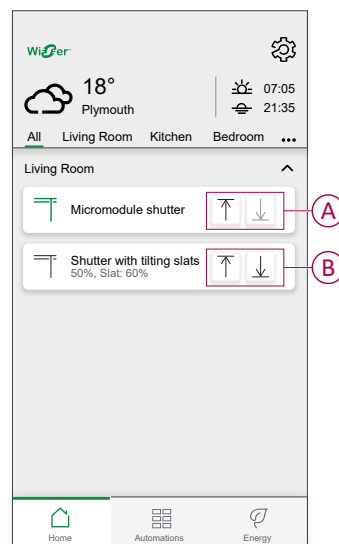

1. Go to the Home page, tap **All** and find the device.
2. Tap   (A) or (B) to open/close the shutter or shutter with tilting slats.





Setting up a schedule

The shutter can be controlled and triggered by a schedule. Once the schedule is set, your system will follow the active schedule. You can create or modify the schedules at any time. The devices can be fully controlled by schedule. Once the schedule is set, the devices operates at a given time.

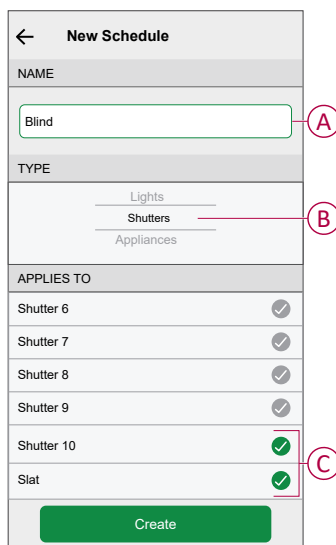

To create a schedule:

1. On the **Home** page, tap  > **Schedules** > .
2. Enter a name of the schedule (A).
3. Select a device type (B).
4. Select the list of devices (C) to which the schedule must apply.
5. Tap **Create**.



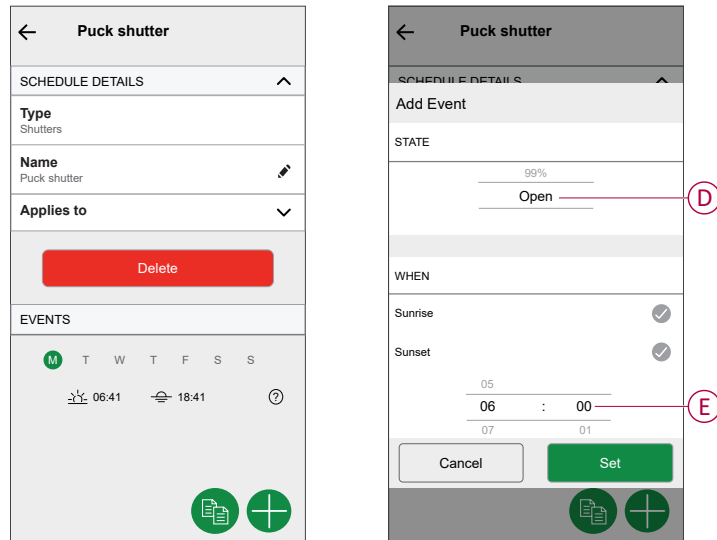

6. Tap  to add an event.

7. Select a state (Open/Closed/percentage) (D), time period (E) and tap **Set**.**TIP:**

- You can add multiple schedules based on your requirement. Select days, tap , set on/off state and time.
- You can copy the existing schedule to another schedule or to the days of your choice. Tap .
 - Tap **Schedule** and select an existing schedule and tap **Copy**.
 - Tap **Day** and select the days you want to assign and tap **Copy**.

Creating a moment

Moment allows you to group multiple actions that are usually performed together. By using the Wiser Home app, you can create moments based on your needs. To create a moment:

1. On the **Home** page, tap .
2. Go to **Moments** and then tap  to create a moment.
3. Enter the name of the moment (A).

TIP: You can choose the cover image that represents your moment by tapping .

4. Tap **Add actions** (B) to select the list of devices.

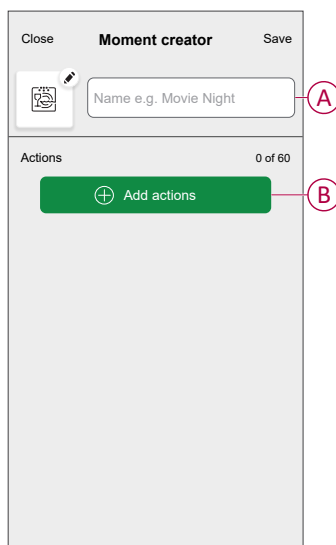

5. Select the devices (C) you want to set an action and tap **Done**.

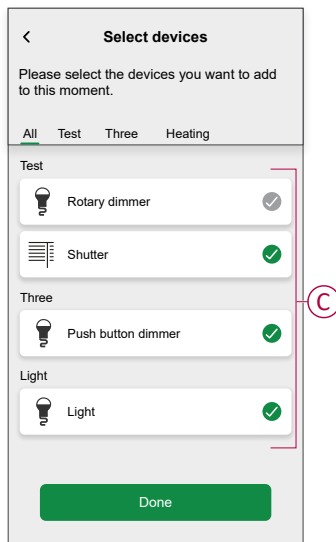

6. On the **Moment creator** page, select any one of the following device and set actions.

– **For shutter:**

- Drag the sliding bar up/down to open/close the shutter completely (D, E).
- Drag the sliding bar to keep the shutter in the preferred position.

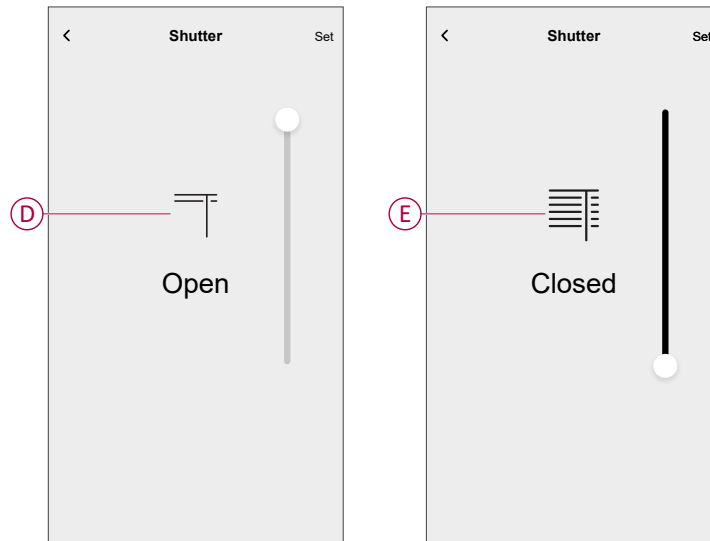

– **For Shutter slat:**

- Select **Position** (F) and drag the sliding bar up/down to open/close the shutter (G).
- Select **Slat Tilt** (F) and drag the sliding bar up/down to adjust the tilt position of the shutter (H).

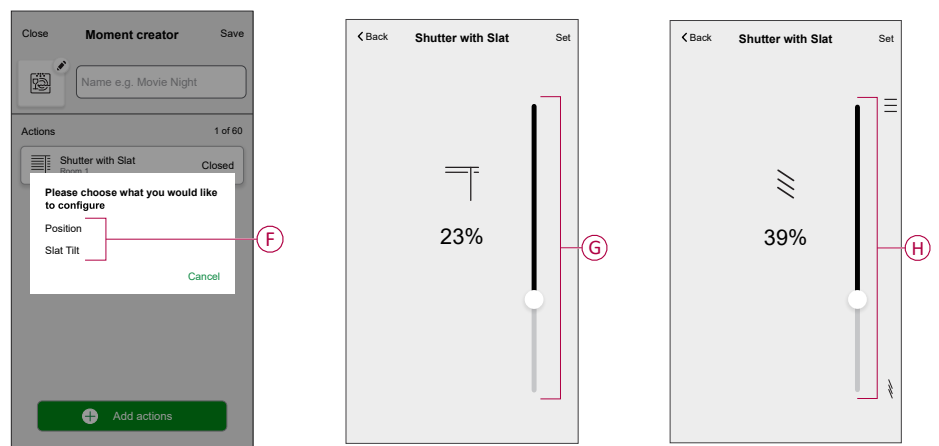





7. Tap **Set**.

8. Once all conditions are set, tap **Save**.

Once the moment is saved, it is visible on the **Moments** tab. You can tap on the moment to enable it.

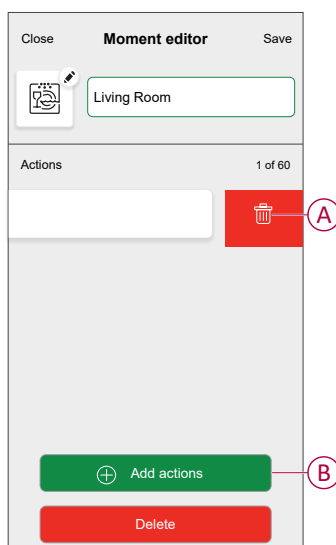

Editing a moment

1. On the **Home** page, tap .
2. Go to **Moments**, locate the moment you want to edit and tap .
3. On the **Moment editor** page, you can perform following changes:
 - Change the icon .
 - Rename the moment.
 - Tap each action to change the settings.
 - To remove an action, slide the action to the left and then tap  (A) to delete it.
 - Tap  **Add actions** (B) to add new action.



4. Tap **Save**, to save the changes.

Deleting a moment

1. On the **Home** page, tap .
2. Go to **Moments**, locate the moment you want to delete and tap .

3. On the Moment editor page, tap **Delete** (A) and then tap **Ok** (B).

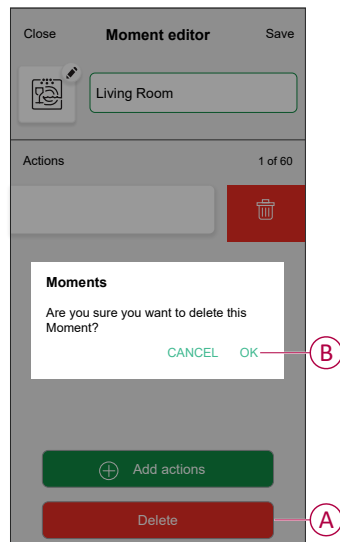

Creating an automation

Automation allows you to group multiple actions that are usually done together, triggered automatically or at scheduled times. By using the Wiser app, you can create automations based on your needs.

To create an automation:

1. On the **Home** page, tap .

2. Go to **Automation** >  to create an automation.

NOTE: Max. 10 automations can be added.

3. Tap  and choose an icon that best represents your automation.

4. Tap **If** (A) and select any of the following conditions (B):

- **All conditions:** This triggers an action only when all conditions are met.
- **Any condition:** This triggers an action when at least one condition is met.

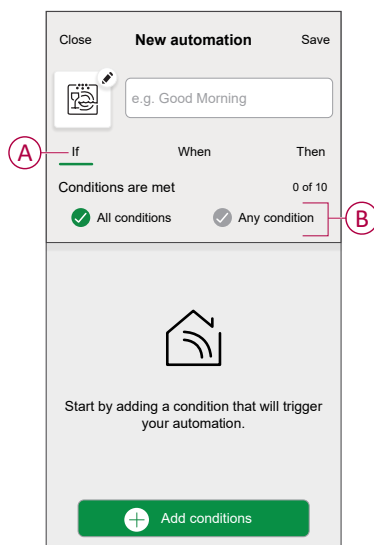

5. Tap **Add conditions** and select any of the following (C):

- **Device status change:** Select a device to enable automation.
- **Away Mode: Enable / Disable** away mode to trigger an action.

NOTE: Away mode can also be used as a trigger to turn off the lights, dimmer or closing the shutter etc. For more information refer to [Away mode](#).

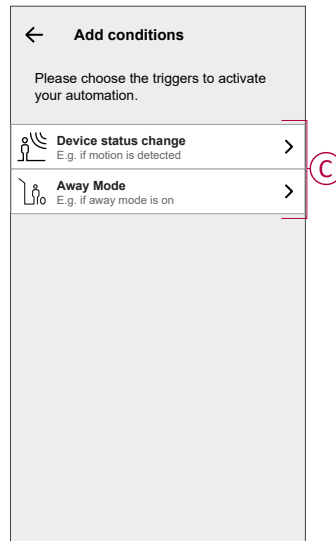



NOTE:

- Max. 10 conditions can be added.
- To remove condition, swipe left and tap .

6. To set a specific time for your automation, tap **When > Add time** and select any of the following (D):

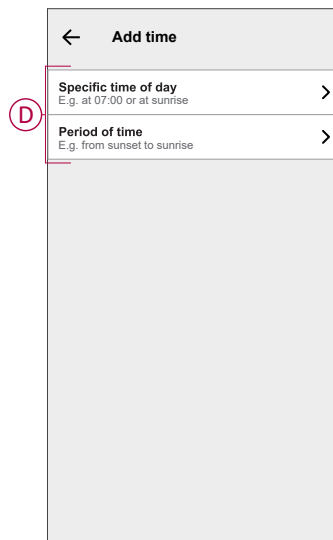
- **Specific time of the day:** Sunrise, Sunset, Custom
- **Period of time:** Daytime, Night time, Custom



NOTE: To remove a specific time, swipe left and tap .

7. To add an action, tap **Then > Add an action** and select any of the following (E):

- **Control a device:** Select a devices that you want to trigger.
- **Send notification:** Turn on the notification for the automation.
- **Activate a moment:** Select the moment that you want to trigger.

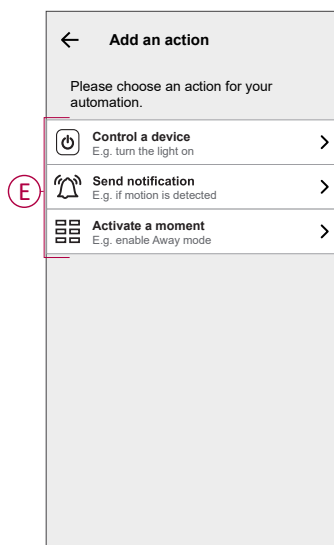

8. Tap **Control a device > Micromodule Shutter**.

Set the required opening/closing percentage or fully open/closed state using the sliding bar (F), then tap **Set**.

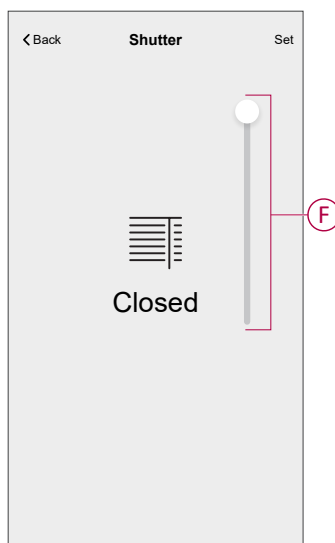

NOTE:

- Max. 10 actions can be added.
- To remove an action, swipe left on the action and tap .

9. Enter the automation name (G).

You can choose the cover image that represents your automation by tapping

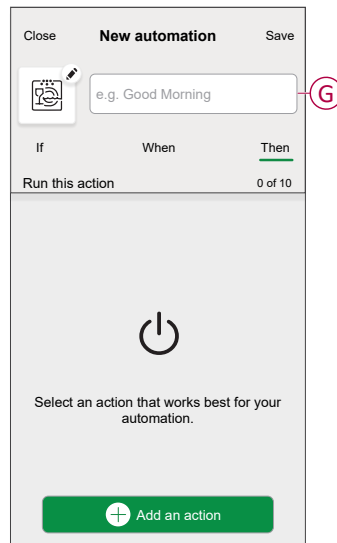

10. Tap **Save**.

Once the automation is saved, it is visible on the **Automation** tab.

Using the  (H) you can enable or disable the automation.

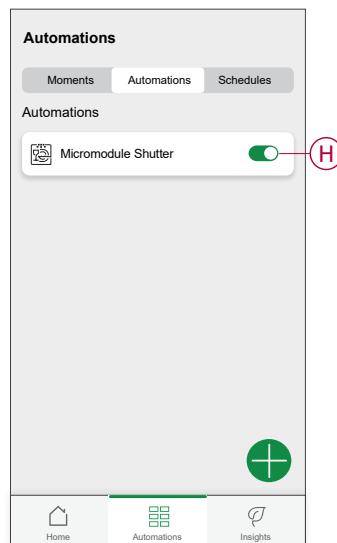

Example of an automation

This demonstration shows how to create an automation that closes the Shutter when the Door is open during Night time.

1. Go to **Automation** >  to create an automation.

- To add a condition, tap **Add Condition > Device status change > Door Sensor**, tap (A) to **Open**, then tap **Set**.

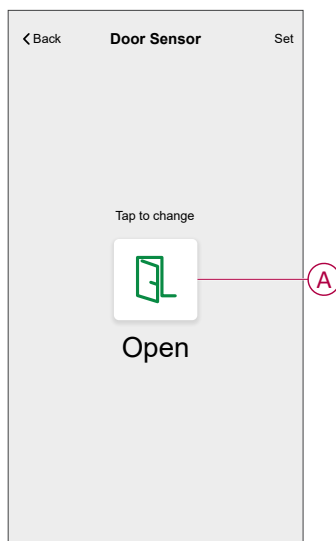

- Read the information and tap **OK**.
- To set the time, tap **When > Add time > Period of time > Night time > Set**.
- To add an action, tap **Then > Add an action > Control a device > Micromodule Shutter > Set** (B).

TIP: You can set the required opening/closing percentage or fully open/closed state using the sliding bar.

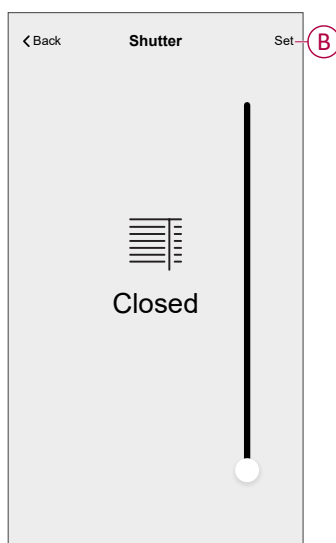

- Read the information and tap **OK**.
- Enter the name of the automation.

TIP: You can choose the cover image that represents your automation by tapping .



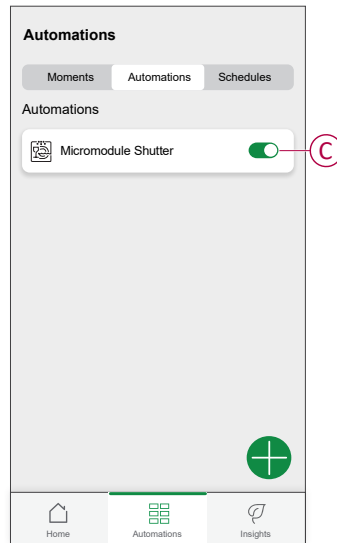

8. Tap **Save**.

Once the automation is saved, it is visible on the **Automation** tab.

NOTE: You can enable or disable automations on the **Automation** tab by using  (C).



Editing an automation

1. On the **Home** page, tap .
2. Go to **Automation**, tap the automation you want to edit.
3. On the **Edit automation** page, you can perform following changes:
 - Change the icon .
 - Rename the automation.
 - Tap each condition to change the settings.
 - To remove a condition, slide the condition towards left and then tap  (A) to delete it.
 - Tap  **Add conditions** (B) to add new condition.

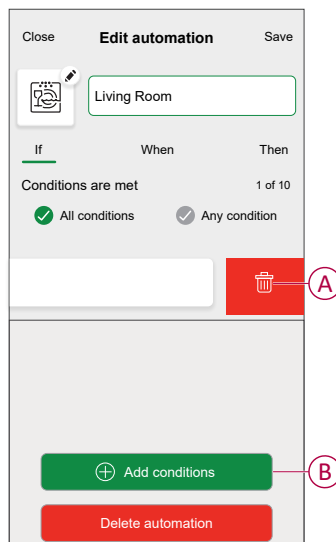

4. Tap **Save** , to save the changes.

Deleting an automation

1. On the **Home** page, tap .
2. Go to **Automation**, tap the automation you want to delete.

- On the **Edit automation** page, tap **Delete automation** (A) and read the confirmation message and then tap **OK** (B).

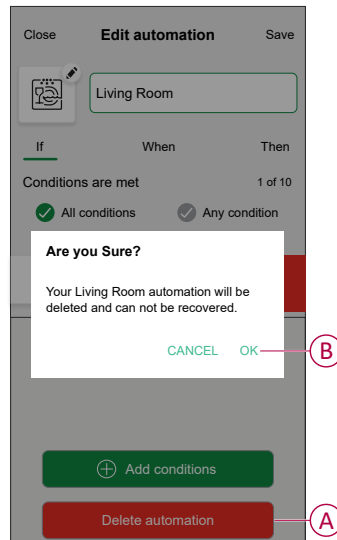

Removing the device from Wiser system

Using the Wiser app, you can remove the Puck from the system.

- On the Home page, tap .
- Tap **Devices > Shutters > Micromodule Shutter** or **Shutter slat > Delete** (A).

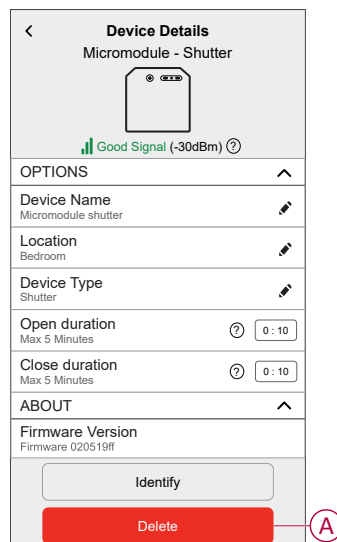

NOTE:

- Removing the device will reset the Puck. The LED starts blinking amber indicating that the Puck is ready to pair.
- If there is a problem while pairing or resetting the Puck, refer to **Resetting the device manually**, page 39.

Resetting the device manually

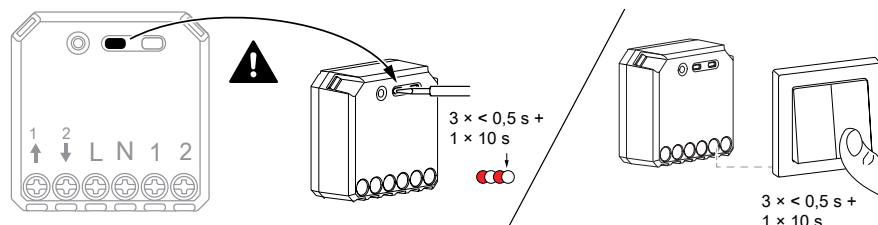

Select any one of the options to reset the device to factory default mode:

- Short press the Setup/Reset button 3 times and then long press the Setup/Reset button once for 10 s on the puck with a screwdriver.
- Short press the push button 3 times and then long press the push button once for 10 s.





LED indication

Pairing the device



| User Action | LED Indication | Status |
|--|--|---|
| Short press the setup/reset button or push button 3 times. | LED blinks amber once per second.  | Pairing mode is active for 30 seconds. When pairing is completed, LED displays green for a few seconds before turning Off.  |

Resetting the device

| User Action | LED Indication | Status |
|---|--|--|
| Short press the setup/reset button or push button 3 times and hold it down once for > 10 s. | LED blinks red once per second.  | The device is in reset mode. The device then restarts and LED turns amber indicating that the device is ready for pairing.  |

Troubleshooting

| Symptom | Solution |
|---|---|
| No shutter movement or uncontrolled shutter movement. | <ul style="list-style-type: none"> • Check power supply. • Check the wiring between Puck and push-button switch.. • Check the load |
| The device is not ready to pair after the device is removed from the app. | Reset to factory default settings, refer to Resetting the device manually , page 39 |

| Symptom | Possible cause | Solution |
|--|---------------------------|--|
| The device is not able to connect with the Hub. After pressing 3 times, the device LED blinks green/red for 30 s.  NOTE: This does not apply to newer Zigbee® model. | Pairing mode has changed. | <ol style="list-style-type: none"> 1. Factory reset the device. 2. After reset, press top right corner of the switch for 4 times and then hold for 20 s, until the LED blinks red.  The device should reboot into the correct mode. 3. After reboot, press 3 times on top right corner of the switch to initiate pairing mode. LED flashes orange.  |

Technical data

| | |
|---|--|
| Nominal voltage | AC 220-240 V, 50/60 Hz |
| Nominal current | 4 A, $\cos\phi = 0.6 - 1.0$ |
| Blind channel | 1, mechanically and electronically locked against each other |
| Standby | Max. 0.3 W |
| Operating Temperature | 0 °C to 35 °C |
| Neutral conductor | Required |
| Connecting terminals | Max. 2 x 2.5 mm ² , solid or stranded types |
| Extension connection | Max. 10 mechanical double push-button switches |
| Length of all cable sections | Max. 50 m for 3-wire NYM cable |
| Fuse protection | 16 A circuit breaker |
| Operating frequency | 2405 - 2480 MHz |
| Max. radio-frequency power transmitted | <10 mW |
| IP rating | IP20 |
| Product dimensions (H x W x D) | 43 x 43 x 22 mm |
| Communication protocol | Zigbee 3.0 certified |

Compliance

Compliance information for Green Premium products

Find and download comprehensive information about Green Premium products, including RoHS compliance and REACH declarations as well as Product Environmental Profile (PEP) and End-of-Life instructions (EOL).

<https://checkaproduct.se.com/>



General information about Green Premium products

Click the link below to read about Schneider Electric's Green Premium product strategy.

<https://www.schneider-electric.com/en/work/support/green-premium/>



EU Declaration of Conformity

Hereby, Schneider Electric Industries, declares that this product is in compliance with the essential requirements and other relevant provisions of RADIO DIRECTIVE 2014/53/EU. Declaration of conformity can be downloaded on se.com/docs.

Trademarks

This guide makes reference to system and brand names that are trademarks of their relevant owners.

- Zigbee® is a registered trademark of the Connectivity Standards Alliance.
- Apple® and App Store® are brand names or registered trademarks of Apple Inc.
- Google Play™ Store and Android™ are brand names or registered trademarks of Google Inc.
- Wi-Fi® is a registered trademark of Wi-Fi Alliance®.
- Wiser™ is a trademark and the property of Schneider Electric, its subsidiaries and affiliated companies.
- Amazon Alexa™ is a trademark of AMAZON TECHNOLOGIES, INC.
- Google Home™ is a trademark of Google INC.

Other brands and registered trademarks are the property of their respective owners.

Printed in:
Schneider Electric
35 rue Joseph Monier
92500 Rueil Malmaison - France
+ 33 (0) 1 41 29 70 00

Schneider Electric
35 rue Joseph Monier
92500 Rueil Malmaison
France

+ 33 (0) 1 41 29 70 00

www.se.com

As standards, specifications, and design change from time to time,
please ask for confirmation of the information given in this publication.

© 2021 – 2024 Schneider Electric. All rights reserved.

DUG_Micro Module Shades Control_WH-04