

	www.se.com	en Schneider Charge Pro - Spare Part Replacement Guide
	BRU8418000	

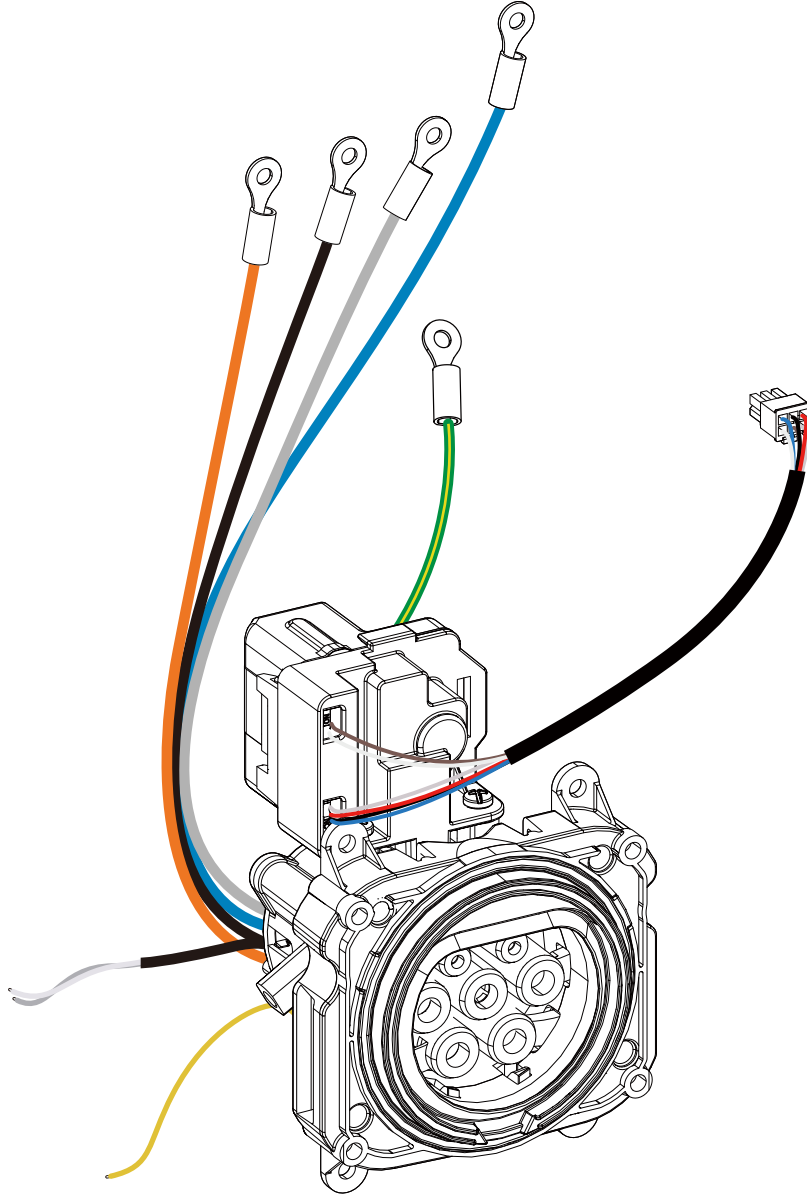

EVP2SSS43

Customer Care Center

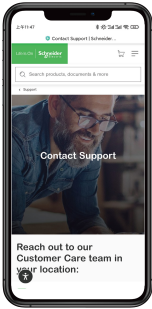

Safety	3
1 Switching off the charging station	4
2 Spare part compatibility chart	5
2.1 Commercial references	5
2.2 Equipment not supplied	5
3 Replacement procedure	5
3.1 Disassembling	5
3.2 Assembling	17
4 Power on	28
5 Test after replacement	28
6 Recycling packaging	28

The information provided in this document contains general descriptions, technical characteristics and/or recommendations related to products/solutions.

This document is not intended as a substitute for a detailed study or operational and site-specific development or schematic plan. It is not to be used for determining suitability or reliability of the products/solutions for specific user applications. It is the duty of any such user to perform or have any professional expert of its choice (integrator, specifier or the like) perform the appropriate and comprehensive risk analysis, evaluation and testing of the products/solutions with respect to the relevant specific application or use thereof.

The Schneider Electric brand and any trademarks of Schneider Electric SE and its subsidiaries referred to in this document are the property of Schneider Electric SE or its subsidiaries. All other brands may be trademarks of their respective owner.

This document and its content are protected under applicable copy right laws and provided for informative use only. No part of this document may be reproduced or transmitted in any form or by any means (electronic, mechanical, photocopying, recording, or otherwise), for any purpose, without the prior written permission of Schneider Electric.

Schneider Electric does not grant any right or license for commercial use of the document or its content, except for a non-exclusive and personal license to consult it on an "as is" basis.

Schneider Electric reserves the right to make changes or updates with respect to or in the content of this document or the format thereof, at any time without notice.

Electrical equipment should be installed, operated, serviced, and maintained only by qualified personnel. No responsibility is assumed by Schneider Electric for any consequences arising out of the use of this material.

To the extent permitted by applicable law, no responsibility or liability is assumed by Schneider Electric and its subsidiaries for any errors or omissions in the informational content of this document, as well as any non-intended use or misuse of the content thereof.

Safety

Important Information



Read these instructions carefully, and look at the equipment to become familiar with the device before trying to install, operate, or maintain it. The following special messages may appear throughout this documentation or on the equipment to warn of potential hazards or to call attention to information that clarifies or simplifies a procedure.



The addition of this symbol to a "Danger" or "Warning" safety label indicates that an electrical hazard exists which will result in personal injury if the instructions are not followed.



This is the safety alert symbol. It is used to alert you to potential personal injury hazards. Obey all safety messages that follow this symbol to avoid possible injury or death.

⚠ DANGER

DANGER indicates a hazardous situation which, if not avoided, **will result** in death or serious injury.

⚠ WARNING

WARNING indicates a hazardous situation which, if not avoided, **could result** in death or serious injury.

⚠ CAUTION

CAUTION indicates a hazardous situation which, if not avoided, **could result** in minor or moderate injury.

NOTICE

NOTICE is used to address practices not related to physical injury.

⚠ ⚠ WARNING

RISK OF INJURY OR DAMAGING THE CHARGING STATION

- Electrical equipment should be installed, operated, serviced, and maintained only by qualified personnel. No responsibility is assumed by Schneider Electric for any consequences arising out of the use of this material.
- A qualified person is one who has skills and knowledge related to the construction, installation, and operation of electrical equipment and its installation and has received safety training to recognize and avoid the hazards involved.

Failure to follow these instructions could result in death, serious injury, or equipment damage.

1

Switching off the charging station

⚠ ⚠ DANGER

HAZARD OF ELECTRIC SHOCK, EXPLOSION OR ARC FLASH

- Turn off all power supplying this equipment before working on the charging station.
- On some charging stations more than one power supply must be switched off.
- Use a Voltage Tester (VT) of appropriate rating.
- Do not install the product under bad weather condition without adequate protections.

Failure to follow these instructions will result in death or serious injury.

NOTICE

HAZARD OF ELECTROSTATIC DISCHARGE OR POWER SURGE

- Do not plug or unplug the connectors inside the charging station by force.
- Do not touch the electronic boards by hand or with a tool (e.g. screwdriver).
- Use anti-static protection when making connection operations inside the charging station.

Failure to follow these instructions could result in equipment damage.

Locate the protection device that allows the charging station to be disconnected from power on the wiring diagram and disconnect it.
(As marked by the green frames in below diagrams.)

380-415V 3-phase With Neutral

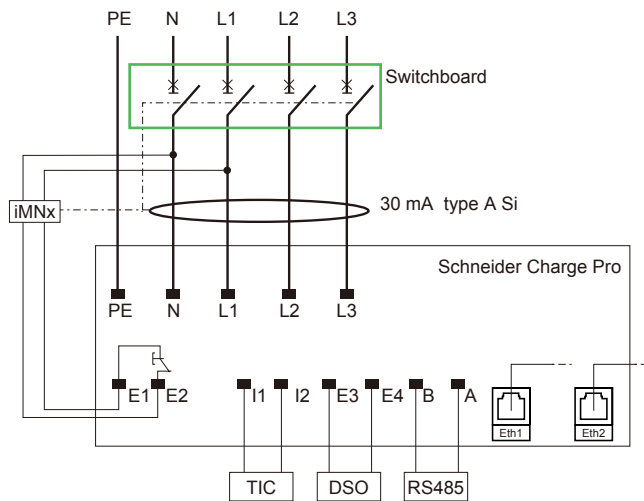

220-240V 3-phase No Neutral

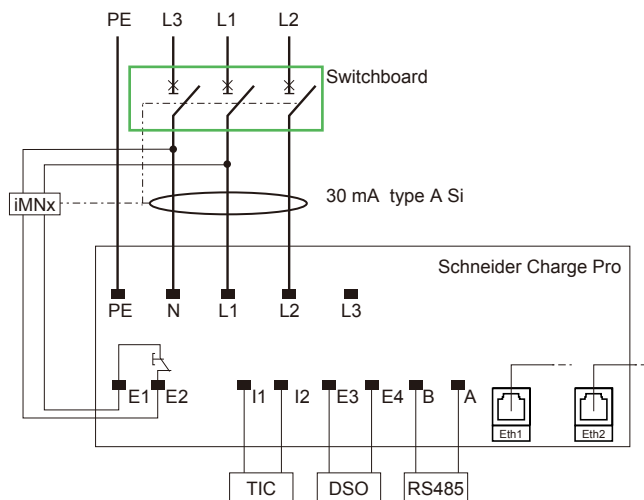

iMNx: Undervoltage release

2 Spare part compatibility chart

2.1 Commercial references

Commercial Reference	Number of Phase	Current output	Power Rating (kW)	T2S Socket
EVB4S22N40M	1/3	32A	7/11/22	✓
EVB4S22N40	1/3	32A	7/11/22	✓
EVB4S22NC0M	1/3	32A	7/11/22	
EVB4S22NC0	1/3	32A	7/11/22	
EVB4S22N40MG	1/3	32A	7/11/22	✓
EVB4S22N40G	1/3	32A	7/11/22	✓
EVB4S22NC0MG	1/3	32A	7/11/22	
EVB4S22NC0G	1/3	32A	7/11/22	

2.2 Equipment not supplied

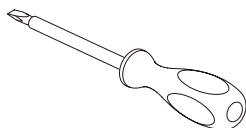

2 mm/0,8 in
4 mm/1,6 in

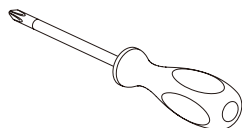

PH2

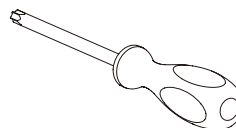

T20 security

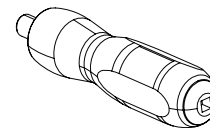

0,5 Nm - 3,5 Nm
Torque driver

3 Replacement procedure

3.1 Disassembling

⚠ ⚠ DANGER

HAZARD OF ELECTRIC SHOCK, EXPLOSION OR ARC FLASH

- Turn off all power supplying this equipment before working on the charging station.
- On some charging stations more than one power supply must be switched off.
- Use a Voltage Tester (VT) of appropriate rating.
- Do not install the product under bad weather condition without adequate protections.

Failure to follow these instructions will result in death or serious injury.

3 Replacement procedure

3.1 Disassembling

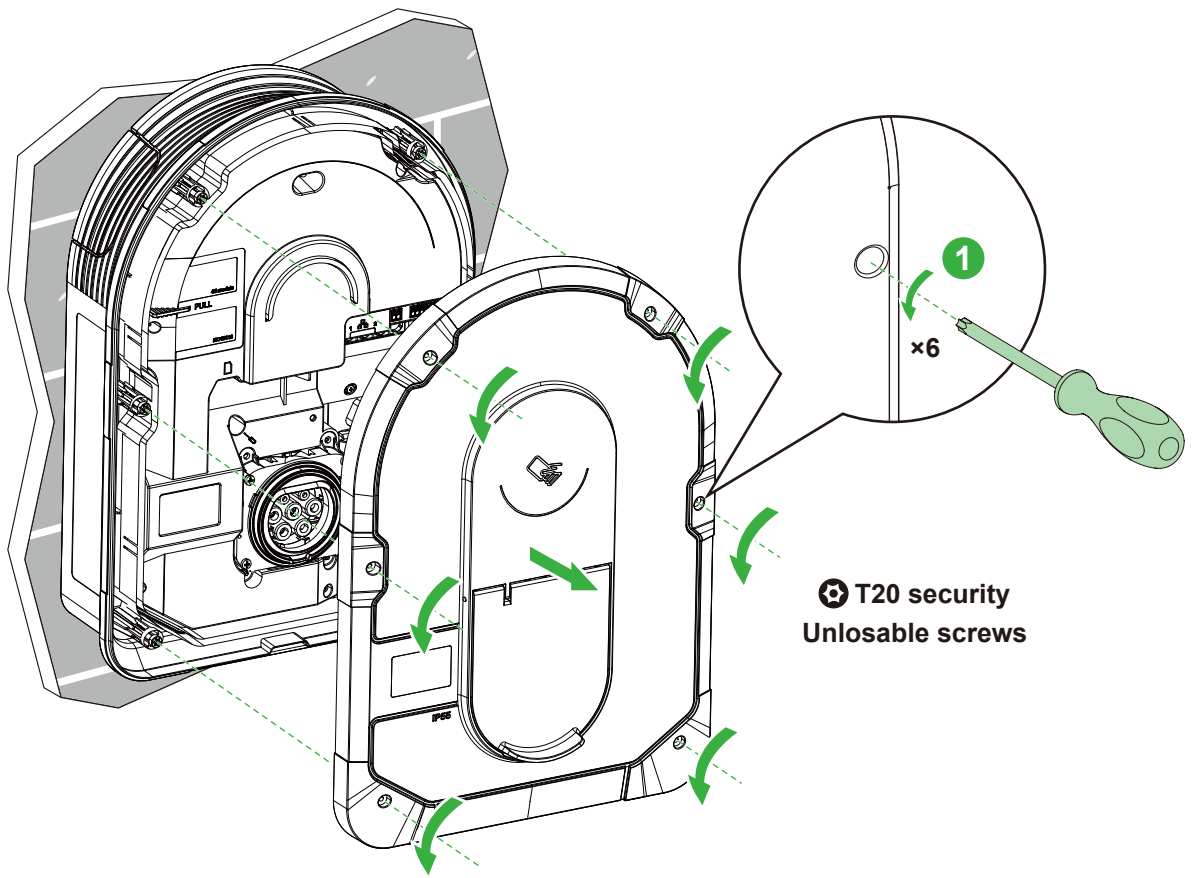

3 Replacement procedure

3.1 Disassembling

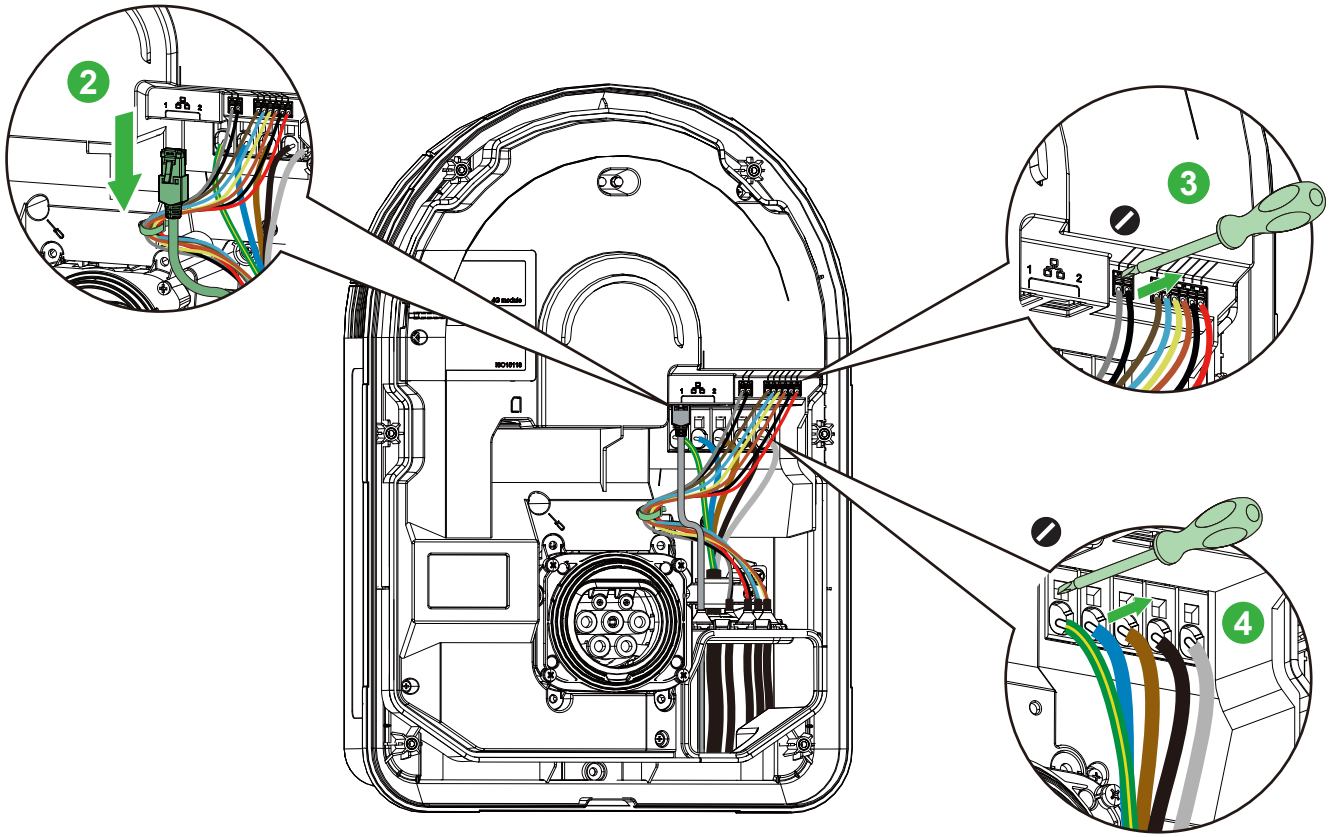

3 Replacement procedure

3.1 Disassembling

i In step of 5, loose the clamp but do not need to remove it completely, just enable the cable to be pulled out.

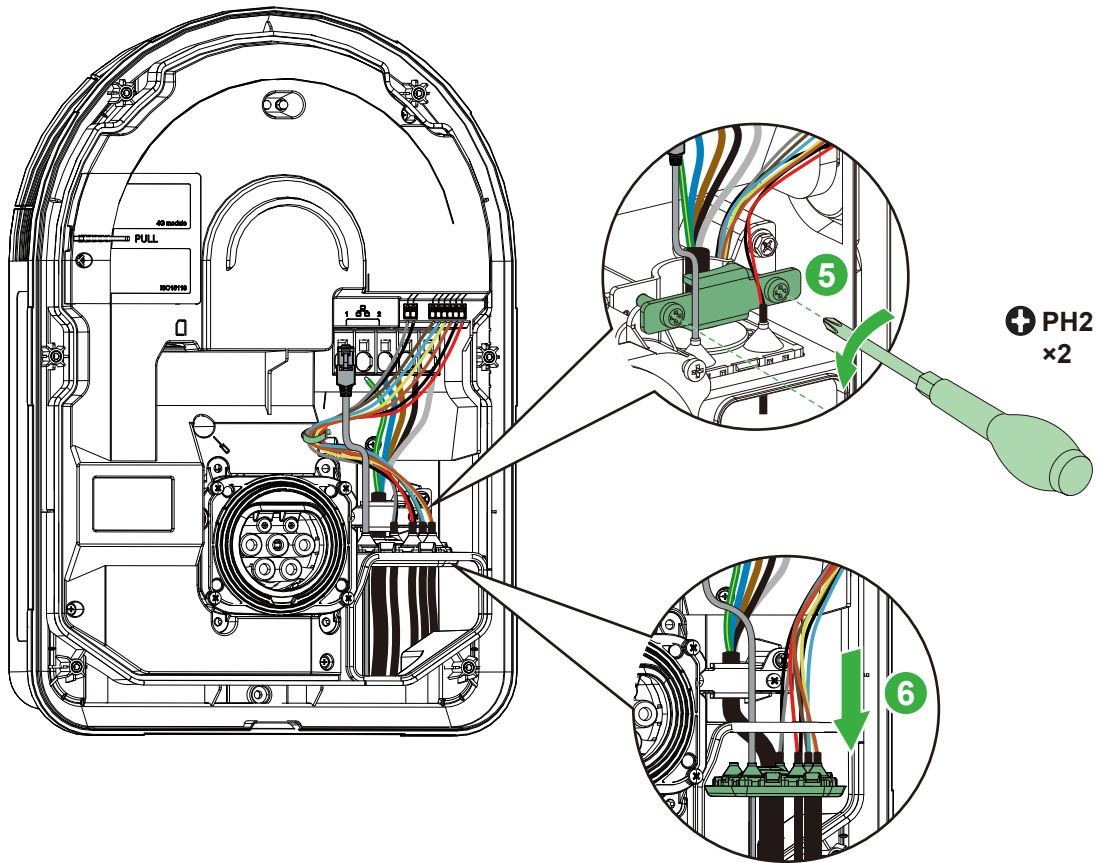

3 Replacement procedure

3.1 Disassembling

i In step of 7, pry up from its edge and then pull out the cover.

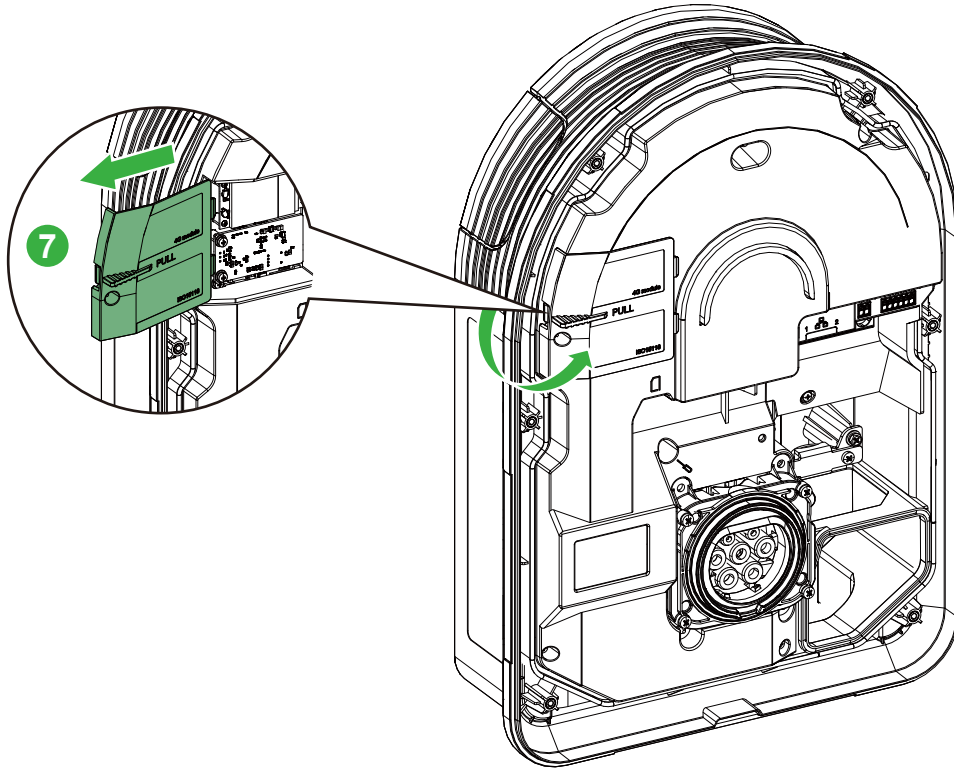

i In step of 8, disconnect the antennas and mark the antennas according to their connection position.

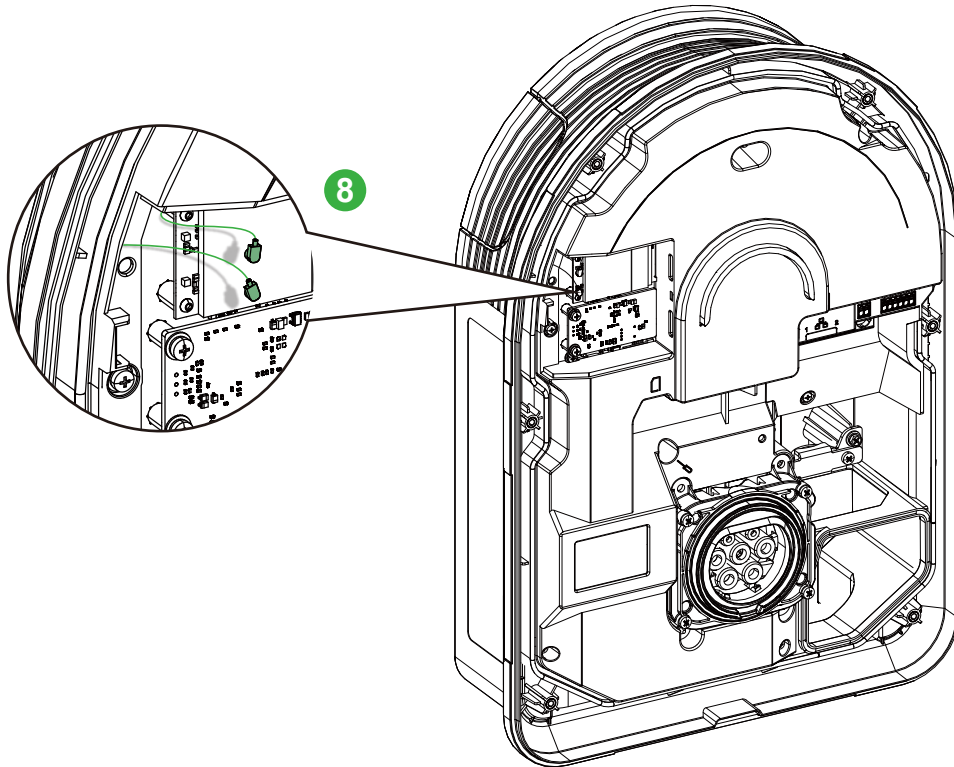

3 Replacement procedure

3.1 Disassembling

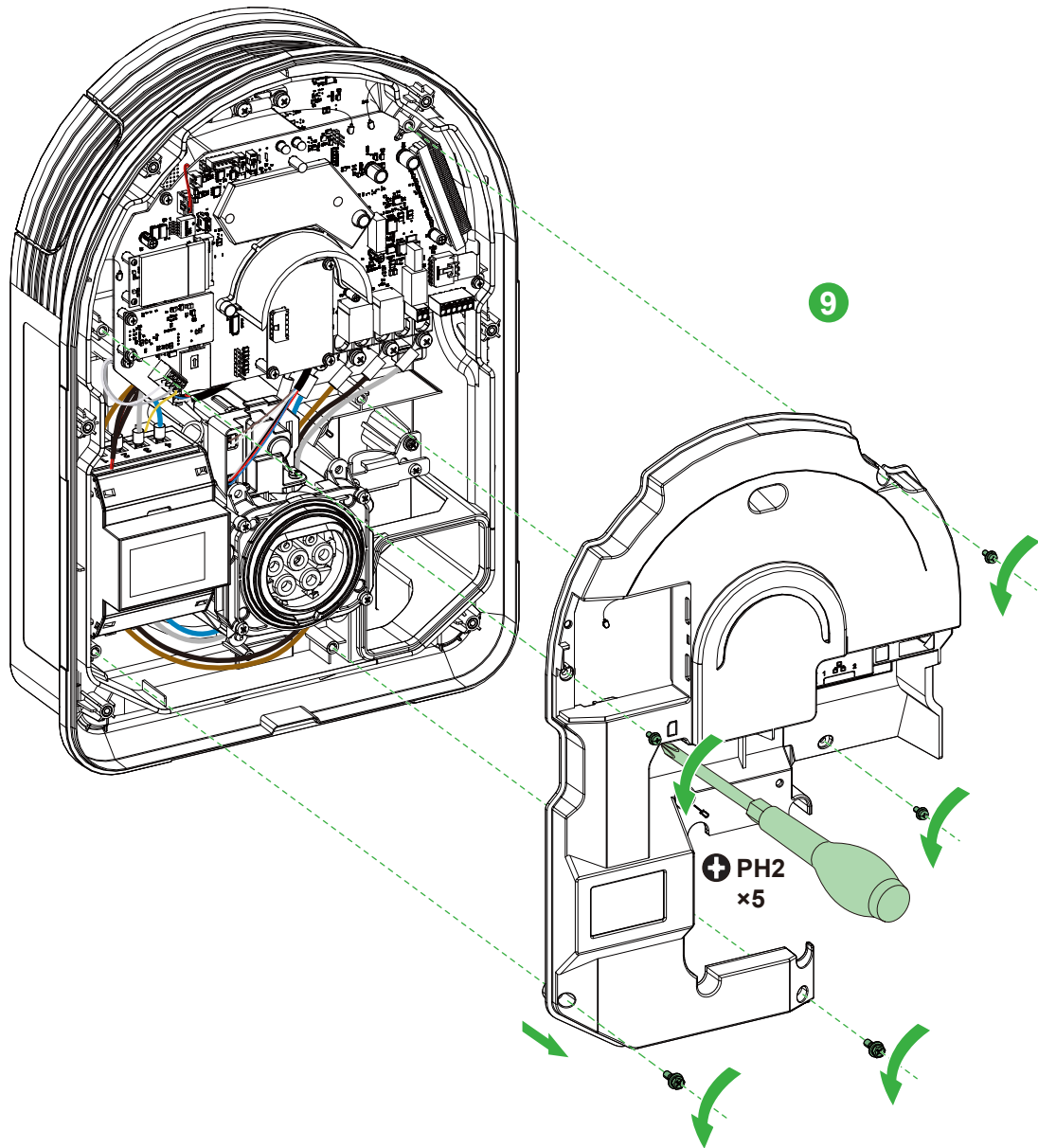

3 Replacement procedure

3.1 Disassembling

i In step of 12, disconnect the antennas and mark the antennas according to their connection position.

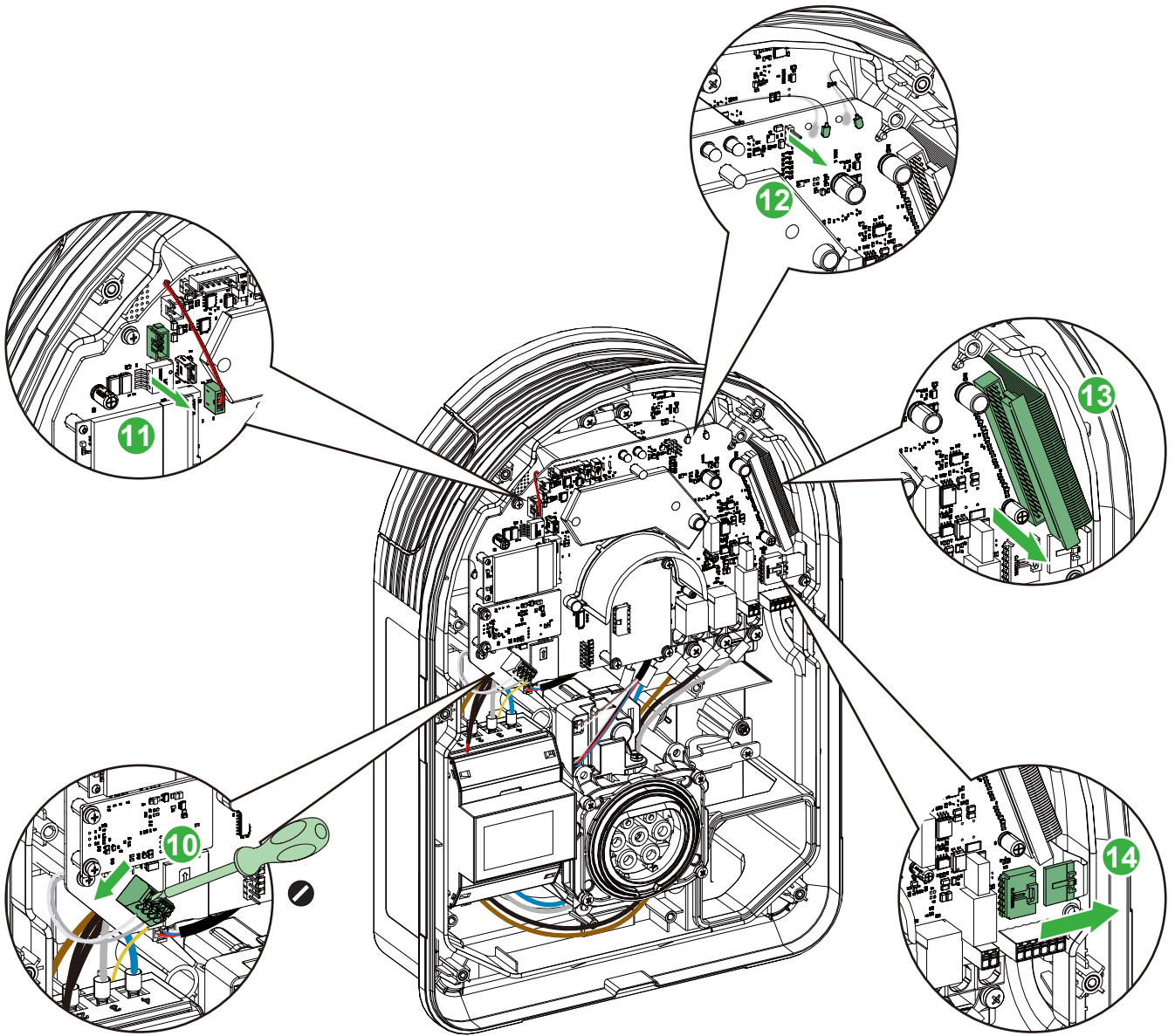

3 Replacement procedure

3.1 Disassembling

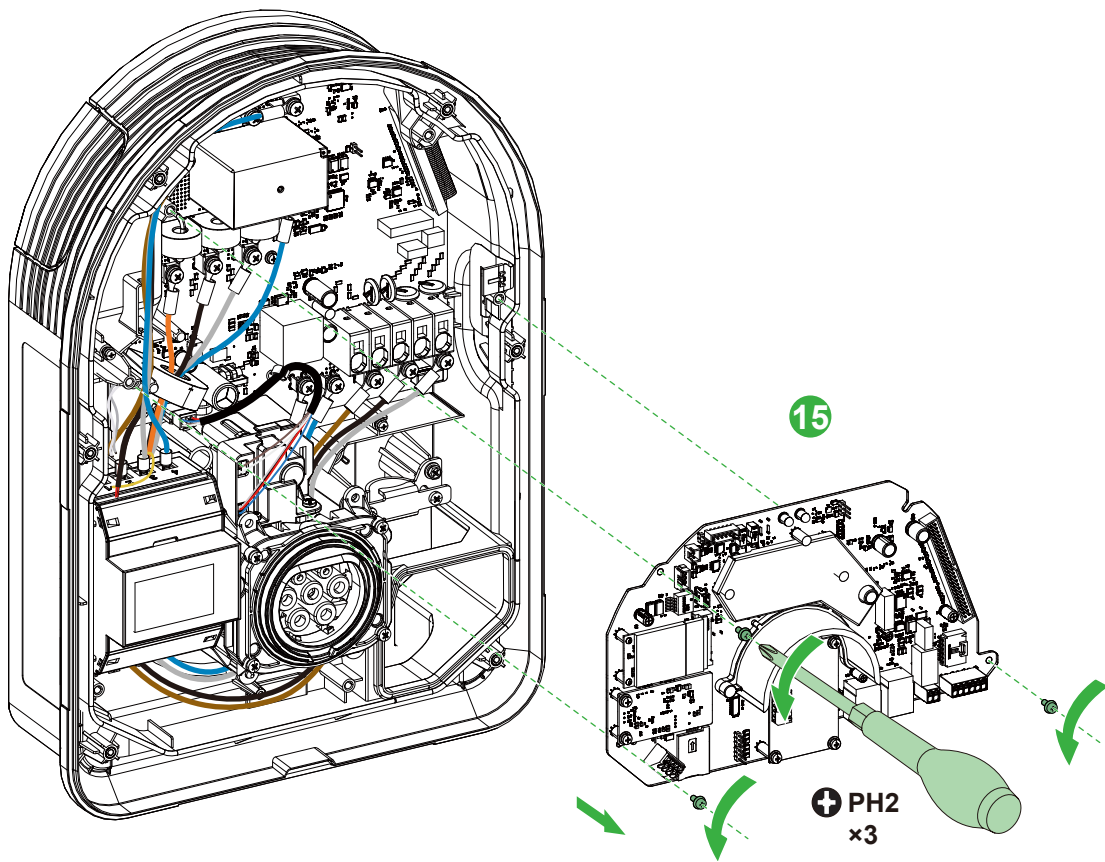

3 Replacement procedure

3.1 Disassembling

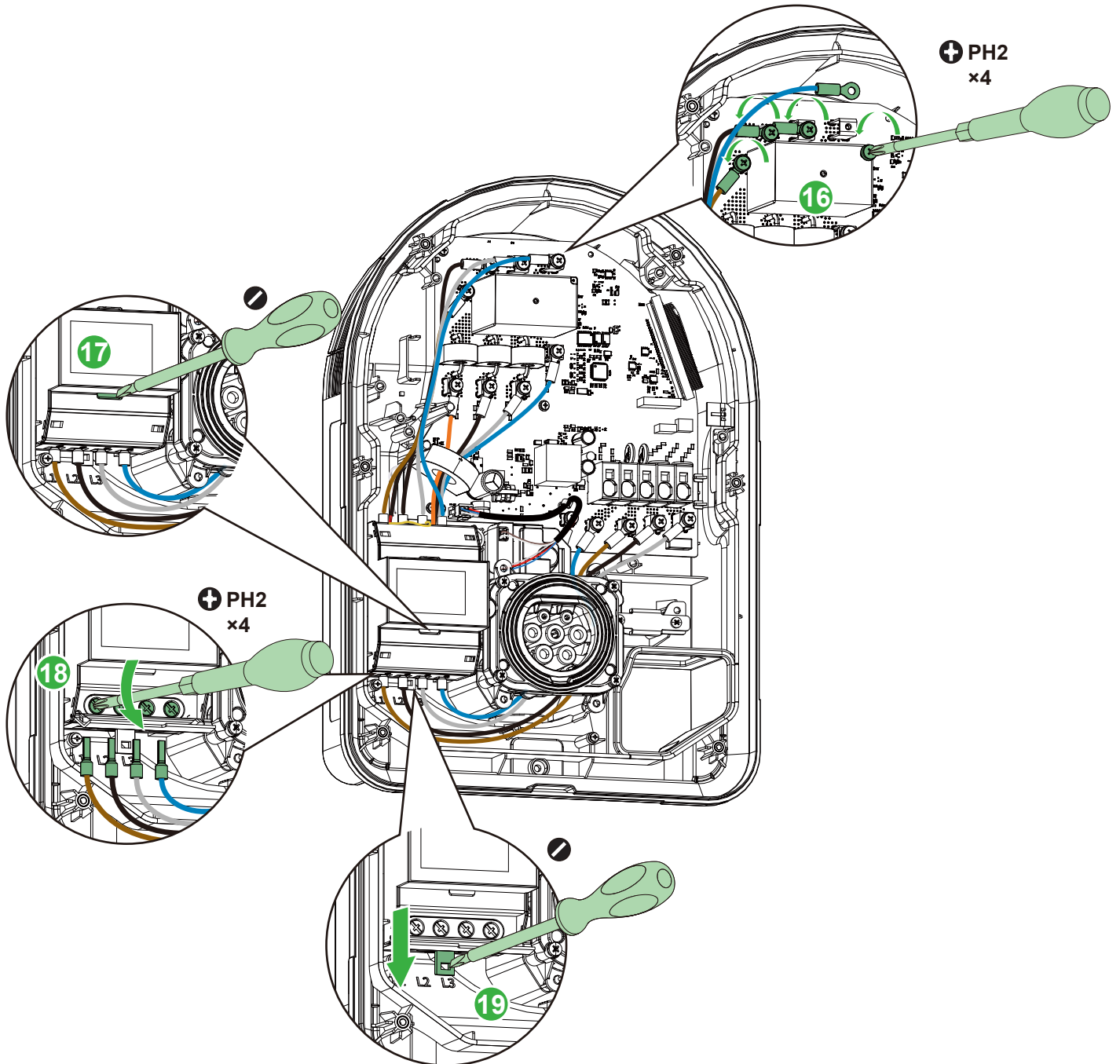

3 Replacement procedure

3.1 Disassembling

i In step of 20, pull out the bottom of the meter so that it is at an actual angle to the charging station and then move it out upwards.

20

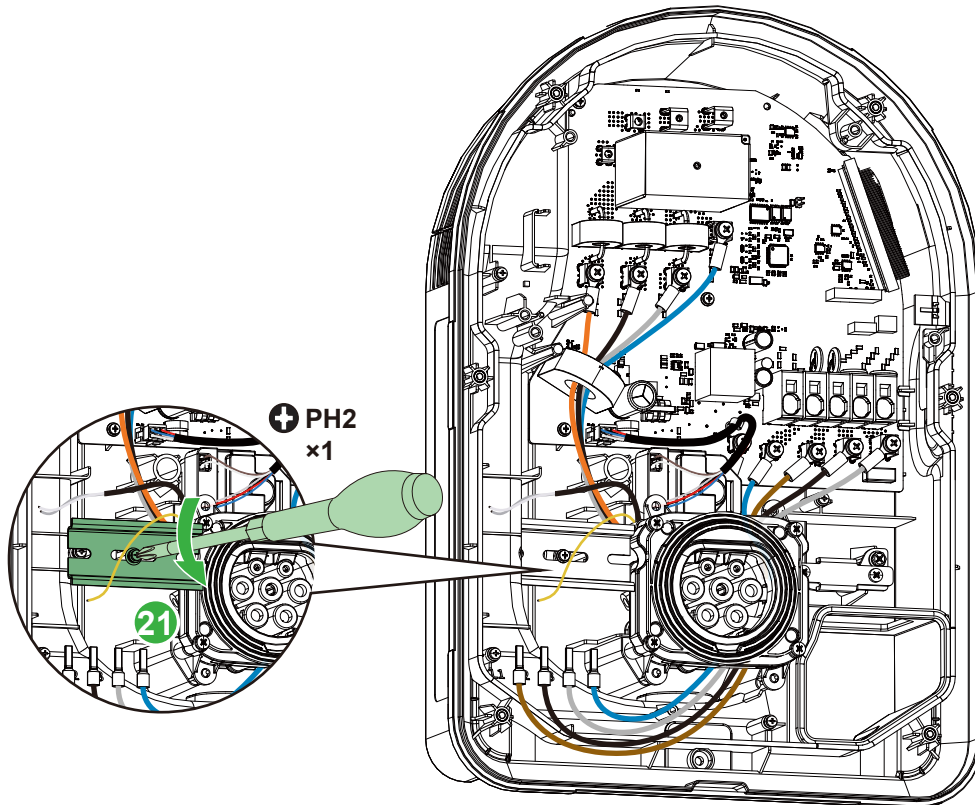
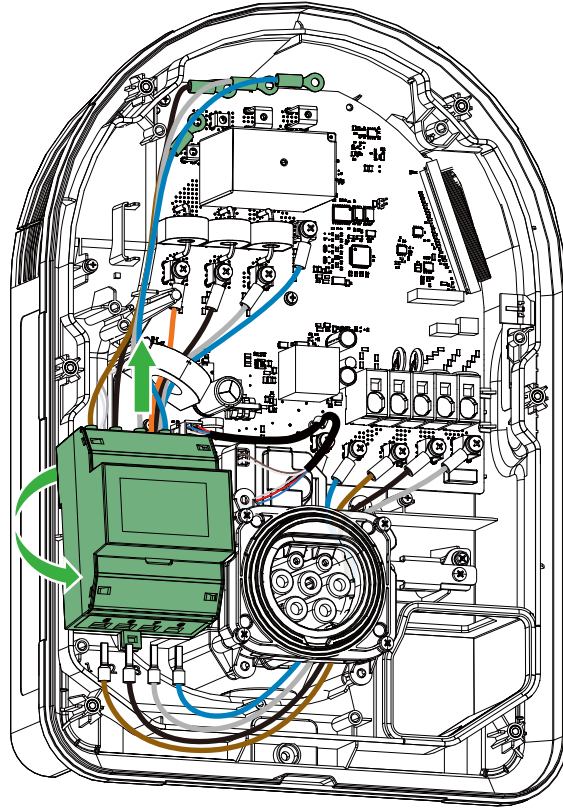

3 Replacement procedure

3.1 Disassembling

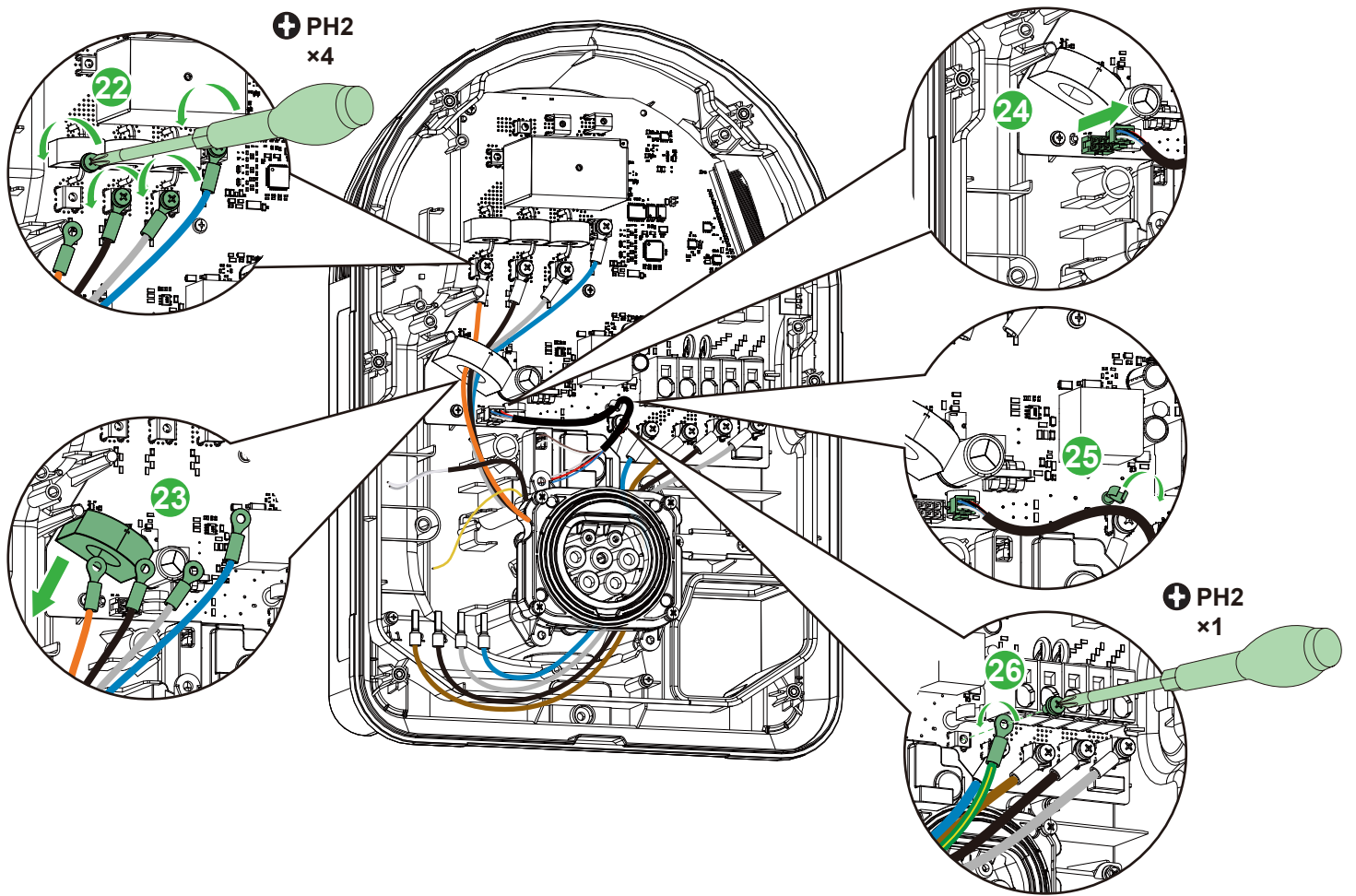

3 Replacement procedure

3.1 Disassembling

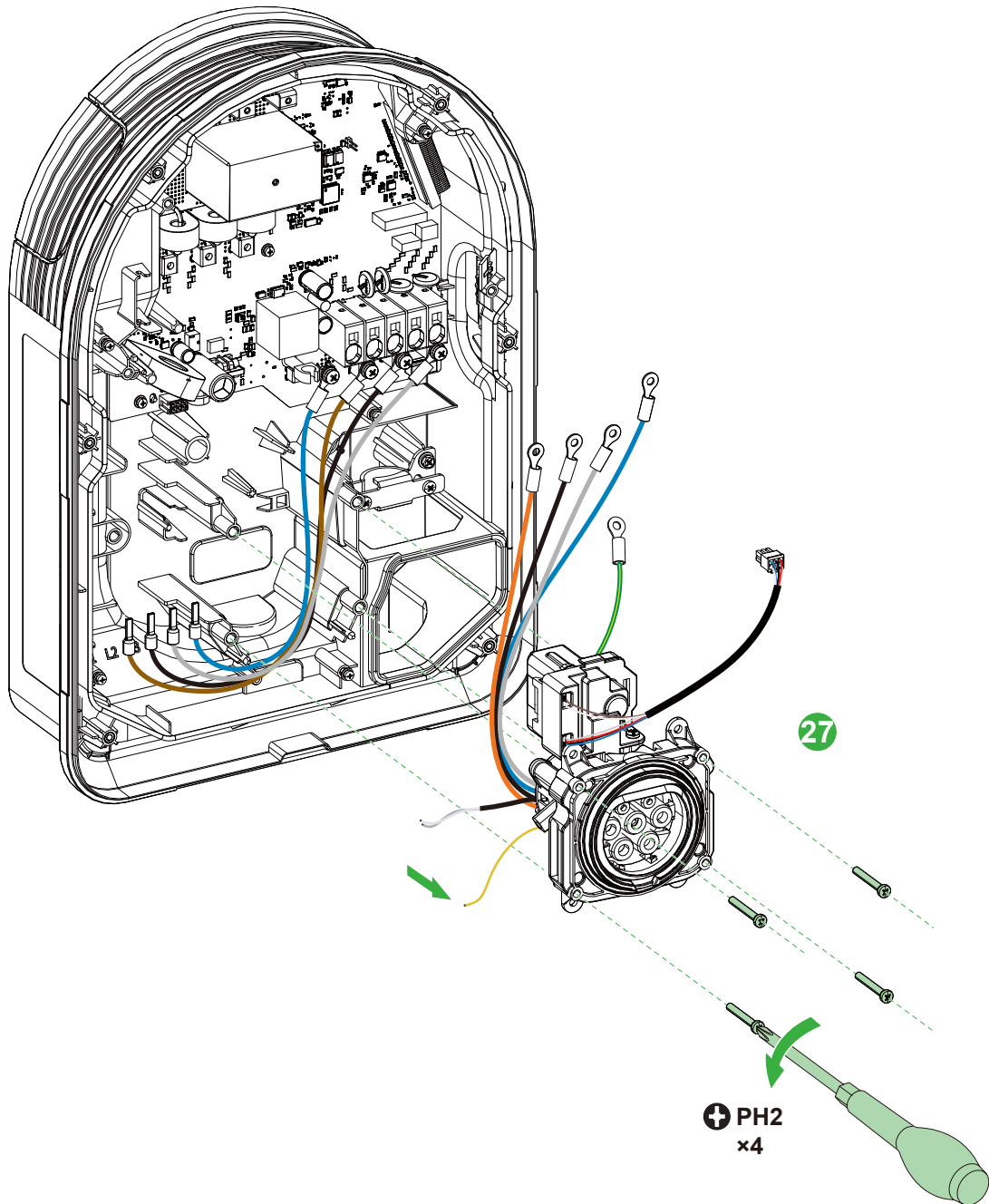

3 Replacement procedure

3.2 Assembling

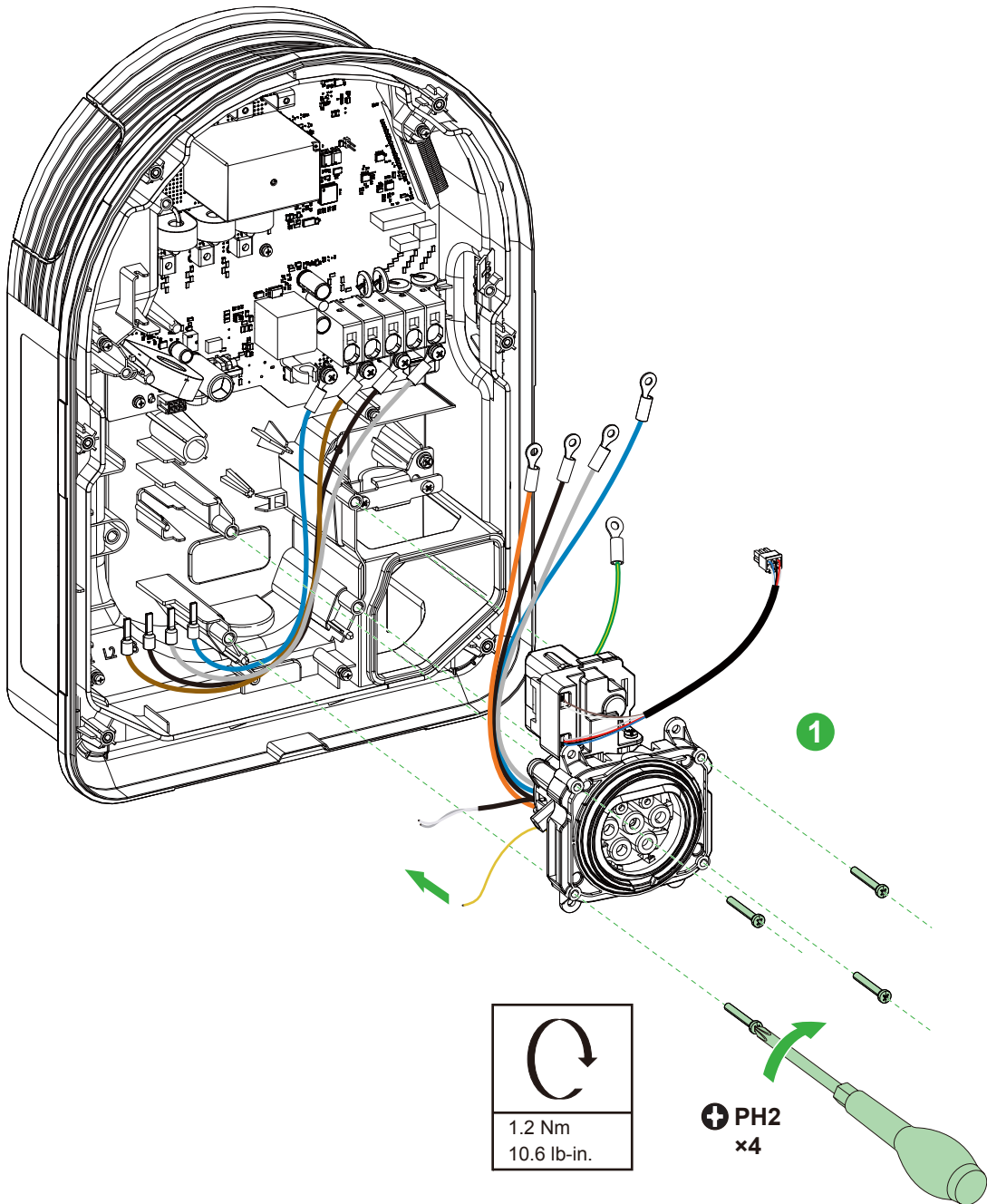

3 Replacement procedure

3.2 Assembling

i In step of 2 and 6, wiring should be performed according to the following table.

Cable Color	Brown	Black	Grey	Blue
Connection	L1	L2	L3	N

⚠ ⚠ DANGER

HAZARD OF ELECTRIC SHOCK, EXPLOSION OR ARC FLASH

After completing step of 2, test and ensure continuity of the PE connector before powering on the charging station.

Failure to follow these instructions will result in death or serious injury.

⚠ ⚠ WARNING

RISK OF INJURY OR DAMAGING THE CHARGING STATION

In step of 5, L1, L2, L3 and N wires should go through the current loop.

Failure to follow these instructions could result in death, serious injury, or equipment damage.

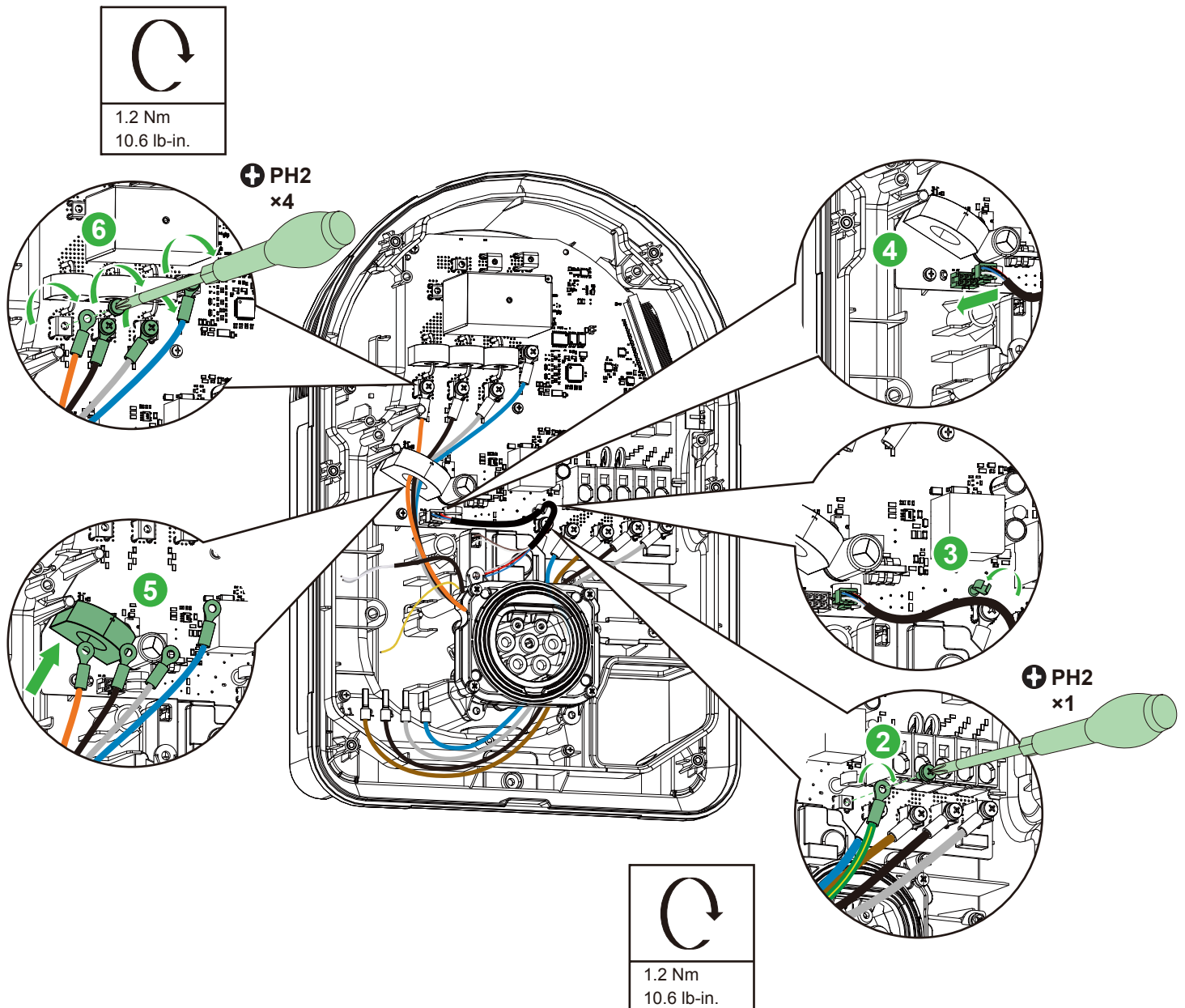

3 Replacement procedure

3.2 Assembling

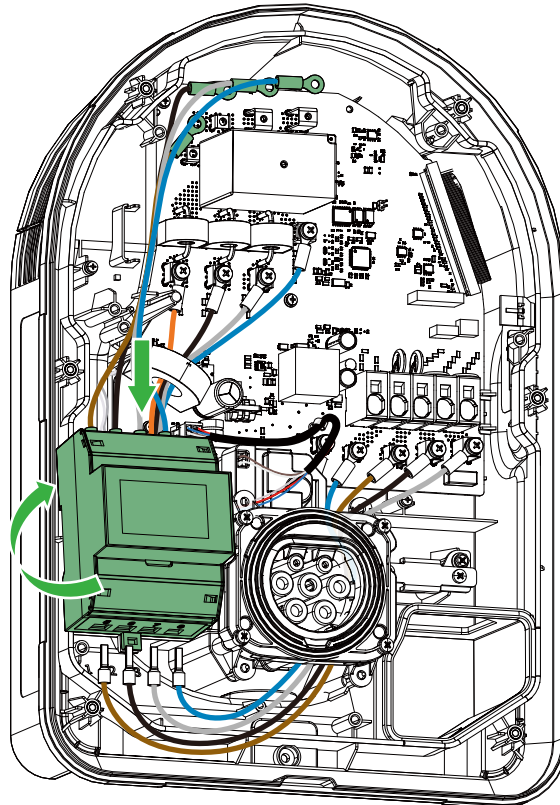
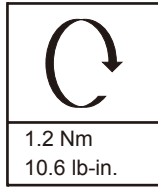
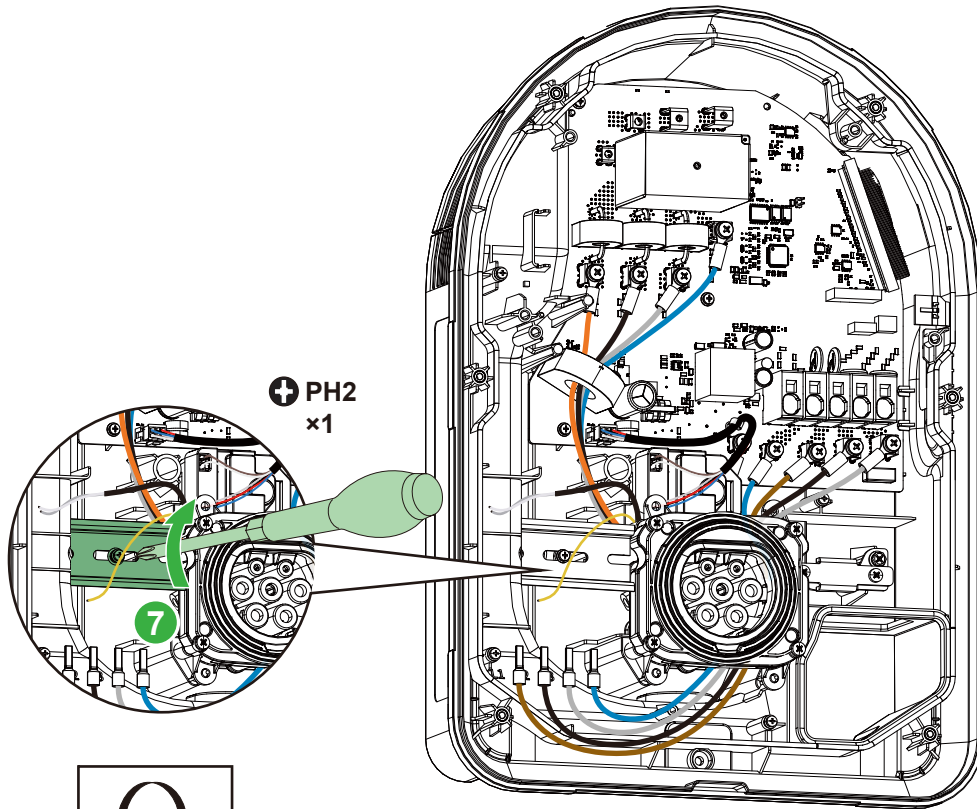

3 Replacement procedure

3.2 Assembling

i In step of 11 and 12, wiring should be performed according to the following table.

Cable Color	Brown	Black	Grey	Blue
Connection	L1	L2	L3	N

i After step of 11, check whether pulling wires could unplug them from meter to ensure a secure connection.

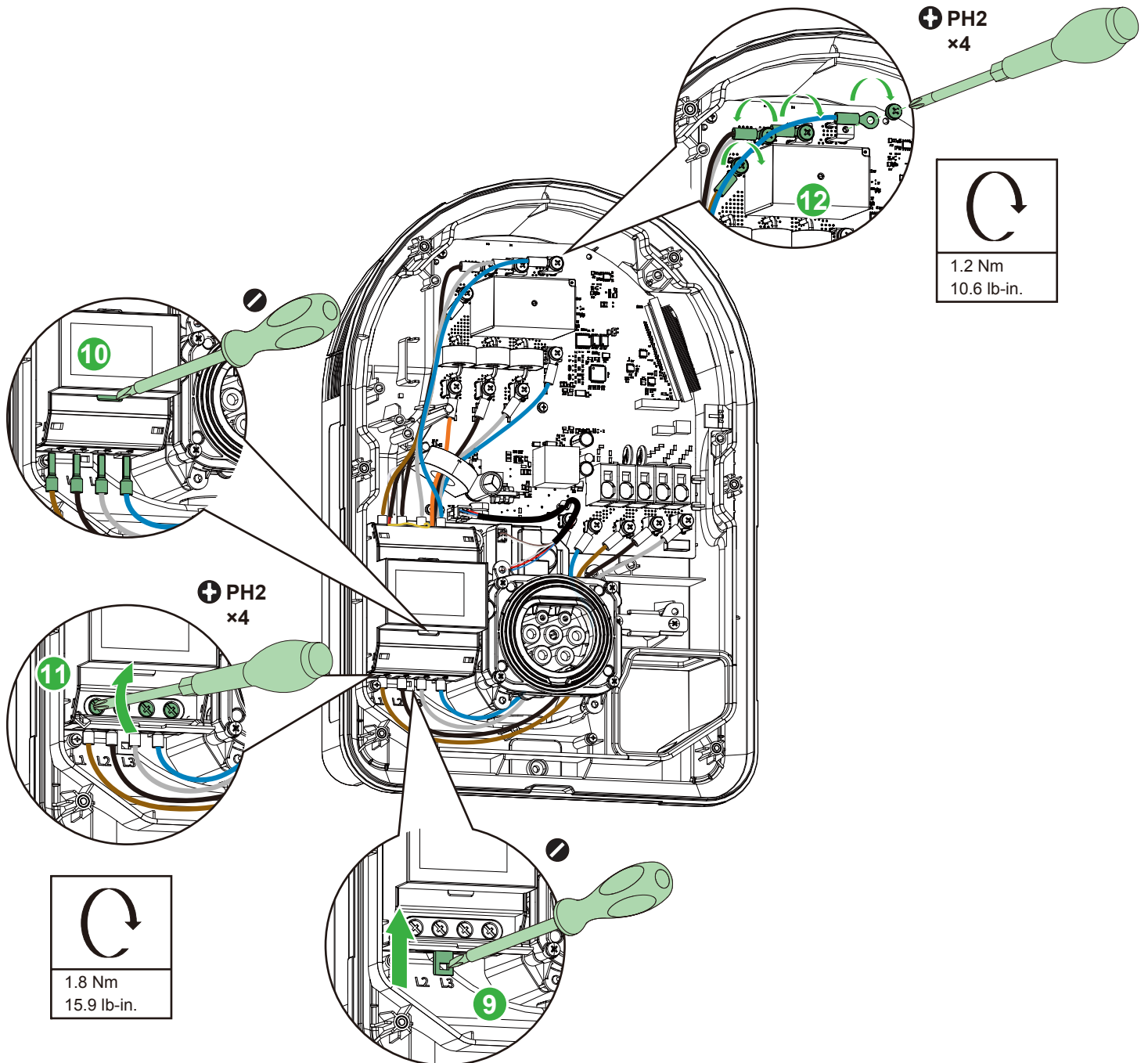

3 Replacement procedure

3.2 Assembling

NOTICE

RISK OF DAMAGING THE CHARGING STATION

Make sure that all signal cables and antennas are not covered or pinched, especially for cables of side button.
Failure to follow these instructions could result in equipment damage.

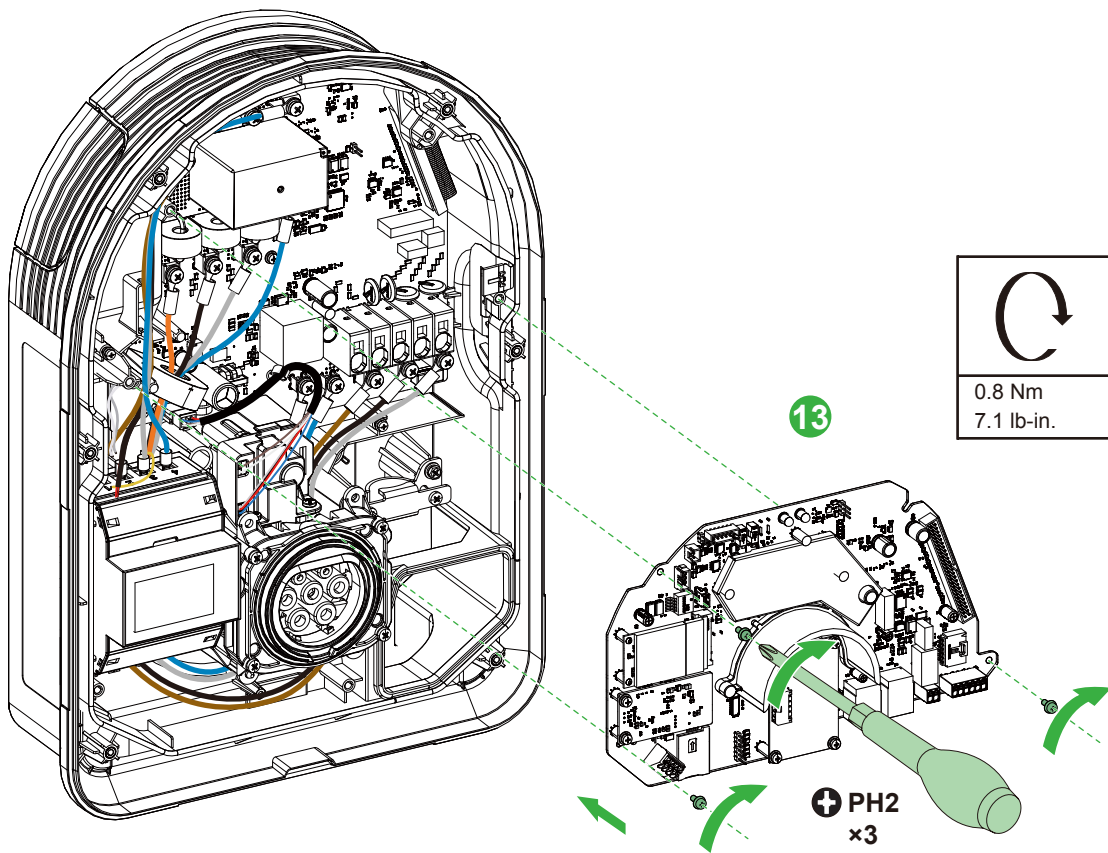

3 Replacement procedure

3.2 Assembling

i In step of 14, wiring should be performed according to the following table, do not mix them up.

Cable Color	White	N/A	Grey	Yellow
Connection	CP	PE	CC	PE

i In step of 16, connect the antennas according to the marks made in the disassembling process, do not mix with each other.

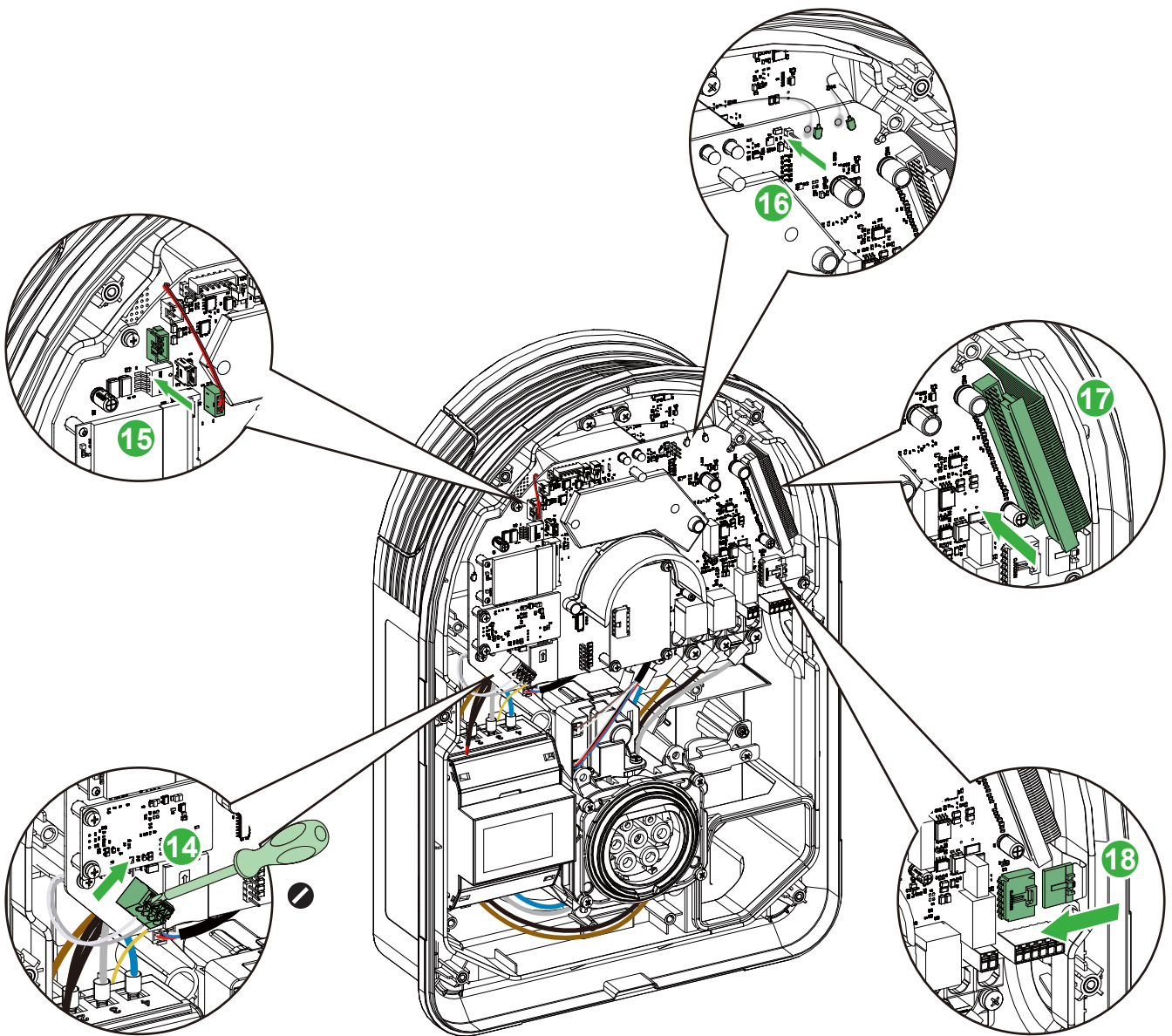

3 Replacement procedure

3.2 Assembling

NOTICE

RISK OF DAMAGING THE CHARGING STATION

Make sure that all signal cables and antennas are not covered or pinched, especially for cables of side button.
Failure to follow these instructions could result in equipment damage.

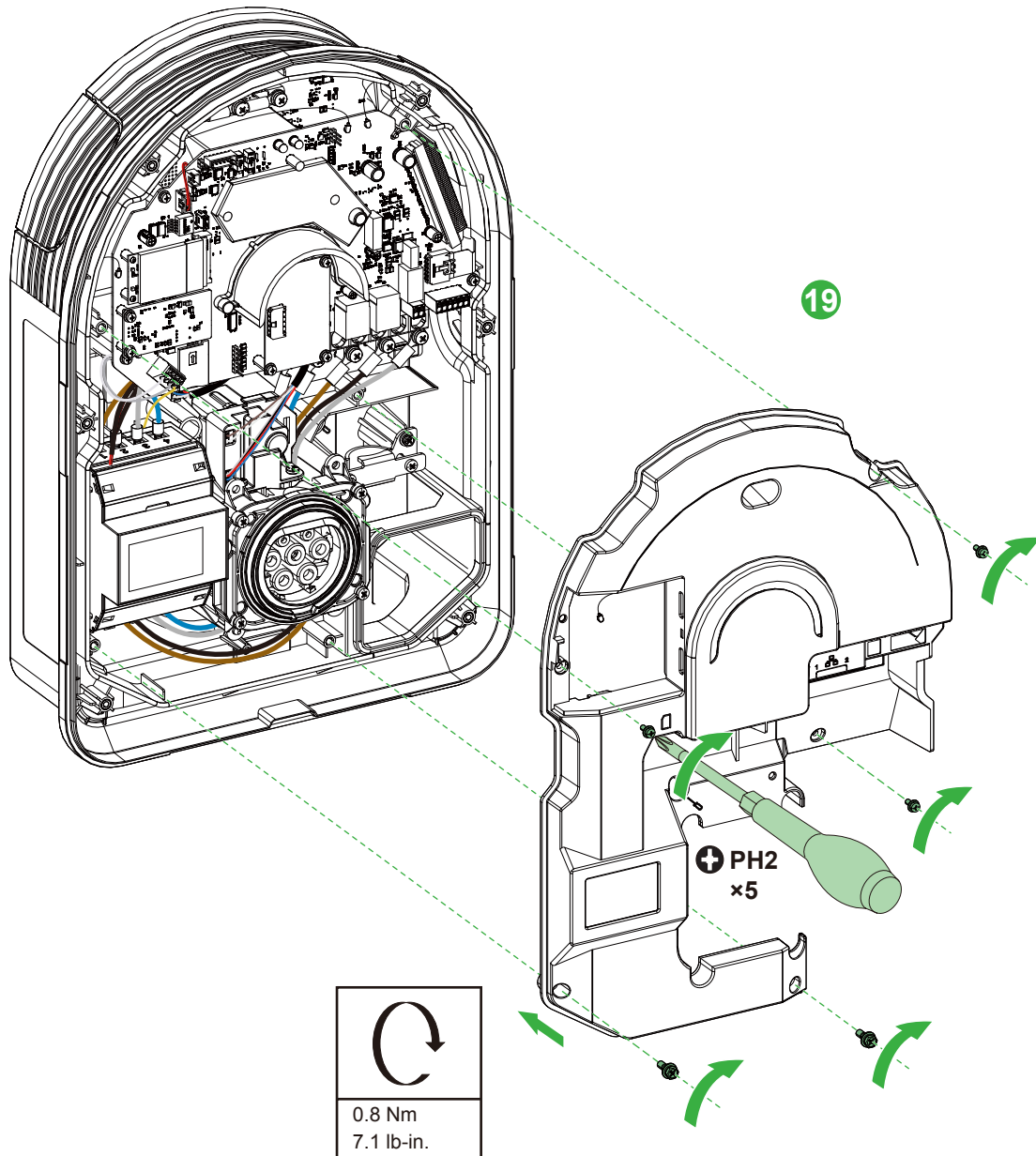

3 Replacement procedure

3.2 Assembling

i In step of 20, connect the antennas according to the marks made in the disassembling process, do not mix with each other.

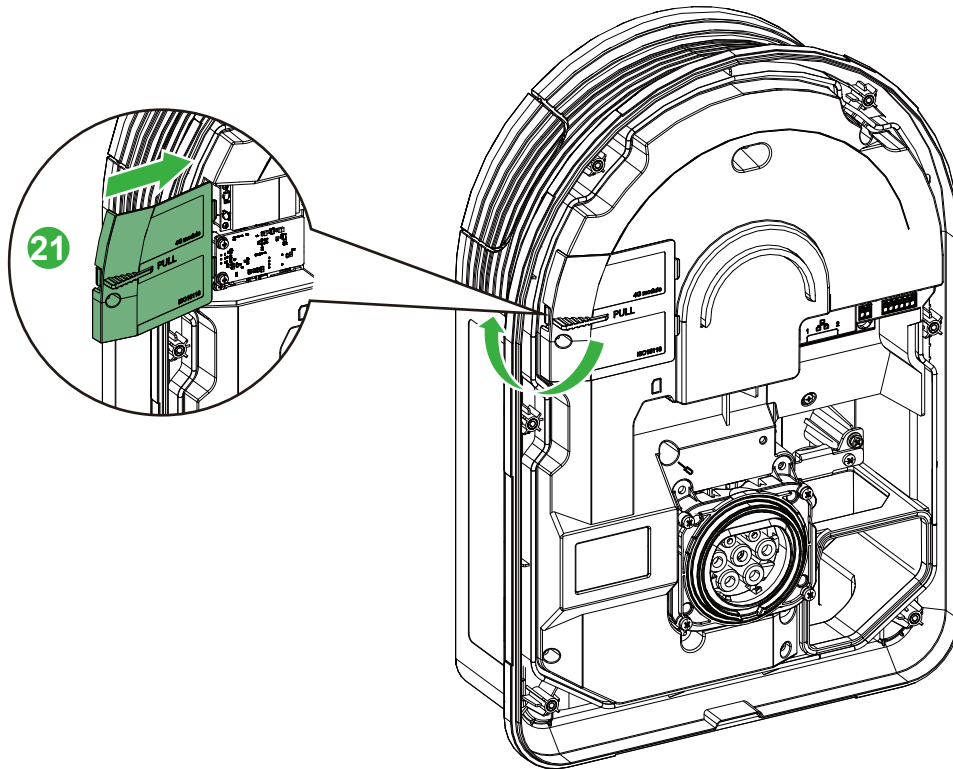
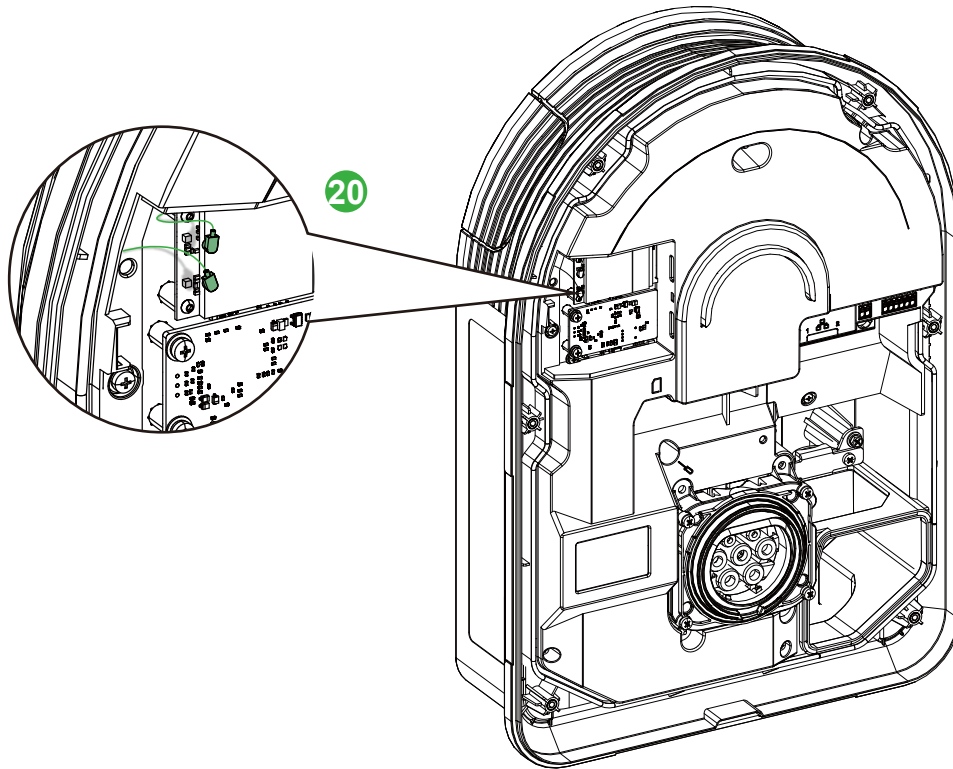

3 Replacement procedure

3.2 Assembling

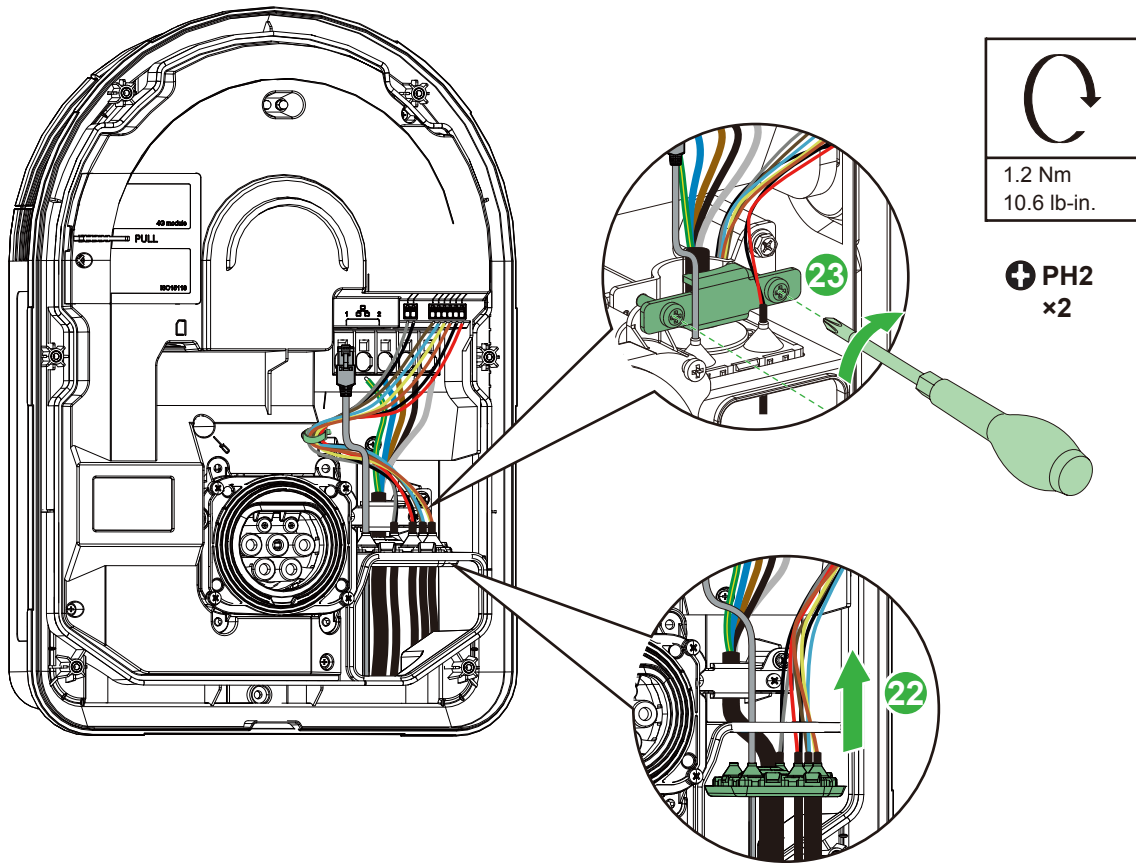

3 Replacement procedure

3.2 Assembling

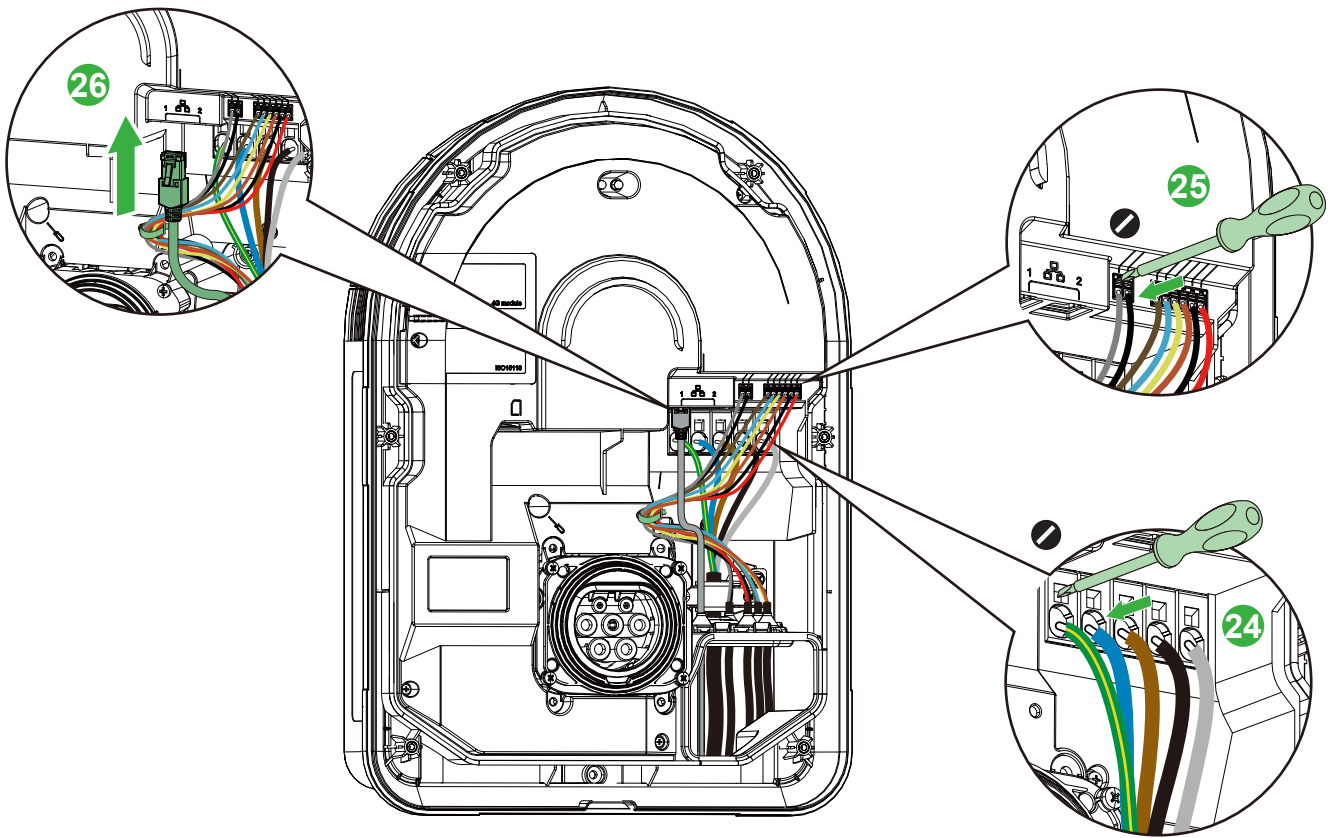

3 Replacement procedure

3.2 Assembling

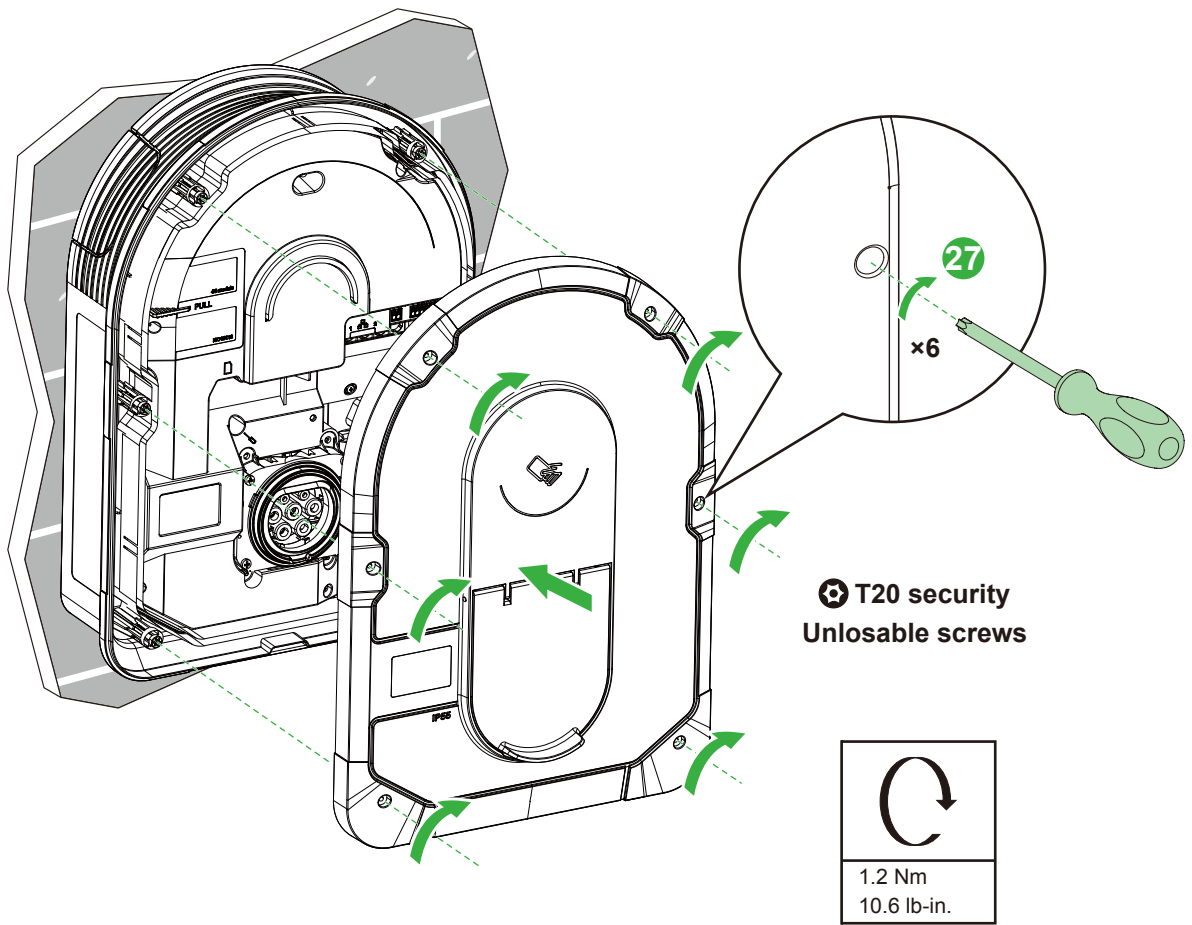

4 Power on

⚠ ⚠ DANGER

HAZARD OF ELECTRIC SHOCK, EXPLOSION OR ARC FLASH

- Be aware of potential hazards, and carefully inspect the work area for tools and objects that may have been left inside the device.
- Test and ensure earth continuity of the charging station before power on.
- Wear suitable personal protective equipment (PPE).
- Follow all safety procedures.
- Perform functional test according to the items listed in section 5 before charging electric vehicle.

Failure to follow these instructions will result in death or serious injury.

The light strip changes from white to green after about three minutes.

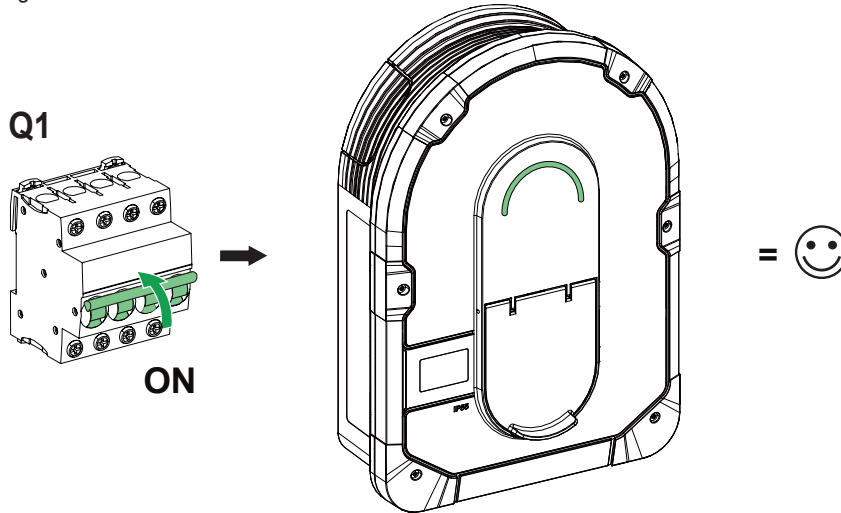

5 Test after replacement

No.	Item	Test Items	Tools
1	Mechanical check	All components assembled	Inspection check
2	Communication Test	Ethernet communication test	e-setup commissioning
3		Wi-Fi communication test	e-setup commissioning
4		4G communication test	e-setup commissioning
5	Charging function test	State A --> State B function test	EV simulator
6		State B --> State C function test	EV simulator
7		State C test	EV simulator
8		Stop charging test	EV simulator
9		RFID card start/stop charging test	EV simulator & e-setup commissioning
10	HMI function test	HMI LED function test	Inspection check
11		Side button function test	e-setup commissioning
12	Electronic lock function test	Lock function test	EV simulator
13		Unlock function test	EV simulator
14	Protection function test	DC 6mA leakage current test	Inspection check
15	Metering function test	Embedded MID meter function test	Inspection check

6 Recycling packaging

- The packaging materials from this spare part can be recycled.
- The T2S socket replaced by this spare part can be recycled. Please help protect the environment by recycling them in appropriate containers.