

Iso-Gard® Current Transformer MLHG6CT-AU

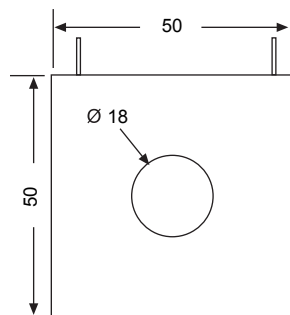
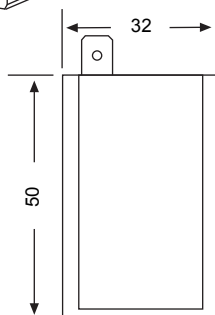
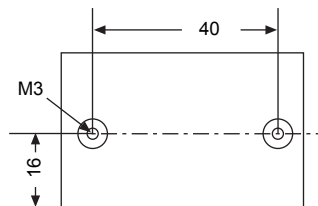
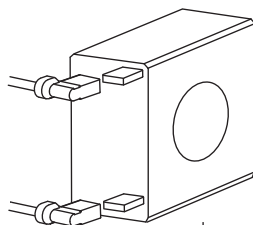

ISO-GARD®
Line Isolation Monitor

Application Note

Suitability

The Current Transformer is for use only with the Isogard Line Isolation Monitor (LIM). For complete details, including installation, setup, settings, and troubleshooting, refer to the *Line Isolation & Overload Monitor Installation and Reference Guide* for the MLHG6/MLHG6-AU.

For LIM installations, the CT is sold as a standalone part. The installer mounts the transformer and makes the wiring connections.

DANGER

HAZARD OF ELECTRIC SHOCK, EXPLOSION OR ARC FLASH

- This product must only be installed and serviced by appropriately qualified and/or licenced electrical personnel.
- Isolate the electrical supply before doing any work on this product.
- Ensure that the product has been correctly installed and tested for safe operation before reconnecting the electrical supply.

Failure to follow these instructions will result in death or serious injury.

Wiring Diagram

As shown in the diagram, the L1 conductor is looped through the centre of the transformer.

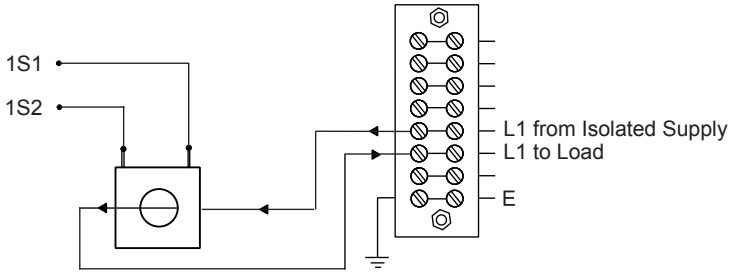

Customer care—Australia

We warrant this product for 2 years. For details, visit:
<https://www.schneider-electric.com.au/en/about-us/legal/terms-and-conditions.jsp>

Our goods also come with guarantees that cannot be excluded under the Australian Consumer Law. You are entitled to a replacement or refund for a major failure and compensation for any other reasonably foreseeable loss or damage. You are also entitled to have the goods repaired or replaced if the goods fail to be of acceptable quality and the failure does not amount to a major failure.

Schneider Electric (Australia) Pty Ltd

Customer Care: 1300 369 233

Email: customercare.au@schneider-electric.com

www.schneider-electric.com.au

Customer care—New Zealand

We warrant this product for 2 years. For details, visit:
<https://www.schneider-electric.com.nz/en/about-us/legal/terms-and-conditions.jsp>

Schneider Electric (NZ) Ltd

Customer Care: 0800 652 999

Email: sales@nz.schneider-electric.com

www.schneider-electric.com



Schneider Electric reserves the right to change specifications, modify designs and discontinue items without incurring obligation and whilst every effort is made to ensure that descriptions, specifications and other information in this catalogue are correct, no warranty is given in respect thereof and the company shall not be liable for any error therein.

© 2018 Schneider Electric.

Medilec is a trademark of Schneider Electric (Australia) Pty Ltd or its affiliated companies. Other trademarks are the property of their respective owners.

This material is copyright under Australian, New Zealand and international laws. Except as permitted under the relevant law, no part of this work may be reproduced by any process without prior written permission of and acknowledgement to Schneider Electric.