

Depth C inches (mm)		
	With Keypad	Without Keypad
No option card	10.47[266.0]	9.45[240.0]
With 1 option card	11.38[289.0]	10.35[263.0]
With 2 options cards	12.28[312.0]	11.26[286.0]

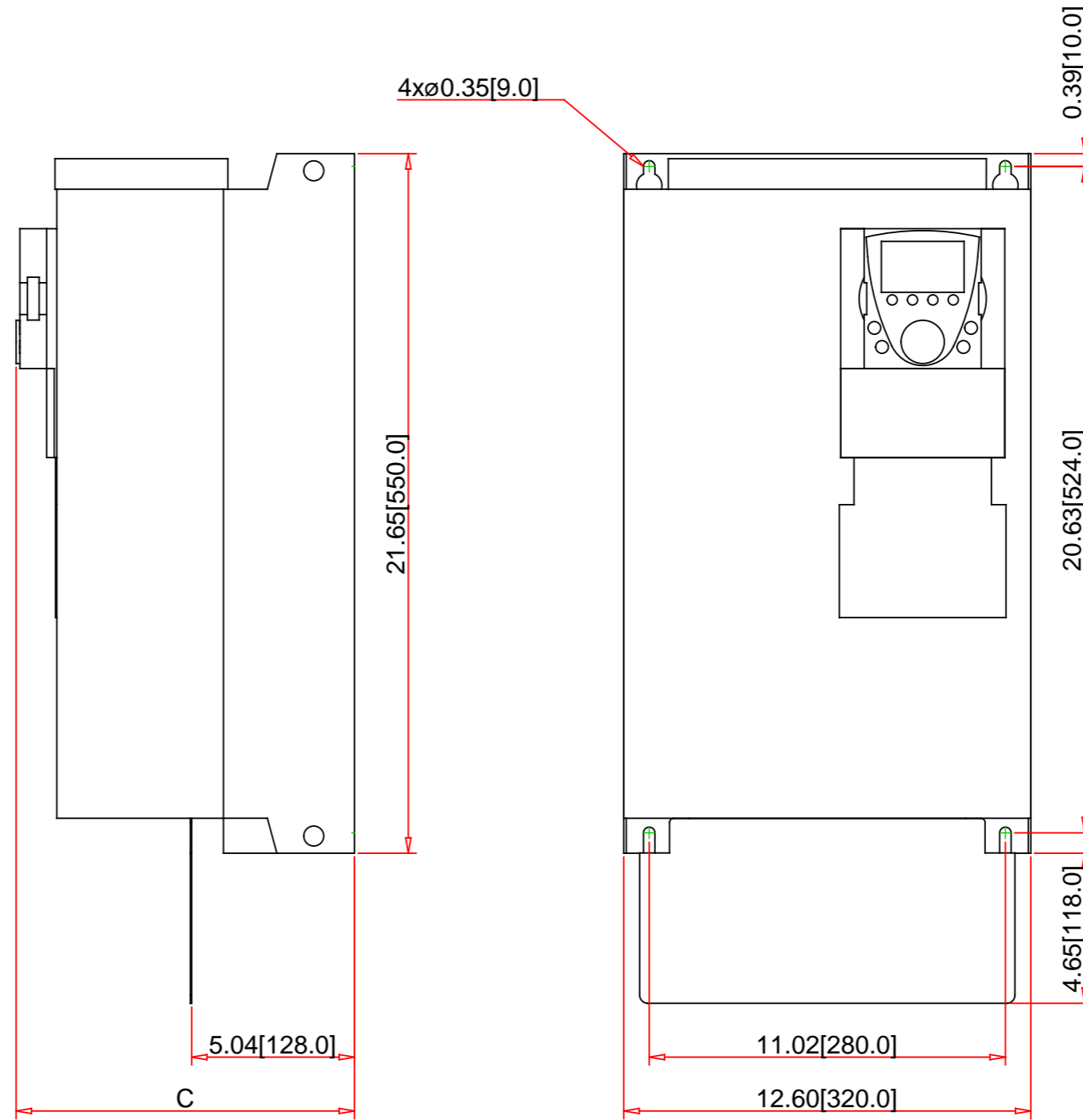

Optional EMC grounding plate is shown, it may be removed if not needed in the application.

Note:  
 - Drawings Not To Scale  
 - Drawings Subject to Change Without Notice  
 - Dimensions are inches next to [Millimeters]  
 - Inch Dimensions are derived from the metric.

Part No.:  
**ATV71HD30M3X**

**Schneider Electric**  
 Schneider Electric United States  
 North American Division  
 Boston One Campus  
 800 Federal Street  
 Andover, MA 01810, USA  
 Phone: +1 8773425173  
 Email: CCC@us.schneider-electric.com

**Technical Information:**

Control Voltage: 24Vdc  
 Logic Input: 6  
 Analog Input: 2  
 Analog Output: 1  
 Communication: Modbus and CANopen  
 Logic/Relay Output: 1 NO/NC, 1 NO  
 Weight [lb/kg]: 81.57 / 37  
 UL File No.: E116875  
 CSA File: 1650725  
 Other: CE, ABS, DNV, GOST, RoHS, WEEE, C-Tick, NOM 117

**Specification:**

Description:  
 Family: Altivar 71  
 Product Line: AC Drive  
 Application: Constant Torque  
 Voltage Rating: 208/240VAC  
 HP Rating / kW Rating: 40 / 30  
 Output Ampere Rating: 120A  
 Enclosure Rating: IP20  
 Frame Size: 7B  
 Input Phase / Output Phase: 3-Phase / 3-Phase