

Depth C inches (mm)		
	With Keypad	Without Keypad
No option card	9.29[236.0]	8.27[210.0]
With 1 option card	10.20[259.0]	9.17[233.0]
With 2 options cards	11.10[282.0]	10.08[256.0]

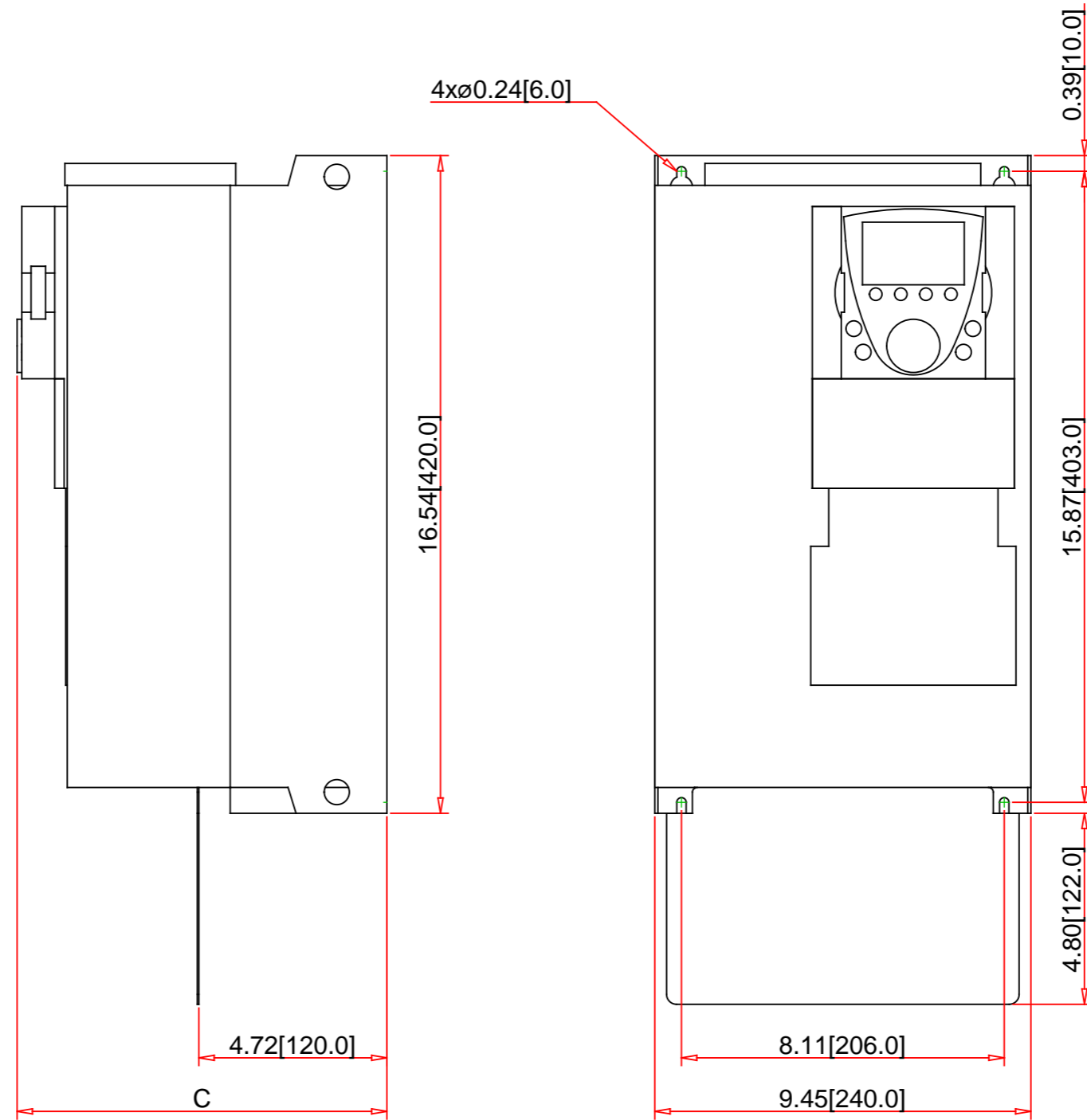

Optional EMC grounding plate is shown, it may be removed if not needed in the application.

Note:  
 - Drawings Not To Scale  
 - Drawings Subject to Change Without Notice  
 - Dimensions are inches next to [Millimeters]  
 - Inch Dimensions are derived from the metric.

Part No.:  
**ATV71HD22Y**

Schneider Electric United States  
 North American Division  
 Boston One Campus  
 800 Federal Street  
 Andover, MA 01810, USA  
 Phone: +1 8773425173  
 Email: CCC@us.schneider-electric.com



Technical Information:

Control Voltage: 24Vdc  
 Logic Input: 6  
 Analog Input: 2  
 Analog Output: 1  
 Communication: Modbus and CANopen  
 Logic/Relay Output: 1 NO/NC, 1 NO  
 Weight [lb/kg]: 66.14 / 30  
 UL File No.: E116875  
 CSA File: 1650725  
 Other: CE, ABS, DNV, GOST, RoHS, WEEE, C-Tick, NOM 117

Specification:

Description:  
 Family: Altivar 71  
 Product Line: AC Drive  
 Application: Constant Torque  
 Voltage Rating: 575/690VAC  
 HP Rating / kW Rating: 25 / 22  
 Output Ampere Rating: 27A / 29A  
 Enclosure Rating: IP20  
 Frame Size: 6  
 Input Phase / Output Phase: 3-Phase / 3-Phase