

Depth C inches (mm)		
	With Keypad	Without Keypad
No option card	14.84[377.0]	14.84[377.0]
With 1 option card	14.84[377.0]	14.84[377.0]
With 2 options cards	15.43[392.0]	14.84[377.0]

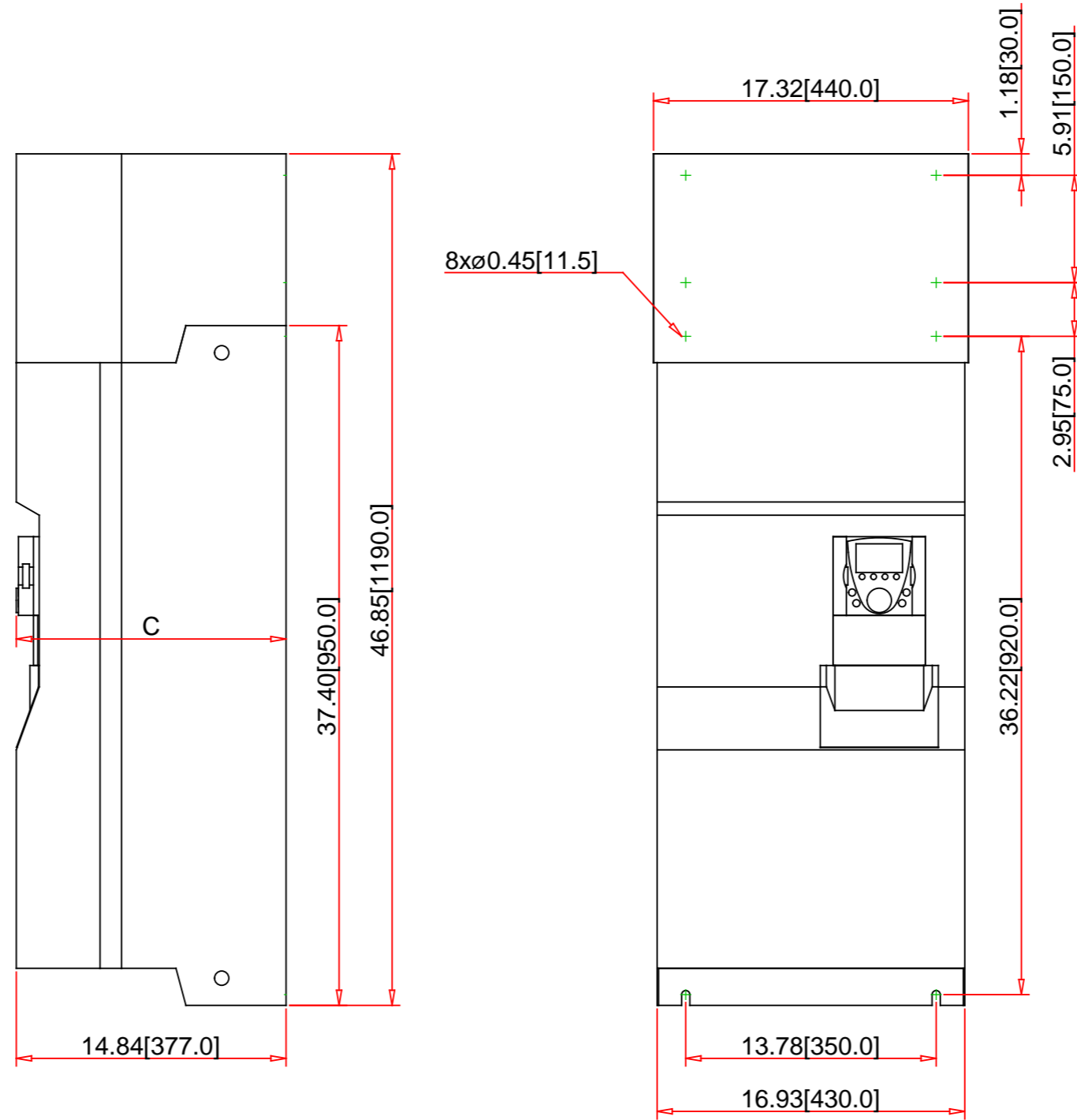

Note:
 - Drawings Not To Scale
 - Drawings Subject to Change Without Notice
 - Dimensions are inches next to [Millimeters]
 - Inch Dimensions are derived from the metric.

Part No.:

ATV71HC16N4

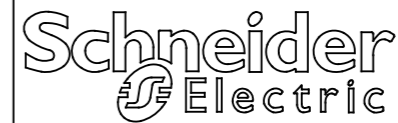

Schneider Electric United States
 North American Division
 Boston One Campus
 800 Federal Street
 Andover, MA 01810, USA
 Phone: +1 8773425173
 Email: CCC@us.schneider-electric.com

Technical Information:

Specification:

Control Voltage: 24Vdc
 Logic Input: 6
 Analog Input: 2
 Analog Output: 1
 Communication: Modbus and CANopen
 Logic/Relay Output: 1 NO/NC, 1 NO
 Weight [lb/kg]: 358 / 163
 UL File No.: E116875
 CSA File: 1650725
 Other: CE, ABS, DNV, GOST, RoHS, WEEE, C-Tick, NOM 117

Description:
 Family: Altivar 71
 Product Line: AC Drive
 Application: Constant Torque
 Voltage Rating: 400/480VAC
 HP Rating / kW Rating: 250 / 160
 Output Ampere Rating: 314A
 Enclosure Rating: IP20
 Frame Size: 12
 Input Phase / Output Phase: 3-Phase / 3-Phase