

# EVlink Parking

EVlink™ Parking solutions from Schneider Electric combine robust, easy-to-use charging stations with intuitive online management and monitoring to ensure the efficiency of your EV charging network. Together with flexible service plans, excellent support, and training from our global network of experts, EVlink solutions are ideal for public and commercial parking as well as fleet and workplace charge points.



## MAIN CHARACTERISTICS

- Neutral point connection: TT, TN, or IT
- Dimensions (H x W x D): 1146 x 413 x 220 mm (Floor-standing version)
- Degree of protection: IP54, IK10
- Operating temperature: -25°C to +50°C
- LED-light interface: Available (green), Maintenance (orange), Not operational (red)
- Socket type: 1 or 2 sockets; Type 2 or Type 2 with shutters, and/or TE/TF domestic socket
- Output current can be set from 6 A to 32 A
- Available power per socket: 7.4 kW (32 A/230 V) and 22.1 kW (32 A/400 V)
- Compliant with IEC 61851 and CB Scheme-certified

Highly robust socket outlet thanks to thermal-resistant silver coating

## ENHANCED CAPABILITIES

- Load management per socket, automatic load balancing, postponed charge
- Embedded or external power metering
- RFID card configuration setting: activate/deactivate, privilege settings
- Visualisation of charge detail records

## DIAGNOSTIC AND MAINTENANCE

- Diagnostic status with front-facing LEDs or embedded Web server
- Upgradable firmware for access to advanced features

## BACK-END SUPERVISION SYSTEM (OPTIONAL)

- OCPP 1.5 ready
- Ready to connect to EVlink Insights or third-party infrastructure management systems
- Ready to connect to local management systems, e.g. building management systems

## EASY TO INSTALL, MAINTAIN, AND USE

- Only 1 person required to carry and handle
- Worldwide customer care support and QR code app for easy installation tracking
- Free access or user identification with RFID card to activate (unlock the socket shutter) or deactivate (unlock the plug) a charging session

## CHARGING WITH RFID CARD:

### Start

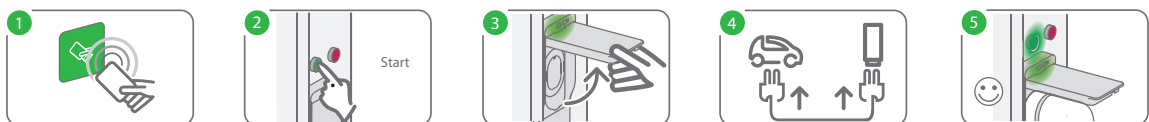

### Stop

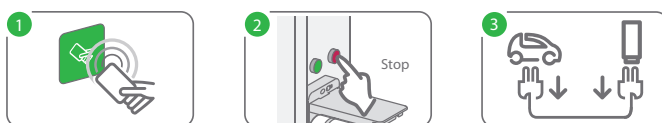

Z.E. READY



Life Is On

Schneider  
Electric