

OPERATING HANDLE DESCRIPTION

12 INCH HANDLES ARE FOR USE WITH 400A TYPE TG1 AND TG2 DISCONNECT SWITCHES ONLY.	
TYPE	USAGE
A5	HANDLE MECHANISM COMPLETE FOR FIXED DEPTH INSTALLATION IN NEMA 1, 12, 3, 3R, AND 4 (SHEET METAL) ENCLOSURES.
A6	HANDLE MECHANISM COMPLETE FOR FIXED DEPTH INSTALLATION IN NEMA 4 (STAINLESS STEEL) ENCLOSURES.
A7	HANDLE MECHANISM COMPLETE FOR ADJUSTABLE DEPTH INSTALLATION IN NEMA 1, 12, 3, 3R, AND 4 (SHEET METAL) ENCLOSURES.
A8	HANDLE MECHANISM COMPLETE FOR ADJUSTABLE DEPTH INSTALLATION IN NEMA 4 (STAINLESS STEEL) ENCLOSURES.

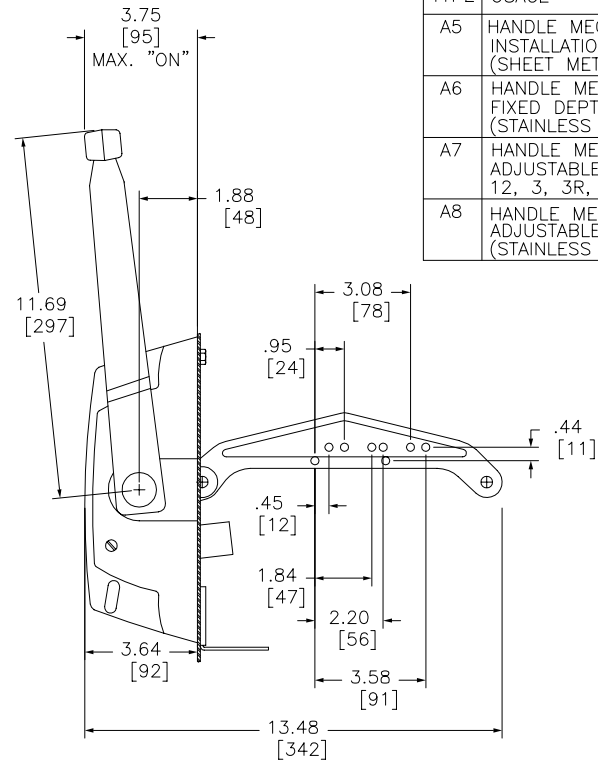
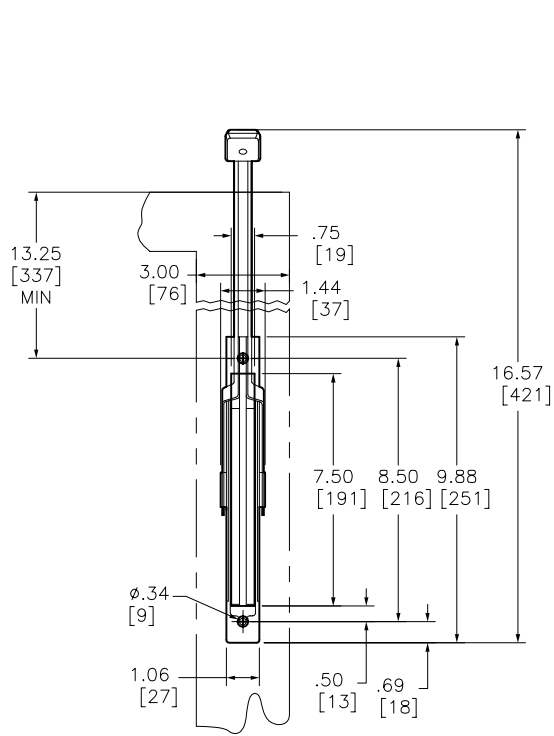

Catalog Number: 9422-A5, A6, A7, A8
 Ratings: -
 UL File/CCN: E52369/WHTY2
 CSA File/Class: -
 Meets Standards: -
 Weight: 3.86 lbs
 Wire Size: -
 Terminal torque: -
 Mounting Hwd: -

"THE SQUARE D COMPANY HAS PROPRIETARY RIGHTS TO THE INFORMATION CONTAINED HEREON. THIS INFORMATION REMAINS THE PROPERTY OF SQUARE D COMPANY AND MAY BE USED ONLY IN CONFORMANCE WITH INSTRUCTIONS ISSUED BY SQUARE D COMPANY. USER SHOULD VERIFY DRAWINGS ARE TO THE LATEST/CURRENT REVISION PRIOR TO INCORPORATING IN A DESIGN FILE."

DO NOT SCALE DRAWING
 UNLESS OTHERWISE SPECIFIED DIMENSIONS ARE IN INCHES

THIRD ANGLE PROJECTION
 TOLERANCES UNLESS OTHERWISE SPECIFIED 2 PLACE DECIMALS ± .01

OPERATING HANDLE
 CLASS 9422
 TYPE A5, A6, A7, A8

SQUARE D COMPANY

DWG# 9422_A5+A6+A7+A8_OUTLINE_001
 NO.