

Instruction Bulletin

Replaces 75049-001-40 dated 5/94

Shaft Assembly Kit

For Class 9007 Types T and FT Limit Switches

Class 9998 2934-S928-G1 and 2934-S932-G1

FOR ALL TYPES EXCEPT TU-12 AND FTU-12 MAINTAINED CONTACT DEVICES

DANGER

HAZARDOUS VOLTAGE

Turn off all power before servicing equipment.

Failure to follow this instruction will result in death or serious injury.

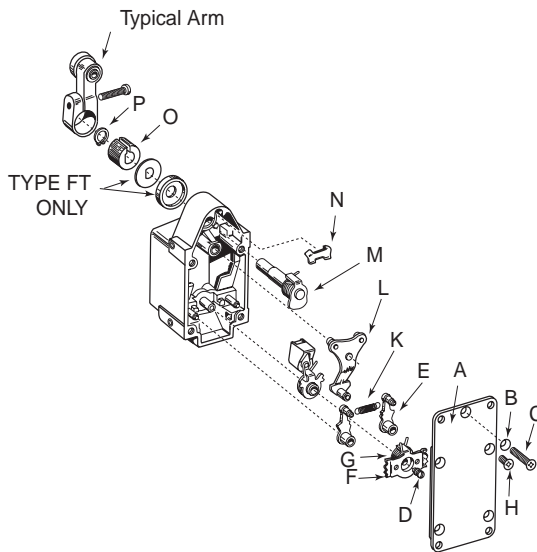

DISASSEMBLY

1. Remove the operating arm, if attached. Remove the retaining ring (P) from the shaft and withdraw the hub (O). On Type FT switches, remove the washer and dust boot. Make sure that the shaft is free from burrs or foreign matter.

2. Remove the five baseplate screws (H and C) and remove the baseplate (A). Remove the auxiliary cam stop (N) from Type TU, TY, FTU, and FTY switches. Remove the screw (D) and withdraw the positioning plate (F) with return spring (G). Remove the latch spring (K) and withdraw the latches (E). Withdraw the lever assembly (L). Push the shaft assembly (M) out through the case, being careful not to damage the bearing or its seal. Remove the spring from the shaft.
3. Carefully inspect the bearing and its shaft seal. If there is any reason to suspect that either may be worn, damaged, or distorted, the complete limit switch should be replaced.

REASSEMBLY

1. Assemble the spring to the new shaft assembly, making sure that the spring arms locate correctly in notches on the cam. Oil the shaft with SAE 30 oil, or equivalent, and push the shaft and spring assembly through the bearing from the back of the switch, being careful not to damage or displace the seal ring. Check for freedom of movement.
2. Reassemble the lever assembly (L) making sure that the arms of the contact operating spring fit around the roller on the back of the lever assembly and have not been moved out of position. Replace the latches (E) in the desired operating position and replace the latch spring (K). Assemble the positioning plate (F) with return spring (G) in the desired operating position and tighten the screw (D). Replace the dust boot and washer on Type FT switches. Replace the hub (O) and the retaining ring (P).
3. Check the action of the switch, using a lever arm to activate the switch mechanism. Reassemble the auxiliary cam stop (N) on Type TU, TY, FTU, and FTY switches. Check the baseplate gasket to be sure that it is satisfactory or replace it. Reassemble the baseplate with five retaining screws (H and C), being sure that the nylon seal washer (B) is fitted under the head of the longer screw (C) next to the shaft end of the switch.
4. Finally, check for correct, smooth action of the switch mechanism before returning the limit switch to active service.

Square D Company
8001 Hwy 64 East
Knightdale, NC 27545
888-SquareD (778-2733)
www.squared.com

Electrical equipment should be serviced only by qualified electrical maintenance personnel. No responsibility is assumed by Schneider Electric for any consequences arising out of the use of this material.

