

550B1025

Wi-Fi

Schneider
Electric

Forudsætninger

Download **Wisir app'en** til din smartphone / tablet.

Yderligere information

Detaljeret produktinformation er tilgængelig online i **systemvejledningen**: Scan QR-koden eller følg linket:



<https://www.1.lk.dk/wisir>



Lær produktet at kende

Med Wisir trådløs IP kamera, indendørs kan du overvåge områder i dit hjem og bruge de indbyggede sensorer til at kontrollere andre Wisir-enheder med Wisir Gateway.

Package contents

- (A) IP kamera
- (B) Strømforsyning
- (C) Ledning til spændingsforsyning
- (D) Monteringsplade
- (E) 3 skruer med vægplugs
- (F) Opmærkelære
- (G) Vejledning

Installation

Du kan installere kameraet i alle retninger, f.eks. På væggen, i loftet eller på et bord.
Vær opmærksom på at de danske regler for bl.a. databeskyttelse og tv-overvågning kan sætte begrænsninger for anvendelsen, ligesom der gælder begrænsninger for aflytning/optagelse af samtaler og at du som bruger er ansvarlig for overholdelsen heraf.

Setup

Du kan indsætte et mikro SD kort til lokal opbevaring. Yderligere oplysninger findes i systemets brugervejledning.

For at slutte kameraet til din router skal du følge instruktionerne i Wisir app'en.
Se systemvejledning.

Nulstilling

Se systemvejledning.

Betjening

Se systemvejledning.

Tekniske data

| | |
|-----------------------------|-----------------------------|
| Mærkespænding: | 100-240 V ac., 50/60 Hz |
| Strømforsyning: | 5 V dc., 2 A |
| Effektforbrug: | maks. 10 W |
| Driftstemperatur: | -10° C - 45° C |
| Relativ fugtighed: | <95% RH |
| Frekvensområde: | 2405 - 2480 MHz |
| Maks. transmitteret effekt: | < 100 mW |
| Wi-Fi® standard: | IEEE 802.11 b/g/n 2.4 GHz |
| Wi-Fi® security: | WPA-PSK / WPA2-PSK |
| Kanal båndbredde: | Understøtter 20/40 MHz |
| Data sikkerhed: | AES128 |
| Opløsning: | 1080p |
| Vidvinkelobjektiv: | 80° vandret 40° lodret |
| IR rækkevidde: | 7 m |
| Panoreringsvinkel: | 0° - 340° |
| Tilt-vinkel: | -75° - 75° |
| Lokal hukommelse: | Mikro SD kort, maks. 128 GB |



Bortskaf enheden separat fra husholdningssaffald på et godkendt opsamlingssted. Professionel genanvendelse beskytter mennesker og miljø mod potentielle negative effekter.

Varemærker

- Wisir™ er et varemærke og tilhører Schneider Electric SE, dets datterselskaber og associerede selskaber.
- Wi-Fi® er et registreret varemærke tilhørende Wi-Fi Alliance®.
- Apple® og App Store® er mærkenavne eller registrerede varemærker tilhørende Apple Inc.
- Google Play™ Store og Android™ er varemærker eller registrerede varemærker tilhørende Google Inc.

Andre varemærker og registrerede varemærker er de pågældende ejeres ejendom.

EU-overensstemmelseserklæring

Schneider Electric Danmark A/S erklærer hermed, at dette produkt er i overensstemmelse med de væsentlige krav og andre relevante bestemmelser i RADIO EQUIPMENT DIRECTIVE 2014/53 / EU.

Overensstemmelseserklæringen kan downloades på adressen se.com/docs.

Lauritz Knudsen

Schneider Electric Danmark A/S, Lautrupvang 1, 2750 Ballerup, Telefon: +45 88 30 20 00, www.lk.dk

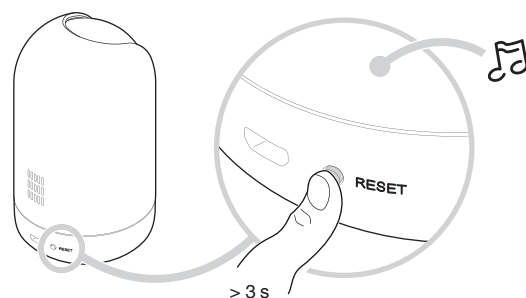
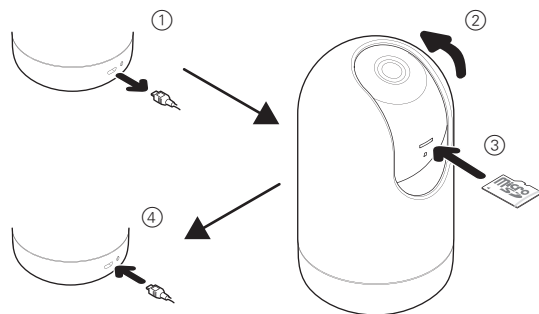
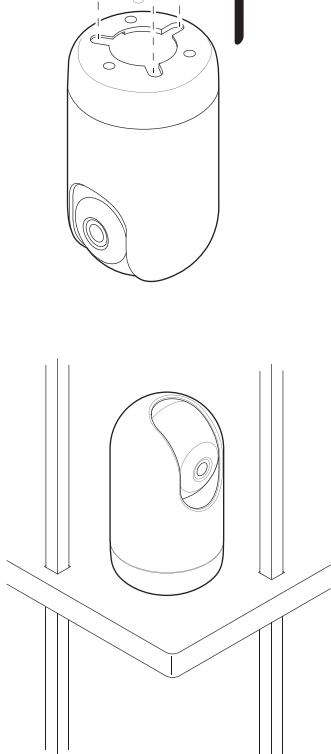
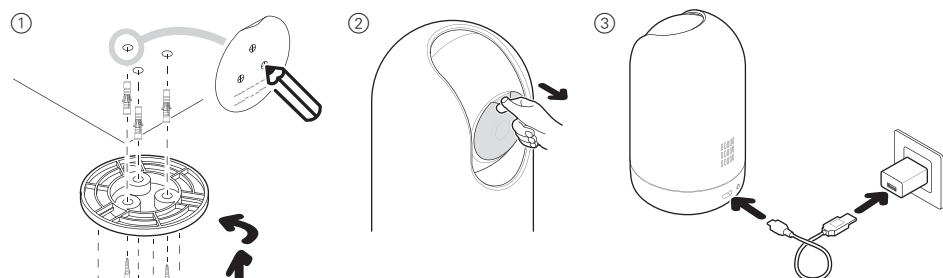
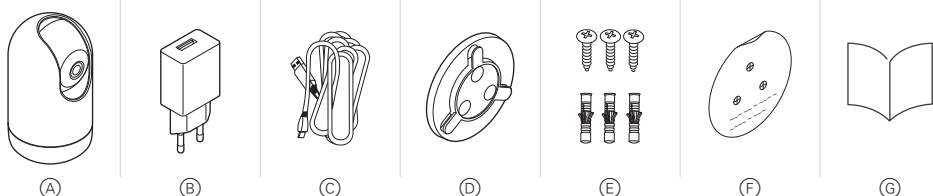

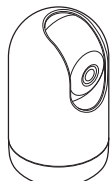

550B1025

WiFer™

Schneider
Electric

Prerequisites

Download the **Wiser app** to your smartphone/tablet.

Additional system information

Detailed product information is available on-line in the **system user guide**. Scan the QR code or follow the link:



<https://www1.lk.dk/wiser>



Getting to know the product

With the Wiser IP camera indoor you can monitor sensitive areas of your home and use the build-in sensors to control other Wiser devices with the Wiser Gateway.

Package contents

- (A) IP Camera
- (B) Power supply
- (C) Power supply cord
- (D) Mounting base
- (E) 3 screws with wall plugs
- (F) Marking template
- (G) Installation instructions

Installing

You can install the camera in all directions, e.g. on the wall, at the ceiling or on a table.

Be aware of the Danish laws on, amongst others, privacy and CCTV, which may restrict the use. Moreover, be aware of the restrictions on wiretapping/recording conversations.

Please note that as a user you are responsible for the compliance with such regulations.

Setup

You can insert a micro-SD card for local storage.

To connect the camera to your router, please follow the instructions in the Wiser app.

For more details, refer to the system user guide.

Resetting

For more details, refer to the system user guide.

Operating

For more details, refer to the system user guide.

Technical data

| | |
|---|------------------------------------|
| Nominal voltage: | AC 100-240 V, 50/60 Hz |
| Power supply: | DC 5 V, 2 A |
| Power consumption: | max. 10 W |
| Operating temperature: | -10° C - 45° C |
| Operating humidity: | <95% RH |
| Operating Frequency: | 2405 - 2480 MHz |
| Max. radio-frequency power transmitted: | < 100 mW |
| Wi-Fi® standard: | IEEE 802.11 b/g/n 2.4 GHz |
| Wi-Fi® security: | WPA-PSK / WPA2-PSK |
| Channel bandwidth: | Support 20/40 MHz |
| Data security: | AES128 |
| Resolution: | 1080p |
| Wide angle lens: | 80° horizontally 40° vertically |
| IR range: | 7 m |
| Pan angle: | 0° - 340° |
| Tilt angle: | -75° - 75° |
| Local storage support: | Micro SD Card, max. 128 GB |

 Dispose of the device separately from household waste at an official collection point. Professional recycling protects people and the environment against potential negative effects.

Trademarks

- Wiser™ is a trademark and the property of Schneider Electric SE, its subsidiaries and affiliated companies.
- Wi-Fi® is a registered trademark of Wi-Fi Alliance®.
- Apple® and App Store® are brand names or registered trademarks of Apple Inc.
- Google Play™ Store and Android™ are brand names or registered trademarks of Google Inc.

Other brands and registered trademarks are the property of the relevant owners.

EU Declaration of conformity

Hereby, Schneider Electric Danmark A/S, declares that this product is in compliance with the essential requirements and other relevant provisions of RADIO EQUIPMENT DIRECTIVE 2014/53/EU. Declaration of conformity can be downloaded on: se.com/docs.

Lauritz Knudsen

Schneider Electric Danmark A/S, Laturupvang 1, 2750 Ballerup, Phone: +45 88 30 20 00, www.lk.dk

