

Iconic Connected AC Fan Speed Controller

Device user guide

Information about features and functionality of the device.

05/2023



Legal Information

The Schneider Electric brand and any trademarks of Schneider Electric SE and its subsidiaries referred to in this guide are the property of Schneider Electric SE or its subsidiaries. All other brands may be trademarks of their respective owners.

This guide and its content are protected under applicable copyright laws and furnished for informational use only. No part of this guide may be reproduced or transmitted in any form or by any means (electronic, mechanical, photocopying, recording, or otherwise), for any purpose, without the prior written permission of Schneider Electric.

Schneider Electric does not grant any right or license for commercial use of the guide or its content, except for a non-exclusive and personal license to consult it on an "as is" basis. Schneider Electric products and equipment should be installed, operated, serviced, and maintained only by qualified personnel.

As standards, specifications, and designs change from time to time, information contained in this guide may be subject to change without notice.

To the extent permitted by applicable law, no responsibility or liability is assumed by Schneider Electric and its subsidiaries for any errors or omissions in the informational content of this material or consequences arising out of or resulting from the use of the information contained herein.

Table of Contents

Safety information	4
Iconic Connected AC Fan Speed Controller	5
For your safety	5
About the device	6
Installing the device	6
Changing device protocol	7
Pairing the device	8
Pairing Zigbee device manually	8
Pairing Zigbee device with auto scan	11
Pairing Bluetooth device	12
Manual operation	13
Configuring the device	14
Changing the device icon	14
Renaming the device	15
Changing the device location	15
Zigbee Mode	16
Zigbee fan controller settings	16
Using the Device	18
Removing the device from Wiser system	27
Bluetooth Mode	28
Bluetooth fan controller settings	28
Using the Device	32
Removing the device	34
Resetting the device manually	35
LED indication	35
Troubleshooting	36
Technical Data	37
Compliance	38
Compliance information for Green Premium products	38
Trademarks	38

Safety information

Important information

Read these instructions carefully and look at the equipment to become familiar with the device before trying to install, operate, service, or maintain it. The following special messages may appear throughout this manual or on the equipment to warn of potential hazards or to call attention to information that clarifies or simplifies a procedure.



The addition of either symbol to a “Danger” or “Warning” safety label indicates that an electrical hazard exists which will result in personal injury if the instructions are not followed.



This is the safety alert symbol. It is used to alert you to potential personal injury hazards. Obey all safety messages that accompany this symbol to avoid possible injury or death.

DANGER

DANGER indicates a hazardous situation which, if not avoided, **will result in** death or serious injury.

Failure to follow these instructions will result in death or serious injury.

WARNING

WARNING indicates a hazardous situation which, if not avoided, **could result in** death or serious injury.

CAUTION

CAUTION indicates a hazardous situation which, if not avoided, **could result in** minor or moderate injury.

NOTICE

NOTICE is used to address practices not related to physical injury.

Iconic Connected AC Fan Speed Controller

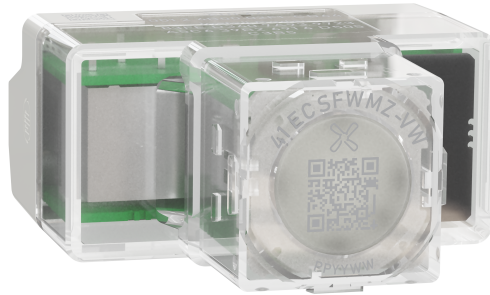

41ECSFWMZ-VW (Zigbee®)

41ECSFWM-VW (Bluetooth®)

For your safety

⚠ DANGER

HAZARD OF ELECTRIC SHOCK, EXPLOSION, OR ARC FLASH

- It is illegal for persons other than an appropriately licensed electrical contractors or other persons authorised by legislation to work on the fixed wiring of any electrical installation.
- To comply with all safety standards, the device must be used only for the purpose described in this instruction and must be installed in accordance with the wiring rules and regulation in the location where it is installed.
- Lock out and tag the input circuit before accessing the wiring connections.
- The Locking Bar on the grids must be set to the Closed position to ensure that the device cannot be removed during normal operation.
- There are no user serviceable parts inside the device.

Failure to follow these instructions will result in death or serious injury.

NOTICE

EQUIPMENT DAMAGE HAZARD (LOAD AND OPERATION)

- Operation of the device at elevated temperatures or voltages outside of specification (240 V a.c. and 25 °C) may cause the over-temperature protection circuitry to operate.
- Reduce the size of the connected load or use a different brand of fan to prevent recurrence.
- Do not operate the product for prolonged periods in extreme conditions.

Failure to follow these instructions can result in equipment damage.

About the device

Iconic Connected AC Fan Speed Controller, Zigbee/Bluetooth (hereinafter referred to as **fan controller**) can control up to two fans and in three steps, you can adjust the fan speed to achieve your desired comfort. You can also control the fan using Wiser app.

- Fan controller Zigbee (**41ECSFWMZ-VW**)
Connect the fan controller to a Wiser Hub.
- Fan controller Bluetooth (**41ECSFWM-VW**)
Connect the fan controller directly to your mobile device via Bluetooth.

Operating elements

- A. Push-button
- B. Status LED (Amber, Green, and Red LED)
- C. Speed indicating LEDs

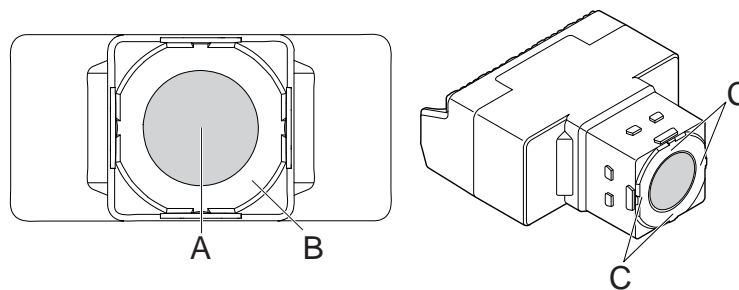

NOTE:

- The LED position will change when the fan controller is installed in a different orientation. To maintain same LED position with change in orientation, refer to the [orientation settings](#), page 16.
- For information on LED during each control stage, refer [LED indication](#), page 35.

Installing the device

Refer to the installation instruction supplied with this product.

See [Iconic Connected AC Fan Speed Controller, Zigbee/BLE](#).

Changing device protocol

The communication protocol of the device can be changed from Zigbee to Bluetooth and Bluetooth to Zigbee.

Reset the device before changing device protocol. Refer resetting the device, page 35.

Short press the push-button 3 times and then long press the push-button once (> 20s).

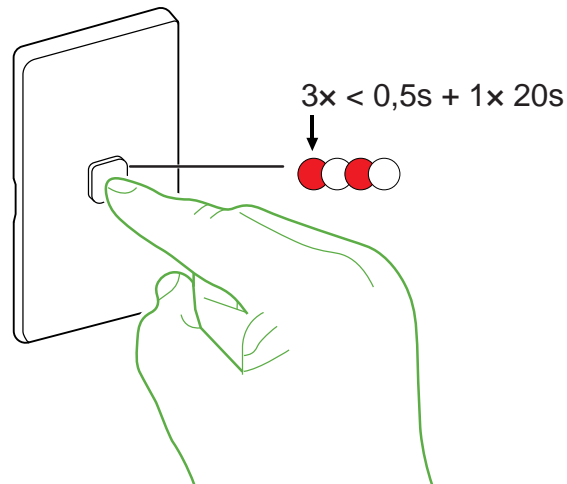

Red led flash rapidly indicating commence of protocol change.

On successful change in protocol:

- Zigbee to Bluetooth - No colour indication, white back light only.
- Bluetooth to Zigbee - Flashing Amber LED (Indicating that device is in pairing mode), if pairing is not completed will become solid Amber

Pairing the device

Using the Wiser app, pair your device with the **Wiser Hub** to access and control the device. You can either add the device manually or do an auto-scan to pair it.

Pairing Zigbee device manually

You can pair the device to Wiser system manually with or without installed code.

1. On the **Home** page, tap **+**.
2. Tap **Iconic A.C. fan controller ZB**  and select the required **Wiser Hub** on the slide-up menu.
3. Select any one of the options to add device (A):
 - **Add Device with Install Code**
 - **Add Device without Install Code**

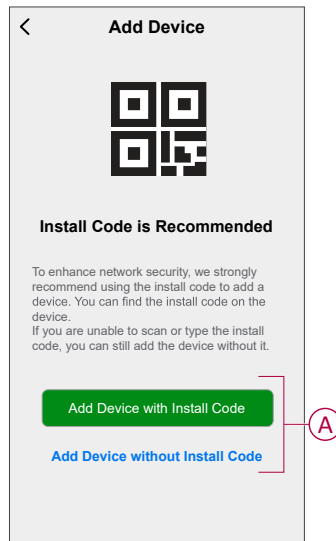

TIP: It is highly recommended to add the device with Install code.

4. To pair the device with install code, tap **Add Device with Install Code** to display the slide-up menu. Select any one of the options (B):
 - **Scan Install Code:** you can scan the device for the install code.

TIP: The QR code is located on the push button.

- **Enter Install Code Manually:** you can manually enter the install code from the device.

TIP: The install code is located on the device's top.

After scanning or entering the install code, proceed to **Step 6**.

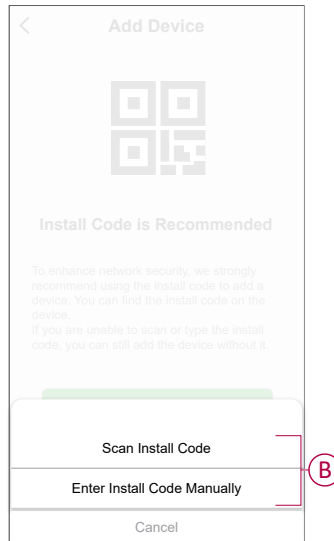

5. To pair the device without install code, tap **Add Device without Install Code**.
6. Press and hold the push-button for > 8 s to enter pairing mode.

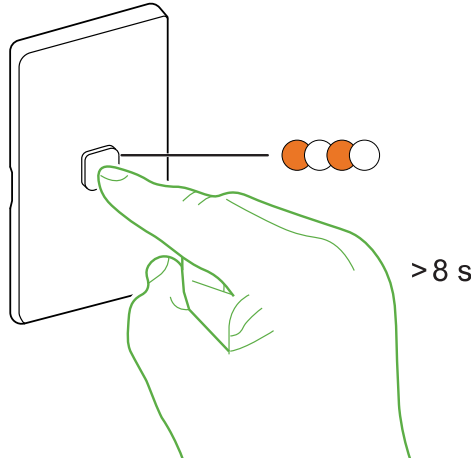

7. In the app, tap **Confirm the indicator blinking rapidly** and then tap **Start Configuration (C)**.

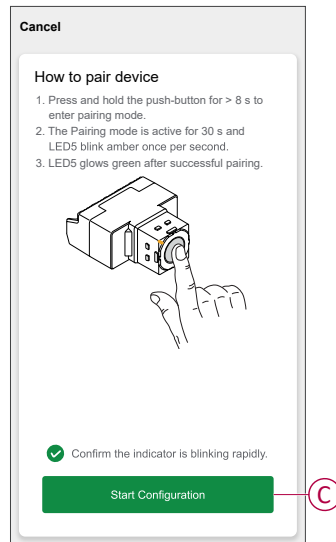

Wait for a few seconds until the LED turns green.

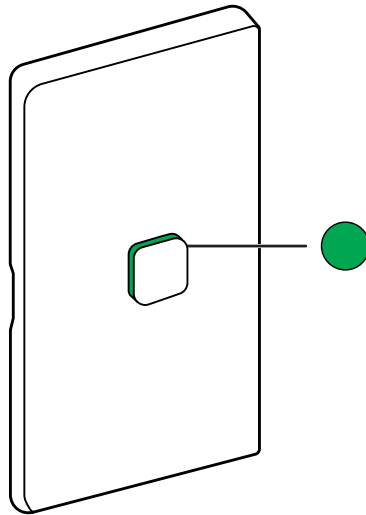

8. Once the device is added in the app, tap **Done**.

Pairing Zigbee device with auto scan

Pairing the device with auto scan automatically discovers the device when the device is powered on.

1. On the **Home** page, tap **+**.
2. Tap **Auto scan > Confirm**.
3. Enable permissions to **Access location** and **Wi-Fi** for scanning device and then tap **Start scanning**.

NOTE: If you have multiple hubs, perform Step 4 or proceed to Step 5.

4. Tap **Select Hub** and select **Wiser Hub** from the slide-up menu.
5. Press and hold the push-button for > 8 s to enter pairing mode.

NOTE: Wait for a few seconds until the device search is complete.

TIP: If you want to pair multiple devices at once, perform step 5 on each device and wait for a few seconds for them to be detected.

6. Tap **Next (A)**, select **Iconic Fan Controller**.

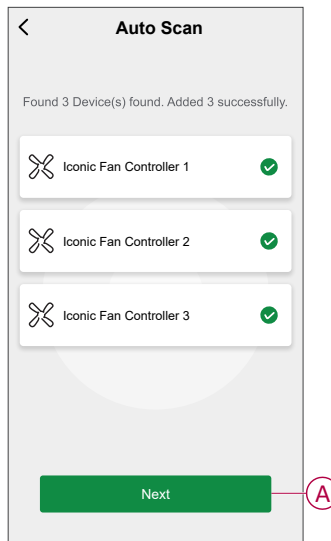

7. Once the device is added successfully, tap **Done**.

Pairing Bluetooth device

Using the Wiser app, you can pair the device with smartphone to access and control the device.

NOTE: When pairing the Bluetooth™ device with the Wiser app, be within a range of 8 to 10 m of the module. Range can be affected by wall thickness and construction materials.

1. On **Home** page, tap **+** then tap **Iconic A.C. fan controller BLE** .
2. Press and hold the push-button for > 8 s to enter pairing mode.
LED blinks red/green per second

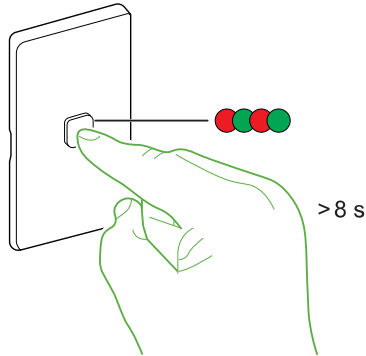

3. In the app, select **Confirm the indicator blinking rapidly** and tap **Start Configuration (A)**.

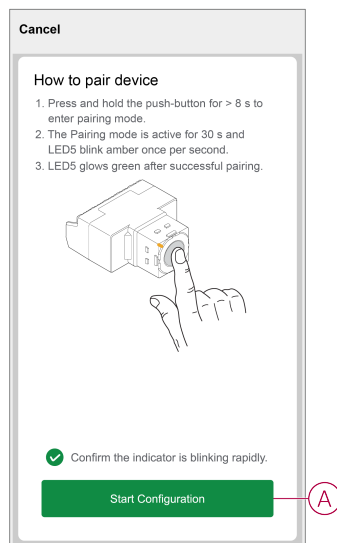

NOTE: Enable permissions to nearby devices and Bluetooth™ for scanning the device.

4. Tap  to select and add the device from the list and then tap **Next > Done**.

NOTE: The device can be paired with max. 8 smartphones. To pair an additional phone, you must unpair one of the existing phones. Refer managed paired phones, page 30.

Manual operation

You can turn on/off or control the fan speed manually.

Shortly press the push button to turn on the fan at low speed, then press it again to change the speed to medium and then again to high.

Press and hold the push-button for 1 s to turn off the fan.

You can also turn off the fan by short pressing the push button once when it is at high speed

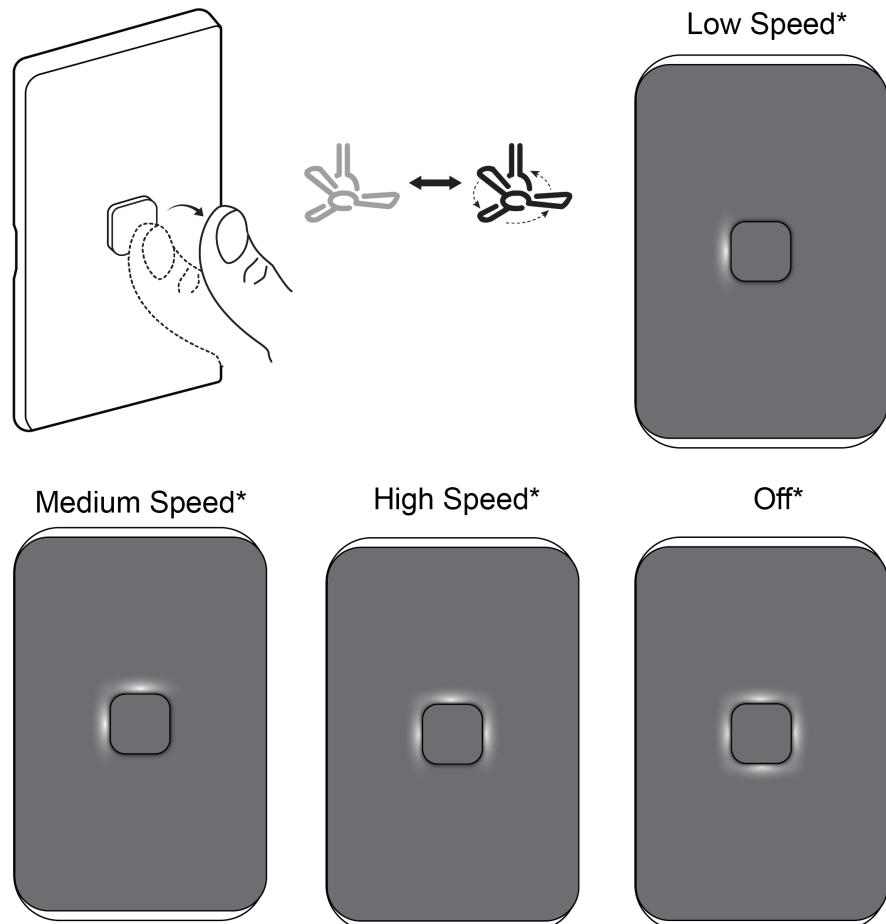

*LED Orientation - Horizontal Right

TIP: You can change LED behavior in Wiser app setting:



For Zigbee, refer Zigbee LED indication setting, page 16.

For Bluetooth, refer Bluetooth LED indication setting, page 29.

Configuring the device

Changing the device icon

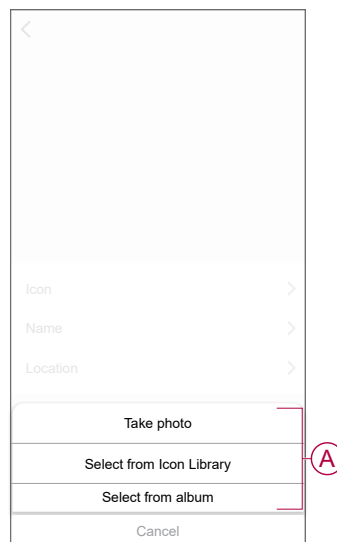

You can change the device icon using the Wiser app.

1. On the **Home** page, select the device for which you wish to change the icon.
2. At the top-right corner of the screen, tap .
3. Tap edit  next to the device name.
4. Tap **Icon** to view the menu.
5. In the slide-up menu, select any one of the following (A) to change the device icon:
 - **Take photo** - allows you to take a photo with your device camera.
 - **Select from Icon Library** - allows you to select an icon from the app library.
 - **Select from Album** - allows you to select a photo from the mobile gallery.



Renaming the device

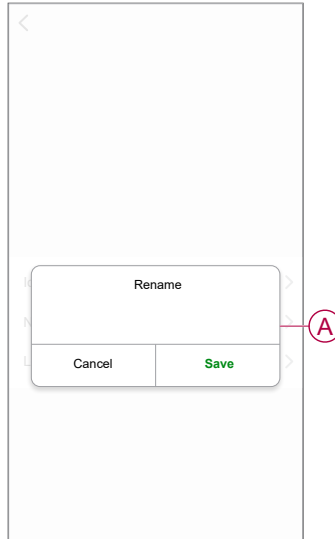

You can rename the device using the Wiser app.

1. On the **Home** page, select the device for which you wish to rename.
2. At the top-right corner of the screen, tap .
3. Tap edit  next to the device name.
4. Tap **Name**, enter the new name (A) and then tap **Save**.



Changing the device location

You can change the device location using the Wiser app.

1. On the **Home** page, select the device for which you wish to change the location.
2. At the top-right corner of the screen, tap .
3. Tap edit  next to the device name.
4. Tap **Location**.
5. Select the desired location from the list (A) and then tap **Save**.

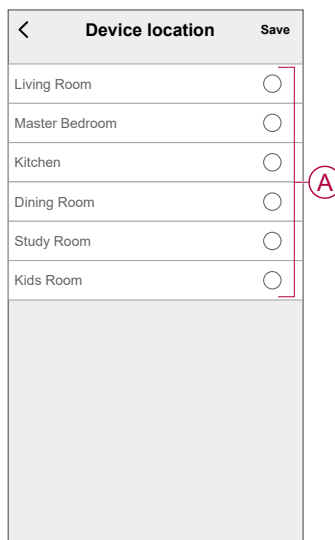

Zigbee Mode

Zigbee fan controller settings

Using the Wiser app, LED behavior on the fan controller can be set.

1. On the **Home** page, tap **All devices > Iconic Fan Controller**.
2. On the device control panel page, tap **Settings**.

LED indicator mode

You can select the LED indicator mode for easy identification of the fan controller status.

Tap **LED Indicator Mode** and select a mode (A):

– **Always On:** the LED(s) on the fan controller is always on.

– **On with timeout but acts as a locator:** all LED(s) glow in lesser brightness after the time out.

– **On with timeout:** When the fan controller is operated, respective LED(s) glow for 5 s.

For information on LED during each modes, refer to LED indication, page 35.

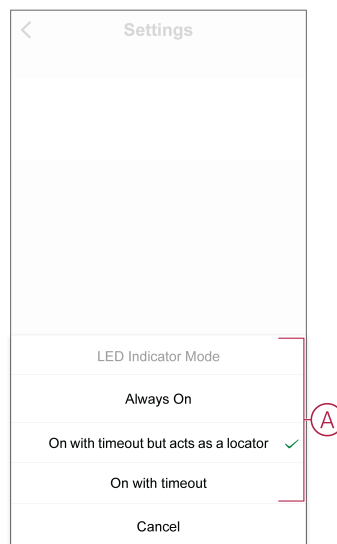

Orientation settings

The Fan Controller can be installed in 4 different orientations. This feature allows the user/installer to select the orientation of the low/medium/high speed LEDs to maintain the same sequence across different fan controllers.

Using the app, you can choose the orientation.

Tap **LED Indicator Orientation** and select an orientation:

- **Horizontal Left**
- **Horizontal Right**
- **Vertical Top**
- **Vertical Bottom**

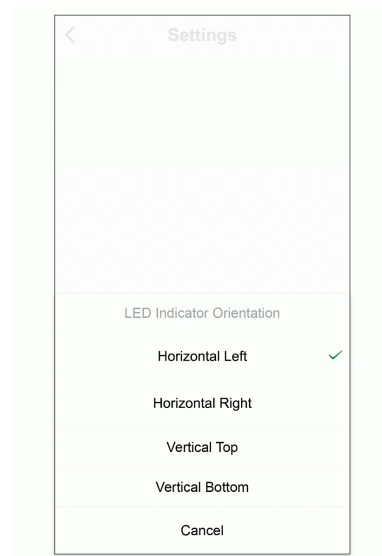

Using the Device

On the **Home** page, tap **All devices** > **Iconic Fan Controller** to access the control panel.

On the fan controller control panel page, you can see the following:

- Power button (A)
- Fan speed (B)
- Schedule, page 19 (C)
- Settings, page 16 (D)

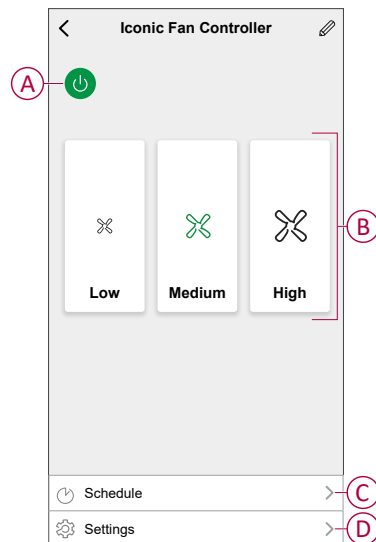

Operating the device using app

Using the Wiser app, you can turn on/off and regulate the fan speed.

On the **Home** page, tap the power button (A) to turn on/off the fan.

Tap  (B) for slide-up menu and select required fan speed (C).

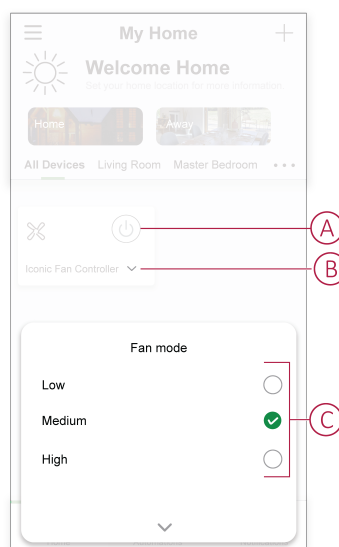

NOTE: You can also navigate to the control panel, page 18 of the device to operate the fan.

Creating a schedule

The fan controller can be controlled and triggered by a schedule. Once the schedule is set, your system will follow the active schedule. You can create or modify the schedules at any time.

1. On the **Home** page, tap **All devices** > **Iconic Fan Controller**.
2. Tap **Schedule** > **Add schedule** to add a schedule.
3. Set the time (A).
4. Tap **Repeat** (B) to select the days you want to set the schedule.
5. Tap **Note** (C), enter the note and tap **Confirm**.
6. Tap the toggle switch (D) to turn On the **Notification** for the schedule. The app will send a notification that the scheduled task is executed at the time of schedule.
7. Tap **Fan Speed** (E) and select the required speed:
 - **Low**
 - **Medium**
 - **High**



The screenshot shows the 'Add Schedule' dialog box with the following elements and callouts:

- Cancel** (top left), **Add Schedule** (top center), **Save** (top right)
- Time Selection:** A list of times from 08:31 to 13:36. The time 10:33 is selected. A red bracket labeled **A** highlights the time selection area.
- Repeat:** A dropdown menu currently set to 'Once'. A red circle labeled **B** highlights the dropdown arrow.
- Note:** A text input field with a right-pointing arrow. A red circle labeled **C** highlights the arrow.
- Notification:** A toggle switch currently in the 'off' position. A red circle labeled **D** highlights the toggle.
- Fan Speed:** A dropdown menu currently set to 'Medium'. A red circle labeled **E** highlights the dropdown arrow.
- Note:** A text area at the bottom containing the text: 'Note - The Schedule works according to the timezone where device is located.'

8. Tap **Save**.

Creating a moment

A Moment allows you to group multiple actions that are usually done together. Using the Wiser app, you can create moments based on your needs (such as movie night).

1. On the **Home** page, tap .
2. Go to **Moment** > **+** to create a moment.
3. Tap **Edit name** , enter the name of the moment (A) and tap **Save**.
TIP: You can choose the cover image that represents your moment by tapping .

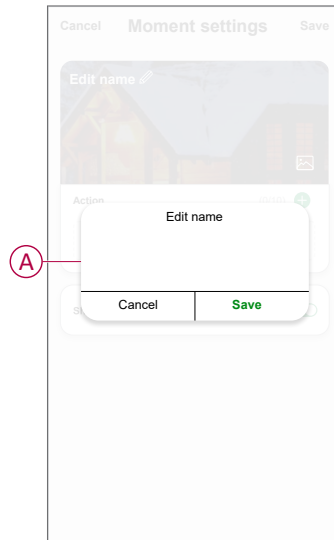

4. In the **Action** section, tap **Add task** (B) to display the slide-up menu.
5. In the **Add task** menu, you can do either or all of the following actions (C):
 - **Run the device:** select the devices that you want in a moment.
 - **Select Automation:** select the automation that you want to enable or disable. For more info refer to *Automation*.
 - **Delay:** set the delay time.

NOTE: You can add one or more actions using .

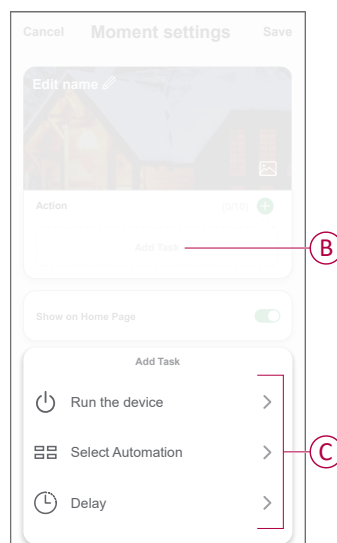

6. Tap **Run the device > Iconic Fan Controller > Fan Speed** and select a function (D) and then tap **Save > Next**.

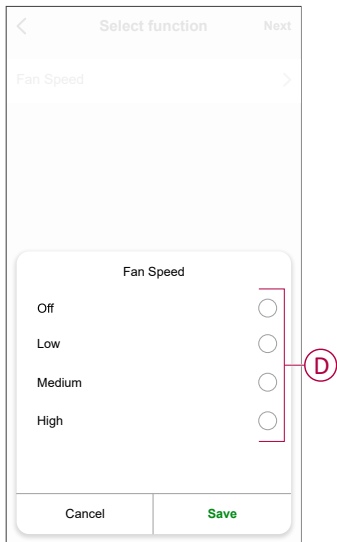

7. Set all actions and tap **Save**.

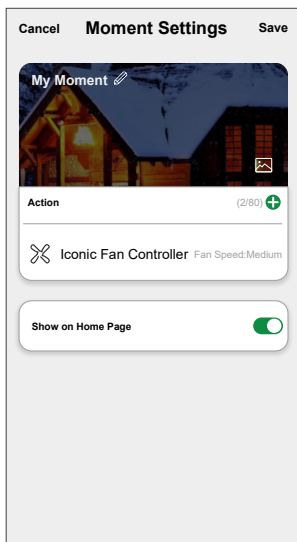

Editing a moment

1. On the **Moment** tab, locate the moment you want to edit and tap ●●●.
2. On the **Edit** page, you can tap each item (such as dimmer, shutter, delay, temperature, etc.) to change the settings.

TIP:

- You can add one or more actions using .
- To delete an existing action, slide each item towards left and tap **Delete**.

Deleting a moment



To delete a moment:

1. On the **Moment** tab, locate the moment that you want to delete and then tap ●●●.
2. Tap **Delete** and then tap **Ok**.

NOTE: After deleting a moment, the device action can no longer be triggered.

Creating an automation

An automation allows you to group multiple actions that are usually done together, triggered automatically or at scheduled times. By using the Wiser app, you can create automations based on your needs.

1. On the **Home** page, tap the .
2. Go to **Automation** > **+** to create an automation.
3. Tap **Edit name** , enter the name of the automation (A) and tap **Save**.

TIP: You can choose the cover image that represents your automation by tapping .

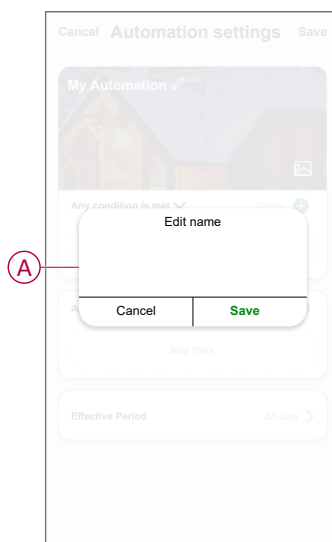

4. Tap **Any condition is met** to select any one of the condition type (B):
 - **All conditions are met:** the automation is triggered when all the conditions are met.
 - **Any condition is met:** the automation is triggered when at least one condition is met.

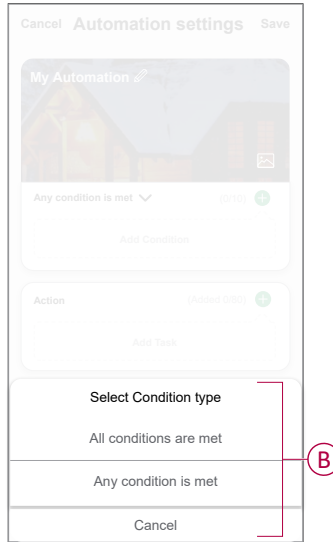

5. Tap **Add Condition** to display the slide-up menu.
6. In the **Add Condition** menu, you can do either or all of the following options (C):
 - **When weather changes:** select the various weather settings.
 - **Schedule:** set the time and day.
 - **When device status changes:** select the device and it's function.

NOTE: You can add one or more conditions using .

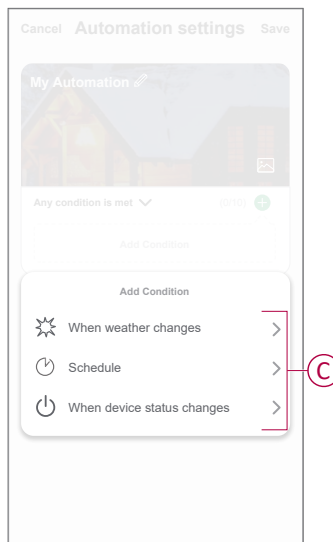

7. Tap **Add task** to display the slide-up menu you can do either or all of the following options (D):
- **Run the device:** select the devices that you want to trigger.
 - **Moment or Automation:** select the moment which you want to trigger or select the automation that you want to enable or disable.
 - **Send notification:** turn on notification for the automation.
 - **Delay :** set the delay time.

NOTE: You can add one or more actions using .

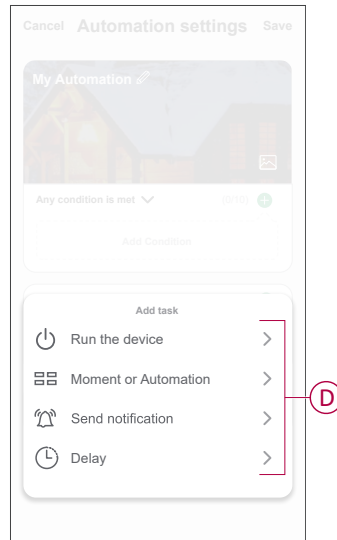

8. Tap **Run the device > Iconic Fan Controller > Fan Speed** and select a function and then tap **Save > Next**.

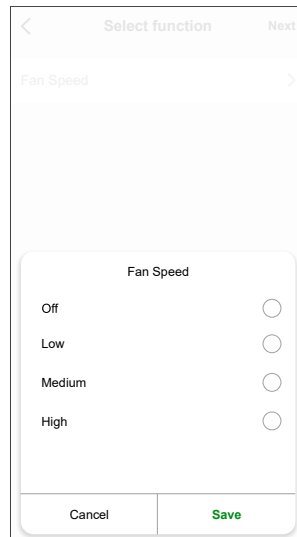

9. Tap on Effective period to set the time range for the automation. You can select any one of the following (E):
 - **All-day - 24 hours**
 - **Daytime - From sunrise to sunset**
 - **Night - From sunset to sunrise**
 - **Custom - User defined time period**

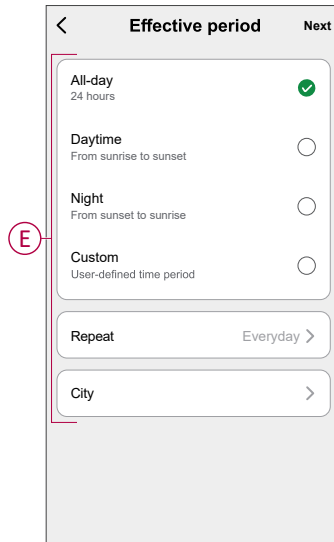



10. Set all actions and conditions, then tap **Save**.

Automation is now available under **Automation** tab. Use toggle switch to enable/disable automation.

Example of an automation

This demonstration shows you how to create an automation to turn on the fan when outdoor temperature exceeds certain value.

1. Go to **Automation** > **+** to create an automation.
2. Tap **Edit name** , enter the name of the automation and tap **Save**.
TIP: You can choose the cover image that represents your automation by tapping .
3. Tap **Add Condition** > **When weather changes** > **Outdoor Temperature**, set temperature (A) and then tap **Next**.

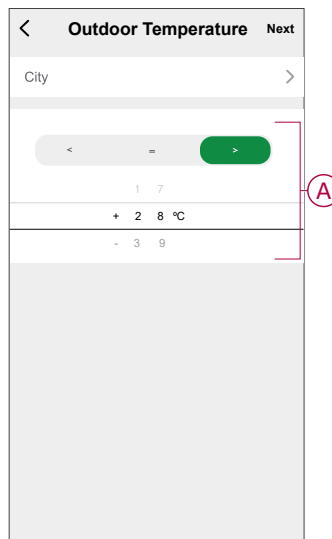

4. Tap **Run the device > Iconic Fan Controller > Fan Speed** and select a function and then tap **Save > Next**.

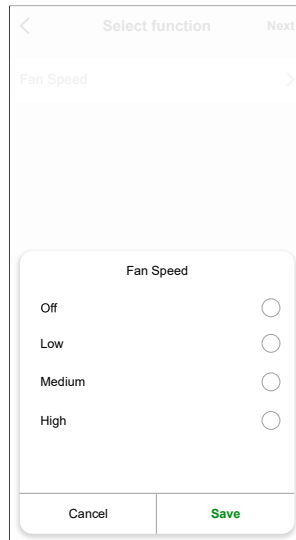

5. In the **Automation Settings** page, tap **Save**.

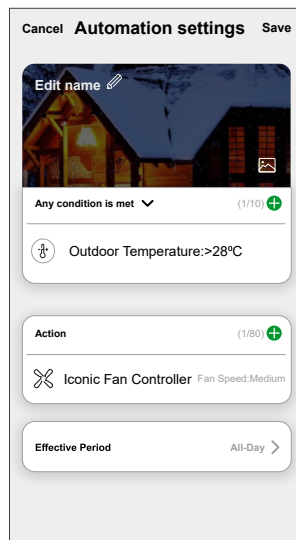

Automation is now available under **Automation** tab. Use toggle switch to enable/disable automation.

Editing an automation

1. On the **Automation** tab, locate the automation you want to edit and tap ●●●.
2. On the **Edit** page, you can tap each item (such as dimmer, shutter, delay, temperature, etc.) to change the settings.

TIP:

- You can add one or more condition or actions using .
- To delete an existing condition or action, slide each item towards left and tap **Delete**.

Deleting an automation

1. On the **Automation** tab, locate the automation that you want to delete and then tap ●●●.
2. Tap **Delete** and then tap **Ok**.

NOTE: After deleting an automation, the device action can no longer be triggered.

Removing the device from Wiser system

Using the Wiser app, you can remove the fan controller from the device list.

1. On the **Home** page, tap **All devices** and select the **Iconic Fan Controller** which must to be removed.
2. Tap  to display more details.
3. Tap **Remove and Factory Reset Device (A)** and tap **Confirm**.

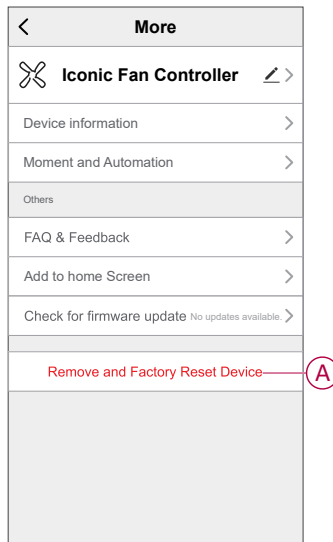

TIP: On the **Home** page, tap and hold the **Iconic Fan Controller** to remove the device.

NOTE: By removing the device, you will reset the device and all related data is erased. If you have a problem with the reset, then refer to [resetting the device](#), page 35.

Bluetooth Mode

Bluetooth fan controller settings

Using The Wiser app, you can manage the Dimmer modes and settings.

1. On the **Home** page, tap **All devices** > **Iconic Fan Controller**.
2. Tap **Settings** and select any of the following:
 - Mode, page 29 (A)
 - LED Indicator Settings, page 29 (B)
 - Synchronization Time, page 30 (C)
 - Manage Paired Phone, page 30 (D)
 - Device Orientation, page 31 (E)
 - Reset Device Settings, page 31 (F)

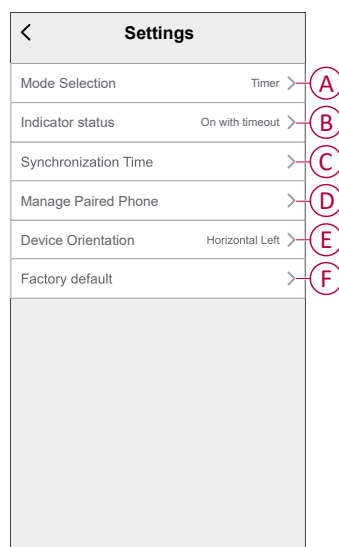

Changing the Mode

Using mode setting, timer can be set to turn off the device after a set period of time or you can set it as a switch to turn on/off manually.

On the **Settings** page, tap **Mode** and select any of the following:

- **Switch:** control the speed and turn on/off of the fan.
- **Timer:** when fan is running, set the timer to turn off. Refer using mode timer, page 33.

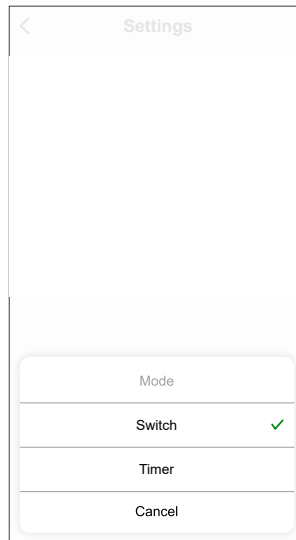

LED Indicator Settings

You can select the LED indicator mode for easy identification of the device status.

On the **Settings** page, tap **LED Indicator Settings** and select any of the following:

- **Always On:** LED on the device is always turned on.
- **On with Timeout but as Locator:** LED glow in lesser brightness after the time out.
- **On with Timeout:** After inactive period LED turns off.

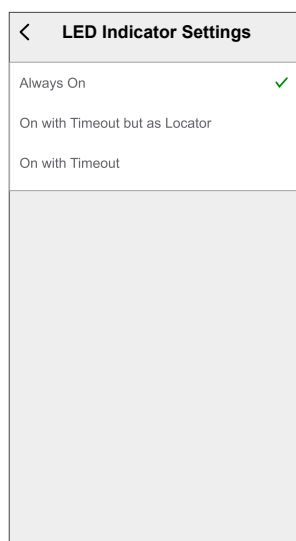

Synchronization Time

Using Wiser app, you can synchronize the time of the device with your smartphone.

On the **Settings** page, tap **Synchronization Time > Update Time & Date (A)**. This allows the device time to sync with smartphones in real-time.

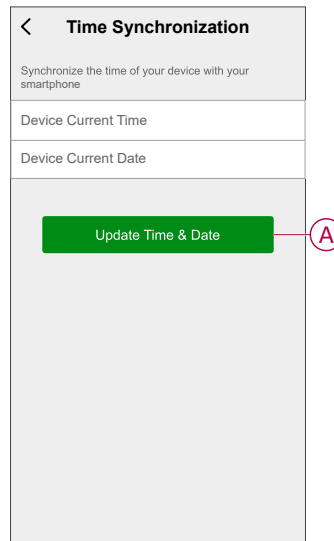

Manage Paired Phone

Using Wiser app, you can view or delete paired phones.

On **Settings** page, tap **Manage Paired Phone** and select any of the following (A):

- **Delete all Devices:** the device is removed from all paired phones.
- **Delete my Device:** the device is removed from current phone.

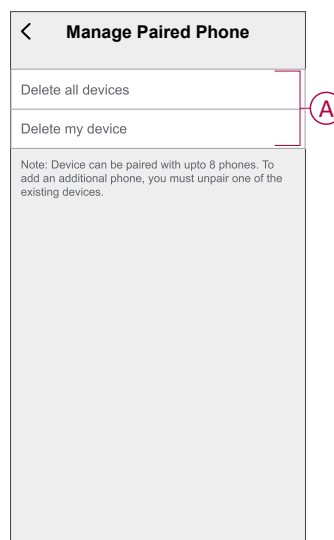

Device Orientation

The Fan Controller can be installed in 4 different orientations. This feature allows the user/installer to select the orientation of the low/medium/high speed LEDs to maintain the same sequence across different fan controllers.

On the **Settings** page, tap **Device Orientation** and select any of the following:

- **Horizontal Left**
- **Horizontal Right**
- **Vertical Top**
- **Vertical Bottom**

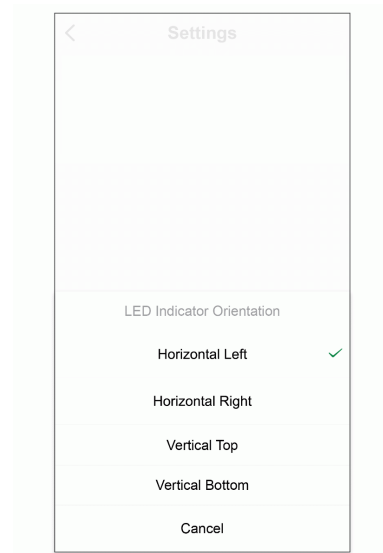

Reset device settings

Using Wiser app, you can reset the device settings to default.

On **Settings** page, tap **Reset device settings**.
Read the information and tap **Confirm (A)**.

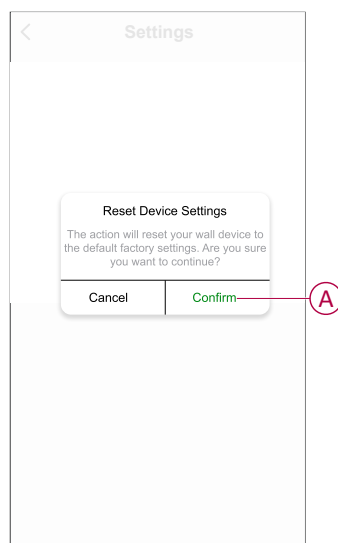

NOTE: This action will reset the device to default factory settings.

Using the Device

On the **Home** page, tap **All devices > Iconic Fan Controller** to access the control panel.

On the fan controller control panel page, you can see the following:

- Power button (A)
- Fan speed (B)
- Mode timer, page 33 (C)
- Mode indicator, page 29 (D)
- Settings, page 16 (E)

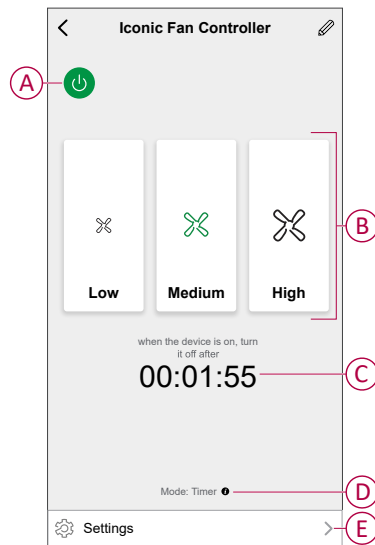

Operating the device using app

Using the Wiser app, you can turn on/off and regulate the fan speed.

1. On Home page, select the fan controller and tap power button (A) to turn on/off the fan.
2. Once fan is turned on, select the required speed (B).

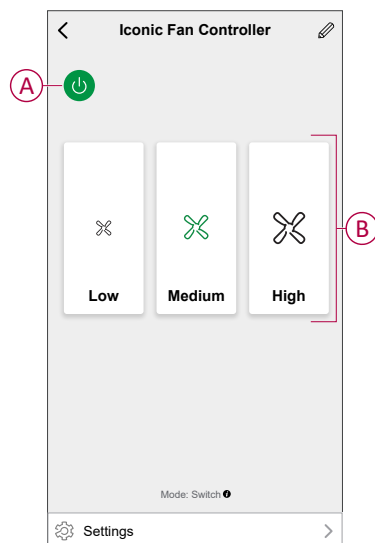

NOTE: During timer mode, the fan controller automatically turns off after a specified period of time. Refer Using timer mode, page 33.

Setting timer mode

You can set the timer to turn off the device after a certain period of time.

In Wiser app, change the mode from switch to timer, refer to mode settings, page 29.

1. On the device control panel page, tap timer (A) for the slide-up menu.

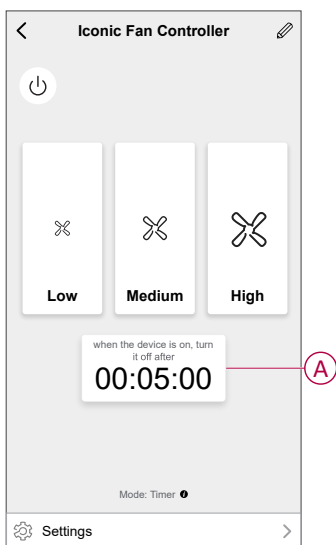

2. In the slide-up menu select the required **Set Period** (B) and tap **Save**.

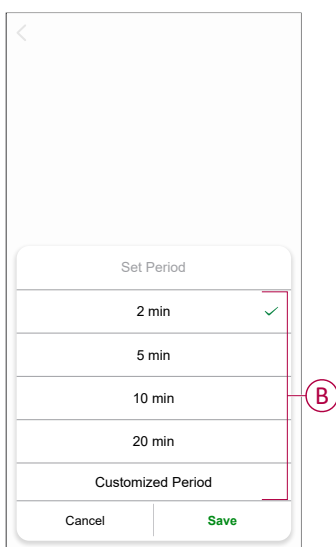

NOTE: The timer mode will be stopped automatically at the end of the countdown timer. If the timer mode feature is enabled, and there are one or more Schedule/Moment/Automation actions in this period, then the system will stop the current mode action immediately, and perform the new actions (the new action always has a higher priority than the current action).

Once the countdown timer reaches zero, the device turns off.

Removing the device

Using the Wiser app, you can remove a device from the device list.

1. On the **Home** page, tap **All devices > Iconic Fan Controller**.
2. Tap  to display more details.
3. Tap **Remove device** (A) and select any of the following:
 - **Disconnect**: to remove the device.
 - **Disconnect & Erase Data**: to remove the device and erase data.

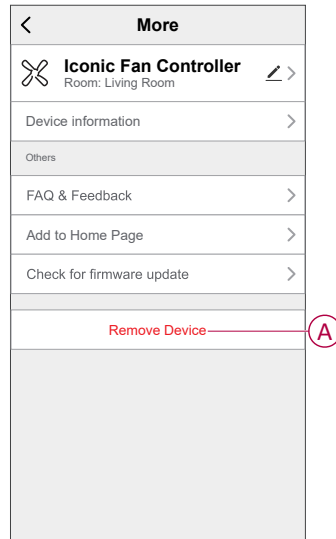

TIP: On the **Home** page, tap and hold the **Iconic Fan Controller** to remove the device.

Resetting the device manually

You can reset the device to factory default manually.

Short press the push button three times (<0,5 s) and then long press the push button once (>10 s).

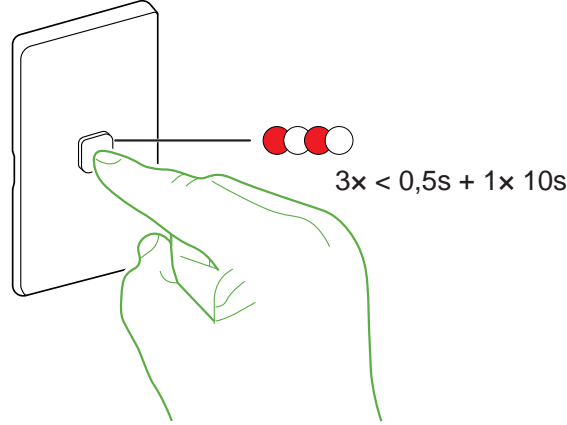

After 10 s, release the push button when the LED starts blinking red.



NOTE: For Zigbee device, after reset, the LED turns amber/orange indicating that device is ready for pairing.

LED indication



Pairing the device

User Action	LED Indication	Status
Press and hold the push button for > 8 s times.	For Zigbee, LED blinks amber.  For Bluetooth, LED blinks red green. 	Pairing mode is active for 30 seconds. When pairing is completed, LED glows green for a few seconds before turning Off. 

Changing protocol

User Action	LED Indication	Status
Short press the push-button 3 times and long press once for > 20 s.	LED blinks red rapidly indicating commence of protocol change. 	On successful change in protocol: <ul style="list-style-type: none"> • Zigbee to Bluetooth - No colour indication, white back light only. • Bluetooth to Zigbee - Flashing Amber LED (Indicating that device is in pairing mode), if pairing is not completed will become solid Amber

Resetting the device

User Action	LED Indication	Status
Short press the push button 3 times and hold it down once for > 10 s.	LED blinks red once per second. 	For Zigbee, the device is reset to the factory settings after 10 seconds. The device then restarts and the LED blinks amber indicating that it is ready for pairing.  For Bluetooth, the device is reset to the factory settings after 10 seconds and the device turns off.

LED indicator mode

LED indicator mode	Speed	LEDs	Timeout	Locator*
Always On	Low	LED1	0	No
	Medum	LED1 and LED2		
	High	LED1, LED2, and LED3		
	Off	LED1, LED2, LED3, and LED4		
Act as a Locator	Low	LED1	5 s	Yes
	Medum	LED1 and LED2		
	High	LED1, LED2, and LED3		
	Off	LED1, LED2, LED3, and LED4		
On with Timeout	Low	LED1	5 s	No
	Medum	LED1 and LED2		
	High	LED1, LED2, and LED3		
	Off	LED1, LED2, LED3, and LED4		

*Glows all four LEDs in lesser brightness after the time out

LED Orientation - Horizontal Left*

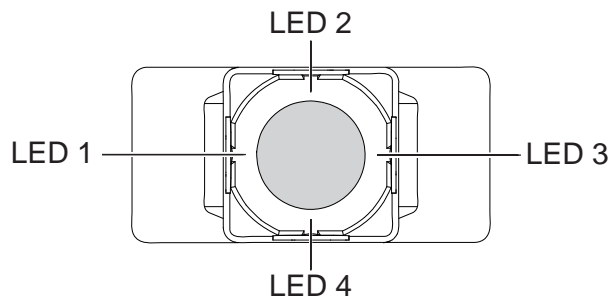

*LED position may vary depending on orientation.

Troubleshooting

Symptom	Solution
No fan movement or uncontrolled movement.	<ul style="list-style-type: none"> • Check power supply. • Check the wiring. • Check the load
The device is not ready to pair after the device is removed from the app.	Reset to factory default settings, refer to resetting the device manually, page 35.

Technical Data

Technical data

Operating Voltage	220 - 240 V AC. , 50 Hz
Load rating	Total max.150 W
Number of Fans	Max. 2
Switching Technique	Relay

Protection

Over Temperature	Yes
Short circuit	No
Over-current fuse	No
Thermal protection	Yes
LED Indicator	Yes
Multi-gang plate capacity	Max 3 primary fan controllers per plate
Compatible plate ranges	Iconic, Iconic Style, Iconic Essence, Pro Series
Mounting Centres	84 mm pattern plate

Compliance

RCM	
Environmental Rating	IP20

Ambient operating

Humidity	5%–90% RH, non-condensing
Temperature	-10 to +50 °C

41ECSFWMZ-VW

Operating frequency	2.405 GHz to 2.48 GHz
Max. radio-frequency power transmitted	< 10 mW
Communication protocol	Zigbee 3.0 certified

41ECSFWM-VW

Communication protocol	Bluetooth low energy
------------------------	----------------------

Compliance

Compliance information for Green Premium products

Find and download comprehensive information about Green Premium products, including RoHS compliance and REACH declarations as well as Product Environmental Profile (PEP) and End-of-Life instructions (EOLI).

<https://checkaproduct.se.com/>



General information about Green Premium products

Click the link below to read about Schneider Electric's Green Premium product strategy.

<https://www.schneider-electric.com/en/work/support/green-premium/>



Trademarks

This guide makes reference to system and brand names that are trademarks of their relevant owners.

- Zigbee® is a registered trademark of the Connectivity Standards Alliance.
- Bluetooth® is a registered trademark of the Bluetooth Special Interest Group (SIG).
- Apple® and App Store® are brand names or registered trademarks of Apple Inc.
- Google Play™ Store and Android™ are brand names or registered trademarks of Google Inc.
- Wi-Fi® is a registered trademark of Wi-Fi Alliance®.
- Wiser™ is a trademark and the property of Schneider Electric, its subsidiaries and affiliated companies.

Other brands and registered trademarks are the property of their respective owners.

Schneider Electric (Australia) Pty Ltd
33-37 Port Wakefield Road
Gepps Cross SA 5094
Australia

Customer Care: 13 73 28

www.clipsal.com

As standards, specifications, and design change from time to time,
please ask for confirmation of the information given in this publication.

© 2023 – 2023 Schneider Electric. All rights reserved.

DUG_AC Fan controller_CLP-00