

| KNOCKOUTS | | | | |
|-----------|-----|-----|------|------|
| SYMBOL | A | B | C | D |
| IN | .50 | .75 | 1.00 | 1.25 |
| MM | 13 | 19 | 25 | 32 |

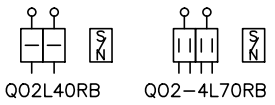
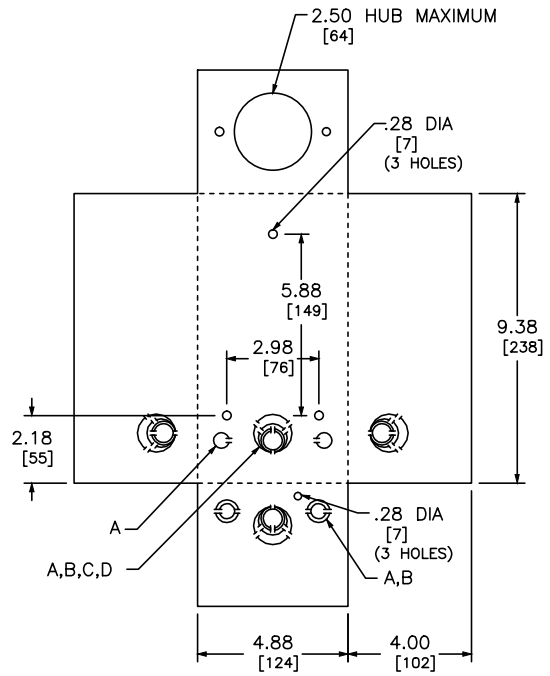

DUAL DIMENSIONS: INCHES
MILLIMETERS

| CATALOG NUMBER | MAXIMUM SYSTEM VOLTAGE | MAINS AMPERE RATING | SPACES | MAXIMUM NUMBER OF SINGLE POLE CIRCUITS | MAIN WIRE SIZE AWG |
|----------------|------------------------|---------------------|--------|----------------------------------------|--------------------|
| QO2L40RB | 120/240VAC | 40 | 2 | 2 | #12-6 AL, #14-6 CU |
| QO2-4L70RB | 1Ø 3W | 70 | | 4 | #12-3 AL, #14-4 CU |

NOTES:
FINISH - GRAY BAKED ENAMEL ELECTRODEPOSITED OVER CLEANED PHOSPATIZED STEEL.
UL LISTED - FILE E-6294 CSA LISTEDZ
NEUTRALS - INSULATED GROUNDABLE.

QO LOAD CENTERS
RAINPROOF NEMA TYPE 3R ENCLOSURE
OUTDOOR



DWG# 3020
NO.